

Palermo Fountain Owners Manual

Palermo is the capital of the Italian island of Sicily that is know for its grand Opera performances - this little piece of Italian elegance will add festivity to any space.

PLEASE READ THESE INSTRUCTIONS COMPLETELY BEFORE ATTEMPTING TO ASSEMBLE YOUR NEW FOUNTAIN

CONTENTS:

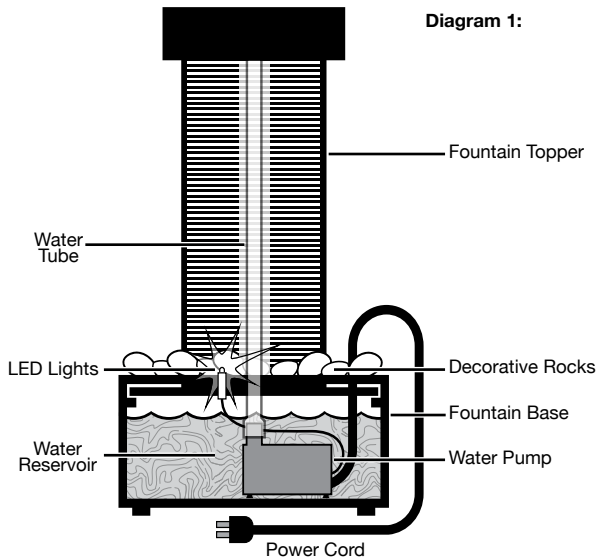

Please note, images of parts are not to scale with one another.



Pre Assembly Preparation:

- Note: The Palermo Fountain is designed for easy assembly but please use caution when assembling fountain.
- Prior to assembly take time to find a suitable location for your fountain and make sure to place the Base of your Fountain on a flat, firm surface.
- Use Diagram 1 for reference on part names, connecting and how all the individual parts fit together.
- Use all electrical safety precautions. Please make sure that the electrical plug is dry and clean before inserting into the outlet. Always unplug before filling with water or servicing your fountain.
- Due to evaporation check and fill water level periodically.

ASSEMBLY:



Figure 1

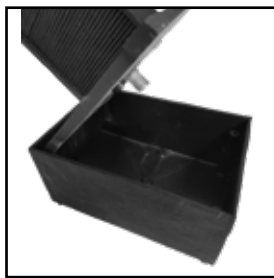

Figure 2

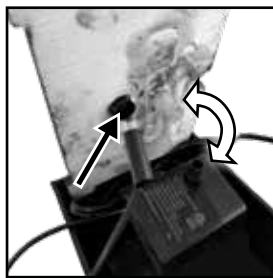

Figure 3

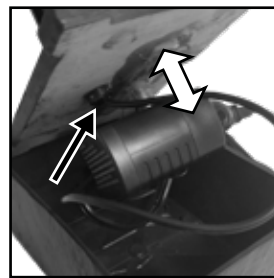

Figure 4

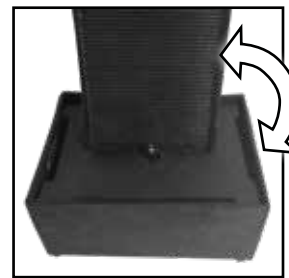

Figure 5

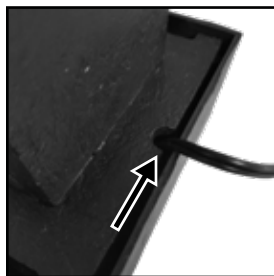

Figure 6



Figure 7

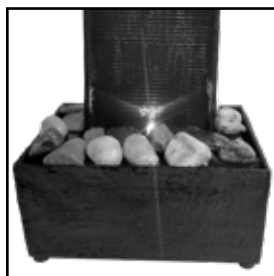

Figure 8



Figure 9

- Prior to assembly take time to find a suitable location for your fountain and make sure to place the Base of your Fountain on a flat, firm surface (Figure 1).
- Set the Fountain Topper on the edge of the Fountain Base (Figure 2).
- Insert the Water pump/LED Light combo into the Fountain Base. Insert the LED Light into the circular hole in the Fountain Topper base (Figure 3 & 4 Black Arrows). Insert the outlet of the Water Pump into the Water Tube (Figure 3 & 4 White Arrows).
- Set the Fountain Topper onto the Fountain Base (Figure 5). Route the Electrical Power Cord through the notch in the back of the Fountain Topper (Figure 6 Black Arrow).
- Place the Decorative Rocks around the base of the Fountain Topper (Figure 7).
- Fill the fountain reservoir with water (Figure 7). Make sure water pump is completely submerged in water. Due to evaporation check and fill water level periodically.
- Plug in your fountain and enjoy (Figure 8).
- If needed, you can adjust the water flow by locating the Water Flow Adjustment Lever on the Water Pump side cover. Move the lever toward the + (plus) sign to increase water flow or - (minus) sign to decrease water flow (Figure 9 Arrow).

OPERATION:

To turn on your fountain plug in your fountain: Check for water flowing out of the Fountain Topper and LED light is on. If water is not flowing refer Troubleshooting Section/Priming The Water Pump of this manual.

Water Level: Due to evaporation, clean water must be added periodically. Be sure to maintain the water level in the fountain base so that the water pump is completely submerged in water at all times. If not, damage may occur and the limited warranty will be void.

TROUBLESHOOTING:

Troubleshooting Guide

Priming the Water Pump

If you find the Water Pump is running but water is not flowing from your Fountain, you can try priming the Water Pump. First unplug the Corded Water Pump from the power source. Grab the pump and hold it while still submerged and lightly shake. This will dislodge any air bubbles that may be caught in your Water Pump. Plug the Corded Water Pump back into the power source. Water should be flowing from your Fountain. If water is not flowing, unplug the Corded Water Pump and repeat the steps above.

PROBLEM	SOLUTION
Water Not Flowing	Pump is on but no water flow: Check water level.
	Pump is on but no water flow: Check pump is free of debris, kinks or obstructions. See Care And Maintenance Section.
	Pump is on but no water flow: Check tube is connected properly. See Assembly Section.
Low Water Flow	Adjust the water flow by locating the Water Flow Adjustment Lever on the Water Pump side cover. Move the lever toward the + (plus) sign to increase water flow or - (minus) sign to decrease water flow.
	Pump is on but low water flow: Check pump is free of debris, kinks or obstructions. See Care And Maintenance Section.
Loud Sound	Pump is on but low water flow: Check water level. Air in pump: See Priming The Water Pump Section.
	Pump is on but low water flow: Check pump is free of debris, kinks or obstructions. See Care And Maintenance Section.
Suddenly Stops	Pump suddenly stops: Check pump is free of debris, kinks or obstructions. See Care And Maintenance Section.

CARE AND MAINTENANCE:

Cleaning your Fountain

In order to keep your Fountain in tip-top shape and free of algae, we recommend cleaning your Fountain every two months. To clean your Fountain, unplug, drain of all water and disassemble. Use a mild soap and soft cloth to clean the parts.

DO NOT SCRUB YOUR FOUNTAIN AS THIS COULD CAUSE DAMAGE TO THE FINISH.

Cold Storage

Drain the water from Fountain prior to the first freeze of the season. Clean and dry the Fountain of all water and bring it indoors. (Now is a great time to clean the pump to remove any debris that may have accumulated throughout the year). Store in a warm dry area.

Cleaning The Water Pump

The impeller inside of the Water Pump is what pushes water up through your Fountain. After long periods of usage, this part will need to be cleaned to make sure your Fountain runs optimally.

Step 1: Remove the pump cover panel off the Water Pump by grabbing the sides of the cover and pulling it up off the unit. Cover is tight but will come off.

Step 2: Remove the impeller chamber cover. Cover is also tightly fitted but will come off.

Step 3: Remove the impeller from its chamber.

Step 4: Rinse the impeller until all debris has been removed.

Step 5: Reassemble your pump.

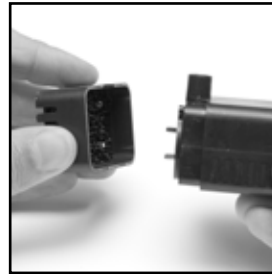

Step 1



Step 2



Step 3



Step 4

READ AND FOLLOW ALL SAFETY INSTRUCTIONS.

a) Close supervision is necessary when any appliance is used by or near children. b) To avoid injury, do not contact moving parts or hot parts such as heaters, reflectors, lamp bulbs, and the like. c) Always unplug an appliance from an outlet when not in use, before putting on or taking off parts, and before cleaning. Never yank cord to pull plug from outlet. Grasp the plug and pull to disconnect. d) Do not use an appliance for other than intended use. The use of attachments not recommended or sold by the appliance manufacturer may cause an unsafe condition. e) Do not install or store the appliance where it will be exposed to the weather or to temperatures below freezing. f) Read and observe all the important notices on the appliance. g) If an extension cord is necessary, a cord with a proper rating should be used. A cord rated for less amperes or watts than the appliance rating may overheat. Care should be taken to arrange the cord so that it will not be tripped over or pulled. h) This appliance has no user serviceable parts.

LIMITED ONE YEAR WARRANTY

This warranty gives you specific legal rights and you may also have other rights which vary from state to state. This product has a one year limited warranty on all materials and workmanship. Bernini® warrants the original purchaser of this product that the product will be free from manufacturing defects in workmanship and material for a period of one (1) year from the date of original purchase. If within one (1) year this product fails due to defect in material or workmanship, Bernini® will repair, replace or supply any defective part(s) at their discretion. The purchaser must contact Bernini® and provide a description of the defective part, including digital pictures if requested, with this original purchase documentation as validation of warranty coverage. This warranty does not cover or apply to: (a) damage to the product due to misuse, mishandling, and abuse, (b) products not used in accordance with instructions, (c) product not assembled or installed according to instructions, and (d) normal wear and tear.

Call us for assistance at +1 (619) 449-2392 or you can email us at customer@berninifountains.com or mail us at: 9545 Pathway Street, Santee, CA 92071, Our Customer Care Department is available: Monday - Friday 8:30am to 4:00pm PST /11:30am - 7:00pm EST

Please read first before returning:

Please call us for assistance at +1 (619) 449-2392 or email us at customer@berninifountains.com. Our Customer Care Department is available: Monday - Friday 8:30am to 4:00pm PST, 11:30am to 7:00pm EST. If you have any questions regarding assembly, parts or operation, please visit our website at www.berninifountains.com. On our website, you will find instructional videos on how to assemble and operate your fountain and you can keep up to date on our newest products. This product comes with a one year limited warranty against materials and workmanship.

Santee, California 92071 | World Wide Patents Pending | Email: customer@berninifountains.com | On the web: www.berninifountains.com

Facebook & Pinterest: Bernini Fountain Company | Instagram: [@berninifountains](https://www.instagram.com/berninifountains) | Twitter: [@yrdllc](https://twitter.com/yrdllc)

© Yeiser Research & Development, LLC; 2020. All rights reserved.

Made in China | Designed in the USA

001207 BPFI rev 1f US

2 | BERNINI



Remember if you need help contact Customer Care: +1 (619) 449-2392

Palermo is the capital of the Italian island of Sicily that is know for its grand Opera performances - this little piece of Italian elegance will add festivity to any space.