

**\*PLEASE READ THESE INSTRUCTIONS COMPLETELY BEFORE ATTEMPTING TO ASSEMBLE YOUR NEW FOUNTAIN**

**OWNERS MANUAL**

## CONTENTS:



Please note, images of parts are not to scale with one another.

## Diagram 1a:

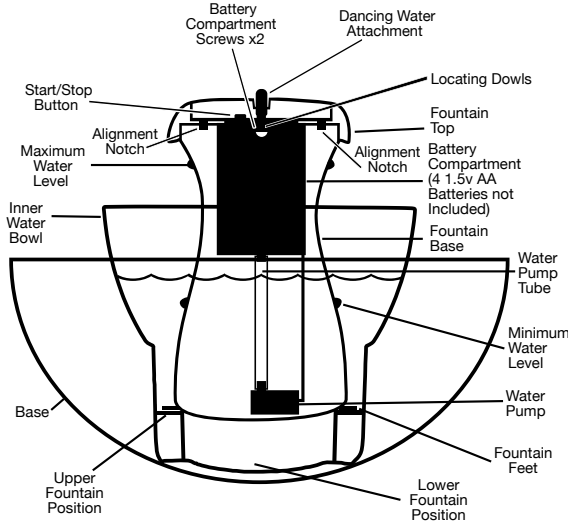

## STEP 1

### INSTALLING BATTERIES:

1. Lift Fountain Top with Battery Compartment & Water Pump out of the Fountain Base (Figure 5). Disconnect the Water Tube from the Battery Compartment.
2. Unscrew (counter clockwise) the Battery Compartment Screws and open cover (Figure 1a, 1b).
3. Orient the Battery Compartment with locating dowel on top. (See Arrow Figure 2a & 2b).
4. Requires 4 AA Batteries (Not Included). Insert 2-1.5v AA Batteries with the (+) side facing up in Battery Compartment and 2 AA Batteries with the (-) facing up in Battery Compartment (Figure 2a).
5. Reinstall the Fountain Top by aligning the locating dowel in the Battery Compartment and Fountain Top. Set the Battery Cover down onto the Battery Compartment ensuring the dowel sets into the alignment hole. Tighten the Battery Cover Screw by turning clockwise. **NOTE: You may need to apply pressure to the Battery Compartment Screws while tightening for the threads to catch.**

### CHANGING BATTERIES:

1. Remove any Dancing Water Attachment, lift Battery Compartment and Water Pump out of the Fountain (Figure 5), ensure **Battery Compartment and Water Pump are completely dry before opening Battery Compartment. It is important that no water enters the Battery Compartment.**
2. See Installing Batteries Section above on how to reinstall batteries and reassemble.
3. Set the Battery Compartment and Water Pump back into the Fountain (Figure 6).

## STEP 2

### Fountain Assembly

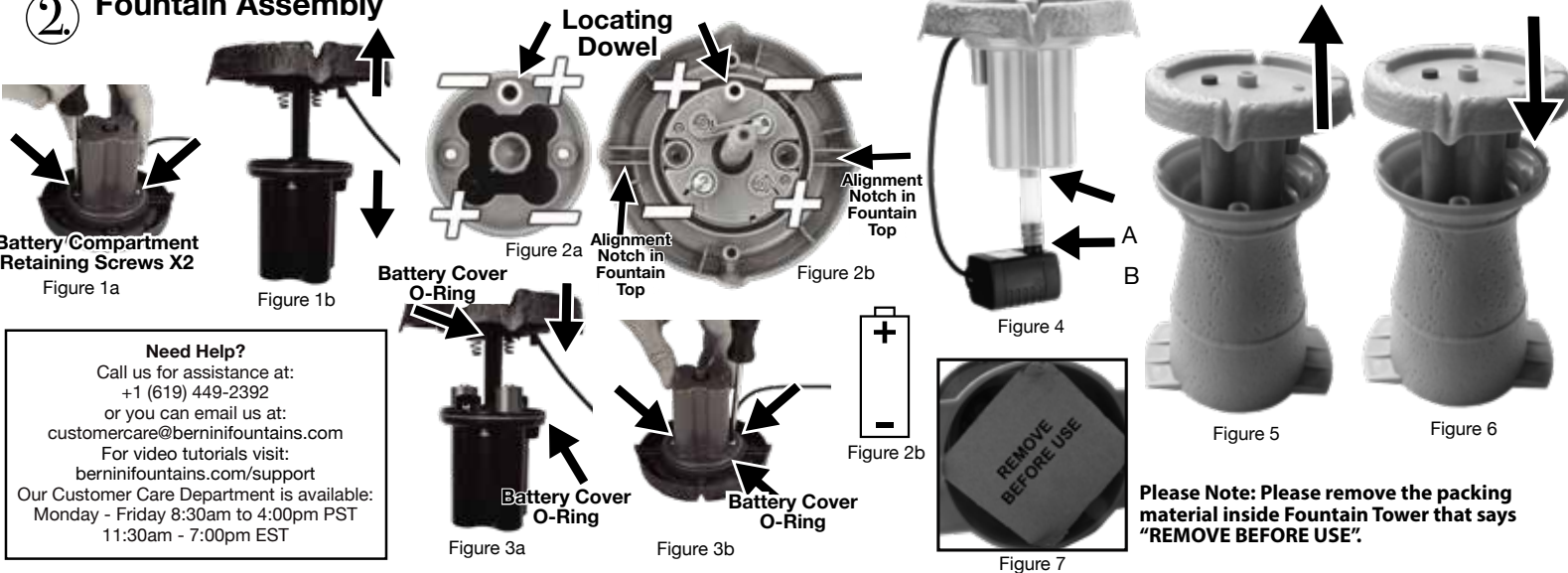

**Need Help?**  
 Call us for assistance at:  
 +1 (619) 449-2392  
 or you can email us at:  
 customercare@berninifountains.com  
 For video tutorials visit:  
 berninifountains.com/support  
 Our Customer Care Department is available:  
 Monday - Friday 8:30am to 4:00pm PST  
 11:30am - 7:00pm EST

**Please Note: Please remove the packing material inside Fountain Tower that says "REMOVE BEFORE USE".**

1. Take the Fountain Top/Battery Compartment and Water Pump, connect one side of the Water Tube to the Water Pump and the other end to the bottom side of the Battery Compartment (A & B of Figure 4).
2. Lower the Fountain Top with Battery Compartment and Water Pump into the Fountain Base. There are two locating dowels and two alignment notches that help you align the Fountain Top to the Fountain Base. Fit these into place and press to Fountain Top and Base together to secure (Figure 6).

## STEP 3

### OPERATING YOUR FOUNTAIN:

**The Fountain has a 1 or 2 hour timer and will repeat at the same time every day.**

**Turn Fountain on and daily set timer:** When the fountain is off, set the run time for 1 or 2 hours by slowly pressing the button 1 to 2 times. Three seconds after pressing the button, the LED light will repeatedly flash the number of times the button was pressed. This indicates the number of hours the Fountain will run every day. The Fountain will turn on at the same time, for the selected number of hours, daily thereafter.

**Stop Fountain for one day:** Press the button for less than 2 seconds. The LED will flash three times.

**Turn off the daily timer:** Press the button for less than 2 seconds. Then press and hold button again for over 2 seconds, the LED will flash solid for 2 seconds.

**DANCING WATER ATTACHMENT (OPTIONAL):** When Fountain is not running, attach the Dancing Water Attachment to the outlet in the middle of the Fountain Tower (Figure 8a, 8b and 8c). To prevent overspray, use a larger bowl.

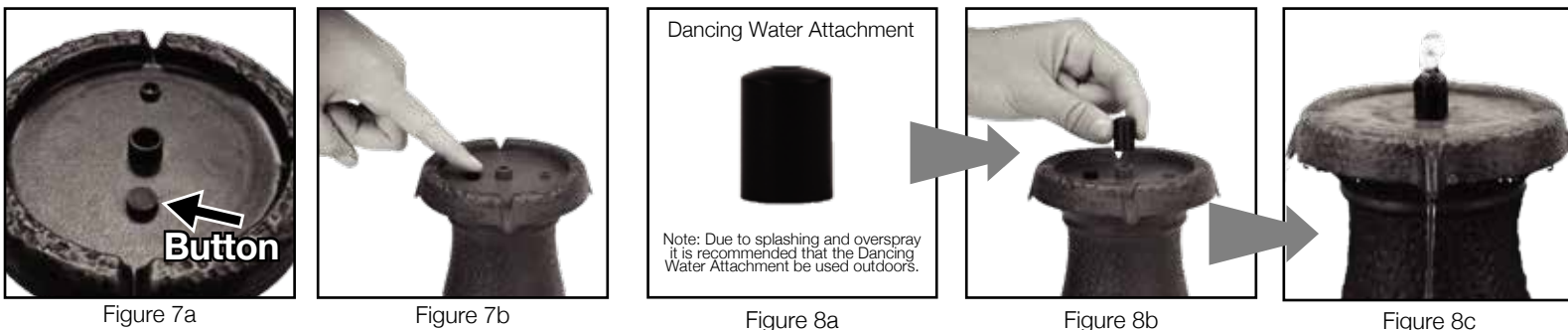

**Dancing Water Attachment**

Note: Due to splashing and overspray it is recommended that the Dancing Water Attachment be used outdoors.

### STEP 4 Troubleshooting

### Troubleshooting Guide

#### PRIMING THE WATER PUMP

If you find the Water Pump is running, but water is not flowing from your Fountain, you can try priming the Water Pump:  
Turn off Fountain, grab both sides of the Fountain and quickly shake your Fountain for ten seconds. This is to dislodge any air bubbles that may be caught in your Water Pump. Press the button to turn on your Fountain. Water should be flowing from the top of your Fountain. If water is not flowing, press and hold button for over 2 seconds again to turn off your Fountain, and repeat the step above.

#### WATER PUMP CONNECTION

If your Water Pump becomes disconnected from the Water Tube inside of the Fountain or if the Water Tube gets disconnected from the Battery Compartment, go to the Assembly Section to reconnect the Water Pump.

PROBLEM	SOLUTION
<b>Water Not Flowing</b>	Check batteries are installed correctly: See Installing Batteries Section.
	Check that batteries are new and good condition: See Installing Batteries Section.
	Pump is on but no water flow: Check water level.
	Pump is on but no water flow: Check pump is free of debris, kinks or obstructions. See Care And Maintenance Section.
	Pump is on but no water flow: Check tube is connected properly. See Assembly Section.
<b>Low Water Flow</b>	Check that batteries are new and good condition: See Installing Batteries Section.
	Pump is on but low water flow: Check pump is free of debris, kinks or obstructions. See Care And Maintenance Section. Pump is on but low water flow: Check water level. Air in pump: See Priming The Water Pump Section.
<b>Loud Sound</b>	Loud sound and weak flow: Air in pump: See Priming The Water Pump Section.
	Loud sound and weak flow: Check pump is free of debris, kinks or obstructions. See Care And Maintenance Section.
<b>Suddenly Stops</b>	Pump suddenly stops: Check pump is free of debris, kinks or obstructions. See Care And Maintenance Section.

### STEP 5 Care and Maintenance

#### COLD STORAGE

Turn power off, remove from container, clean and dry the Fountain of all water. Remove the batteries for long term storage and bring it indoors. (Now is a great time to clean the pump to remove any debris that may have accumulated throughout the year).

#### CLEANING YOUR FOUNTAIN

In order to keep your Fountain in tip-top shape and for a prolonged life, it is best if your Fountain and the bowl or water container that the Fountain is placed in are cleaned periodically. To clean your fountain, drain of all water and disassemble. Use a mild soap and a soft cloth to clean the parts of your Fountain.

#### CLEANING THE WATER PUMP'S PARTS

The impeller inside of the Water Pump is what pushes water up through your Fountain, allowing you to enjoy the soothing sounds and wonderful sights of your Fountain. After long periods of usage, this part will need to be cleaned to make sure your Fountain runs optimally.

**Step 1:** Remove the front panel of the Water Pump by grabbing the sides of the front panel and pulling it off the unit.

**Step 2:** Remove the impeller chamber cover. This is tightly fitted but will come off.

**Step 3:** Remove the impeller from its chamber.

**Step 4:** Rinse the impeller until all debris has been removed.

**Step 5:** Re assemble in reverse order.

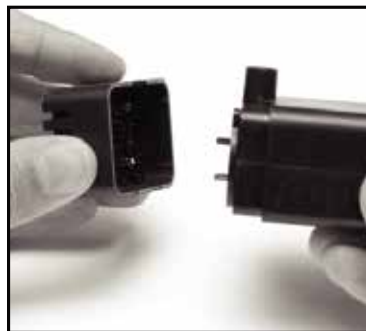

Step 1



Step 2



Step 3



Step 4

#### IMPORTANT BATTERY SAFETY INSTRUCTIONS:

**PROPOSITION 65 WARNING:** This product can expose you to chemicals including lead and lead compounds which are known to the State of California to cause cancer and birth defects or other reproductive harm. For more information go to [www.P65Warnings.ca.gov](http://www.P65Warnings.ca.gov).

**WARNING:** When using electric devices, basic safety precautions should always be followed to reduce the risk of fire, electric shock and personal injury, including the following:

**WARNING:** 1. Do not incinerate the battery even if it is severely damaged or is completely worn out. The battery can explode in a fire. Check with municipal codes in your area for possible special disposal instructions.

2. If liquid leaks from the battery cell, discontinue use immediately and dispose of properly.

3. Use only 4-1.5V AA Cell Batteries.

4. Do not attempt to disassemble, remodel or destroy the batteries, as it may cause battery leakage, fire, or bursting; and could also create sulfuric acid spills from the battery resulting in possible burns to person and damage to the immediate environment.

5. Never dispose of batteries in the garbage. Disposal of batteries in the garbage is unlawful under state and federal environmental laws and regulations. Always take used batteries to your local battery-recycling center.

#### LIMITED ONE YEAR WARRANTY

This warranty gives you specific legal rights and you may also have other rights which vary from state to state. This product has a one year limited warranty on all materials and workmanship. Bernini® warrants the original purchaser of this product that the product will be free from manufacturing defects in workmanship and material for a period of one (1) year from the date of original purchase. If within one (1) year this product fails due to defect in material or workmanship, Bernini® will repair, replace or supply any defective part at their option. The purchaser must contact Bernini® and provide a description of the defective part; including digital pictures if requested, with this original purchase documentation as validation of warranty coverage. This warranty does not cover or apply to: (a) damage to the product due to misuse, mishandling, and/or abuse; (b) products not used in accordance with instructions; (c) product not assembled or installed according to instructions; and (d) normal wear and tear. Call us for assistance at +1 (619) 449-2392 or you can email or mail us at: 9545 Pathway Street, Santee, CA 92071, [customercare@berninifountains.com](mailto:customercare@berninifountains.com). Our Customer Care Department is available: Monday - Friday 8:30am to 4:00pm PST / 11:30am - 7:00pm EST

#### Please read first before returning:

Please call us for assistance at +1 (619) 449-2392 or email us at [customercare@berninifountains.com](mailto:customercare@berninifountains.com). Our Customer Care Department is available: Monday - Friday 8:30am to 4:00pm PST, 11:30am to 7:00pm EST. If you have any questions regarding assembly, parts or operation, please visit our website at [www.berninifountains.com](http://www.berninifountains.com). You will find instructional videos on how to assemble and operate your fountain and keeps you up to date on our newest products. You can also email us with any questions you have. This product comes with a one year limited warranty against materials and workmanship.

**STEP 6. Assembly Of Bird Feeder:**

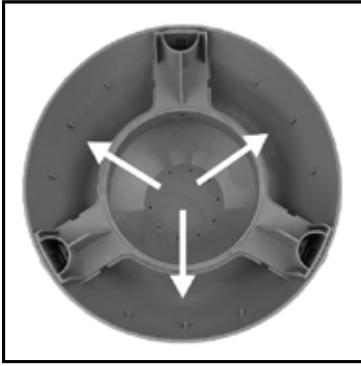

Figure 1



Figure 2



Figure 3



Figure 4

In this step you will install the 3 Bird Feeder Covers into the Base. These 3 Bird Feeder Covers install over the 3 holes in the base and enable you to fill the area with bird seed once the fountain is completely assembled (Figure 1-4).

Note: Be sure to place the Base of your fountain on a flat, firm surface. The 3 Bird Feeder Covers will install in the 3 areas marked with the arrows. All 3 covers are exactly the same.



Figure 5



Figure 6



Figure 7

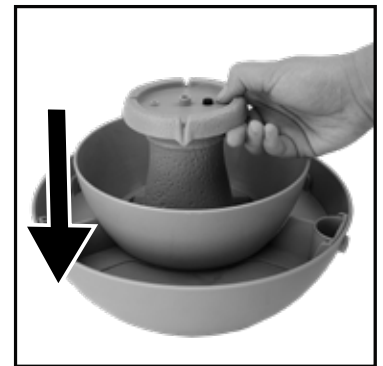

Figure 8

Insert Inner Water Bowl (Figure 5-7).

Insert the fully assembled Fountain Tower into the center of the Inner Water Bowl. There are two height options for the fountain (See Diagram 1a, Figure 9-10 and Figure 11-12 of step 7). To lower the height, align the feet of the Fountain Base to the bottom of the Inner Water Bowl. To raise the Fountain height, align the feet to the raised step on the Inner Bowl. Make sure the Fountain Tower is secure before proceeding to the next step.

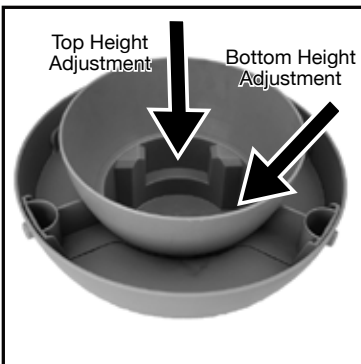

Figure 9

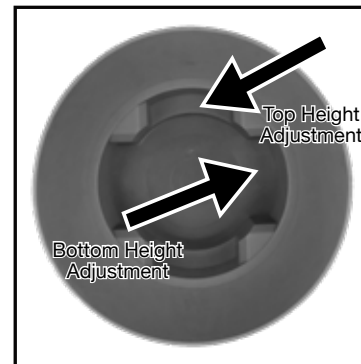

Figure 10



Figure 11

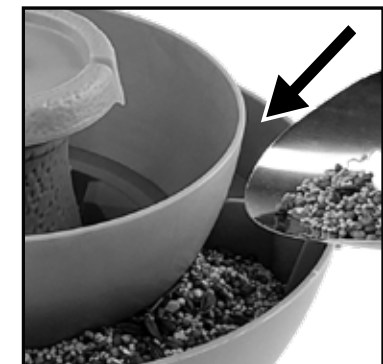

Figure 12

Fill Inner Water Bowl with water until it reaches the minimum water level ring on the Fountain Tower (see Diagram 1a and Figure 11).

Add bird seed to the Bottom Bowl (Figure 12). **Do not remove the Inner Water Bowl while there is bird seed in the Bottom Bowl (Figure 13).**

Insert the Wire Cable into the hole located on the side of the Bottom Bowl. Thread the other end of the Wire Cable through the loop and connect it to the Hook (Figure 14-16). Repeat this step for the other two Wire Cables (Figure 16).

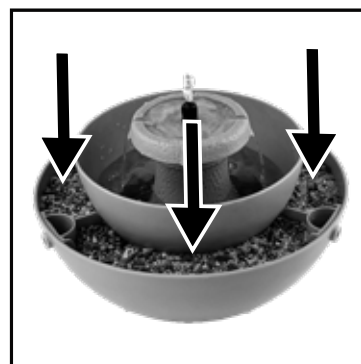

Figure 13

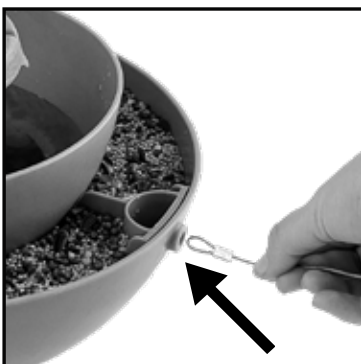

Figure 14

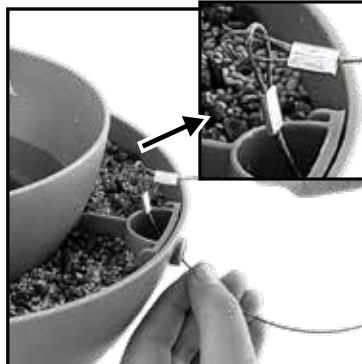

Figure 15

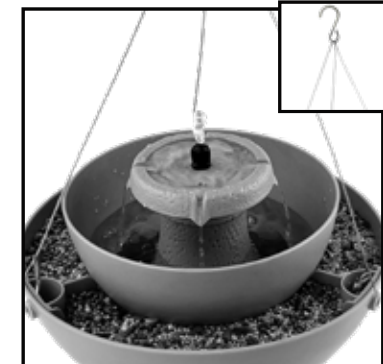

Figure 16

**STEP 7**  
**Assembly of Planter**

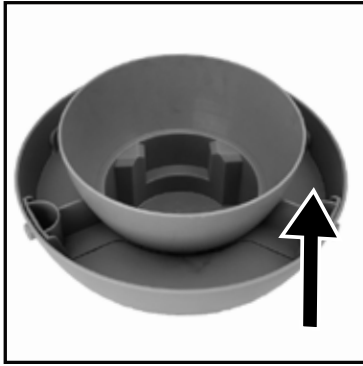

Figure 1



Figure 2



Figure 3

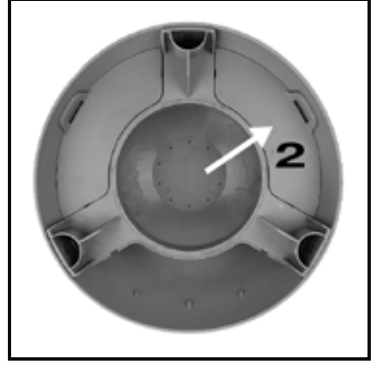

Figure 4

Take out Inner Water Bowl, remove any bird feed if converting from a bird feeder, remove the three Bird Feeder Covers in the Base (Figure 1-7) and reinsert the Inner Water Bowl (Figure 6). **Please Note: Please remove the packing material inside Fountain Tower that says "REMOVE BEFORE USE" (Figure 7).** Add soil and plants to the Base (arrows in Figure 13). Do not remove the Water Bowl while there is soil and plants in the Base.

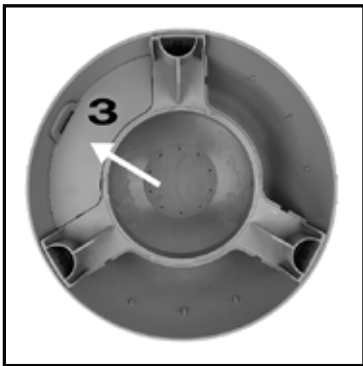

Figure 5

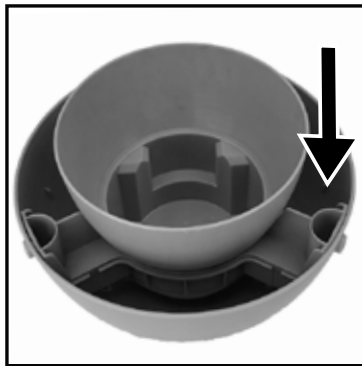

Figure 6



Figure 7



Figure 8

Insert the fully assembled Fountain Tower into the center of the Inner Water Bowl. There are two height options for the fountain (See Diagram 1a and Figure 9 and 10 of this step and 9-10 of step 6). To lower the height, align the feet of the Fountain Base to the bottom of the Inner Water Bowl. To raise the Fountain height, align the feet to the raised step on the Inner Water Bowl. Make sure the Fountain is secure before proceeding to the next step.



High Setting

Figure 9



Low Setting

Figure 10



Figure 11



Figure 12

Fill Inner Water Bowl with water till it reaches the minimum water level ring on the Fountain Base (Figure 11 and Diagram 1a).

Add soil to the Base. **Do not remove the Inner Water Bowl while there is soil in the Bottom Bowl (Figure 13).**

Insert the Wire Cable into the hole located on the side of the Base. Thread the other end of the Wire Cable through the loop and connect it to the Hook (Figure 14-16). Repeat this step for the other two Wire Cables (Figure 16).

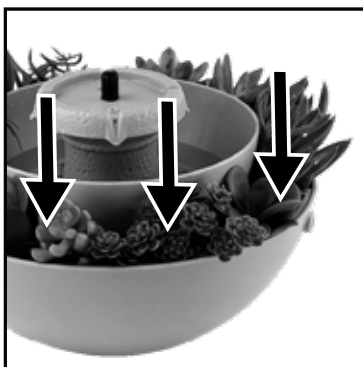

Figure 13

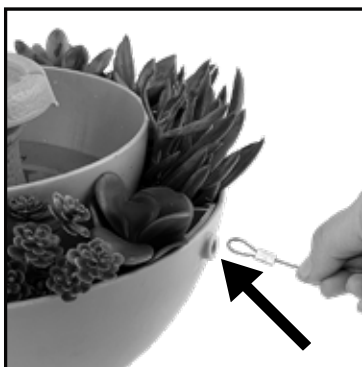

Figure 14

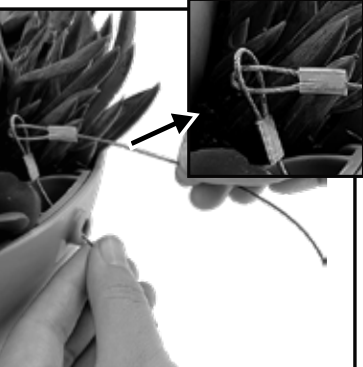

Figure 15



Figure 16