

BERNINI™

INNOVATIVE GARDEN

LAGO FOUNTAIN



2023

Owner's Manual

B E R N I N I[™]

INNOVATIVE GARDEN

NOTES:

B E R N I N I

INNOVATIVE GARDEN

PRODUCT REGISTRATION

Thank you for your purchase!

Bernini Fountains recommends you register your new fountain.

Online:

berninifountains.com/register, print and mail in a registration card

Via Phone: call our customer care department at 1+ (619) 449-2392

Via email:

customercare@berninifountains.com

Failure to register your fountain will not diminish your warranty rights. However, registering your fountain will allow Bernini Fountains to better serve you with any of your customer care needs.

PLEASE READ FIRST BEFORE RETURNING

- Please call us for assistance at 1+ (619) 449-2392 or email us at customer care@berninifountains.com
- Our Customer Care Department is available:
Monday - Friday 8:30am to 4:00pm PST, 11:30am to 7:00pm EST
- If you have any questions regarding assembly, parts or operation, please visit our website at www.berninifountains.com.
- At berninifountains.com you will find instructional videos on how to assemble and operate your fountain and you can view our newest products.
- This product comes with a one year limited warranty against materials and workmanship, see page 20.
- Please review the list of accessories included with your Bernini™ Fountain on the next page. Please note, images of parts are not to scale with one another.

About Lago

Lago is located in the mountainous interior of the Cosenza Province, near the slopes of Monte Cocuzzo. Despite being sited in mountainous territory, the higher elevations of the city offer views of the nearby coastline. A pre-historic tribe living in Cosenza called themselves the "Itali" and it was from them where Italy drew its name. They called their land, "Viteliu," which means "land of the life-giving calf."

PARTS

FOR YOUR BERNINI™ FOUNTAIN

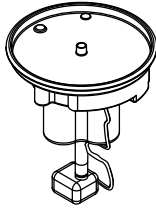

**Battery
Compartment,
Water Tube &
Water Pump**

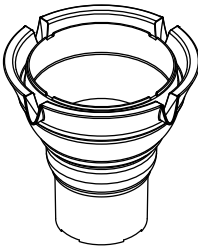

**Fountain
Tower**

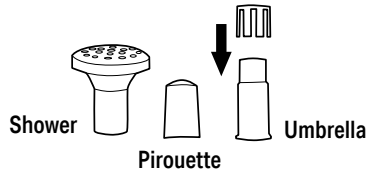

**Dancing Water
Attachments**

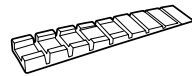

Leveling Shim

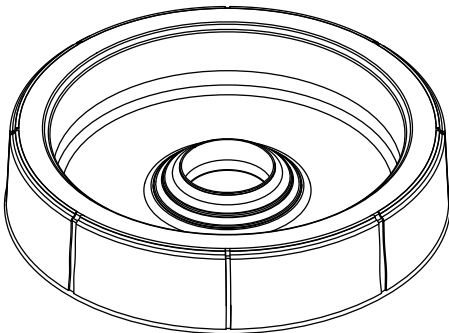

Base

**Items/Tools Required:
(Not Included)**

- Philips Screwdriver
- 4 D Cell Batteries

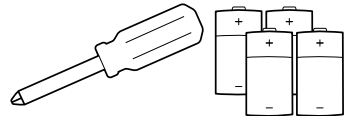

CONTENTS

	PAGE
STEP 1: BASE & FOUNTAIN TOWER	1
Base & Fountain Tower	2
STEP 2: BATTERY INSTALLATION.....	3
Inserting Batteries Into The Battery Compartment.....	4
Assembling Battery Compartment Housing & Battery Cover	5
Assembling Water Pump & Tube To Battery Compartment.....	7
Changing Batteries.....	7
STEP 3: SETTING UP YOUR FOUNTAIN	8
Fill Your Fountain.....	9
Operating Your Fountain.....	9
Dancing Water Attachments	11
STEP 4: FOUNTAIN PLACEMENT OPTIONS	12
Fountain Placement Options.....	13
TROUBLESHOOTING AND MAINTENANCE	15
Water Pump Connection.....	15
Priming the Water Pump.....	16
Using Leveling Shims.....	16
Cleaning Your Fountain	16
Cleaning Your Water Pump's Parts	17
Cold Storage.....	18
Troubleshooting Guide.....	19
Limited Warranty Information.....	20

STEP 1

BASE & FOUNTAIN TOWER

YOU WILL NEED:

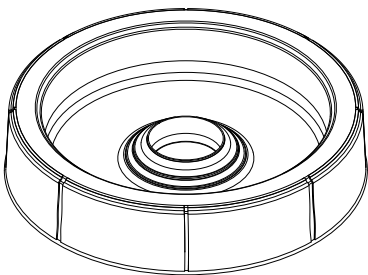

Base

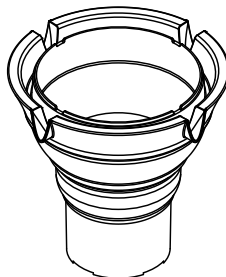

Fountain
Tower

BASE & FOUNTAIN TOWER

A look at how the base & bowl locking system works on your Fountain.

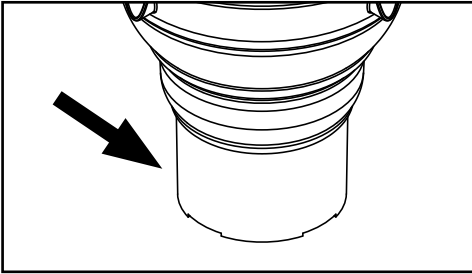

Bottom of Fountain Tower

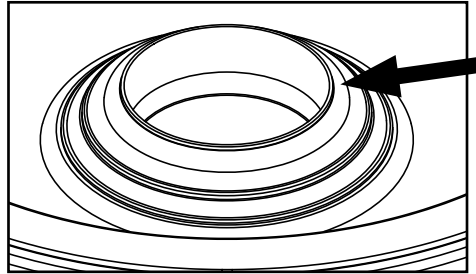

Top of the Base

Note: The bottom of the Fountain Tower fits into a recess in the middle of the base. Place the Base of your fountain on a flat, firm surface.

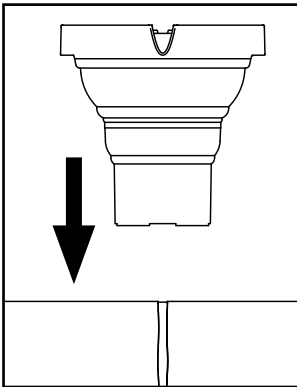

STEP 1.1 Set the Fountain Tower into the center water reservoir in the base.

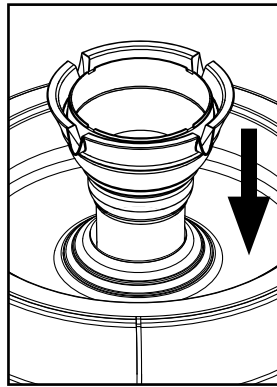

STEP 1.2 Ensure the Fountain Tower sets all the way down into the Base reservoir.

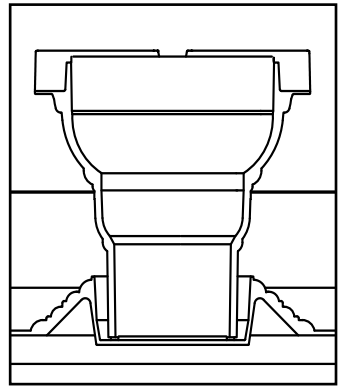

STEP 1.3 The Fountain Tower will set into the Base Reservoir as in the image above.



At this point, your fountain should look like this.

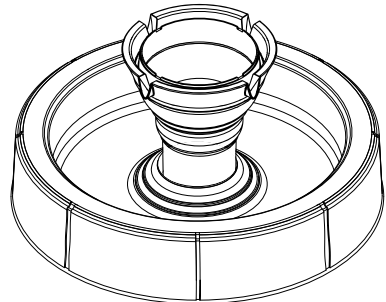

STEP 2

BATTERY INSTALLATION

YOU WILL NEED:

Items/Tools Required:
(Not Included)

- Philips Screwdriver
- 4 D Cell Batteries

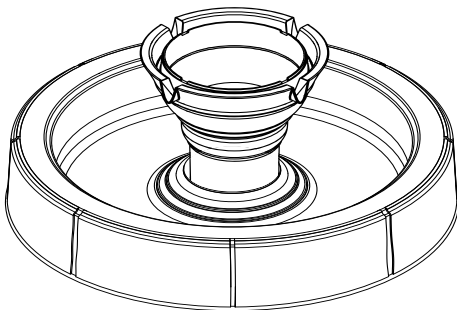
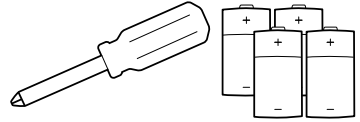

Fountain
Assembled

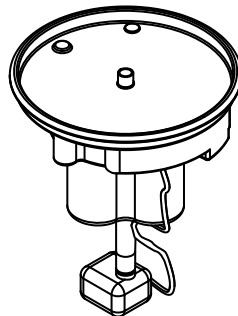

Battery Compartment
Water Tube & Water Pump

INSERTING BATTERIES INTO THE BATTERY COMPARTMENT

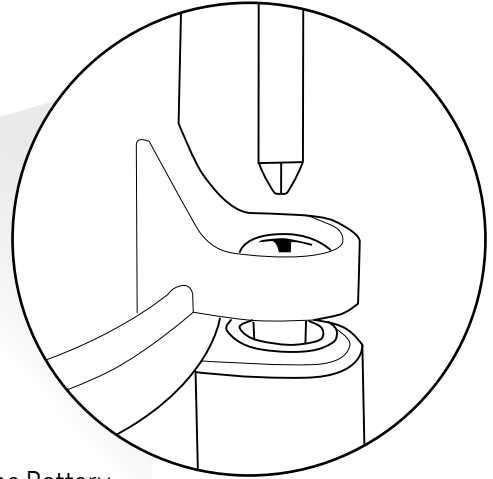
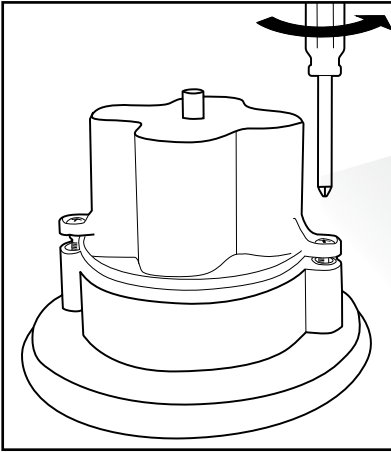

STEP 2.1 Unscrew (counter clockwise) the Battery Compartment Screws and open cover. Note: Cover fits tightly and may take some effort to separate. If screws continue to turn compartment is completely unscrewed.

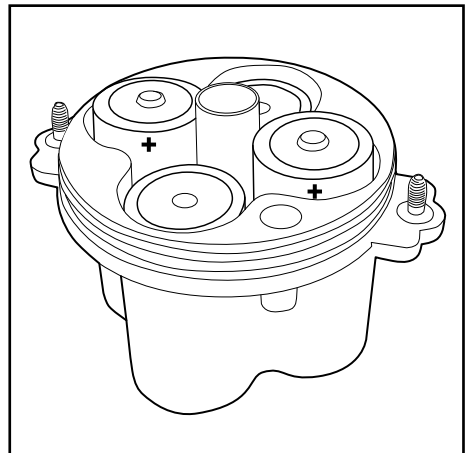
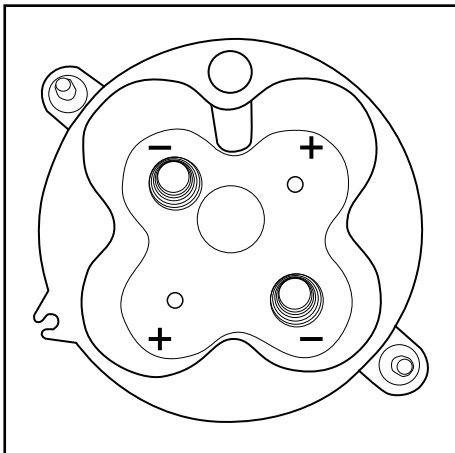

STEP 2.2 Fountain requires 4 D batteries (Not Included). Insert x2 D Batteries with the (+) side facing up in Battery Compartment and x2 D Batteries with the (-) facing up in Battery Compartment.

ASSEMBLING BATTERY COMPARTMENT HOUSING & COVER

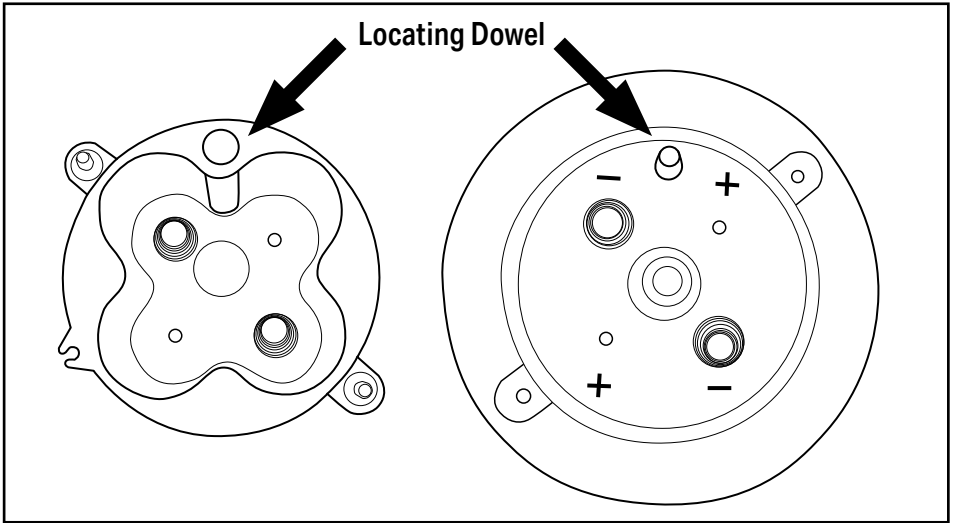

STEP 2.3 Reinstall the Fountain Top by aligning the locating dowel in the Battery Compartment and Fountain Top. Set the Battery Cover down onto the Battery Compartment ensuring the dowel sets into the alignment hole.

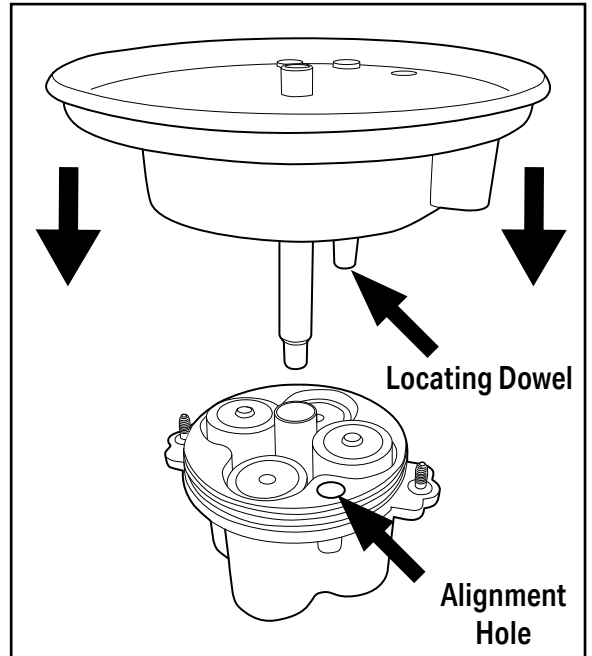

ASSEMBLING BATTERY COMPARTMENT HOUSING & COVER

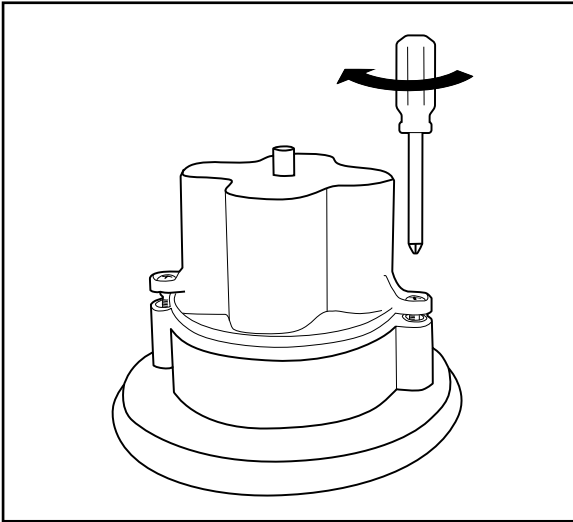

STEP 2.4 Apply pressure and tighten the Battery Cover Screws by turning clockwise.

NOTE: Pressure must be applied to the Battery Compartment while tightening the screws to assure the compartment is properly sealed. After both screws have been tightened, you may notice a small gap between the Battery Cover and the Battery Compartment Housing. Press down firmly on the bottom of the Battery Compartment Housing to help tighten the gap.

ASSEMBLING THE WATER PUMP & TUBE TO BATTERY COMPARTMENT

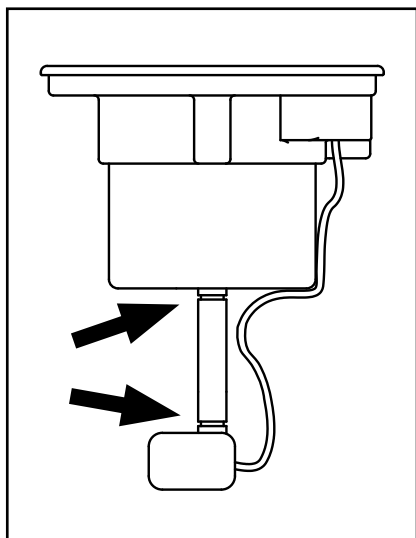

Figure A

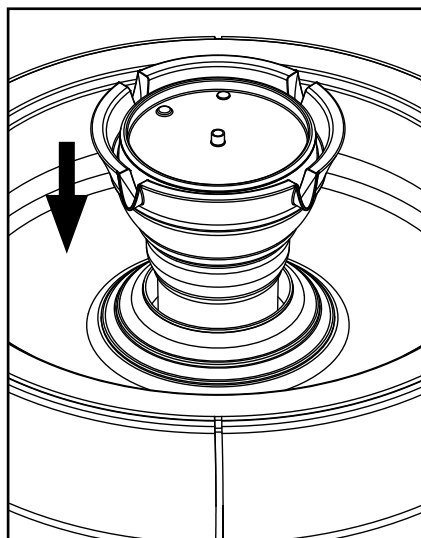

Figure B

STEP 2.5 Connect one side of the Water Tube to the Water Pump and the other end of the tube to the bottom side of the Battery Compartment (Figure A).

STEP 2.6 Lower the Battery Compartment and Water Pump into the Topper. Battery Compartment and Water Pump should be flush with Topper (Figure B).

CHANGING BATTERIES

- 1) Remove any Dancing Water Attachment
- 2) Lift Battery Compartment and Water Pump out of the Fountain.
- 3) Follow steps starting on Page 3 for "Battery Installation".

NOTE: When changing batteries, ensure Battery Compartment and Water Pump are completely dry before opening Battery Compartment to prevent water from getting inside.

STEP 3

SETTING UP YOUR FOUNTAIN

YOU WILL NEED:

WATER TO FILL
YOUR FOUNTAIN

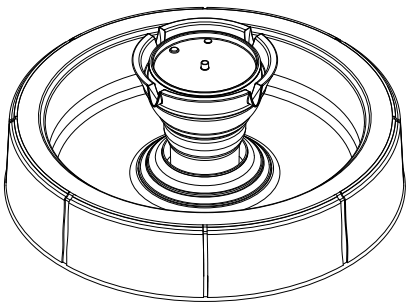

**Fountain
Assembled**

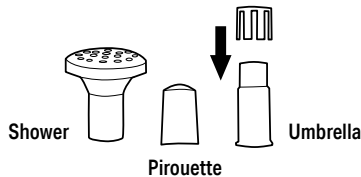

**Dancing Water
Attachments**

FILL YOUR FOUNTAIN

- Fill the large bowl until the water is 1 inch (2.5 centimeters) from the top of the bowl (Figure B next page).
NOTE: Ensure water is maintained above minimum water level.
- To dislodge any air bubbles from the pump, grab both sides of the large bowl and quickly shake your fountain for ten seconds.
- Press the button once to turn your fountain on. Water should be flowing from the top of your fountain.
- If water is not flowing, press the button once more to turn your fountain off and repeat the step above.

OPERATING YOUR FOUNTAIN

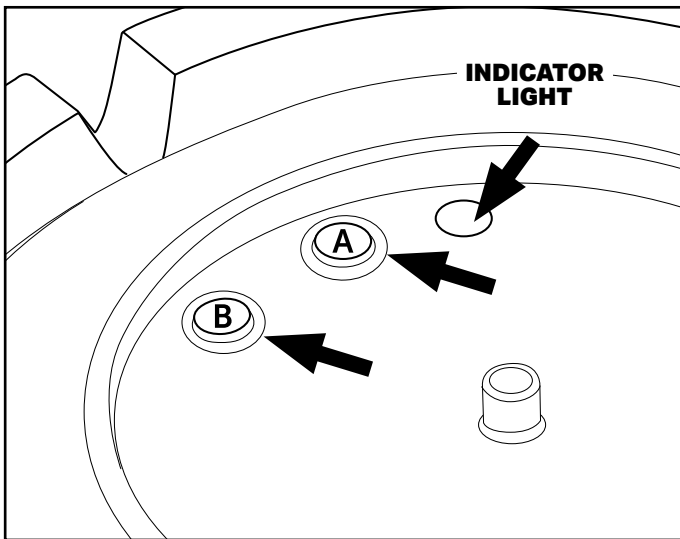

Figure A

Turn Fountain on and off:

- The A Button is the manual on and off button.
- **With the Fountain off, press the A button:** The fountain will run for a maximum of 6 hours or until the A button is pressed again which will shut the fountain off.

OPERATING YOUR FOUNTAIN (CONTINUED)

Programing The Fountain:

- **Press the A Button 2 times:** Clears out all programming.
- **Press the B Button 1 time:** Will program the fountain to run for 1 hour each day at the same time. The light (Figure C), will flash once to confirm your selection.
- **Press the B Button 2 times:** Will program the fountain to run for 2 hours each day at the same time. The light (Figure C), will flash twice to confirm your selection.
- **Press the B Button 3 times:** Will program the fountain to run for 3 hours each day at the same time. The light (Figure C), will flash 3 times to confirm your selection.
- **Press the B Button 4 times:** Will program the fountain to run for 4 hours each day at the same time. The light (Figure C), will flash 4 times to confirm your selection.
- **Pressing the B Button more than 4 times:** Pressing the B Button more than 4 time will start this process over.

Reset/Change the timer:

- Press the A button twice to clear out any timers programmed into the B Button. If you want to reset the timer, set the B Button Programing as in the "Programing The Fountain" Section above (Figure A).

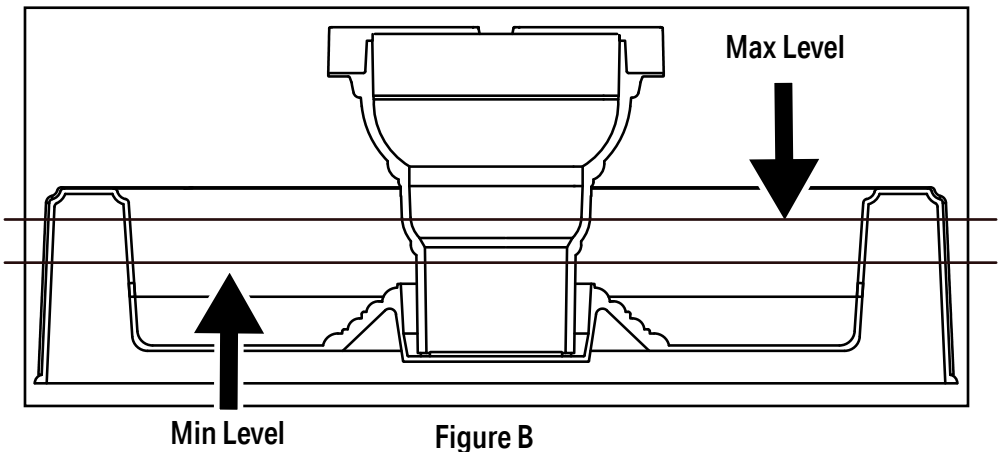

DANCING WATER ATTACHMENTS

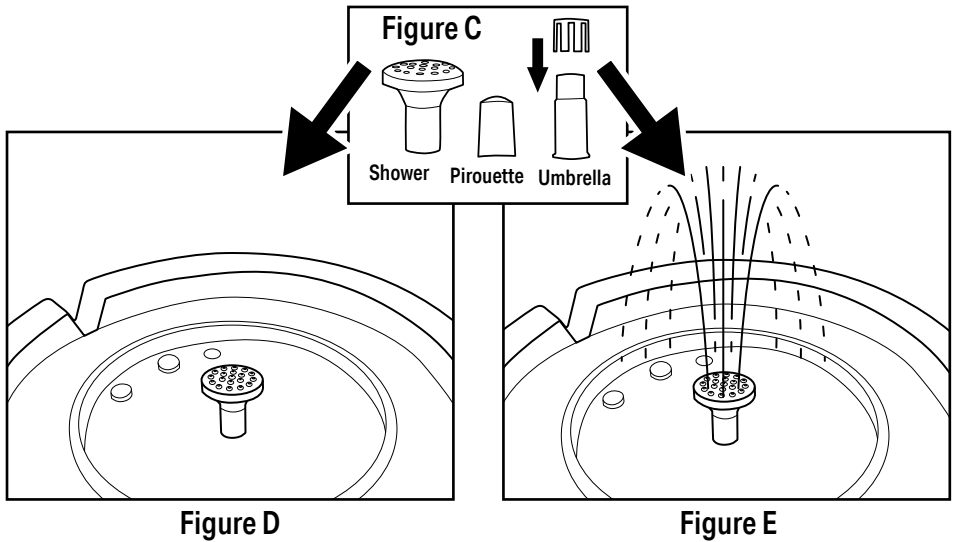

DANCING WATER ATTACHMENTS: (OPTIONAL)

You can put any of the Dancing Water Attachments on the Fountain whether the Fountain is running or is not running.

- Select one of the Dancing Water Attachments and place on the outlet in the middle of the Battery Compartment (Figure C, D, & E).

NOTE: Please be aware that there is over spray that occurs while using the Dancing Water Attachments.



You can now try your fountain to see if everything is working correctly! Turn your fountain on and you should see water flowing from the outlet on the top of the Topper. **If water is not flowing, please refer to the "Priming The Water Pump" in the "Troubleshooting & Maintenance" Section.**

STEP 4

FOUNTAIN PLACEMENT

YOU WILL NEED:

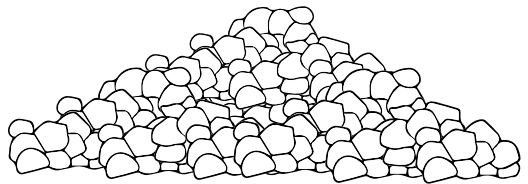

Rocks (Optional)-Not Included

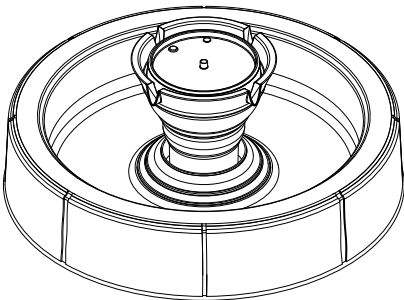

**Fountain
Assembled**



Mulch (Optional)-Not Included

FOUNTAIN PLACEMENT OPTIONS

Pick a location for your Lago Fountain, make sure the location is nice and level with enough space around it:

STEP 4-1:

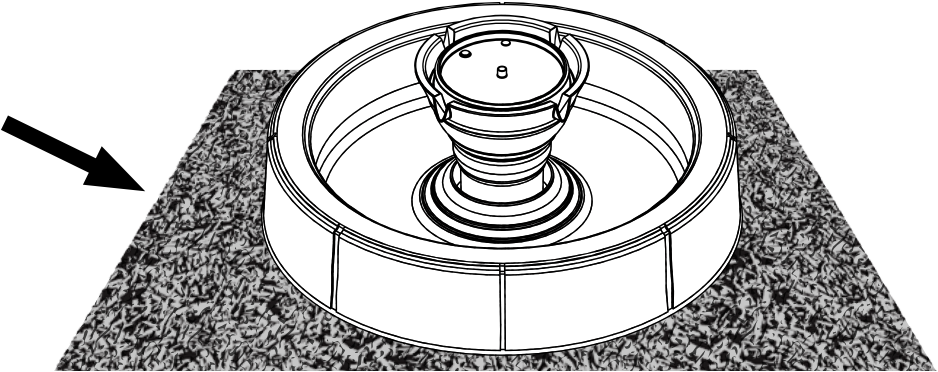

Figure 1

Set on top of level firm ground or pavement (Figure 1).

STEP 4-2:

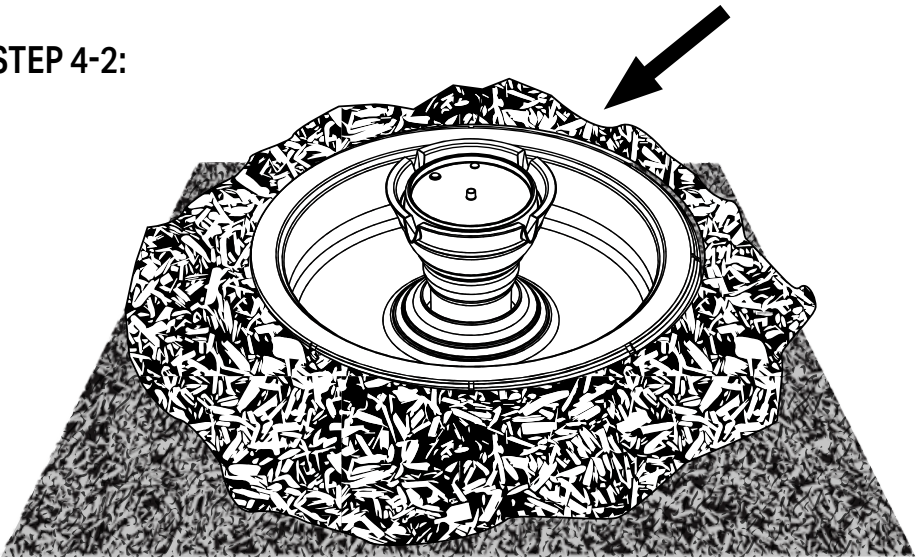

Figure 2

Set in the ground and fill surrounding area with mulch, soil, or rocks

FOUNTAIN PLACEMENT OPTIONS

STEP 4-3:

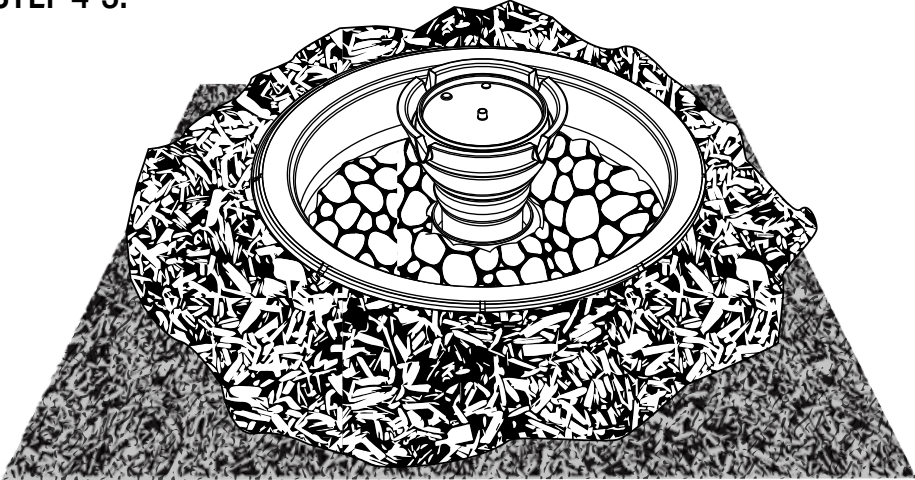
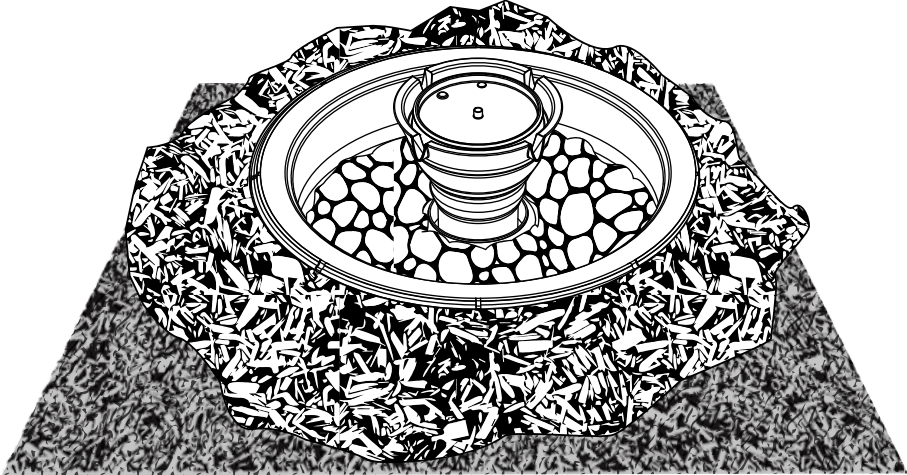

Figure 3

Place pebbles in bowl around the Tower Guard



At this point, your fountain should look like this.



TROUBLESHOOTING AND MAINTENANCE

WATER PUMP CONNECTION

If your fountain's water pump tube becomes disconnected from pump and or Battery Compartment use these instructions to reconnect your water pump.

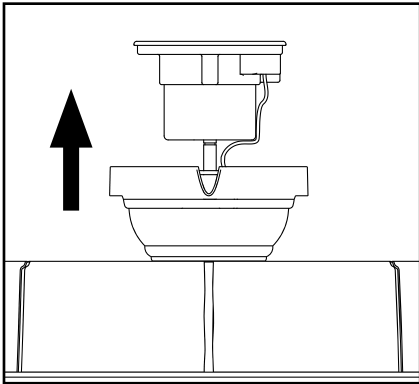

Before beginning, remove the Battery Assembly from Topper. Step 1: Lift the Battery Assembly out of the Topper to access pump and tube.

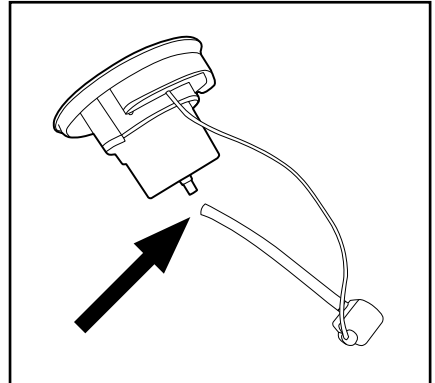

Step 2: Rest the Battery and Pump Assembly on its side. Check the connection at the top of the water tube at the Battery Housing. Re connect if needed.

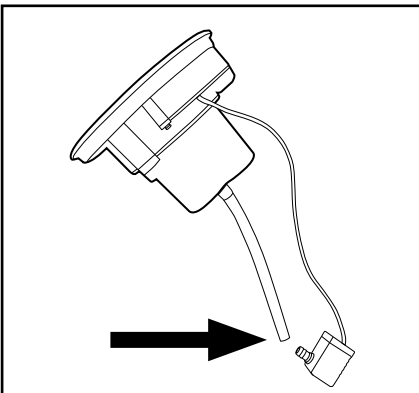

Step 3: Check the connection at the bottom of the water tube at the Water Pump. Re connect if needed.

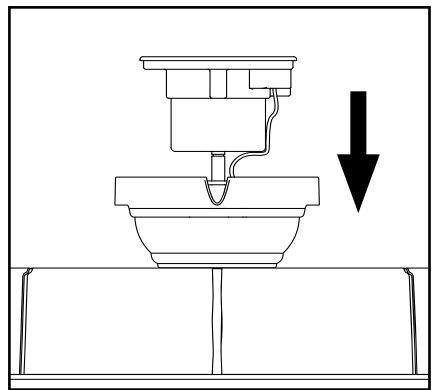

Step 4: Reassemble the Battery and Pump Assembly in reverse of removal or refer to the instructions in the Battery and Pump Assembly section of this manual.

PRIMING THE WATER PUMP

If you find the Water Pump is running, but water is not flowing from your Fountain, you can try priming the Water Pump:

- **Turn off Fountain:** Grab both sides of the Fountain and quickly shake your Fountain for ten seconds. This is to dislodge any air bubbles that may be caught in your Water Pump.
- **Press the button to turn your Fountain on:** Water should be flowing from the top of your fountain. If water is not flowing, **Press and hold button for over 2 seconds again to turn your Fountain off** and repeat the step above.

USING LEVELING SHIMS

If you are having trouble getting water to flow evenly off of the edge of your fountain, you may need to level the surface that your fountain is placed on. With the included leveling shims, you do not need to move your fountain, just follow the instructions below to get even water flow.

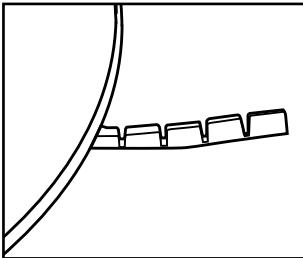

Place the shim underneath the base on the opposite side that is not flowing as strongly as the other sides.

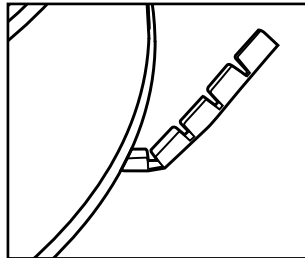

Grasp the shim and break it on the crease closest to the end of the base.

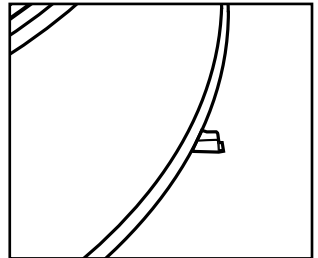

Once the shim is broken, it will be hidden but will level your fountain.

CLEANING YOUR FOUNTAIN

To keep your fountain in tip top shape and for a prolonged life It is important to keep your fountain clean.

Periodically clean the fountain, bowl or water container that the fountain is placed in.

CLEANING YOUR FOUNTAIN (CONTINUED)

- To clean your fountain, drain of all water and disassemble
- Use a mild soap and a soft cloth to clean the parts of your fountain.
- DO NOT SCRUB YOUR FOUNTAIN, THIS COULD CAUSE DAMAGE TO THE FINISH OF YOUR FOUNTAIN.

CLEANING YOUR WATER PUMP'S PARTS

After about six weeks of usage, clean the water pump's impeller to keep your fountain in tip-top shape. The water pump impeller inside of the water pump is what pushes water up through the fountain. Clean the water pump impeller to make sure your fountain runs optimally.

- Drain the fountain of all water prior to cleaning the water pumps' parts.

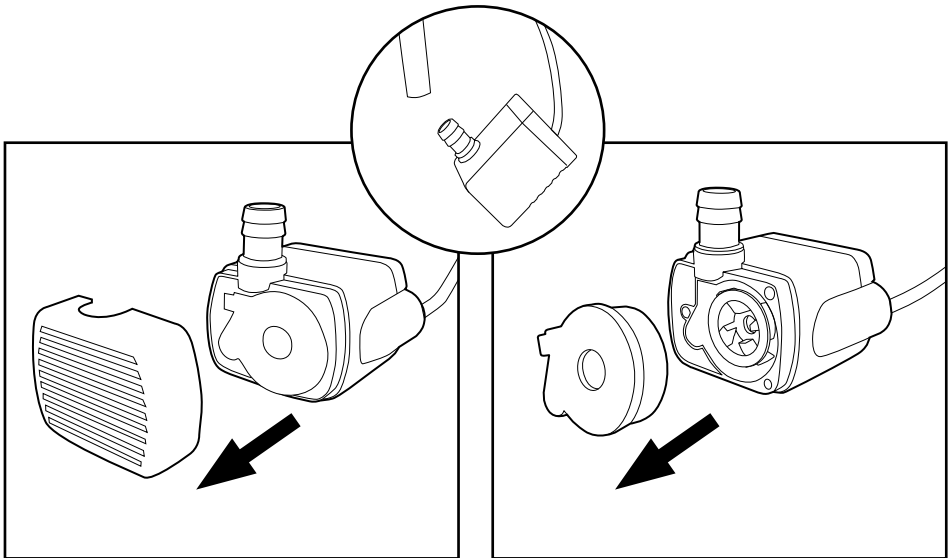

Begin by disconnecting the pump from the water tube. (See inset image)

Step 1: Remove the front of the water pump by grabbing the sides of the front panel and pull it off the unit.

Step 2: Remove the impeller chamber cover. This is tightly fitted on to the impeller chamber, but will come off.

CLEANING YOUR WATER PUMP IMPELLER (CONTINUED)

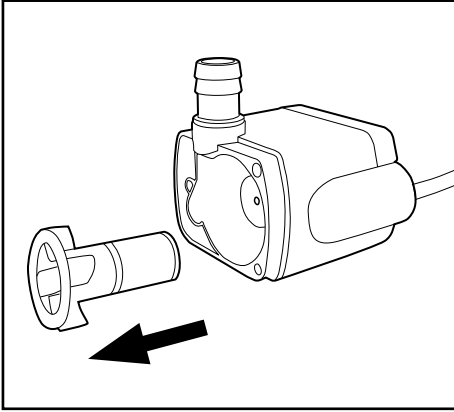

Step 3: Remove the impeller from its chamber.

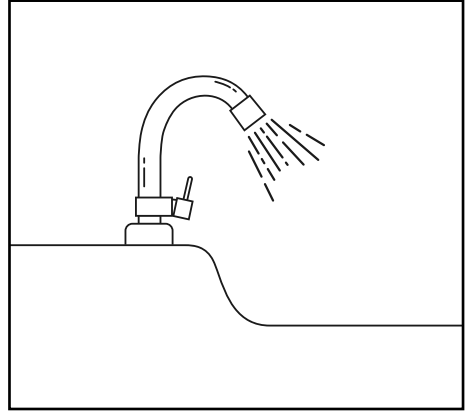

Step 4: Rinse the impeller and the impeller chamber until all debris has been removed.

Reassembly is the reverse of disassembly.

- Replace the impeller in the impeller chamber.
- Put the impeller chamber cover back on.
- Replace the pump's front panel.

COLD STORAGE

- Turn power off
- Remove fountain from container.
- Clean and dry the fountain of all water.
- Remove the batteries for long term storage and bring the fountain indoors.

Now is a great time to clean the pump to remove any debris that may have

TROUBLESHOOTING CHECKLIST

PROBLEM	SOLUTION
Fountain is not working	Check that batteries have a full charge: (See Changing Battery Section).
Water Not Flowing	Prime Pump as instructed. (Refer to Priming The Water Pump).
	Check batteries are installed correctly: (See Installing Battery Section).
	Check that batteries have a full charge: (See Changing Battery Section).
	Check water level.
	Check pump is free of debris, kinks or obstructions. (See Troubleshooting section).
	Check water tube is connected properly. (See Base and Fountain Bowl Installation Section).
Loud Pump	Prime Pump as instructed. (Refer to Priming The Water Pump Section)
	Check water level.
	Check pump is free of debris, kinks or obstructions. (See Troubleshooting section)
Fountain Settings not working	Check that batteries have a full charge: See Changing Battery Section.
Low Water Flow	See Changing Battery Section.
	Check pump is free of debris, kinks or obstructions. See Troubleshooting section.
	Check water level.
	Pump is cavitating. See Priming The Water Pump Section.
Suddenly Stops	Check pump is free of debris, kinks or obstructions. See Troubleshooting section.

WARRANTY

LIMITED ONE YEAR WARRANTY

This product has a one year limited warranty on all materials and workmanship. Bernini™ warrants the original purchaser of this product that the product will be free from manufacturing defects in workmanship and material for a period of one (1) year from the date of original purchase.

If within one (1) year this product fails due to defect in material or workmanship, Bernini™ will repair, replace or supply any defective part at their discretion.

The purchaser must contact Bernini™ and provide a description of the defective part, including digital pictures if requested, with this original purchase documentation as validation of warranty coverage.

This warranty does not cover or apply to: (a) damage to the product due to misuse, mishandling, and abuse, (b) products not used in accordance with instructions, (c) product not assembled or installed according to instructions, and (d) normal wear and tear.

Call for assistance at 1+ (619) 449-2392 or you can email us at:
customercare@berninifountains.com

Our Customer Care Department is available:
Monday - Friday 8:30am to 4:00pm PST / 11:30am - 7:00pm EST

BATTERY SAFETY

IMPORTANT BATTERY SAFETY INSTRUCTIONS

DANGER: Do not store battery in an airtight container as it may cause an explosion.

WARNING: When using electric devices, basic safety precautions should always be followed to reduce the risk of fire, electric shock and personal injury, including the following:

1. Do not incinerate the battery even if it is severely damaged or is completely worn out.
 - The battery can explode in a fire.
 - Check with municipal codes in your area for possible special battery disposal instructions.
2. If liquid leaks from the battery cell, discontinue use immediately and dispose of batteries properly.
3. Use only 4-1.5V D Cell Batteries.
4. Do not attempt to disassemble, remodel or destroy the batteries, as it may cause battery leakage, fire, or bursting.
5. Never dispose of batteries in the garbage.
 - Disposal of batteries in the garbage is unlawful under state and federal environmental laws and regulations.
 - Always take used batteries to your local battery-recycling center.
6. Do not mix old and new batteries. Do not mix alkaline, standard (Carbon-zinc), or rechargeable (Ni-Cd, Ni-Mh, etc) batteries.

BERNINI™

INNOVATIVE GARDEN

THANK YOU FOR SELECTING BERNINI FOUNTAINS

We're excited to offer you the highest quality fountains with the reliability you need! We would love to hear if you have any suggestions or ideas that can be incorporated into new or enhanced features. We hope you have many years of enjoyment from your fountain and we look forward to hearing from you.



Scan this QR code for the latest version of these instructions

Scan the below image to Register Your warranty.



Or go to:
www.berninifountains.com/register



PHONE:
1+ (619) 449-2392



EMAIL:
customercare@berninifountains.com



WEB:
www.berninifountains.com



FB: Bernini Fountain Company



PINTEREST: Bernini Fountain Company



INSTAGRAM:
[@berninifountains](https://www.instagram.com/berninifountains)



TWITTER:
[@yrdllc](https://twitter.com/yrdllc)

Santee, California 92071

World Wide Patents Pending

© Yeiser Research & Development, LLC; 2023. All rights reserved.

Made in China
Designed in the USA

001356 BLFI rev 1a us