

## ① Assembling The Bird Feeder

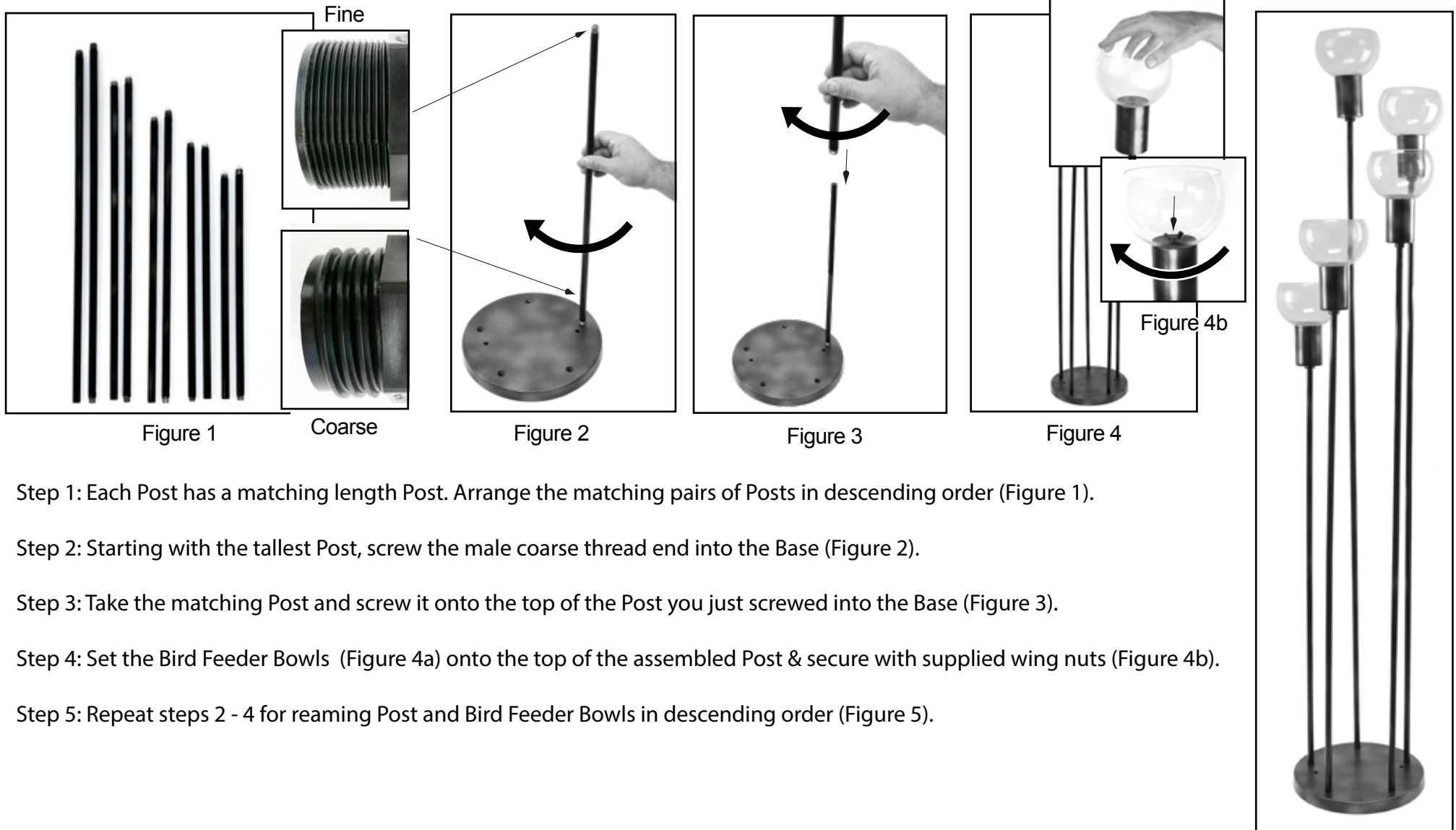

Step 1: Each Post has a matching length Post. Arrange the matching pairs of Posts in descending order (Figure 1).

Step 2: Starting with the tallest Post, screw the male coarse thread end into the Base (Figure 2).

Step 3: Take the matching Post and screw it onto the top of the Post you just screwed into the Base (Figure 3).

Step 4: Set the Bird Feeder Bowls (Figure 4a) onto the top of the assembled Post & secure with supplied wing nuts (Figure 4b).

Step 5: Repeat steps 2 - 4 for reaming Post and Bird Feeder Bowls in descending order (Figure 5).



Figure 6



Figure 7

Step 6: Fill all Bowls with your choice of bird food (Figure 6).

**OPTIONAL:** When not using on deck or hard surface recommended to insert included lawn stakes into the stake holes located on the base to secure to ground or uneven surfaces (Figure 7).

#### **LIMITED ONE YEAR WARRANTY**

This warranty gives you specific legal rights and you may also have other rights which vary from state to state. This product has a one year limited warranty on all materials and workmanship. Bernini® warrants the original purchaser of this product that the product will be free from manufacturing defects in workmanship and material for a period of one (1) year from the date of original purchase. If within one (1) year this product fails due to defect in material or workmanship, Bernini® will repair, replace or supply any defective part at their discretion. The purchaser must contact Bernini® and provide a description of the defective part, including digital pictures if requested, with this original purchase documentation as validation of warranty coverage. This warranty does not cover or apply to: (a) damage to the product due to misuse, mishandling, and abuse, (b) products not used in accordance with instructions, (c) product not assembled or installed according to instructions, and (d) normal wear and tear. Call us for assistance at +1 (619) 449-2392 or you can email or mail us at: 9545 Pathway Street, Santee, CA 92071, [customercare@berninifountains.com](mailto:customercare@berninifountains.com), Our Customer Care Department is available: Monday - Friday 8:30am to 4:00pm PST / 11:30am - 7:00pm EST

#### **Please read first before returning:**

Please call us for assistance at 1-619-449-2392 or email us at [customercare@berninifountains.com](mailto:customercare@berninifountains.com). Our Customer Care Department is available: Monday - Friday 8:30am to 4:00pm PST, 11:30am to 7:00pm EST. If you have any questions regarding assembly, parts, or operation, please visit our website at [www.berninifountains.com](http://www.berninifountains.com). You will find instructional videos on how to assemble and operate your fountain, and keeps you up to date on our newest products. You can also email us with any questions you have. This product comes with a one year limited warranty against materials and workmanship.