

Galvanised Planters - Typical Specification

Materials	
Metal	0.8 Gauge Pre-Galvanised steel sheets (0.9 - 1mm thickness)
Fabriaction	
Seams	All seams are fabricated by way of a 'lockform' arrangement
Corners	All corners are fixed with rivets and a triangular corner plate.
Drainage & Liners	As standard our planters are made with drainage holes (10mm D) in the bases and are not water tight. Planters can be specified without drainage holes or PVC Liners

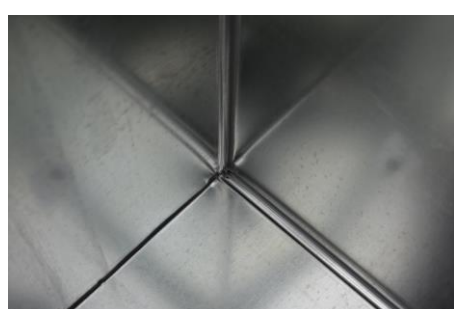

Seams



Corners



Drainage

Maximum sizes	
Troughs	1950 x 700 x 700mm (L x W x H)
Tapered	1000 x 1000 x 1000mm (L x W x H)
Cylinders	1000 x 1000 x 1000mm (L x W x H)

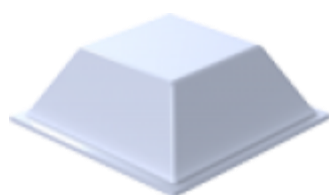

Planters are supplied with 7mm deep stick-on plastic feet (20mm wide), clear plastic.

