

# VISION 156

PORTABLE VIDEO ENTERTAINMENT SYSTEM

## Quick Start Guide

For complete operational guidelines, please refer to your user manual.

Basic Setup

### GETTING STARTED

- Flip the power switch to ON to check current battery level.
- The LED battery indicator will turn on.
- The unit will enter into "Setup Wizard" mode, please choose "Home" for regular use.

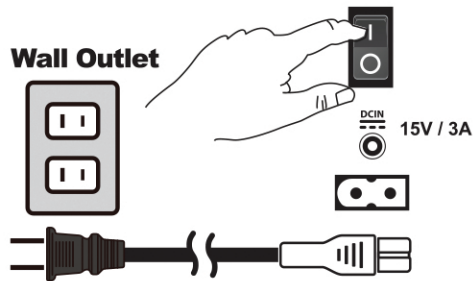

### BLUETOOTH CONNECTION

#### Manual Bluetooth Pairing

- Place speaker and Bluetooth device within 3 feet of each other.
- Make sure the Bluetooth function is enabled on your device.
- Press and hold the Bluetooth button for 2 seconds to enter pairing mode. BLUE LED will flash.
- Search for Bluetooth devices on you device. Select "MONSTER VISION156".

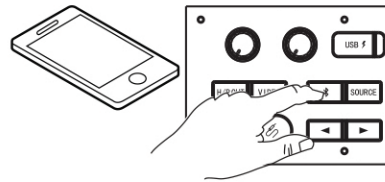

### AUX INPUT

- Plug in the 3.5 mm Stereo Audio wire into the AUDIO input,
- Press AUDIO key and the unit will enter into AUX mode. BT LED indicator will turn off.
- You can connect any audio device that has a 3.5 mm audio output jack, and can playback any audio from the connected device.

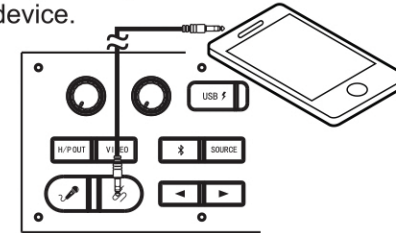

Source

### SOURCE SWITCHING KEY

- Main unit has 4 Sources (Display/Bluetooth/Aux in/Radio)  
Press "Source" key on remote control to change between source DISPLAY/FM/AUX/BT sequence: DISPLAY/FM/AUX/BT
- The main unit supports 4 sources under audio mode:
  1. Display source (default source);
  2. FM source;
  3. AUX IN source;
  4. Bluetooth source.
- If Main unit is on in Display mode, it will have 4 sub-sources in Display mode. Press the video key on the unit OR press "TV"/"HDMI"/"USB" button on Remote Control to change source between "TV"/"HDMI1"/"HDMI2"/"USB"; the related source message will show on TV screen;

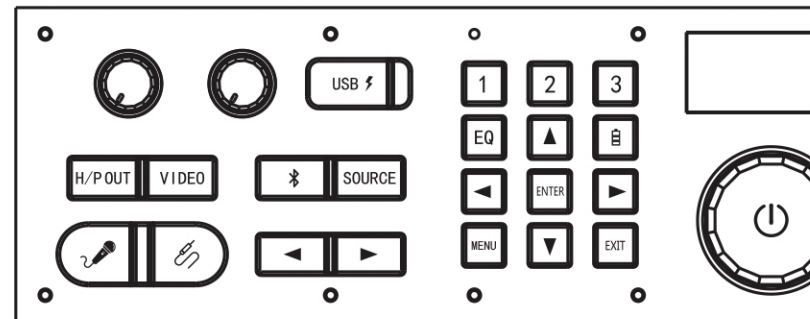

\*If the unit is not in use, power should be switched off  
\*Unit should be recharged every 2 months if not in constant use.