

M MONSTER[®]

VISION 156

PORTABLE VIDEO ENTERTAINMENT SYSTEM



User Manual

TABLE OF CONTENTS

FCC Warning Statement	3
Important Safety Instructions	3
Contents	5
Speaker Components	5
Getting Started	6
Source Switching Key	6
Bluetooth Connection	6
Headphone Output	7
Mic Input	7
AUX Input	7
FM Radio	8
USB Charging	8
USB Player	8
EQ Presets Audio	8
EQ Presets Video	8
Multimedia Compatibility	9
Standby Function	9
Wakeup Function	9
Specifications	10
Limited Warranty	11

FCC WARNING STATEMENT

Changes or modifications not expressly approved by the party responsible for compliance could void the user's authority to operate the equipment.

This equipment has been tested and found to comply with the limits for a Class B digital device, pursuant to Part 15 of the FCC Rules.

These limits are designed to provide reasonable protection against harmful interference in a residential installation. This equipment generates, uses, and can radiate radio frequency energy and, if not installed and used in accordance with the instructions, may cause harmful interference to radio communications. However, there is no guarantee that interference will not occur in a particular installation. If this equipment does cause harmful interference to radio or television reception, which can be determined by turning the equipment off and on, the user is encouraged to try to correct the interference by one or more of the following measures:

- Reorient or relocate the receiving antenna.
- Increase the separation between the equipment and receiver.
- Connect the equipment into an outlet on a circuit different from that to which the receiver is connected.
- Consult the dealer or an experienced radio/TV technician for help.

FCC Radiation Exposure Statement

This equipment complies with FCC radiation exposure limits set forth for an uncontrolled environment. In order to avoid the possibility of exceeding the FCC radio frequency exposure limits, Human proximity to the antenna shall not be less than 20cm (8 inches) during normal operation.

IMPORTANT SAFETY INSTRUCTIONS

TO PREVENT FIRE OR SHOCK HAZARD, DO NOT USE THIS PLUG WITH AN EXTENSION CORD, RECEPTACLE OR OTHER OUTLET UNLESS THE BLADE CAN BE FULLY INSERTED TO PREVENT BLADE EXPOSURE. TO PREVENT FIRE OR SHOCK HAZARD, DO NOT EXPOSE THIS APPLIANCE TO RAIN OR MOIST.

TO PREVENT FIRE OR SHOCK HAZARD, DO NOT USE THIS PLUG WITH AN EXTENSION CORD, RECEPTACLE OR OTHER OUTLET UNLESS THE BLADE CAN BE FULLY INSERTED TO PREVENT BLADE EXPOSURE. TO PREVENT FIRE OR SHOCK HAZARD, DO NOT EXPOSE THIS APPLIANCE TO RAIN OR MOIST.

 <p>The lightning flash with arrow-head symbol, within an equilateral triangle is intended to alert the user to the presence of insulated "dangerous voltage" within the product's enclosure that may be of sufficient magnitude to constitute a risk of electric shock to persons.</p>	<p style="text-align: center;">CAUTION</p> <p style="text-align: center;">RISK OF ELECTRIC SHOCK DO NOT OPEN</p> <p>WARNING: TO REDUCE THE RISK OF ELECTRIC SHOCK DO NOT REMOVE COVER (OR BACK), NO USER SERVICEABLE PARTS INSIDE REFER SERVICING TO QUALIFIED SERVICE PERSONNEL.</p>	 <p>The exclamation point within an equilateral triangle is intended to alert the user to the presence of important operating and maintenance (servicing) instructions in the literature accompanying the appliance.</p>
--	---	---

Important Safety Instructions

- 1) Read these instructions – All the safety and operating instructions should be read before this product is operated.
- 2) Keep these instructions – The safety and operating instructions should be retained for future reference.
- 3) Heed all warnings - All warnings on the appliance and in the operating instructions should be adhered to.
- 4) Follow all instructions – All operating and use instructions should be followed.

- 5) This apparatus can be used in wet location conditions after disconnected the AC Mains supply and closing the water proof cap for the AC inlet. It must not be used in wet location conditions when charging. Do not use this apparatus near water-The appliance should not be used near water or moisture – for example, in wet basement or near a swimming pool.
- 6) Clean only with dry cloth.
- 7) Do not block any ventilation openings, install in accordance with the manufacturer’s instructions.
- 8) Do not install near any heat sources such as radiations, heat registers, stoves, or other apparatus (including amplifiers) that produce heat.
- 9) Do not defeat the safety purpose of the polarized or grounding plug. A polarized plug has two blades with one wider than the other. A grounding plug has two blades and a third grounding prong. The wide blade or the third prong is provided for your safety. If the provided plug does not fit into your outlet, consult an electrician for replacement of the obsolete outlet.
- 10) Protected the power cord from being walked on or pinched particularly at plugs, convenience receptacles, and the point where they exit from the apparatus.
- 11) Only use attachments/accessories specified by the manufacturer.
- 12) Use only with the cart, stand, tripod, bracket, or table specified by the manufacturer, or sold with the apparatus. When a cart or rack is used, use caution when moving the cart/apparatus combination to avoid injury from tip-over.



- 13) Unplug this apparatus during lighting storms or when unused for long periods of time.
- 14) Refer all servicing to qualified service personnel. Servicing is required when the apparatus has been damaged in any way, such as power-supply cord or plug is damaged, liquid has been spilled or objects have fallen into the apparatus, the apparatus has been exposed to rain or moisture, does not operate normally, or has been dropped.
- 15) Mains plug is used as the disconnect device, the disconnect device shall remain readily operable.
- 16) Do not install this equipment in a confined or building-in space such as a book case or similar unit, and remain a well ventilation conditions at open site. The ventilation should not be impeded by covering the ventilation openings with items, such as newspapers, table-cloth, curtains, etc.
- 17) No naked flame sources, such as lighted candles, should be placed on the apparatus.
- 18) Attention should be drawn to the environmental aspects of battery disposal.
- 19) The use of apparatus in moderate climate.
- 20) The apparatus shall not be exposed to dripping or splashing and that no objects filled with liquids, such as vases, shall be placed on the apparatus.

WARNING: To reduce the risk of fire or electric shock, do not expose this apparatus to rain or moisture.

WARNING: The batteries shall not be exposed to excessive heat such as sunshine, fire or the like.

CAUTION: Danger of explosion if battery is incorrectly replaced. Replace only with the same or equivalent type.

-  Protective earthing terminal. The apparatus should be connected to a mains socket outlet with a protective earthing connection.



CONTENTS

This box includes the following items:

- Monster Vision156
- AC Power Cable
- Remote Control
- User Manual (incl. Warranty Statement)
- Quick Start Guide
- Micro USB Cable
- TV Tuner Antenna
- Cloth Bag

REMOTE CONTROL

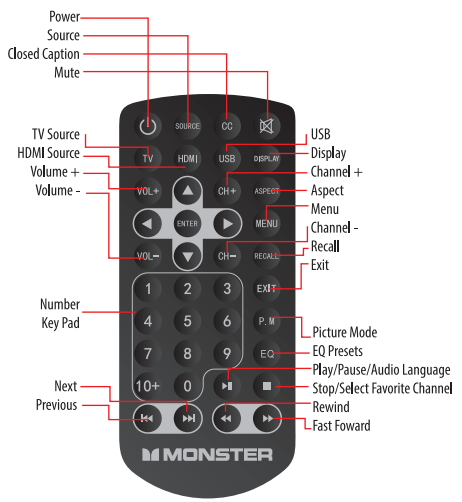

SPEAKER COMPONENTS

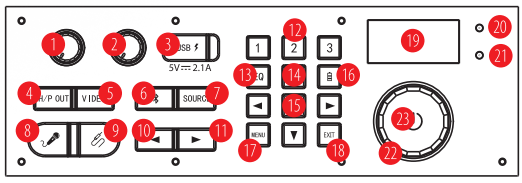

If any items are missing, contact our customer service team at 1.800.976.0677.

- | | | |
|----------------------|------------------------|-------------------------|
| 1. Mic Level | 13. EQ Presets | 25. HDMI 2 Port |
| 2. Echo Level | 14. Cursor | 26. TV Antenna Port |
| 3. USB Charging Port | 15. Enter | 27. USB Player Port |
| 4. Headphone Out | 16. Battery Level | 28. Power Rocker Switch |
| 5. Video | 17. Menu | 29. DC In 15V / 3A |
| 6. Bluetooth | 18. Exit | 30. AC Input Power |
| 7. SOURCE | 19. Display | |
| 8. Mic Port | 20. Power RED LED | |
| 9. Aux In Port | 21. Bluetooth BLUE LED | |
| 10. Previous | 22. Vol+ / Vol - | |
| 11. Next | 23. Power | |
| 12. Number Key 1-3 | 24. HDMI 1 Port | |

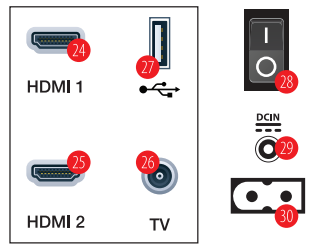

GETTING STARTED

- Flip the power switch to ON to check current battery level.
- The LED battery indicator will turn on.
- The unit will enter into "Setup Wizard" mode, please choose "Home" for regular use.

Wall Outlet

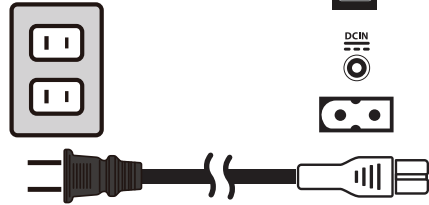

SOURCE SWITCHING KEY

- Main unit has 4 Sources (Display/Bluetooth/Aux in/Radio) Press "Source" key on remote control to change between source DISPLAY/FM/AUX/BT sequence: DISPLAY/FM/AUX/BT
- The main unit has 4 sources under audio mode:
 1. Display source (default source);
 2. FM source;
 3. AUX IN source;
 4. Bluetooth source.

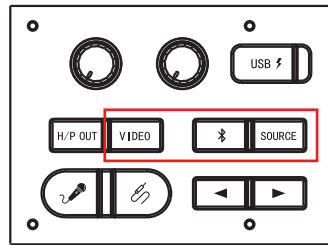

- If Main unit is on in Display mode, it will have 4 sub-sources in Display mode. Press the video key on the unit OR press "TV"/"HDMI"/"USB" button on Remote Control to change source between "TV"/"HDMI1"/"HDMI2"/"USB"; the related source message will show on TV screen;

BLUETOOTH CONNECTION

Manual Bluetooth pairing

- Place speaker and Bluetooth device within 3 feet of each other.
- Make sure Bluetooth function is enabled on your device.
- Press and hold Bluetooth  button for 2 seconds to enter pairing mode. BLUE LED will flash.
- Search for Bluetooth devices on your device. Select "**MONSTER VISION156**."

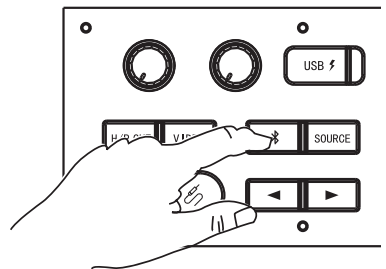
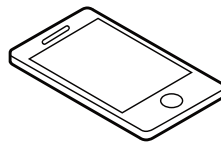

Bluetooth®
Pairing

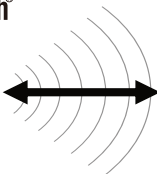

- Speaker will confirm connection with audible sound.
- Once paired, **BLUE LED** will stop flashing and remain steady.

HEADPHONE OUTPUT

- In any mode, there is sound output when headphones are plugged in, and the volume is adjustable.
- When headphones are plugged in, there is no sound output from the speaker.

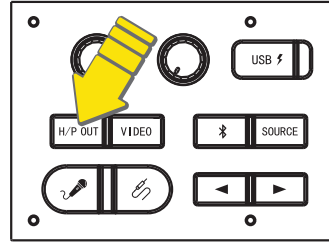

MIC INPUT

- Plug in the 1/4" audio jack plug in the MIC input for Microphone, the unit will enter into that mode (MIC), make sure the the Microphone, is on.
- You can connect any audio device that has a 1/4" audio output jack, with playback capability audio.
- Playback functions (Play, Pause, Next, Previous) can be controlled from the connected Audio device.
- Guitar not included.

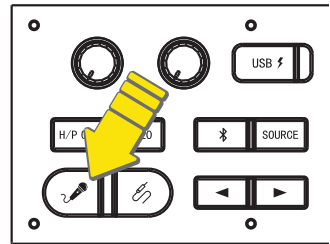

Dynamic Microphone recommended

AUX INPUT

- Plug in the 3.5 mm Stereo Audio wire into the AUDIO input.
- Press the AUDIO button to change the source to AUX
- You can connect any audio device that has a 3.5mm audio output jack, and can playback and audio from the connected device.

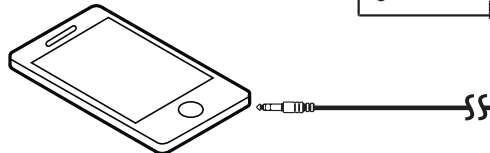

FM RADIO

Listening to FM radio

- Press the “ SOURCE ” button to select SOURCE source, the radio station frequency will be displayed on the screen.
- Press and hold (◀ or ▶) to search a station with the strongest reception.

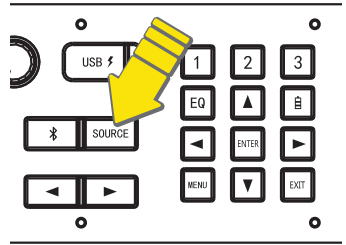

Store your favorite radio stations manually

- Tune to the desired radio station.
- Press and hold a number key (1-3) to enter programming mode; The corresponding number blinks on the screen; enter the stations to save on the selected preset.
- Repeat above step 1-2 to store additional stations.

Store a favorite radio station

- Press the “ SOURCE ” button to select FM source.
- Press the number 1-3 keys to select one of your favorite radio stations to listen.

PRESET FUNCTION WORKS SIMILARLY ON SUPPLIED REMOTE WITH AN ADDITIONAL 6 PRESETS FOR A TOTAL OF 9

USB CHARGING

- With the built in USB power back, connect your USB cable to USB power ports. You can connect an iPhone, iPad, or any Android device. (USB cable not included)

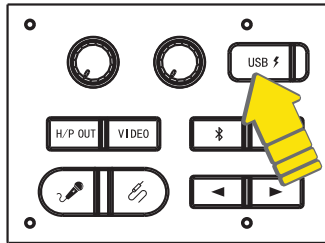

Items	Parameters
Capacity of Built-in Battery	12V / 7A
Power Bank Output	Voltage 5V/2.1A

USB Player (REAR USB ONLY)

The USB Player can support “Photo”/“Music”/“Video”;

1. USB Version 1.0, 1.1, 2.0; up to 64GB;
2. Compression format is MP3;
3. MP3 bit rates: 32 - 320 kbps;
4. Can't Display MP3 embedded album art;
5. MP3 ID3 tag is V1.2;
6. Only support Mass Storage Class (MSC) playback;
7. Support Fat16/Fat32;
8. Playback folder 7 level;

EQUALIZER (EQ) PRESETS AUDIO



Customize your listening experience with 6 EQ settings when in **Bluetooth, AUX, or FM** mode.

Audio:

EQ1 MUSIC **EQ4 ROCK**
EQ2 FLAT **EQ5 POP**
EQ3 JAZZ **EQ6 CLASSIC**

EQUALIZER (EQ) PRESETS VIDEO



Customize your view experience with 4 EQ setting when playing display source.

VIDEO:

EQ1 MUSIC
EQ2 MOVIE
EQ3 NEWS
EQ4 FLAT

MULTIMEDIA COMPATIBILITY

Video: AVI, MKV, MP4, MOV, VOB, FLV, MPG, TRP, H.265, H.264, H.263, MPEG1
MPEG2, MPEG4, 3GP, TS

Audio: MP3, WMA, AC3, AAC, WAV, FLAC, M4A , MPEG1, MPEG2 ac3 ogg, AAC-LC, HEAAC

Picture: JPEG, JPG, PNG, BMP

STANDBY FUNCTION

- Main unit will auto enter standby in working mode to save battery, AC charging will also power off. Only Red LED will turn on and other LED will turn off when main unit enters standby mode; Main unit will auto enter standby mode by following previous method, all LED, will turn off when main unit enters standby;
- **In Bluetooth source in working battery mode:** when BT connection fails, or disconnected for 15 minutes, the setting goes to standby mode and BT LED turns off.
- **For AUX In source in working battery mode:** main unit will auto enter standby mode when main unit is in Aux In source and no Aux cable is inserted into main unit for 15 minutes.
- **For USB source in working battery mode:** main unit will auto enter standby mode when main unit is in USB source and no music playing or pause for 15 minutes.
- **Main unit is working mode:** Press and hold the “Standby” key for 2s and it will auto enter STANDBY status.

WAKEUP FUNCTION DESCRIPTION

- **Main unit in OFF status:** Switch “Power” key from Power off to Power on will wake up main unit from standby mode; Main unit will wake up and return to the last source mode, the Power Red LED will turn off when main unit is working.
- **Main unit in STANDBY status:** Press “Standby” key and the main unit will wake up main unit from standby mode; Main unit will wake up and return to the last source mode, the Power Red LED will turn off when main unit is working.
- **Main unit in STANDBY status:** Press “Standby” key for 1s ; Main unit will wake up and returns to last source mode;
- **Main unit at STANDBY status:** Press “Power” key on Remote Control to wake up main unit from standby mode; Main unit will wake up and return to the last source mode, the Power Red LED will turn off when main unit is working.

***If they unit is not in use, power should be switched off**

***Unit should be recharged every 2 months if not in constant use.**

SPECIFICATIONS

GENERAL

IP Rating	IPX4
Audio & Video Inputs	Bluetooth; (3.5mm) AUX-IN; FM Radio; (x2) HDMI; (¼") Mic/Guitar Input
Audio Output	Headphone out
Bluetooth Version	5.3
App	No
LED Indicators	Red (Power/Charge/Standby); Blue (Bluetooth)
Lighting Color	No
Made In	China
Materials	Metal & Plastic
Microphone	Yes
Dimensions (L x W x H) Inches	17,80" x 9,00" x 18,75"
Dimensions (L x W x H) mm	452 x 230,5 x 476
Weight (lbs. / kg)	7.912 Kg
Internal Memory	N/A

PACKAGE

Gift Box (L x W x H) Inches	19,9" x 11,3" x 20,7"
Gift Box (L x W x H) mm	505 mm x 286 mm x 526 mm

DISPLAY

Display Size	394,38mm Diagonal
.....	15,6 inches Diagonal
Active Area	344,15 H x 193,59 V
Pixel Format	1920 H x 1080 V
Pixel Pitch	0,17925 H x 0,17925 V
Pixel Configuration	R, G, B vertical stripe
Display Mode	Normal
Driving Scheme	FFS
Power Consumption	0,561
Surface treatment of front polarizer	„Anti-glare Coating

POWER

Power Input	AC 120V-240V
Play Time	
Audio Only	Up to 25 Hrs.
Video & Audio	Up to 8 Hrs.
Charge Time	Up to 6 Hrs.
Battery Type	Lead-Acid
Battery Capacity	12V/7A
Standby Time/Power	15 min
USB Output	5V/2.1A
Operating Temperature Range ..	32°F to 104°F / 0°C to 40°C
Operating Humidity	40-90% RH
Storage Temperature Range	-4°F to 140°F / -20°C to -60°C
Work Mode	N/A
Off Mode	N/A

AUDIO

Audio Controls	Power (On/Off); Volume (Increase/Decrease/Wake-up); Bluetooth (Select/Pair); Next/Previous (Tracks (BT)); Radio (Station/Seek); Numbers (Radio Station Presets); Microphone Volume (Increase/Decrease); Echo Volume (Increase/Decrease); Video (Select Source); Audio (Select - Bluetooth/Radio/AUX-IN)
Speaker Output	60W
Speaker Drivers	3" Full Range
Passive Radiators	No
Frequency Response	40HZ-20KHZ
THD + Noise	<10%
Max SPL	99dB
Signal-to-Noise Ratio	> 75dB

FEATURES

Carring Handle; Battery Level Indicator;
15.6" 1080P 16:9 Color LCD Display; 9 Radio Remote
Presets; 3 Radio Presets on Unit; DC 15V / 3A Car
Charger Input

Limited Warranty

Model: MNVISION156

This Monster-branded product, marketed as new, in the original carton to the original purchaser ("Product"), is warranted by Russell Distribution Company, LLC against manufacturing defects in materials and workmanship for a limited warranty period of Ninety (90) Days for Labor and One (1) year for Parts. This Limited Warranty is conditioned upon proper use of Product by you, the Purchaser.

This Limited Warranty does not apply to store display products and product sold as a "marked down" special, in as is condition, "close outs", "liquidation and clearance sales", "open box", products missing accessories, or no fault found.

Proof of purchase in the form of a Bill of Sale, Receipt or Receipted Invoice is evidence the Product is within the limited warranty period. The Bill of Sale, Receipt or Receipted Invoice must be presented as a pre-condition to obtaining the limited warranty service.

This limited warranty begins on the original date of purchase and is valid only on Products purchased through authorized dealers and used in the United States, and Puerto Rico, by the original Purchaser. To receive warranty service, the Purchaser must first contact us for problem determination and service procedures. The original dated bill of sale, receipt or receipted invoice must be presented upon request as proof of purchase.

We will repair your product or if repairs cannot be made, we will replace it at no charge with the same or similar product. If the Product is defective as specified in this limited warranty during the limited warranty period, we may use new or remanufactured parts to repair the Product. All replaced parts and products become our property and must be returned to us. Replacement parts and products assume the remaining original limited warranty, or ninety (90) days, whichever is longer.

Product freight must be prepaid by you, the original Purchaser and shipped in either its original packaging or packaging affording an equal degree of protection. We will not be responsible for or obligated to replace damaged Products.

If the Product is received damaged, it is your responsibility as the consumer to file a claim against the carrier. We will only store the damaged Product for 30 days and reserve the right, in our sole discretion, to dispose of the damaged Product or ship it back to you at your expense after 30 days.

This limited warranty covers manufacturing defects in materials and workmanship encountered in normal, and except to the extent otherwise expressly provided for in this statement noncommercial use of this Product, and shall not apply to the following, including, but not limited to: Damage which occurs in shipment; delivery and installation; applications and uses for which this Product was not intended; altered Product or serial numbers; cosmetic damage or exterior finish; accidents, abuse, neglect, fire, water, lightning or other acts of nature; use of products, equipment, systems, utilities, services, hardware, supplies, accessories, applications, installations, repairs, external wiring or connectors not supplied or authorized by us or the manufacturer, which damage this Product or result in service problems; incorrect electrical line voltage, fluctuations and surges; customer adjustments and failure to follow operating instructions, cleaning, maintenance and environmental instructions that are covered and prescribed in the instruction book; reception problems and distortion related to noise, echo, interference or other signal transmission and delivery problems; burned-in images. Uninterrupted or error-free operation of the Product is not warranted.

THERE ARE NO EXPRESS OR IMPLIED WARRANTIES OTHER THAN THOSE LISTED AND DESCRIBED ABOVE, AND NO WARRANTIES WHETHER EXPRESS OR IMPLIED, INCLUDING, BUT NOT LIMITED TO, ANY IMPLIED WARRANTIES OF MERCHANTABILITY OR FITNESS FOR A PARTICULAR PURPOSE, SHALL APPLY AFTER THE EXPRESS WARRANTY PERIODS STATED ABOVE, AND NO OTHER EXPRESS WARRANTY OR GUARANTY GIVEN BY ANY PERSON, FIRM OR CORPORATION WITH RESPECT TO THIS PRODUCT SHALL BE BINDING ON US. REPAIR OR REPLACEMENT AS PROVIDED UNDER THIS LIMITED WARRANTY IS YOUR EXCLUSIVE REMEDY AS THE CONSUMER. WE SHALL NOT BE LIABLE FOR ANY INCIDENTAL, OR CONSEQUENTIAL DAMAGES FOR BREACH OF ANY EXPRESS OR IMPLIED WARRANTY ON THIS PRODUCT; EXCEPT TO THE EXTENT PROHIBITED BY APPLICABLE LAW, ANY IMPLIED WARRANTY OF MERCHANTABILITY OR FITNESS FOR A PARTICULAR PURPOSE ON THIS PRODUCT IS LIMITED FOR THE DURATION OF THIS LIMITED WARRANTY THIS LIMITED WARRANTY SHALL NOT EXTEND TO ANYONE OTHER THAN THE ORIGINAL PURCHASER OF THIS PRODUCT, IS NONTRANSFERABLE AND STATES YOUR EXCLUSIVE REMEDY.

Some states do not allow limitations on how long an implied warranty lasts, or the exclusion or limitation of incidental or consequential damages, so the above limitations or exclusions may not apply to you. This limited warranty gives you specific legal rights, and you may also have other rights, which vary from state to state. Any provision contained herein which is found contrary to state or local laws shall be deemed null and void and the remaining provisions shall continue in full force and effect.

To obtain warranty service:

Telephone: 800-976-0677

Ver. 130828-i



Monster and the Monster logo are registered trademarks of Monster Inc., and its subsidiaries in the U.S. and other countries, used under license.

The Bluetooth® word mark and logos are registered trademarks owned by Bluetooth® SIG, Inc. and any use of such marks by Monster Inc. is under license. Other trademarks and trade names are those of their respective owners.

Monster y el logotipo Monster son marcas registradas de Monster, Inc. y sus subsidiarias en los Estados Unidos de América y en otros países, utilizadas bajo licencia.

La marca y los logotipos Bluetooth® son marcas registradas de Bluetooth SIG, Inc. y cualquier uso de tales marcas por parte de Monster Inc. se realiza bajo licencia. Otras marcas y nombres comerciales son propiedad de sus respectivos dueños.

Monster et le logo Monster sont des marques déposées de Monster, Inc. et ses filiales aux États-Unis et dans d'autres pays, utilisées sous licence.

La marque verbale et les logos Bluetooth® sont des marques déposées de Bluetooth SIG, inc. et toute utilisation de ces marques par Monster Inc. est sous licence. Les autres marques et noms commerciaux appartiennent à leurs propriétaires respectifs.

FOR QUESTIONS OR TECHNICAL SUPPORT

Please call:

1-800-976-0677

Please do not return this product to the store