

ROCKIN' ROLLER 270

PORTABLE INDOOR/OUTDOOR WIRELESS SPEAKER

GENERAL

IP Rating	IPX4
Audio Inputs	Bluetooth; TWS (True Wireless System); ¼" Input (x2) (3.5mm) AUX-IN
Audio Output	(3.5mm) Line Out
Bluetooth Version	4.2
App	Monster Zone Control
LED Power	N/A
LED Indicators	Red/Blue (LED Display); Red/Green (Battery Charge)
Lighting Color	RGB
Made In	China
Materials	Metal & Plastic
Microphone	Wired
Product UPC	0000000000
Dimensions (W x H x D) Inches	13.2" x 18.6" x 10.8"
Dimensions (W x H x D) mm	382* 472.5* 276
Weight (lbs. / kg)	28.66 lbs. / 13 kg
Internal Memory	No

PACKAGE & PALLET

Gift Box (W x H x D) Inches	18.1" x 22.4" x 12.9"
Gift Box (W x H x D) mm	460 x 570 x 330
Pallet Quantity	TBD
Pallet UPC	N/A
Master Box (L x W x H) Inches	N/A
Master Box (L x W x H) mm	N/A
Master Quantity	N/A

FEATURES

270 Sound, Telescoping Handle; All Terrain Rolling Wheels; Storage Compartment; Bottle Opener; Battery Level Indicator

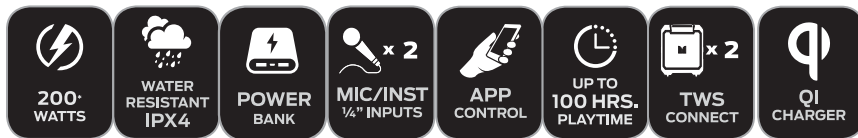

POWER

Power Input	AC 100V/240V
Play Time	Up to 100 Hrs.
Charge Time	Up to 15 Hrs.
Battery Type	Lead-Acid
Battery Capacity	12V/9A
Standby Time/Power	15 min./<0.5W
USB Output	5V/2.2A
Operating Temperature Range	32F° to 104F° / 0C° to 40C°
Operating Humidity	40-90% RH
Storage Temperature Range	-13F° to 158F° / -25C° to 70C°
Work Mode	N/A
Off Mode	<0.01W

AUDIO

Audio Controls	Source Button BT Button (Pause / Play / Pairing) Knob (Vol + / -) Previous / Next (Song / Station) Numerical Buttons (FM stations / EQ settings 1-5) knob(Guitar Echo+ / -& Vol control + / -) knob(microphone Echo+ / -& Vol control + / -) 8, TWS button BASS/TREBLE button NX-Bass Button Battery button
Speaker Output	200W
Speaker Drivers	8"- 50W Woofer x 1 3" - 15W mid-high range Speaker Driver x 1 3" - 8W mid-high range Speaker Driver x 2
Passive Radiators	No
Frequency Response	N/A
THD + Noise	<10%
Max SPL	99 dB
Signal-to-Noise Ratio	>75 dB



- Rockin' Roller270
- AC Power Cable
- AUX Cable
- Quick Start Guide
- Manual/Warranty

The latest installment of the popular Monster Rockin' Rollers 270 is an audio heavyweight with the pedigree to back it up. Triple-digit speaker wattage and triple-digit battery life is encased in a reinforced shell to ensure that the Rockin' Roller 270 survives your wildest excursions, whether on-stage or at the tailgate.



• Monster and the M Monster logo are registered trademarks of Monster, Inc. and its subsidiaries in the U.S. and other countries, used under license. Pure Monster Sound is a trademark of Monster, Inc. and its subsidiaries in the U.S. and other countries, used with permission.

• The Bluetooth® word mark and logos are registered trademarks owned by Bluetooth SIG, Inc. Other trademarks and trade names are those of their respective owners.

• The N-Mark is a trademark or registered trademark of NFC Forum, Inc. in the United States and in other countries.