

MONSTER®

ROCKIN' ROLLER® 4

USER MANUAL

MUSIC WITHOUT LIMITS



Monster and the Monster logo are registered trademarks of Monster Inc., and its subsidiaries in the U.S. and other countries, used under license. The Bluetooth® word mark and logos are registered trademarks owned by Bluetooth SIG, Inc. Other trademarks and trade names are those of their respective owners. The N-Mark is a trademark or registered trademark of NFC Forum, Inc. in the United States and in other countries. NWS, NOAA, and the NOAA Radio logo are registered trademarks of the National Weather Service in the United States and used with kind permission.

MONSTER® 1-800-976-0677 • support@mymonsteraudio.com • MyMonsterAudio.com

MODEL: RR4

THANK YOU FOR CHOOSING MONSTER

Congratulations on your Rockin' Roller 4 indoor/outdoor wireless speaker. Please take your time to explore all of the features and utilities we have built into this product.

We put all of our products through rigorous testing and quality control. We take great pride in presenting this product to you now. For your peace of mind, we offer a one-year limited warranty against manufacturing defects and workmanship. Please refer to the warranty section of the user manual for more details.

For more information on all of our products, please visit: MyMonsterAudio.com.

FOLLOW US:



@MyMonsterAudio



@MyMonsterAudio



/MyMonsterAudio

PACKAGE CONTENTS

Included with your Rockin' Roller 4 purchase:



Rockin' Roller 4



AC Power Cable
(Length: 8')



AUX Cable
(Jack: 3.5mm; Length: 6')



Microphone
(Jack: 1/4"; Length: 8')



User Manual &
Quick Start Guide



2-Piece Stacking Lock
Assembly
(incl. Screws x8)

TABLE OF CONTENTS

PRODUCT CONTROLS	1	▪ Saving Radio Stations (AM/FM/NOAA)	6
POWER & BATTERY		▪ Line Out (3.5mm)	6
▪ Power/Charging	2	FEATURES	
▪ AC Pass Through Outlet	2	▪ Standby Mode	6
▪ Battery Level Indicator	2	▪ Telescoping Handle	6
▪ USB Power Banks	2	▪ Stacking System	7
AUDIO		▪ LED Lights	7
▪ Bluetooth Pairing	3	TROUBLESHOOTING	8
▪ NFC Pairing (Android Devices)	3	SPECIFICATIONS	9
▪ ¼" Guitar/Mic Inputs & Gain/Echo Controls	4	IMPORTANT SAFETY INSTRUCTIONS	10
▪ AUX-IN (3.5 mm)	4	LIMITED WARRANTY	11
▪ True Wireless System (TWS)	4	FCC WARNING STATEMENT	12
▪ Bass/Treble Adjustment	5		
▪ AM/FM Radio	5		
▪ NOAA Weather Radio (NWR)	5		
▪ Equalizer Presets (Bluetooth/AUX-IN ONLY)	5		

PRODUCT CONTROLS

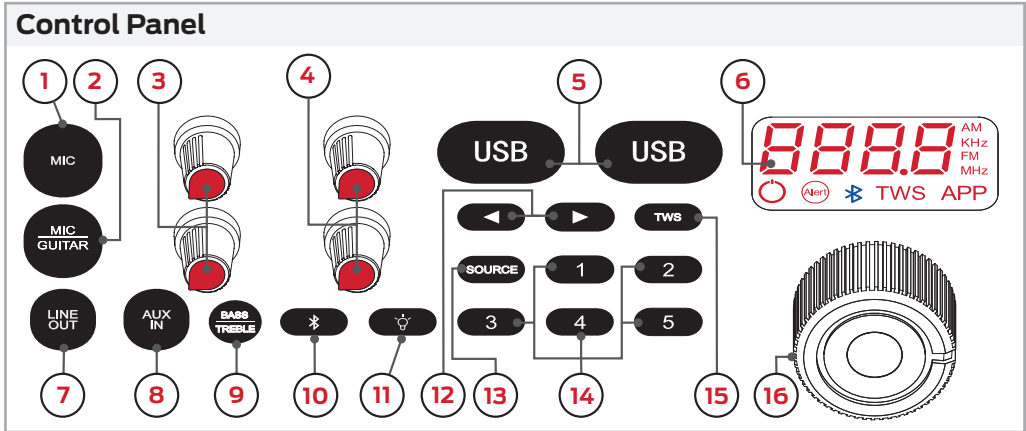

Control Panel

- 1. MIC 1/4" Input
- 2. MIC/GUITAR 1/4" Input
- 3. GAIN Knob (x2)
- 4. ECHO Knob (x2)
- 5. USB Power Bank (x2)
- 6. LED Display
- 7. LINE OUT
- 8. AUX IN
- 9. BASS/TREBLE Button
- 10. BLUETOOTH Button
- 11. LED LIGHT Button

- 12. ARROW Buttons
- 13. SOURCE Button
- 14. NUMBER Buttons
- 15. TWS Button
- 16. VOLUME Knob

LED Display

- 17. SSD Display
- 18. AM Indicator
- 19. FM Indicator
- 20. STANDBY Indicator
- 21. NOAA ALERT Indicator
- 22. BLUETOOTH Indicator

- 23. TWS Indicator
- 24. APP Indicator

Side Panel

- 25. BATTERY Indicator Button
- 26. BATTERY Level Indicator LEDs
- 27. BATTERY LOW Indicator LED
- 28. AC OUTLET Port (Pass Through)
- 29. INPUT POWER Port
- 30. POWER ON/OFF Switch

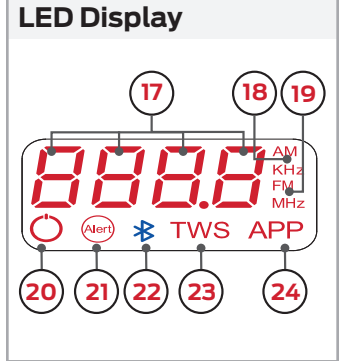

Side Panel

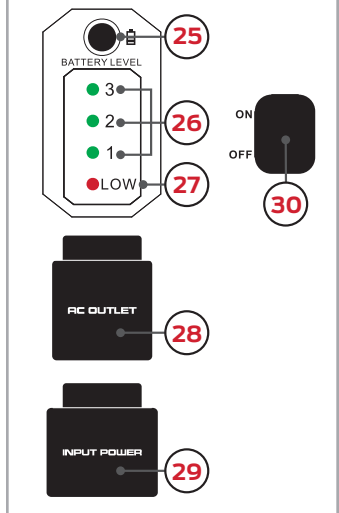

POWER & BATTERY

IMPORTANT: Before first use, charge for ~6 hours.

Power/Charging

- Connect the INPUT POWER port to an external power source using the included power cord.

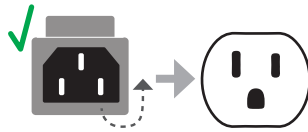

Full Charge – achieved in 7 hours while powered OFF
– achieved in 15 hours while powered ON.



DO NOT use the speaker's AC Outlet port
– it will not charge or power the speaker.

- Flip the switch UP to turn ON the speaker.
("HI" will appear on the LED display. The speaker will connect to the last selected source.)
- Flip the switch DOWN to turn OFF the speaker.

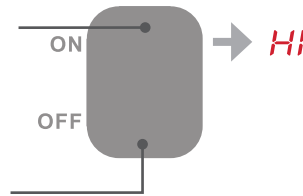

AC Pass Through Outlet

- Connect the AC OUTLET port to an external device to power that device through the speaker.

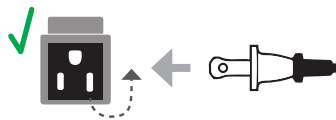

The speaker must be connected to a power source in order to use AC pass through.

(See Power/Charging Speaker.)

Battery Level Indicator

- Press the button above the LED indicators to check the current battery level.
- Green LEDs indicates a full to low battery.
- Flashing RED LED indicates the battery is very low and needs to be charged.

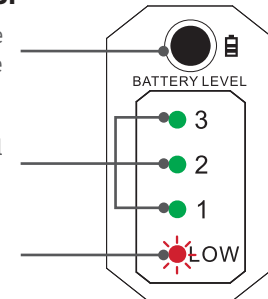

The indicator is only active while the speaker is on.
– Indicator shows current battery level each time the speaker is turned ON.

USB Power Banks

- Connect up to two devices to the speaker via the 5V/2.1A USB ports to charge those devices from the speaker's internal battery.

(USB cable not included.)



USB ports are for charging ONLY
– they will not make audio connections.

AUDIO

Bluetooth Pairing

- 1 Place your mobile device within 3 feet of the speaker.



Make sure *Bluetooth* is enabled on your mobile device.



- 2 Press the **BLUETOOTH** button to set the speaker to Bluetooth mode.

(Press)



The speaker will automatically enter pairing mode.

The speaker will make audible and visual LED confirmation. Bluetooth icon will flash in pairing mode.



*If the Bluetooth icon is NOT flashing, press and hold the **BLUETOOTH** button to manually enter pairing mode.*

- 3 Select "MONSTER RR4" on your mobile device to pair with the speaker.



The speaker will make audible confirmation and the Bluetooth icon will stop flashing.



~30 feet max connection range after paired.
Moving devices outside this range may cause disruption or signal loss.

NFC Pairing (Android Devices)

- 1 Enable NFC on the music device you wish to pair.



- 2 Press the **BLUETOOTH** button to set the speaker to Bluetooth mode.

(Press)



The speaker will automatically enter pairing mode.

The speaker will make audible and visual LED confirmation. Bluetooth icon will flash in pairing mode.



*If the Bluetooth icon is NOT flashing, press and hold the **BLUETOOTH** button to manually enter pairing mode.*

- 3 Place your music device directly on the speaker's NFC logo until paired.



The speaker will make audible confirmation and the Bluetooth icon will stop flashing.



~30 feet max connection range after paired.
Moving devices outside this range may cause disruption or signal loss.

1/4" Guitar/Mic Inputs & Gain/Echo Controls

- Connect an instrument, microphone, or other device to the MIC/GUITAR or MIC port(s) with a standard 1/4 inch jack.

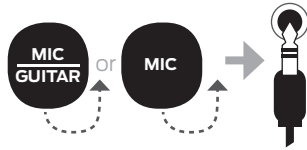

The device(s) will automatically transmit audio playback through the speaker in the current mode.

- Turn GAIN and ECHO control knobs clockwise to increase their effect, and counter-clockwise to decrease their effect.

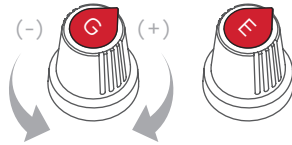

Each 1/4 inch port has its own GAIN and ECHO knobs that can be adjusted independently.



Devices plugged into the 1/4 inch ports will transmit audio playback in all modes/sources.

AUX-IN (3.5mm)

- Connect a music device to the AUX IN port with a standard 3.5 mm jack. The speaker will automatically change to AUX mode.

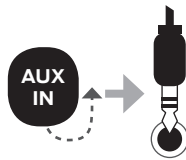

Speaker will make audible and visual LED display confirmation.

AUX "AUX IN"

True Wireless System (TWS)

Wirelessly connect two Rockin' Roller 4 speakers together.

- Place two Rockin' Roller 4 speakers within 10 feet of each other.



- Connect your music device to one of the speakers via BLUETOOTH.



Leave the second speaker in BLUETOOTH mode without connecting to a device.

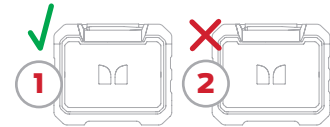

- Press the TWS pairing button on both speakers to activate TWS pairing. The speakers will automatically connect with each other.

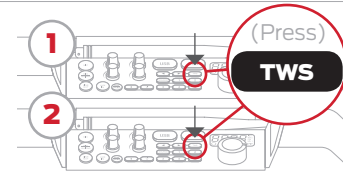

Speaker will make audible confirmation. TWS icons will be displayed on both speakers LED displays when connected.

"Connected" TWS

To disconnect a speaker, press the TWS button.

(Press)

TWS



~30 feet max connection range after paired.
Moving devices outside this range may cause disruption or signal loss.

Bass/Treble Adjustment

- Press the BASS/TREBLE button ONCE to enter bass (Press x1) level mode.



- Press the BASS/TREBLE button TWICE to enter treble level mode. (Press x2)



- Turn the VOLUME knob clockwise to increase or counter-clockwise to decrease the bass/treble levels (-06 to 06).

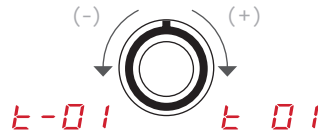

Pressing the BASS/TREBLE button a third time will revert to the audio source mode.

The menu will revert to the audio source mode after ~5 seconds of being idle.

AM/FM Radio

- Press the SOURCE button to change the speaker to AM or FM RADIO.



Speaker will make audible and visual LED display confirmations.

106.9 FM MHz or 600 AM kHz
"Radio" "Radio"

- Press the ARROW buttons to change radio frequency. Press and hold the ARROW buttons to scan for a station.

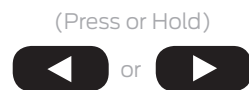

NOAA Weather Radio (NWR)

Access a network of nationwide radio stations that broadcast local weather information.



- Press the SOURCE button to change the speaker to NWR mode.

(Press)

SOURCE

Speaker will make audible and visual LED display confirmation.

NO-1

"NOAA"

- Press the ARROW buttons to change stations.

(Press)



Raise the antenna to a vertical position for improved reception. Stations and signal strength vary depending on location.

- Press the VOLUME knob once to turn NWR alerts off (NOFF). Press again to turn NWR alerts back on (NON). Works in any audio source mode.

(Press)



NOFF

(Press)



NON

Equalizer Presets (Bluetooth/AUX-IN ONLY)

- Press a NUMBER BUTTON (1-5) to change the speaker's equalizer settings.

BUTTON	SETTING	LED
1	FLAT	E-1
2	JAZZ	E-2
3	ROCK	E-3
4	POP	E-4
5	CLASSIC	E-5

Setting will show on the speaker's LED display.

E-1

FEATURES

Saving Radio Stations (AM/FM/NOAA)

- Save the current radio station by pressing and holding one of the NUMBER BUTTONS (1-5).

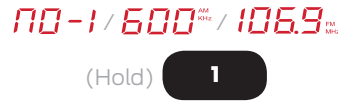

The LED display will confirm the saves station (P-1, P-2, etc.)

P 1

Press the NUMBER KEY while in radio mode to go to the corresponding **SAVED** station.



LINE-OUT (3.5mm)

- Connect a second speaker to the Rockin' Roller 4 via the LINE OUT port with a standard 3.5 mm jack. Audio playback will transmit through the Rockin' Roller 4 and the second speaker simultaneously.

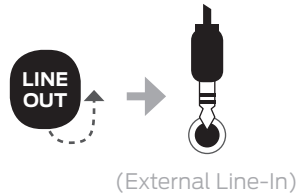

Standby Mode

- Press and hold the VOLUME knob for ~3 seconds to put the speaker in standby mode.

(Press & Hold ~3 seconds)



LED indicators will shut off. Power icon will turn on.

OFF →



- Press any button or turn the VOLUME knob to wake the speaker up from standby.

(Turn)

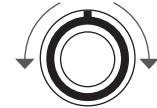

The speaker will automatically enter standby mode after ~15 minutes of inactivity or lack of connection. Standby mode can be manually enabled in any mode.

Telescoping Handle

- Pull the telescoping carry handle UP and away from the speaker to extend it.
- Press the BUTTON on the grip area to adjust the carry handle to a comfortable length.

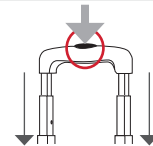
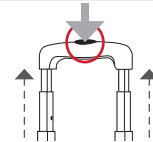

DO NOT use the carry handle when speakers are stacked. The handle is graded to only carry the weight of one Rockin' Roller 4 speaker.

Stacking System

Stack two Rockin' Roller 4 speakers on top of each other.

- 1 Place the FIRST Rockin' Roller 4 on a stable, non-slippery surface.



- 2 Lift the SECOND Rockin' Roller 4 on top of the first speaker and slide the "hooked" feet in first.

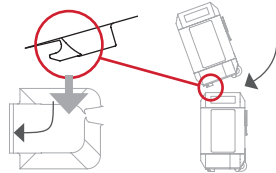

- 3 Pull the latch UP to release the locking mechanism on the bottom speaker.

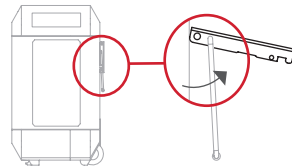

- 5 Swing the locking arm UP and into the top speaker's mounting hook.

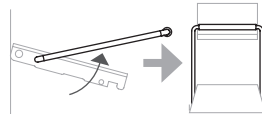

- 6 Push the latch DOWN until it locks securely into place.

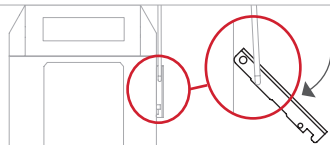

Some assembly required. Make sure the upper and lower locking brackets are installed with all 8 screws tightly in place.

LED Lights

- To turn on the LED lights, press the LIGHT button. Press up to four times to increase the brightness level (25%, 50%, 75%, 100%). Press again to turn off the LED lights.

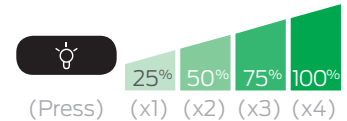

- To change the LED light color, press and hold the LIGHT button to activate color selection (C-1, C-2, etc.). Turn the VOLUME knob to change the color mode.

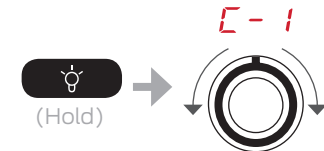

- | | |
|-------------|----------------|
| C-8= White | C-1= Rainbow |
| C-2= Red | C-3= Blue |
| C-4= Green | C-5= Purple |
| C-6= Yellow | C-7= Turquoise |



Color selection display will revert to source display after ~2 seconds of being idle.

LED lights revert to white color and off when the speaker is turned off or enters standby mode.

TROUBLESHOOTING

Speaker is not powering on	<ul style="list-style-type: none">▪ Verify that the POWER switch is fully turned to the ON position. <i>(see pg. 2)</i>▪ Ensure the speaker is not in STANDBY MODE. <i>(see pg. 6)</i>▪ Make sure AC POWER cord is fully inserted into the unit. <i>(see pg. 2)</i>
Buttons are not responding	<ul style="list-style-type: none">▪ Reset the speaker by turning the power OFF, and then back ON. <i>(see pg. 2)</i>▪ Unplug the AC POWER cord, then plug it back in. <i>(see pg. 2)</i>
No music is playing	<ul style="list-style-type: none">▪ Make sure the speaker is set to the same source as your audio device. If you are playing audio via AUX cable, make sure the speaker is in AUX IN mode, etc. <i>(see pg. 3-5)</i>▪ Make sure the VOLUME is high enough on your audio device as well as the speaker.
Bluetooth/NFC audio quality is poor	<ul style="list-style-type: none">▪ Move your music device closer to the speaker.▪ Remove objects that may be interfering with the wireless connection.
Bluetooth/NFC device is not pairing	<ul style="list-style-type: none">▪ Verify that the speaker and your device have BLUETOOTH mode active. <i>(see pg. 3)</i>▪ Make sure the speaker and/or your device is not already paired with another device.▪ Check that the speaker is in pairing mode. <i>(see pg. 3)</i>▪ Turn the speaker OFF, and then back ON. Press and hold the BLUETOOTH button to manually enter pairing mode. <i>(see pg. 3)</i>
Contact our support team for additional services	<p>Call: 1-800-976-0677</p> <p>Email: support@mymonsteraudio.com</p> <p>Hours of Operation: Monday - Friday: 7:00 am - 5:00 pm (PST) Saturday - Sunday: CLOSED</p>

SPECIFICATIONS

General	
Bluetooth Version	4.0
Power Input	AC ~120V/60Hz – 220V/50Hz
Speaker Drivers	30W (x 1) / 15W (x 1)
THD + Noise	<10%
Cabinet Material	Plastic
Battery Capacity	12V 9000mAh <i>(18-22 hours at max volume and light settings)</i>
USB Bank Output	5V/2.1A
Dimensions (W x H x D)	18" x 16" x 9"
Weight	25.5 lbs

Operating Temperature	
Operating Temperature Range	32F° - 104F°
Operating Humidity Range	40-90% RH
Storage Temperature Range	-13F° to 158F°

IMPORTANT SAFETY INSTRUCTIONS

- **Read all instructions** and save them for personal reference in the future.
- **Follow all directions** for operating the product.
- **Heed all warnings** on the product and in the operation instructions.
- **Clean with a dry cloth only.** Always unplug the product from any power source before cleaning.
- **Do not use third-party attachments** or non-recommended accessories with this product.
- **Do not place product on an unstable surface,** such as a cart, stand, tripod, table, etc. Unstable surfaces may cause the product to fall and cause serious injury to people and serious damage to the product. Follow all manufacturer instructions for mounting and accessories.
- **Do not block or cover ventilation slots.** Openings in the product cabin ensure reliable operation and prevent overheating. Avoid placing on beds, sofas, and rugs, or mounting on racks or bookcases, unless proper ventilation is provided.
- **Do not use plug incorrectly.** The product may come with a polarized, alternating-current line plug (one blade is wider/larger than the other). This is a safety feature: the plug will only go into outlet receptacles one way. Do not force the plug. If the plug does not fit, contact your electrician to replace the outlet.
- **Prevent power cord hazards.** Route cords to avoid walking on them or pinching them, especially at plug ends and connection points to the product & power outlets.
- **Unplug power cord when not in use.** The product should not be plugged into a power source when not in use for long periods of time.
- **Do not use this product near bodies of water.** The product is not waterproof and cannot be fully submerged in water. Power cords and electric currents should never be exposed to water.
- **Do not set up near heat sources.** Avoid radiators, stoves, heat registers, amplifiers, and other devices that produce heat. Avoid long exposure to sunlight and high temperatures.
- **Refer all service to qualified personnel.** If the product becomes damaged during use or encounters a malfunction, contact qualified service personnel. Do not attempt to service yourself.
- **To use wirelessly, disconnect AC power.** The plug must be completely disconnected from the power outlet.
- **Do not stand, sit, jump or strike** the Rockin' Roller 4 Speaker with sharp objects. The product may break and not function.

LIMITED WARRANTY

Model: RR4

This Monster-branded product, marketed as new, in the original carton to the original purchaser ("Product"), is warranted by Russell Distribution Company, LLC against manufacturing defects in materials and workmanship for a limited warranty period of ninety (90) days for Labor and one (1) year for Parts. This Limited Warranty is conditioned upon proper use of Product by you, the Purchaser.

This Limited Warranty does not apply to store display products and product sold as a "marked down" special, in as is condition, "close outs", "liquidation and clearance sales", "open box", products missing accessories, or no fault found.

Proof of purchase in the form of a Bill of Sale, Receipt or Receipted Invoice is evidence the Product is within the limited warranty period. The Bill of Sale, Receipt or Receipted Invoice must be presented as a pre-condition to obtaining the limited warranty service.

This limited warranty begins on the original date of purchase and is valid only on Products purchased through authorized dealers and used in the United States, and Puerto Rico, by the original Purchaser. To receive warranty service, the Purchaser must first contact us for problem determination and service procedures. The original dated bill of sale, receipt or receipted invoice must be presented upon request as proof of purchase.

We will repair your product or if repairs cannot be made, we will replace it at no charge with the same or similar product. If the Product is defective as specified in this limited warranty during the limited warranty period, we may use new or remanufactured parts to repair the Product. All replaced parts and products become our property and must be returned to us. Replacement parts and products assume the remaining original limited warranty, or ninety (90) days, whichever is longer.

Product freight must be prepaid by you, the original Purchaser and shipped in either its original packaging or packaging affording an equal degree of protection. We will not be responsible for or obligated to replace damaged Products.

If the Product is received damaged, it is your responsibility as the consumer to file a claim against the carrier. We will only store the damaged Product for 30 days and reserve the right, in our sole discretion, to dispose of the damaged Product or ship it back to you at your expense after 30 days.

This limited warranty covers manufacturing defects in materials and workmanship encountered in normal, and except to the extent otherwise expressly provided for in this statement noncommercial use of this Product, and shall not apply to the

following, including, but not limited to: Damage which occurs in shipment; delivery and installation; applications and uses for which this Product was not intended; altered Product or serial numbers; cosmetic damage or exterior finish; accidents, abuse, neglect, fire, water, lightning or other acts of nature; use of products, equipment, systems, utilities, services, hardware, supplies, accessories, applications, installations, repairs, external wiring or connectors not supplied or authorized by us or the manufacturer, which damage this Product result in service problems; incorrect electrical line voltage, fluctuations and surges; customer adjustments and failure to follow operating instructions, cleaning, maintenance and environmental instructions that are covered and prescribed in the instruction book; reception problems and distortion related to noise, echo, interference or other signal transmission and delivery problems; burned-in images. Uninterrupted or error-free operation of the Product is not warranted.

THERE ARE NO EXPRESS OR IMPLIED WARRANTIES OTHER THAN THOSE LISTED AND DESCRIBED ABOVE, AND NO WARRANTIES WHETHER EXPRESS OR IMPLIED, INCLUDING, BUT NOT LIMITED TO, ANY IMPLIED WARRANTIES OF MERCHANTABILITY OR FITNESS FOR A PARTICULAR PURPOSE, SHALL APPLY AFTER THE EXPRESS WARRANTY PERIODS STATED ABOVE, AND NO OTHER EXPRESS WARRANTY OR GUARANTEE GIVEN BY ANY PERSON, FIRM OR CORPORATION WITH RESPECT TO THIS PRODUCT SHALL BE BINDING ON US. REPAIR OR REPLACEMENT AS PROVIDED UNDER THIS LIMITED WARRANTY IS YOUR EXCLUSIVE REMEDY AS THE CONSUMER. WE SHALL NOT BE LIABLE FOR ANY INCIDENTAL, OR CONSEQUENTIAL DAMAGES FOR BREACH OF ANY EXPRESS OR IMPLIED WARRANTY ON THIS PRODUCT; EXCEPT TO THE EXTENT PROHIBITED BY APPLICABLE LAW, ANY IMPLIED WARRANTY OF MERCHANTABILITY OR FITNESS FOR A PARTICULAR PURPOSE ON THIS PRODUCT IS LIMITED FOR THE DURATION OF THIS LIMITED WARRANTY THIS LIMITED WARRANTY SHALL NOT EXTEND TO ANYONE OTHER THAN THE ORIGINAL PURCHASER OF THIS PRODUCT, IS NONTRANSFERABLE AND STATES YOUR EXCLUSIVE REMEDY.

Some states do not allow limitations on how long an implied warranty lasts, or the exclusion or limitation of incidental or consequential damages, so the above limitations or exclusions may not apply to you. This limited warranty gives you specific legal rights, and you may also have other rights, which vary from state to state. Any provision contained herein which is found contrary to state or local laws shall be deemed null and void and the remaining provisions shall continue in full force and effect.

To obtain warranty service, please contact technical support with questions

Phone: 1-800-976-0677 ▪ Email: support@mymonsteraudio.com

DO NOT return this product to the store. Visit: MyMonsterAudio.com

FCC WARNING STATEMENT

Changes or modifications not expressly approved by the party responsible for compliance could void the user's authority to operate the equipment. This equipment has been tested and found to comply with the limits for a Class B digital device, pursuant to Part 15 of the FCC Rules.

These limits are designed to provide reasonable protection against harmful interference in a residential installation. This equipment generates, uses, and can radiate radio communications. However, there is no guarantee that interference will not occur in a particular installation. If this equipment does cause harmful interference to radio or television reception, which can be determined by turning the equipment off and on, the user is encouraged to try to correct the interference by one or more of the following measures:

- Reorient or relocate the receiving antenna.
- Increase the separation between the equipment receiver.
- Connect the equipment into an outlet on a circuit different from that to which the receiver is connected.
- Consult the dealer or an experienced radio/TV technician for help.

FCC Radiation Exposure Statement

This equipment complies with FCC radiation exposure limits set forth for an uncontrolled environment. In order to avoid the possibility of exceeding the FCC radio frequency exposure limits, Human proximity to the antenna shall not be less than 20cm (8 inches) during normal operation.



A lightning flash and arrowhead within an equilateral triangle denotes the presence of insulated “dangerous voltage” within the product’s enclosure. The voltage may be of sufficient magnitude to constitute a risk of electric shock to persons who come into contact with it.



An exclamation point within an equilateral triangle denotes the presence of important operation & maintenance/service instructions.

WARNING

Prevent fire and shock hazards. Do not use extension cords or outlets that expose plug blades. Do not expose cables and plugs to rain or moisture.

Do not attempt to perform any servicing that is not included in the operating instructions. Do not attempt to replace the battery, as incorrect installation can cause fire or explosion. For service, contact qualified service personnel.

Do not remove cover or back of product. There are no user-serviceable parts inside. Attempting to modify controls or performance beyond manufacturer specifications may result in hazardous exposure to radiation.