

MONSTER®
Rockin Roller PRO
User Manual



FOR QUESTIONS OR TECHNICAL SUPPORT

Please call:

1.800.976.0677

Please do not return this product to the store.

TABLE OF CONTENTS

Warning & FCC Statement	3
Safety Instructions	4
Contents	5
Speaker Component	5
Getting Started	5
Charging Battery	6
Bluetooth Connection	6
NFC Connection	6
Wireless Microphone	7
6.3MM Guitar / Mic Input	7
AUX Input	7
FM Radio	8
USB Charging	8
Equalizer Presets	8
Auto Standby	8
TWS Connection	9
Troubleshooting	9
Specifications	10
Limited Warranty	11

FCC WARNING STATEMENT

Changes or modifications not expressly approved by the party responsible for compliance could void the user's authority to operate the equipment. This equipment has been tested and found to comply with the limits for a Class B digital device, pursuant to Part 15 of the FCC Rules.

These limits are designed to provide reasonable protection against harmful interference in a residential installation. This equipment generates, uses, and can radiate radio frequency energy and, if not installed and used in accordance with the instructions, may cause harmful interference to radio communications. However, there is no guarantee that interference will not occur in a particular installation. If this equipment does cause harmful interference to radio or television reception, which can be determined by turning the equipment off and on, the user is encouraged to try to correct the interference by one or more of the following measures:

- Reorient or relocate the receiving antenna.
- Increase the separation between the equipment and receiver.
- Connect the equipment into an outlet on a circuit different from that to which the receiver is connected.
- Consult the dealer or an experienced radio/TV technician for help.

FCC Radiation Exposure Statement

This equipment complies with FCC radiation exposure limits set forth for an uncontrolled environment. In order to avoid the possibility of exceeding the FCC radio frequency exposure limits, Human proximity to the antenna shall not be less than 20cm (8 inches) during normal operation.



A lightning flash and arrowhead within an equilateral triangle denotes the presence of insulated "dangerous voltage" within the product's enclosure. The voltage may be of sufficient magnitude to constitute a risk of electric shock to persons who come into contact with it.



An exclamation point within an equilateral triangle denotes the presence of important operation & maintenance/service instructions.

WARNING

PREVENT FIRE AND SHOCK HAZARDS. DO NOT USE EXTENSION CORDS OR OUTLETS THAT EXPOSE PLUG BLADES. DO NOT EXPOSE CABLES AND PLUGS TO RAIN OR MOISTURE.

DO NOT ATTEMPT TO PERFORM ANY SERVICING THAT IS NOT INCLUDED IN THE OPERATING INSTRUCTIONS. DO NOT ATTEMPT TO REPLACE THE BATTERY, AS INCORRECT INSTALLATION CAN CAUSE FIRE OR EXPLOSION. FOR SERVICE, CONTACT QUALIFIED SERVICE PERSONNEL.

DO NOT REMOVE COVER OR BACK OF PRODUCT. THERE ARE NO USER-SERVICEABLE PARTS INSIDE. ATTEMPTING TO MODIFY CONTROLS OR PERFORMANCE BEYOND MANUFACTURER SPECIFICATIONS MAY RESULT IN HAZARDOUS EXPOSURE TO RADIATION.

IMPORTANT SAFETY INSTRUCTIONS

- 1. Read all instructions** and save them for personal reference in the future.
 - 2. Follow all directions** for operating the product.
 - 3. Heed all warnings** on the product and in the operation instructions.
 - 4. Clean with a dry cloth only.** Always unplug the product from any power source before cleaning.
 - 5. Do not use third-party attachments** or non-recommended accessories with this product.
 - 6. Do not place product on an unstable surface,** such as a cart, stand, tripod, table, etc. Unstable surfaces may cause the product to fall and cause serious injury to people and serious damage to the product. Follow all manufacturer instructions for mounting and accessories.
- 
- 7. Do not block or cover ventilation slots.** Openings in the product cabin ensure reliable operation and prevent overheating. Avoid placing on beds, sofas, and rugs, or mounting on racks or bookcases, unless proper ventilation is provided.
 - 8. Do not use plug incorrectly.** The product may come with a polarized, alternating-current line plug (one blade is wider/larger than the other). This is a safety feature: the plug will only go into outlet receptacles one way. Do not force the plug. If the plug does not fit, contact your electrician to replace the outlet.
 - 9. Prevent power cord hazards.** Route cords to avoid walking on them or pinching them, especially at plug ends and connection points to the product and power outlets.
 - 10. Unplug power cord when not in use.** The product should not be plugged into a power source when not in use for long periods of time.
 - 11. Do not use this product near bodies of water.** The product is not waterproof and cannot be fully submerged in water. Power cords and electric currents should never be exposed to water.
 - 12. Do not set up near heat sources.** Avoid radiators, stoves, heat registers, amplifiers, and other devices that produce heat. Avoid long exposure to sunlight and high temperatures.
 - 13. Refer all service to qualified personnel.** If the product becomes damaged during use or encounters a malfunction, contact qualified service personnel. Do not attempt to service yourself.

CONTENTS

This box includes the following items:

- Monster Rockin' Roller PRO speaker
- AC Power Cable
- AUX Cable
- Microphone (Wireless)
- User Manual (incl. Warranty Statement)
- Quick Start Guide
- Microphone Mount

If any items are missing, contact our customer service team at 1.800.976.0677.

SPEAKER COMPONENTS

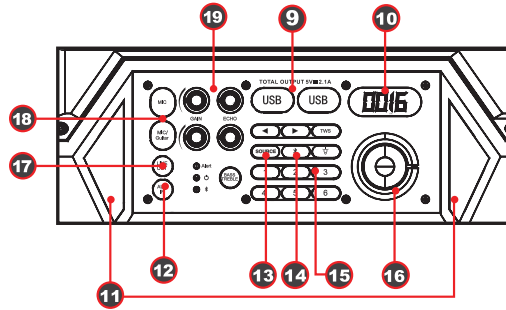
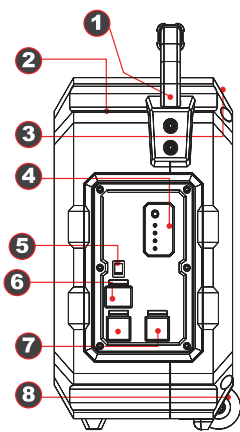

1. Carry handle
2. Ruggedized housing
3. Telescoping handle
4. Battery life indicator
5. Power On/Off switch
6. AC power input
7. AC pass-through outlet
8. In-line rolling wheels
9. USB port (x2)
10. LED interface
11. LED lights
12. AUX input
13. Source selector
14. Bluetooth pairing
15. Radio presets
16. Volume knob
17. Line Out
18. Mic / Guitar Input
19. Mic / Guitar Gain & Echo Control

GETTING STARTED

- Press Battery Level button on side panel to check current battery charge
- Turn the Power switch to ON.
- The LED battery indicator will turn on.
- The unit will enter Bluetooth pairing mode (LED will flash blue).
- If 3.5mm AUX cable is plugged in, unit will automatically enter AUX mode.

Wall Outlet

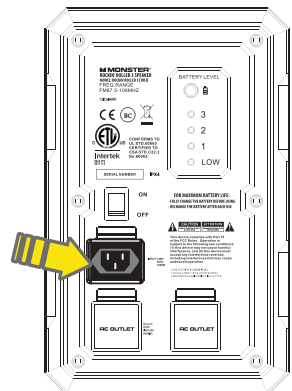

CHARGING BATTERY

- Connect speaker to AC outlet via AC power input to charge battery.
 - Full charge in 7 hours while powered OFF.
 - Full charge in 15 hours while powered ON.
- 3 GREEN LED indicates full battery charge.
- Flashing RED LED indicates that the battery level is low.
- NOTE: Before first use, charge unit for ~6 hours.

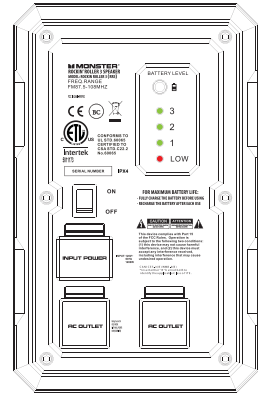

BLUETOOTH CONNECTION

Manual Bluetooth pairing

- Place speaker and Bluetooth device within 3 feet of each other.
- Make sure Bluetooth function is enabled on your device.
- Press and hold Bluetooth  button for 2 seconds to enter pairing mode. BLUE LED will flash.
- Search for Bluetooth connections on your device. Select "MONSTER RRPRO"

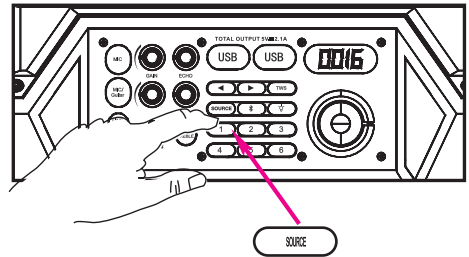
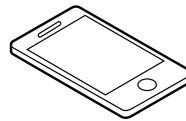

Bluetooth®
Pairing

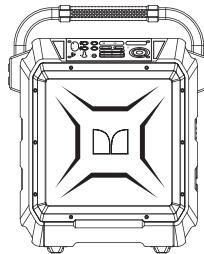
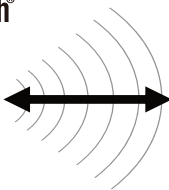

- Speaker will confirm connection with audible sound.
- Once paired, BLUE LED will stop flashing and remain steady.

BLUE LED Indicator
(Flashing to Steady)

NFC CONNECTION

- Turn the speaker on to Bluetooth pairing mode by pressing and holding  to enter into Bluetooth pairing mode.
- Activate Bluetooth on your NFC Compatible mobile device
- Tap your mobile device onto the NFC logo of the speaker
- Bluetooth Blue LED Indicator turns solid upon pairing

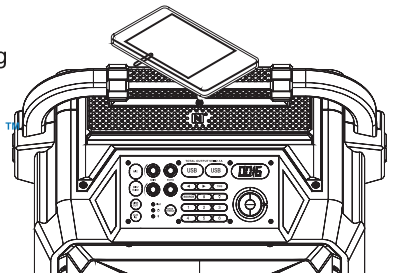

WIRELESS MICROPHONE

- Make sure batteries are properly installed into the microphone.
- Switch microphone button to ON. LED light will flash RED once.
- BLUE LED on the side of the speaker (next to battery life LED) will light up when connected.
- Turn red-tipped GAIN and ECHO dials to tune wireless microphone.



6.3 MM GUITAR / MIC INPUT

- Plug in the 6.3 mm audio jack plug in the MIC input for Microphone, GUITAR input for guitar, the unit will enter into that mode (MIC / GUITAR), make sure the the Microphone, Guitar, or other device is on.
- You can connect any audio device that has 6.3 mm audio output jack, and can playback and audio from this connected device.
- Playback functions (Play, Pause, Next, Previous) can be controlled from the connected Audio device.



AUX INPUT

- Plug in the 3.5 mm Stereo Audio wire into the AUX-IN input, and the unit will enter into AUX mode and BT Blue LED indicator will turn off.
- You can connect any audio device that has 3.5mm audio output jack, and can playback any audio from this connected device.

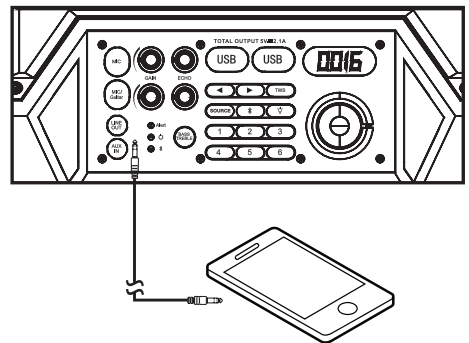

FM RADIO

Listening to FM radio

- Press the “Source” button to select FM source, the radio station frequency will be displayed on the screen
- Press and hold (◀ or ▶) to search a station, with the strongest reception.

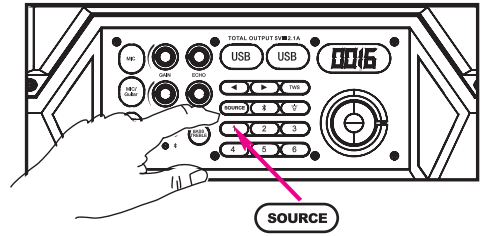

Store your favorite six radio stations manually

- Tune to the desired radio station.
- Press and hold a number key (1-6) to enter programming mode; The corresponding number blinks on the screen; enter the stations to save on the selected preset.
- Repeat above step 1-2 to store additional stations.

Store a favorite radio station

- Press the “Source” button to select FM source.
- Press the number 1-6 keys to select one of your favorite radio stations to listen.

USB CHARGING

- With the built in USB power back, connect your USB cable to one of the two USB power ports. You can connect an iPhone, iPad, or any Android device. (USB cable not included)

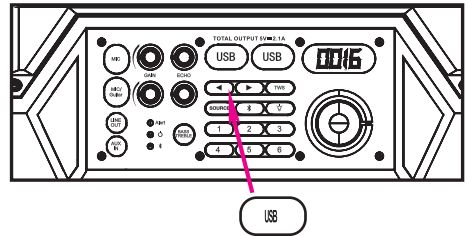

EQUALIZER (EQ) PRESETS



Customize your listening experience with 6 EQ settings when in Bluetooth or AUX mode.

- 1 FLAT
- 2 JAZZ
- 3 ROCK
- 4 POP
- 5 CLASSICAL
- 6 DEFAULT

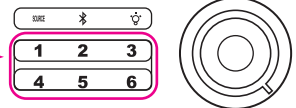

AUTO STANDBY

When entering standby, the RED LED Power signal will turn on, and all other LED lights will turn off.

- **Bluetooth:** Standby mode enables when there is no BT connection, when it has been disconnected for 15 minutes, or if there is a connection failure.
- **AUX:** Standby mode enables when the speaker is in AUX mode and does not detect an AUX cable.
- **Work:** Standby mode enables in work mode by pressing and holding volume knob for 3 seconds.

“Wake up” from standby mode:

If the main unit is in Standby mode, press and hold the volume knob for 1 second. The main unit will turn on and return to the latest source mode. The Power Red LED Signal will turn off and the LED Screen will display the latest source once the main unit is in work mode.

TWS CONNECTION

- Make sure the speaker is in Bluetooth mode and connect to a device.
- Press the TWS button to activate the speaker's True Wireless Stereo (RED LED indicator will flash in TWS mode)
- On a second speaker (NOT connected to a Bluetooth device), press the TWS button.
- When speakers connect, the RED LED indicator will stop flashing and remain on.
- To disconnect a speaker, press the TWS button.

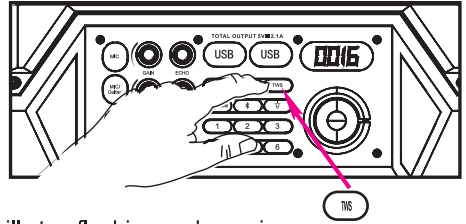

TROUBLESHOOTING

General

No power

- Make sure AC power cord is fully inserted into the unit and the electrical outlet,
- Make sure Power switch is turned to the ON position.
- If battery is flat, plug AC power cord into electrical outlet to charge.

No Button/Key Resonance

- Turn Power switch to OFF, then back to ON to reset the unit.
- Unplug the AC power cord and plug it back in.

No Music Playing

- Make sure AUX/Bluetooth-connected device volume is turned up.
- Make sure Bluetooth-connected device is playing audio through BT.

Bluetooth Operations

Poor Audio Quality

- Bluetooth connection may be poor, move Bluetooth device closer to the unit.

Cannot Pair to Device

- Make sure the unit is not paired to another Bluetooth device.
- Make sure the unit's Bluetooth is switched to ON.
- Make sure the unit is in pairing mode (BLUE LED flashing).
- Turn Power switch to OFF, then back to ON. Press and hold BT button for 2 seconds to enter pairing mode.

SPECIFICATIONS

General	
Input Source	Bluetooth / FM / AUX
Control Buttons	Power, Source, Bluetooth, Volume, Previous / Next, LED lighting, 6 FM preset keys, Battery level LED indicator, TWS, Bass / Treble
Power Input	AC IN 120V/60H z/AC IN 220V/50HZ
Auto Standby	When the unit is not being used for over 15 minutes it will automatically enter standby mode (BT and AUX mode only)
Auto Power Off	Yes
Speaker Driver Size	80W x 1
Full Range	8" (woofer) + 3" (full range)
Max SPL	99dB
THD + Noise	<10%
S/N	>75dB
Cabinet Material	Plastic
Dimensions (W x H x D)	16.7" x 20.6" 9.05"
Weight (Kg)	21 lbs

Operating Temperature	
Operating Temperature Range	32F° - 104F°
Operating Humidity Range	40~90% RH
Storage Temperature Range	-13F° to 158F°

Key	
Power On / Off Key	Power On: Switch "Power" key to "I" Power Off: Switch "Power" ket to "O"
Source Key	Press source key to change source between "BT", "AUX IN". or "FM"
Volume Knob	1. Rotate VOLUME knob to increase / decrease volume. 2. Press and hold the VOLUME knob for 3s and enter standby status.
Bluetooth Paring	1. Press and hold the PAIRING key for 2s to enter pairing mode. 2. Press and hold the PAIRING key for 8s to clear any previous Bluetooth pairing.
Previous / Next Key	Auto search radio stations when in FM mode press and hold "Previous / Next" key in FM source
Preset 1,2,3,4,5,6	1. Short press - play preset station 1. Long press - store current station to preset
Battery Level	Press button to activate LED display

Connections	
3.5mm AUX In	x1
USB Port	x 2 (5v Parallel 2.A)
AC In	x1
AC Out	Yes x 2 (Passthrough)
6.3 mm Line in	x1

Bluetooth	
Bluetooth Version	4.2 + EDR
Bluetooth Profile	A2DP, AVRCP
Bluetooth Frequency Brand	2.4GHz ~ 2.48GHz
Bluetooth Range	10m (33ft.)

Limited Warranty

Model: Rockin' Roller PRO

This Monster-branded product, marketed as new, in the original carton to the original purchaser ("Product"), is warranted by Russell Distribution Company, LLC against manufacturing defects in materials and workmanship for a limited warranty period of Ninety (90) Days for Labor and One (1) year for Parts. This Limited Warranty is conditioned upon proper use of Product by you, the Purchaser.

This Limited Warranty does not apply to store display products and product sold as a 'marked down' special, in as is condition, 'close outs', "liquidation and clearance sales", "open box", products missing accessories, or no fault found.

Proof of purchase in the form of a Bill of Sale, Receipt or Received Invoice is evidence the Product is within the limited warranty period. The Bill of Sale, Receipt or Received Invoice must be presented as a pre-condition to obtaining the limited warranty service.

This limited warranty begins on the original date of purchase and is valid only on Products purchased through authorized dealers and used In the United States, and Puerto Rico, by the original Purchaser. To receive warranty service, the Purchaser must first contact us for problem determination and service procedures. The original dated bill of sale, receipt or received invoice must be presented upon request as proof of purchase.

We will repair your product or if repairs cannot be made, we will replace it at no charge with the same or similar product. If the Product is defective as specified in this limited warranty during the limited warranty period, we may use new or remanufactured parts to repair the Product. All replaced parts and products become our property and must be returned to us. Replacement parts and products assume the remaining original limited warranty, or ninety (90) days, whichever is longer.

Product freight must be prepaid by you, the original Purchaser and shipped in either its original packaging or packaging affording an equal degree of protection. We will not be responsible for or obligated to replace damaged Products.

If the Product is received damaged, it is your responsibility as the consumer to file a claim against the carrier. We will only store the damaged Product for 30 days and reserve the right, in our sole discretion, to dispose of the damaged Product or ship it back to you at your expense after 30 days.

This limited warranty covers manufacturing defects in materials and workmanship encountered in normal, and except to the extent otherwise expressly provided for in this statement noncommercial use of this Product, and shall not apply to the following, including, but not limited to: Damage which occurs in shipment; delivery and installation; applications and uses for which this Product was not intended; altered Product or serial numbers; cosmetic damage or exterior finish; accidents, abuse, neglect, fire, water, lightning or other acts of nature; use of products, equipment, systems, utilities, services, hardware, supplies, accessories, applications, installations, repairs, external wiring or connectors not supplied or authorized by us or the manufacturer, which damage this Product or result in service problems; incorrect electrical line voltage, fluctuations and surges; customer adjustments and failure to follow operating instructions, cleaning, maintenance and environmental instructions that are covered and prescribed in the instruction book; reception problems and distortion related to noise, echo, interference or other signal transmission and delivery problems; burned-in images. Uninterrupted or error-free operation of the Product is not warranted.

THERE ARE NO EXPRESS OR IMPLIED WARRANTIES OTHER THAN THOSE LISTED AND DESCRIBED ABOVE, AND NO WARRANTIES WHETHER EXPRESS OR IMPLIED, INCLUDING, BUT NOT LIMITED TO, ANY IMPLIED WARRANTIES OF MERCHANTABILITY OR FITNESS FOR A PARTICULAR PURPOSE, SHALL APPLY AFTER THE EXPRESS WARRANTY PERIODS STATED ABOVE, AND NO OTHER EXPRESS WARRANTY OR GUARANTY GIVEN BY ANY PERSON, FIRM OR CORPORATION WITH RESPECT TO THIS PRODUCT SHALL BE BINDING ON US. REPAIR OR REPLACEMENT AS PROVIDED UNDER THIS LIMITED WARRANTY IS YOUR EXCLUSIVE REMEDY AS THE CONSUMER. WE SHALL NOT BE LIABLE FOR ANY INCIDENTAL, OR CONSEQUENTIAL DAMAGES FOR BREACH OF ANY EXPRESS OR IMPLIED WARRANTY ON THIS PRODUCT; EXCEPT TO THE EXTENT PROHIBITED BY APPLICABLE LAW, ANY IMPLIED WARRANTY OF MERCHANTABILITY OR FITNESS FOR A PARTICULAR PURPOSE ON THIS PRODUCT IS LIMITED FOR THE DURATION OF THIS LIMITED WARRANTY THIS LIMITED WARRANTY SHALL NOT EXTEND TO ANYONE OTHER THAN THE ORIGINAL PURCHASER OF THIS PRODUCT, IS NONTRANSFERABLE AND STATES YOUR EXCLUSIVE REMEDY.

Some states do not allow limitations on how long an implied warranty lasts, or the exclusion or limitation of incidental or consequential damages, so the above limitations or exclusions may not apply to you. This limited warranty gives you specific legal rights, and you may also have other rights, which vary from state to state. Any provision contained herein which is found contrary to state or local laws shall be deemed null and void and the remaining provisions shall continue in full force and effect.

To obtain warranty service:

Telephone: 800-976-0677



Monster and the M Monster logo are registered trademarks of Monster, Inc. and its subsidiaries in the U.S. and other countries, used under license.

The N-Mark is a trademark or registered trademark of NFC Forum, Inc. in the United States and in other countries.”

The Bluetooth® word mark and logos are registered trademarks owned by Bluetooth SIG, Inc. Other trade marks and trade names are those of their respective owners.

NWS, NOAA, and the NOAA Radio logo are registered trademarks of the National Weather Service in the United States and used with kind permission.