

**Neck Details:**

T:	Ø 1.078 ± .015 in	(20.70 mm)
E:	Ø .984 ± .012 in	(11.125 mm)
H:	Ø .400 ± .012 in	(10.6 mm)
J:	Ø 1.228 ± .015 in	(31.19 mm)
K:	Ø .708 ± .012 in	(17.983 mm)
F:	Ø .276 ± .012 in	(7.01 mm)
G:	Ø .759 ± .015 in	(19.26 mm)
L:	Ø .064 ± .012 in	(11.62 mm)
M:	Ø .676 ± .012 in	(17.21 mm)

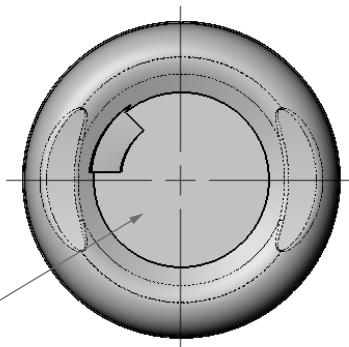
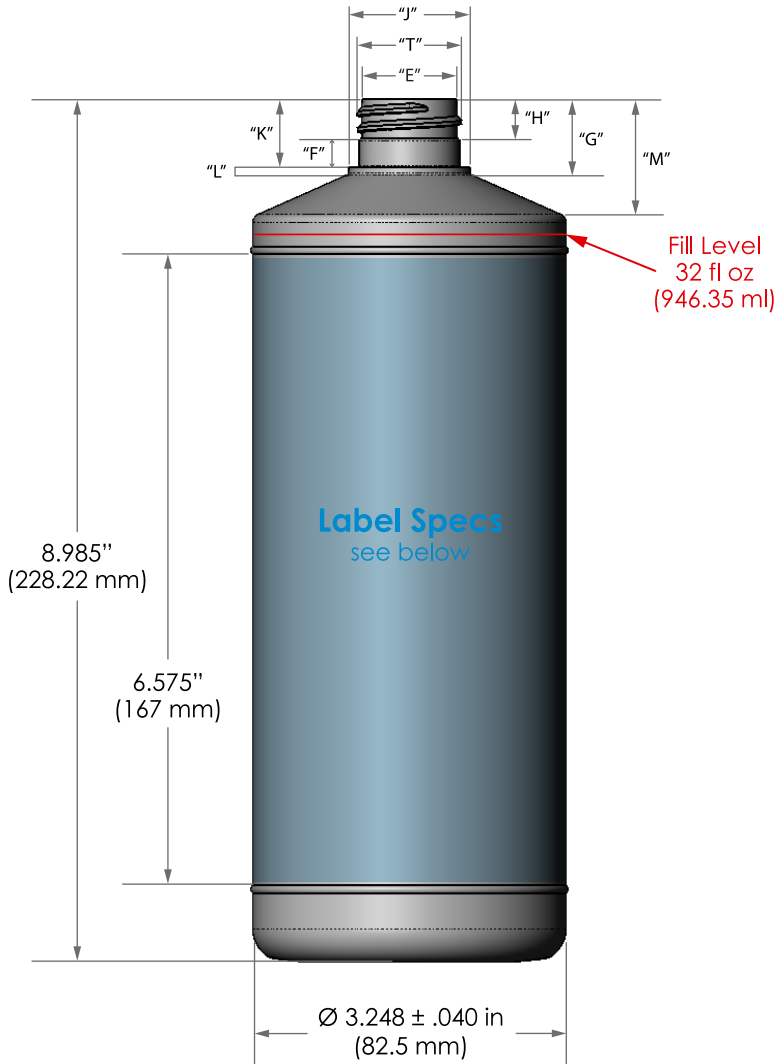

Recycle Logo, cav. no. & "DOT-2E-8-91" engraved

Unless otherwise specified, all dimensions are in inches.

Tolerances :  
angular ±  
x.xx ± 0.060"  
x.xxx ± 0.050"

Note: Sizes are preliminary and subject to development.

**Label Specs:**

10.645 in (270.38 mm) L x 6.325 in (160.655 mm) H x .08 in (2.03 mm) CR  
Note: Length accounts for .125 in space between label ends.

Target Weight: 53 ± 2 g

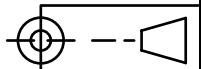

Revised:	
Revised:	
Revised:	
Revised: 4/8/24	spec corrections, label specs

**32oz HDPE Cylinder (28-410)**

Material: High Density Polyethylene (HDPE)	
Neck: (28-410)	Fill Vol: 32 fl oz (946 ml)
Scale: 1 : 2	Overflow: 1029 ± 15 ml



**Aaron Packaging**  
4000 150th Avenue Court East  
Sumner, WA 98390  
360-889-0152  
www.aaronpackaging.com

Drawn by: CML EW	Dwg. no. : 3597
Created: 5/12/21	Mold no. :