

QUICK START GUIDE



pooliprint. XL

TABLE OF CONTENTS

In the box	1
My PooliPrinter parts	2
How to use	3
Download the Pooli App	4
Bluetooth connection	5
How to replace a paper roll	6
Paper roll size selection	7

IN THE BOX



PooliPrinter XL



PooliPrinter
White Roll x1
(Inside the Printer)

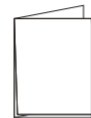

Quick Start Guide



USB Cable

MY POOLIPRINTER PARTS

- 1 Power Light
- 2 Power Button
- 3 Paper Output
- 4 Cover Opening Button
- 5 USB Connector

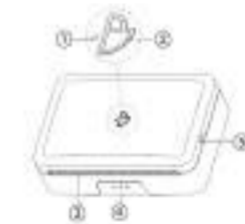

- 1 Print Head
- 2 Paper Roll Holder
- 3 Scroll Wheel
- 4 Cover Lock
- 5 Reset Button



HOW TO USE

Powering ON/OFF

Hold power button for 3 seconds to turn ON/OFF PooliPrinter XL.

Light Status

- Green: Standby / Charging Completed
- Green Flash: Charging / Updating
- Red Flash: Out of paper roll / Cover Open / Low Battery

Recharging

Fully recharge your device before the first time use.
It can be recharged from a USB charger.
It takes about 90 minutes to fully recharge.

1

2

3

DOWNLOAD THE POOLI APP



SCAN ME

4

BLUETOOTH CONNECTION

- Open the App and click "CONNECT"
- Connect to the device by searching for Bluetooth devices and select "Pooli_L3"

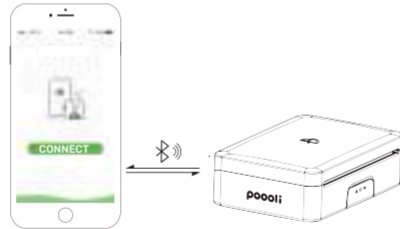

5

HOW TO REPLACE A PAPER ROLL

- Beware fingers pinching when opening cover as shown on Figure 1
- Press the cover opening button to open cover and
- Place the roll of paper coming out as shown on Figure 2
- Once the paper roll is properly installed you can close the cover back to its original shape.

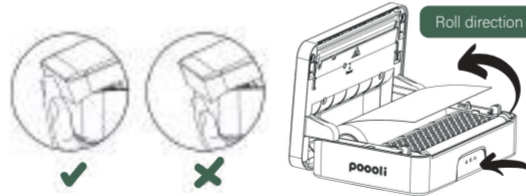

Figure 1

Figure 2

6

PAPER ROLL SIZE SELECTION

To user paper rolls of different sizes move both paper rolls holders to their corresponding slots

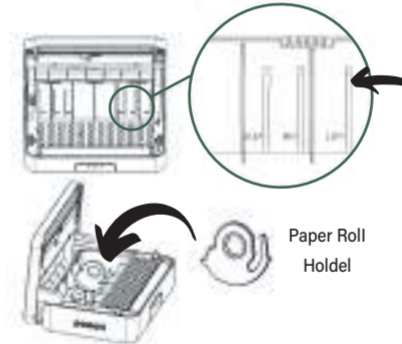

7

pooliprint.
your daily life

ENJOY 15% OFF YOUR ORDERS
LIFETIME WITH CODE LIFE15

PLEASE TAG US ON SOCIAL MEDIA
FOR YOUR CHANCE TO BE FEATURED!



www.pooliprint.com