

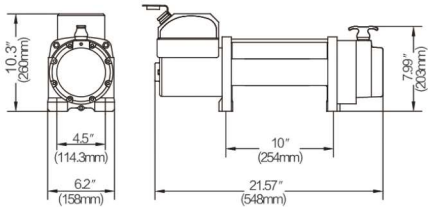

Challenger series NVT12000



12VDC Line speed and motor current (first layer)

Line pull (lbs/kg)	Line speed (fpm/mpm)	Motor current (amps)
0/0	19/5.7	90
4000/1816	15.7/4.8	180
6000/2724	7.9/2.4	280
8000/3632	5.9/1.8	350
12000/4448	3.3/1.0	460

24VDC Line speed and motor current (first layer)

Line pull (lbs/kg)	Line speed (fpm/mpm)	Motor current (amps)
0/0	15.1/4.6	70
4000/1816	7.9/2.4	90
6000/2724	6.6/2.0	130
8000/3632	5.6/1.7	165
12000/4448	3.3/1.0	260

Line pull and cable capacity

Layer of cable	Rated line pull per layer (lbs/kg)	Cable capacity per layer (ft/m)
1	1200/544	17.7/5.4
2	89569/4344	40.0/12.2
3	7949/3609	66.9/20.4
4	6801/3088	85.3/26

SPECIFICATIONS:

- Rated line pull:** 12000lbs(5448kg) single line
- Motor (Series wound):** DC 12V with 5.3hp/3.95kw, DC 24V with 6.8hp/5kw
- Gear train:** 3 stage gear-driven
- Gear ratio:** 196:1
- Clutch:** Pull and turn
- Braking action:** Mechanical, Automatic load holding
- Fairlead:** 4-way roller fairlead
- Wire rope:** 3/8" x 95' (9.2mm x 26m)
- Drum size:** 22.5" x 8.8" (65mm x 224mm)
- Dimensions:**
 - NVT12000** 21.57" x 6.2" x 10.3" (548mm x 158mm x 260mm)
 - NVT12000-S** 21.57" x 6.2" x 10.63" (548mm x 158mm x 270mm)
- Bolt pattern:** 10" x 4.5" (254mm x 114.3mm)
- Net Weight:**
 - NVT12000** 92lbs(41.8kg)
 - NVT12000-S** 95.2lbs(43.2kg)

