

RHINO-RACK

Rhino Master Fit Luggage Boxes

RMFT320, RMFT370, RMFT410, RMFT530

- Important:**
- 1. Please refer to your fitting instruction to ensure that the roof racks are installed in the correct locations.
 - 2. Check the contents of kit before commencing fitment and report any discrepancies.
 - 3. Place these instructions in the vehicle's glove box after installation is complete.
 - 4. These instructions must be followed for warranty to be upheld.

Layout

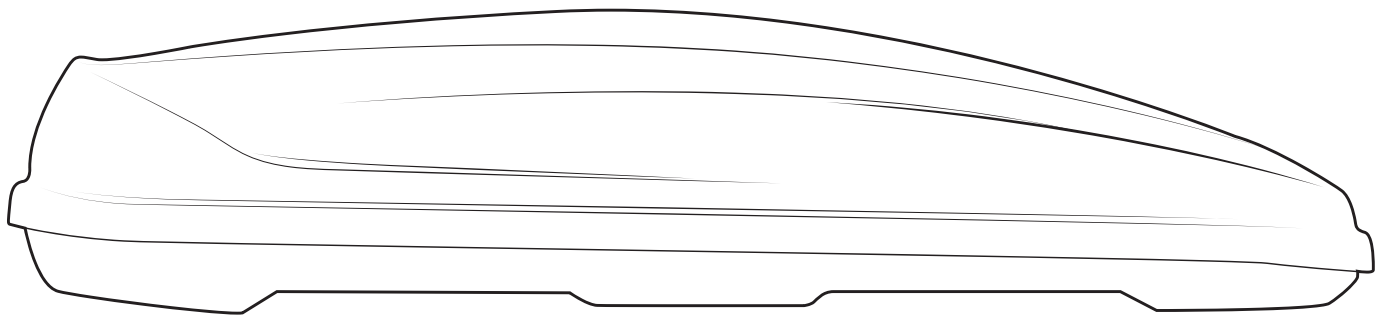

Important

Luggage Box	On Road Cargo Allowance	Off Road Cargo Allowance	Roof Allowance	Luggage Box Weight
RMFT320	60kg / 132lbs	45kg / 99lbs	75kg / 165lbs	15kg / 33lbs
RMFT370	60kg / 132lbs	45kg / 99lbs		15kg / 33lbs
RMFT410	57kg / 125lbs	42kg / 92lbs		18kg / 39lbs
RMFT530	54kg / 119lbs	39kg / 85lbs		21.5kg / 47lbs

Item	Component Name	Qty
1	Key	2
2	Claw	4
3	Strap	2
4	Fitting Instruction	R1422

Tools required: Measuring tape.

NOTE: Before using your luggage box on a journey, make sure the box is securely mounted on the racks and the lid is properly closed and locked with the key.

Record your key number here for future reference, in case of misplaced or lost keys

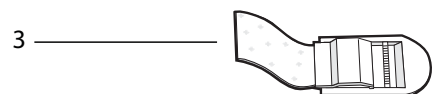
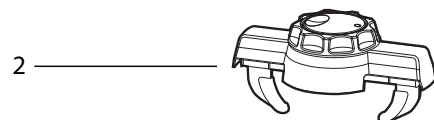
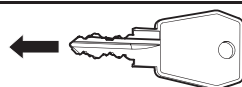



RMFT320, RMFT370, RMFT410, RMFT530

1

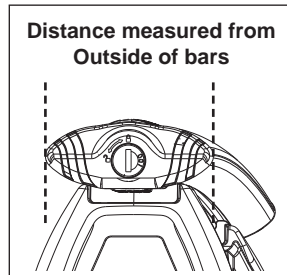
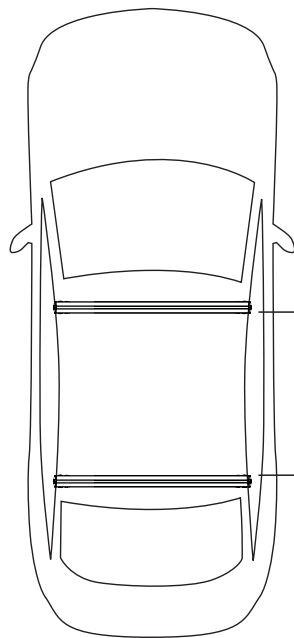

Distance measured from
Outside of bars

Refer below

RMFT370
MIN 550 mm
MAX 890 mm

RMFT320, RMFT410, RMFT530
MIN 550 mm
MAX 1000 mm

Vortex

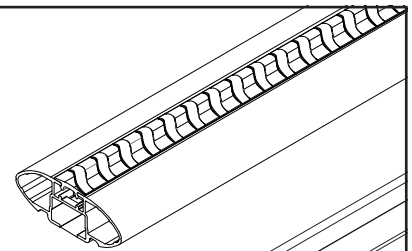

ROLA BAR

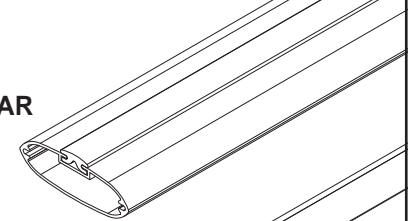

THULE AERO

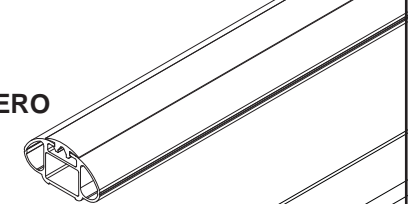

EUROPEAN

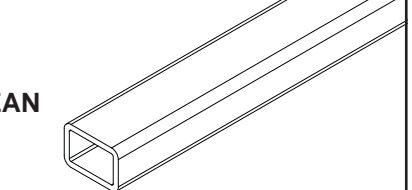

2

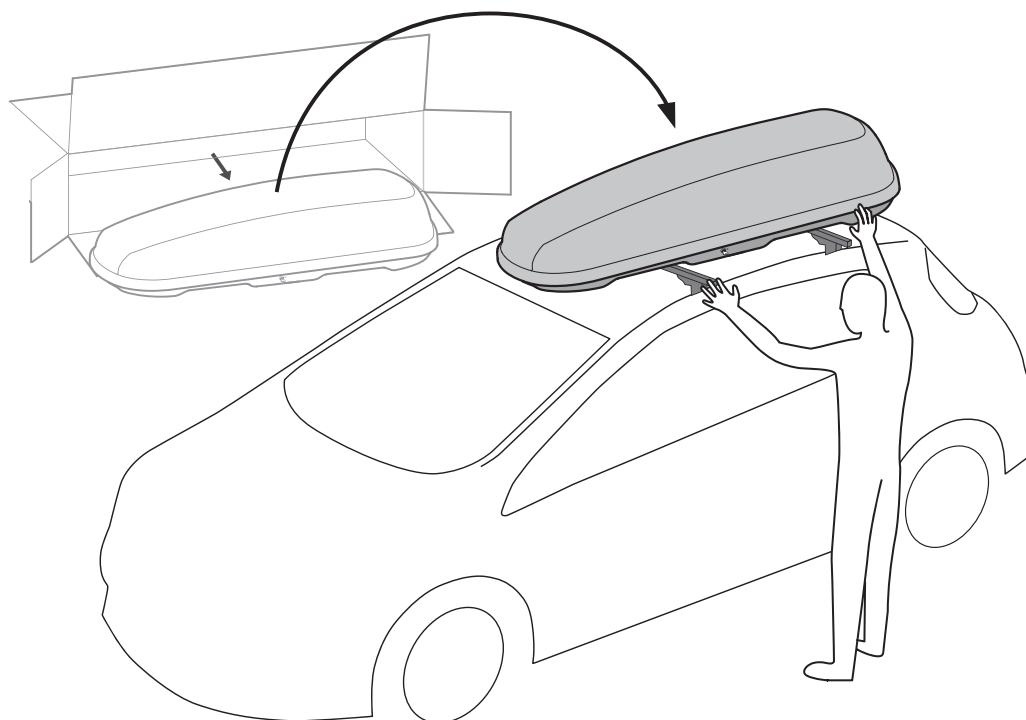
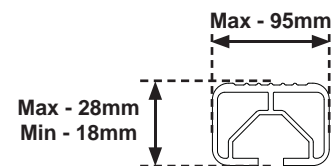
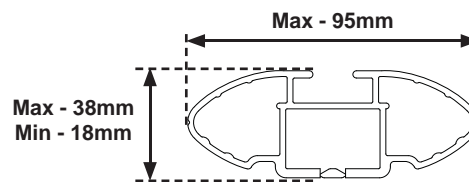



RMFT320, RMFT370, RMFT410, RMFT530

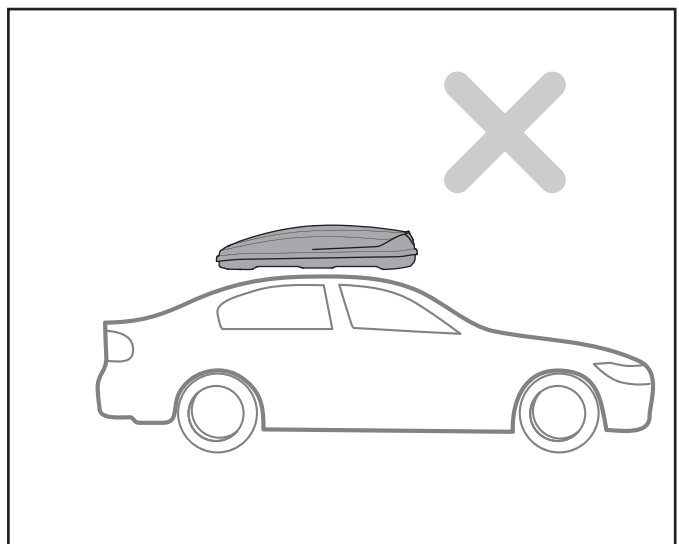
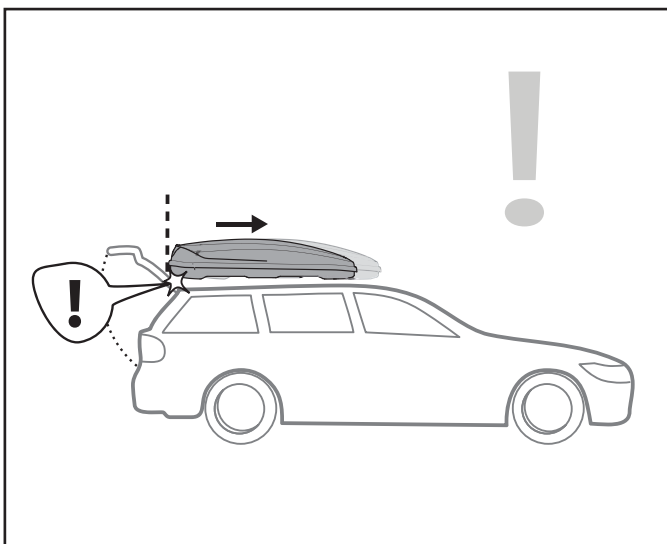
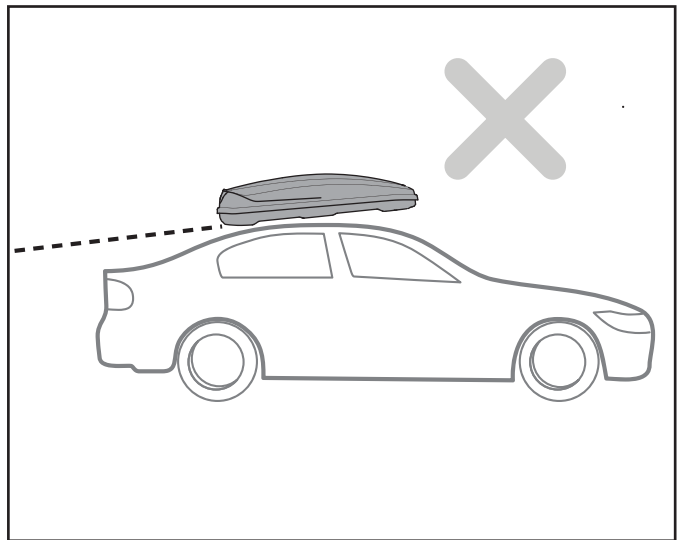
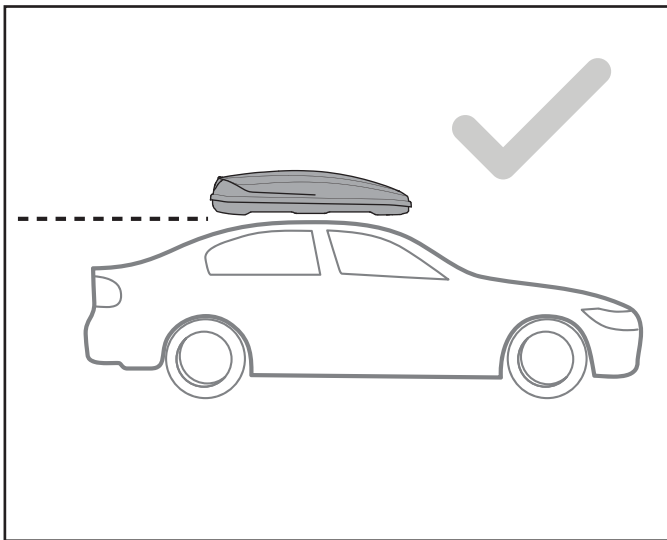
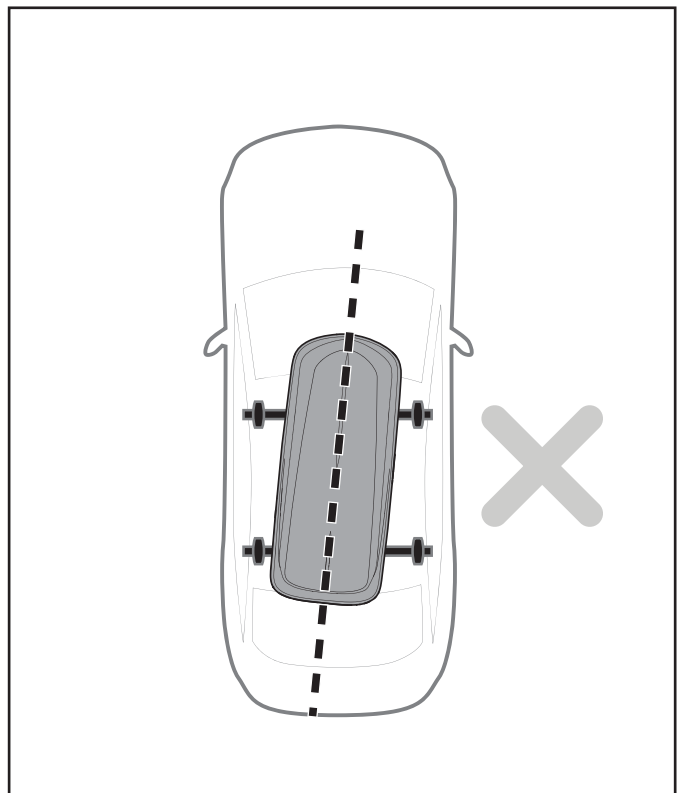
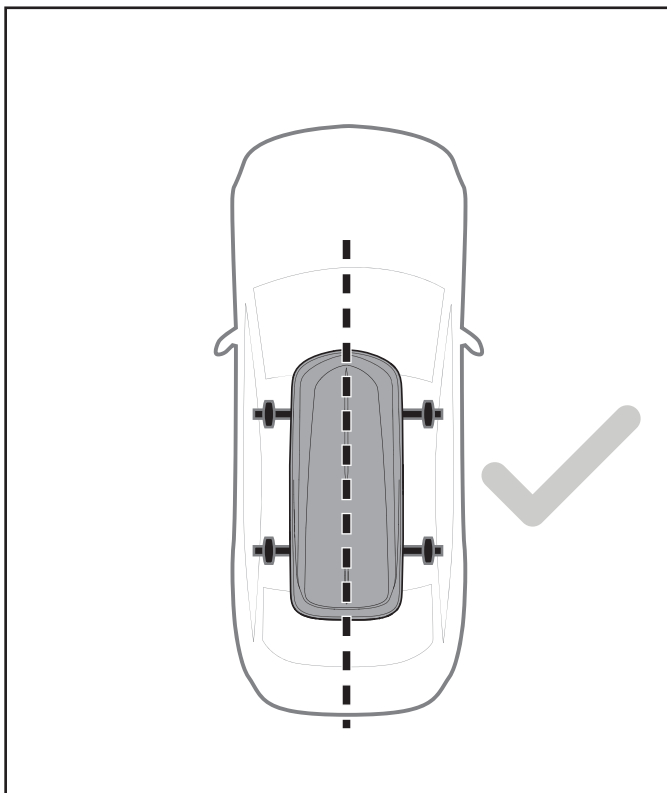



RMFT320, RMFT370, RMFT410, RMFT530

3 After positioning your luggage box, unlock the box and lift the lid open.

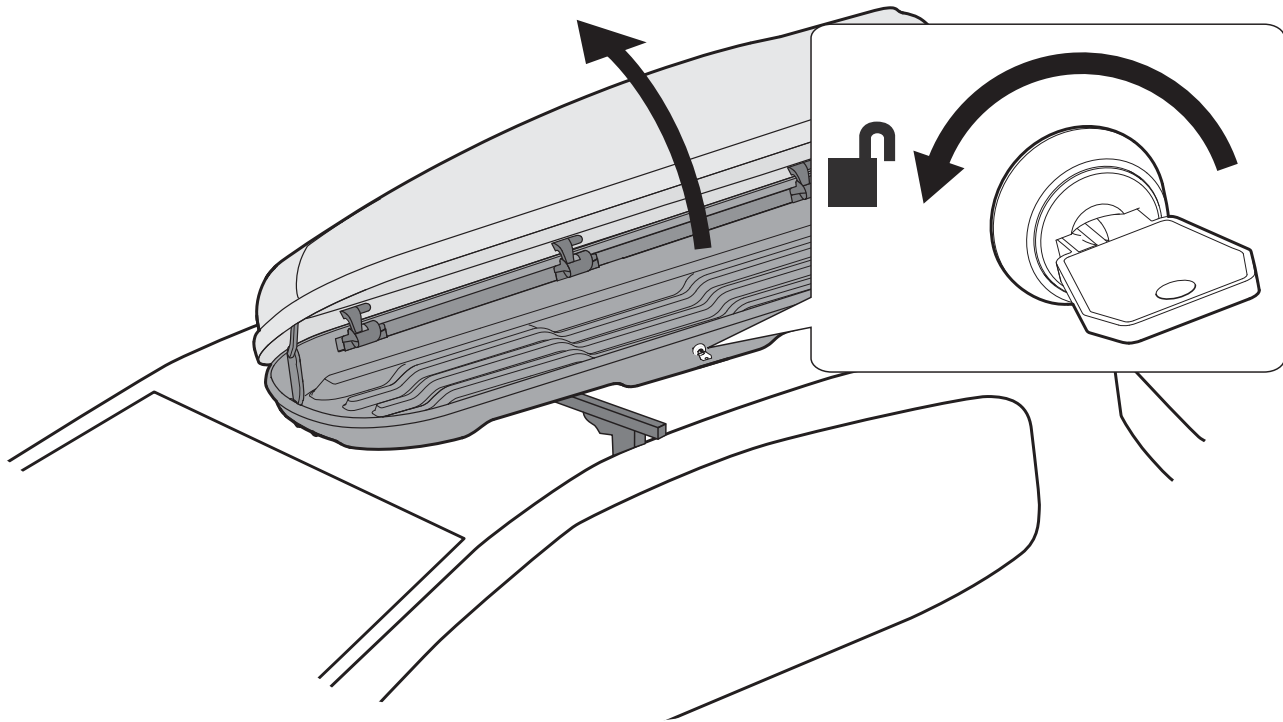

4 Position the claws as shown, aligned with the crossbars underneath.

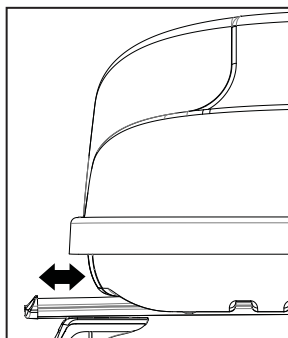
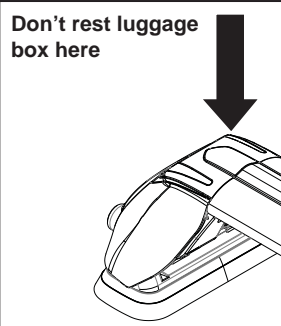

Make sure that the luggage pod sits away from the leg and the end cap

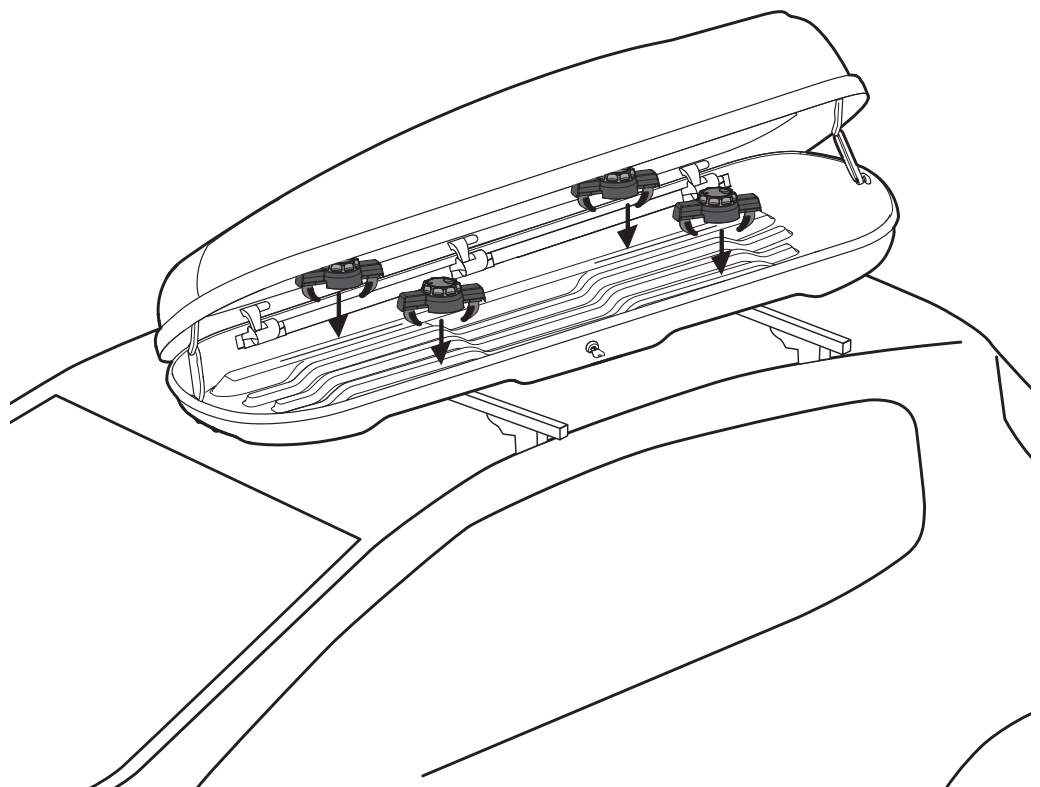



RMFT320, RMFT370, RMFT410, RMFT530

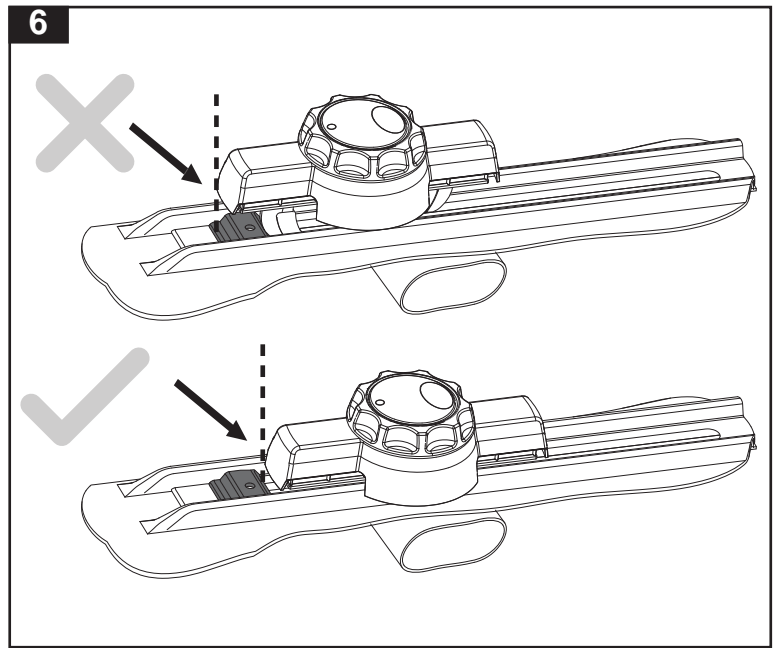
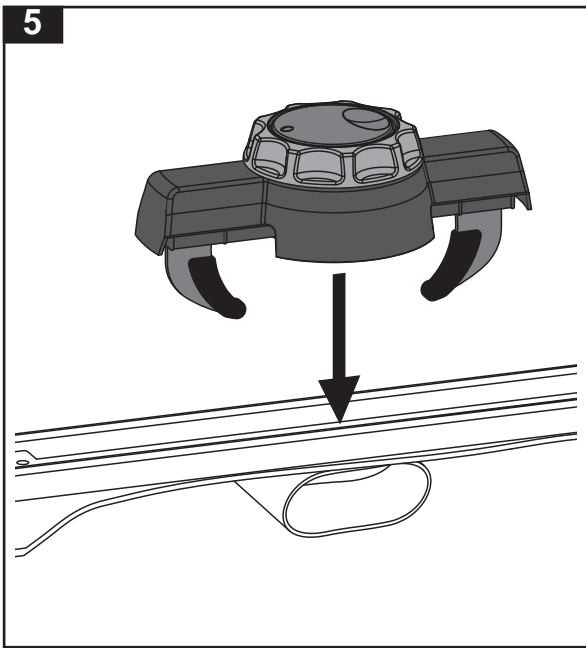

7 Tighten each claw as shown. Make sure that all claws are tightened.

1



2



3

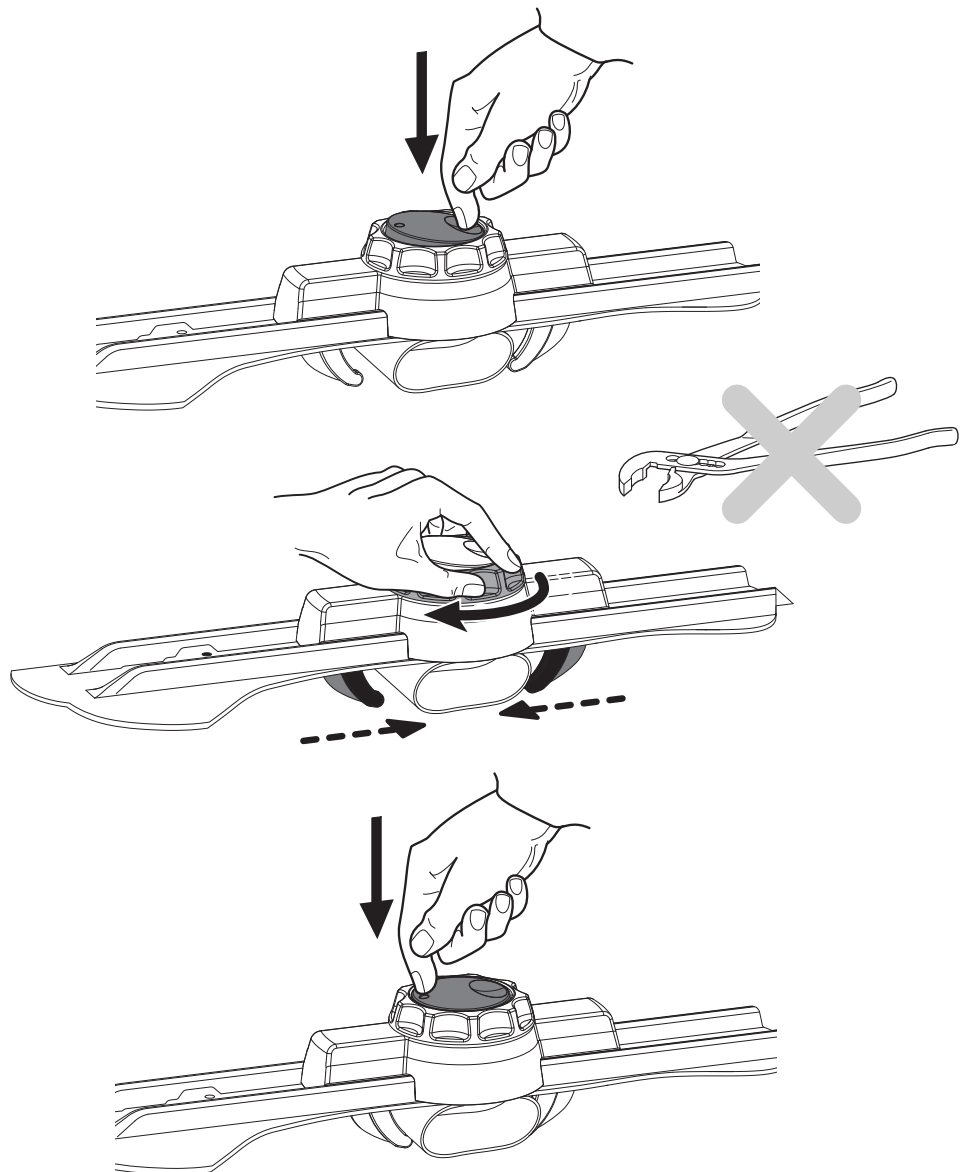



RMFT320, RMFT370, RMFT410, RMFT530

8 Use supplied straps to secure load.

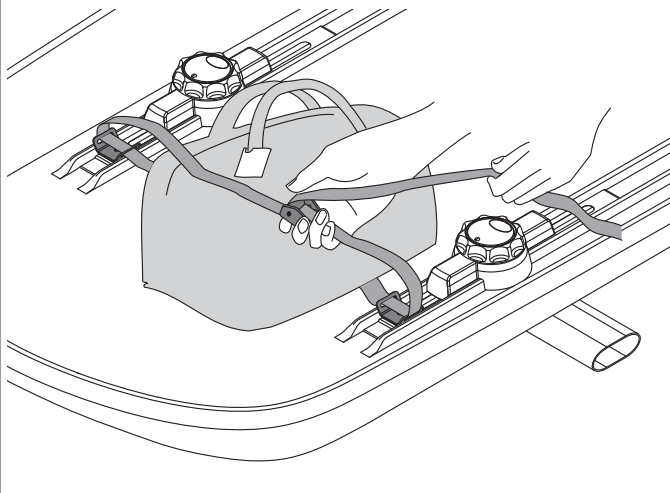

9 Distribute load evenly as shown.

Max. 75 KG

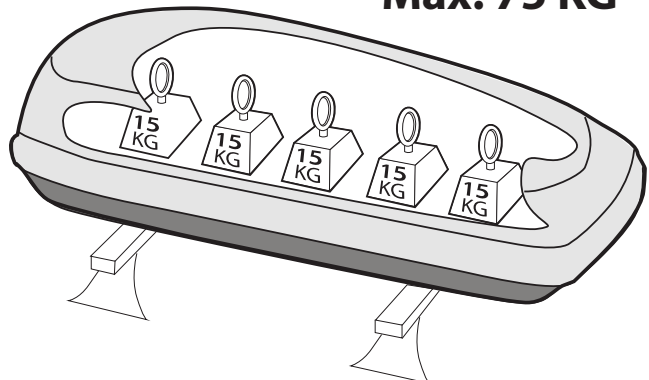

10 Close the box and lock it. Write lock number down at the front of this instruction.

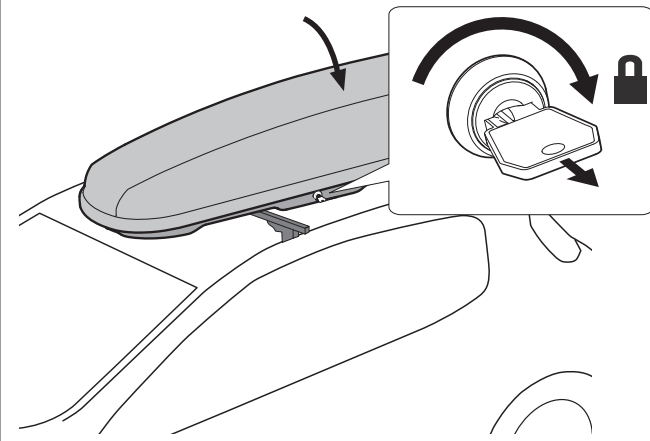

11 Only install the box from the passenger side.

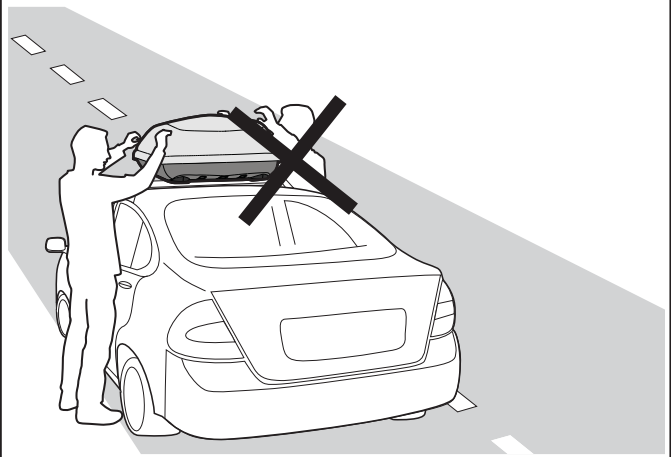

12 Remove luggage box and crossbars before entering an automatic carwash.

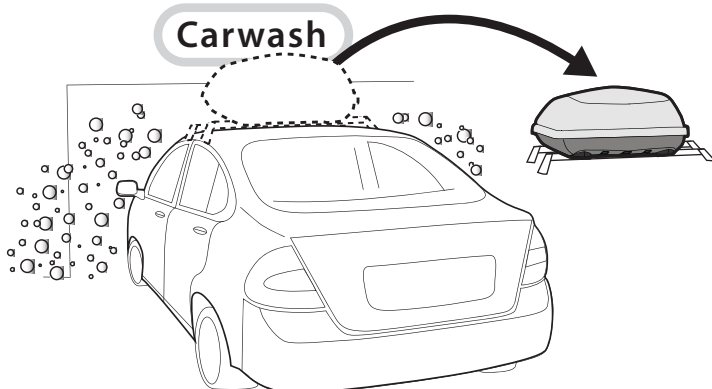

Please take note of the added height of the car due to the crossbar and luggage box.



Clean the box with tap water and possibly with car shampoo. Never use the following products to clean the box or remove stains: cleaning agents, oil, solvents and cleaning products that contain alcohol, chloride and ammonia. These products have an impact on the box material and result in irreparable damage/dischouring.

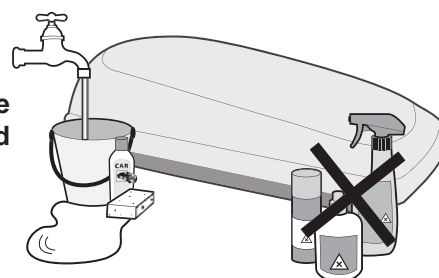



RMFT320, RMFT370, RMFT410, RMFT530

Important Information

Maximum luggage box load carrying capacity: See front page.

Recommendations:

Follow these instructions carefully when mounting and using your luggage box. If you notice one or more parts are missing, please contact your dealer and do not use or install the luggage box. Do not load the luggage box in such a way that the lid cannot be easily closed. Open and close the lid using both hands. The maximum roof load of your car as specified by the car manufacturer must not be exceeded. Note that the total roof load consists of; the weight of the luggage box, the weight of the Roof Racks and the weight of the luggage box contents.

Warning:

Be aware that the luggage box has significantly raised the overall height of your vehicle, this may affect your ability to enter garages etc. Do not operate the luggage box while on the side of the road, you may become distracted to oncoming traffic. Do not store luggage box in direct sunlight for extended periods of time. Do not carry corrosive or combustible materials within the luggage box. Evenly distribute weight within the luggage box. Do not carry live animals within the luggage box.

Load Ratings:

The maximum load of the roof box is 75kg. Any sharp / pointed items in your luggage box should be properly protected in order to prevent damage. Make sure that the contents of the luggage box are properly secured and cannot move about while the car is moving. Car wash and water can be used to clean the luggage box. It is recommended that the luggage box be cleaned before storing it for extended periods.

Sensitivity to Crosswinds, Behaviour in Curves and Braking.

Remember that the luggage box may affect the road holding of your car (e.g. sensitivity to crosswinds, cornering and braking). The maximum speed with box fitted is 130km/h. Before driving off, make sure that your luggage box is properly secured to the roof racks and that the lid is closed.

Check:

After turning the luggage box lid key, the lid should not be able to be opened manually. Record down the number on the keys for future reference. To reduce fuel consumption remove the luggage box when not in use. Check the connection claw every 500km to ensure it is securely attached to roof rack.

Please remove luggage box and crossbars when putting vehicle through an automatic car wash.

Note for Dealers and Fitters

It is your responsibility to ensure instructions are given to the end user or client

Rhino-Rack

3 Pike Street, Rydalmere,

NSW 2116, Australia.

(Ph) (02) 9638 4744

(Fax) (02) 9638 4822

Document No: R1422

Prepared By: Kayle Everett

Authorised By: Chris Murty

Fit Time 20min

Issue No: 02

Issue Date:16/01/2017

These instructions remain the property of Rhino-Rack Australia Pty Ltd and may not be used or changed for any other purpose than intended.