

## C2 Cartoon Digital Camera Manual

Please read the manual carefully before using, and safekeep the warranty card as warranty certificate.

www.thezoofamily.com

### Button/Hole Position Instruction

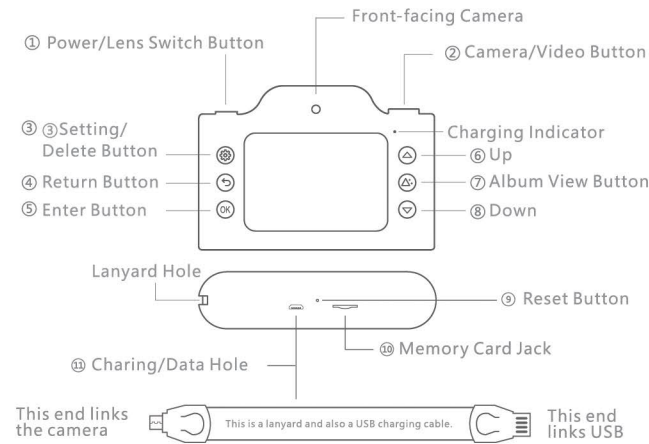

### Function Description

- ④ Power/Lens Switch Button: Long press for 2 seconds to ON/OFF, Single press to switch front and rear camera.
- ② Camera/Video Button: Single press to camera, long press for 2 seconds to video.
- ③ Setting/Delete Button: In camera mode, press to enter settings; In album mode, press to delete photos.
- ④ Return Button: In any mode, press to return to normal photo mode.
- ⑤ Enter Button: Under the settings interface, press to enter option; when choosing it can confirm selection.
- ⑥ Up/Zoom In Button: Single press to switch different photo modes, long press to zoom in.
- ⑦ Album View Button: Press to enter album, Up/Down Button for switch, press again to exit album.
- ⑧ Down/Zoom Out Button: Single press to switch different photo modes, long press to zoom out.
- ⑨ Reset Button: If the camera can't be turned off or crashes, please use toothpick or steel needle to insert reset hole, press the Reset Button, turn it on again after automatic shut-down, then it can restore factory settings.
- ⑩ Charing/Data Button: It can be charged by the 5V charger USB port, and it can be connected to the computer's USB interface to read the photos and videos taken. (Warning! It can't be used during charging! Please don't let children operate.)
- ⑪ Freely expand memory capacity, maximum support for 32G TF card.

### Anleitung der Verbindung

#### ① WIFI-Verbindung

Tap Setting Button③, select WIFI connection, press OK button, choose to open, press OK button again, then it enter the WIFI connection interface, open the WIFI setting of mobile phone, connect to the WIFI name on the camera interface, after successful connection, open the app and tap to connect, the photos and videos in the camera can be read.

#### Attention:

1. Please open APP connection after WIFI successful connection, if you want to view HD pictures please download the original image, if you want to view videos please download before watching.
2. WIFI transmission speed is affected by mobile phone configuration, environment and other factors.
3. Please keep the APP up to date, it will bring better experience.

#### ② Data Line Connection

Use a data cable to connect to the computer, then the data of the camera can be read.

### Icon Instruction

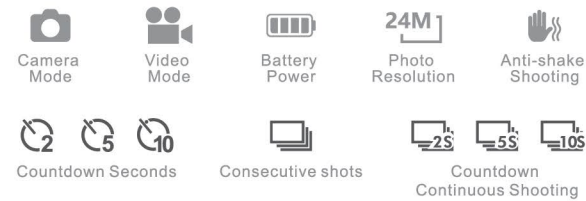

App Download



### Specifications

**Product Name:** Kids Digital Camera  
**Product Model:** C2  
**Battery Capacity:** 750mAh  
**File Format:** JPG, AVI  
**Screen Size:** 2.0Inch IPS Full View Screen  
**Charging Time:** About 2.5 hours  
**Input Voltage:** DC5.0V=1A  
**Auto Power-off:** 2min  
**Storage:** TF card extended storage, maximum support 32GB  
**Camera Weight:** 70g  
**Camera Size:** 85mm\*58mm\*43mm  
**Suitable:** Over 3 years old  
**Camera Function:** WIFI transmission, photograph, video, photo stickers, filter, continuous shooting, timer, timed continuous shooting  
**Language:** Chinese Simplified/Traditional Chinese, English, Korean, Japanese, German, Thai, French, Russian  
**Package Included:** Camera X1, Camera Case X1, data cable lanyard X1, cartoon stickers X1, manual X1

### Precautions (Must Read)

- ① If there is something wrong with the camera, please use steel needle to insert reset hole and press the Reset Button. Reset can solve more than 80% problems, please don't separate it by yourself, in order to avoid danger and unable to warranty.
- ② When the camera indicates that the battery is low, please use the Micro USB charging cable included in package to plug in power converter or computer USB port for charging. This product doesn't include a power charger.
- ③ Please don't throw or squeeze the camera to avoid damage to internal electronic components.
- ④ The camera is an electronic product and isn't waterproof. Please don't expose it to splashing water.
- ⑤ Important information and warranty card are included in package and manual. Please keep for future reference and warranty.
- ⑥ Should be disconnected from the transformer before using liquid cleaning.
- ⑦ The wires, plugs, housings and other components of transformer for charging or battery charger must be checked regularly for damage. Stop using when it is found to be damaged, until it is well repaired. Please don't use charger of poor quality for charging.
- ⑧ The camera can't be connected to more than one power supply.
- ⑨ Only be charged using the recommended transformer. Transformer is not a toy so don't allow children to charge.

**This product enjoys a one-year free maintenance policy from the date of purchase. Please try resetting or unplugging the card before you send the repair product. If it still fails to solve, please contact customer service to confirm the cause of the product failure.**

#### The following conditions are not included in the free repair scope:

- ① Product failure or damage caused by failure to use or maintain as required by the instruction manual.
- ② Accidental factors or human factors cause damage to the product.
- ③ Unauthorized dismantling and repair without our permission.
- ④ Exceeding the warranty period.
- ⑤ Wear, corrosion, discoloration, etc. under normal use.

#### Troubleshooting

Malfunction	Malfunction Type	Solution
A	Unable to turn it on	Please try to replace the charger and then turn it on.
B	Prompt memory card error	Please format the memory card or replace the memory card.
C	Crash, unable to turn it off	Press the reset button and restart.