

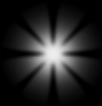

Dual Beam Halogen
NiMH

Classic Plus



USER GUIDE



DISCOVER THE NIGHT!

Thank you for choosing Classic Plus™ from NiteRider, the innovator in technical lighting systems. Classic Plus is a dual-beam halogen system that charges quickly and uses a thumb-operated remote switch for safe, easy access to three lighting modes.

To get the most from your NiteRider light, we urge you to familiarize yourself with the following safety and operation instructions.

NiteRider and Classic Plus are trademarks of NiteRider, Inc.
All other trademarks are the property of their respective owners. The information in this document is subject to change without notice.

RIDING AT NIGHT

While the Classic Plus will improve your control and enjoyment of night riding, please remember that cycling at night is an inherently dangerous activity. In addition to using your lighting system properly and riding with extreme caution, NiteRider urges you to:

- never ride alone
- always let someone know where you are going
- wear a helmet and reflective clothing
- carry an auxiliary light and emergency supplies.

PROTECTING YOUR INVESTMENT

When not in use, always disconnect the headlamp from the battery. To unplug, grasp the connector, not the cable.

Properly charge your battery to maximize its lifespan (see “Battery Charging and Care” on page 10). To avoid damaging your system, only charge your NiteRider battery with the appropriate NiteRider charger.

While Classic Plus will perform in wet weather conditions, submerging it in water will damage the system. If you need a submersible light, NiteRider manufactures industrial-grade dive light systems. For information, contact NiteRider Dive Lights at 858.268.3850 or visit www.niteriderdive.com.

SUPPORT

If you experience difficulties during product installation or operation, NiteRider provides free telephone support on weekdays from 8:00 AM to 4:30 PM (Pacific Time) at 800.466.8366, ext. 4. You may also e-mail us at support@niterider.com.

WARRANTY

NiteRider stands behind its products with the following warranties:

- Lifetime warranty on all mechanical components
- 1 year on cables and connectors, electronic components, and printed circuit boards
- 180 days on rechargeable batteries and fast chargers
- 60 days on halogen bulbs

To repair or replace your product while under warranty, return it (postage prepaid and insured with original sales receipt) to the address below. Out-of-warranty repair service is also available. For complete warranty information, please visit our website..

NiteRider, Inc.
8205 Ronson Road, Suite E
San Diego, CA 92111 USA
800.466.8366
www.niterider.com

Parts List and Identification	4
Quick Start	5
Mounting the Headlamp	6
Universal Handlebar Mount	6
Inserting the Headlamp	7
Mounting the Battery	8
Operation	9
Battery Charging and Care	10
Using the 2.5-hour Fast Charger	10
Battery Initialization	10
Smart Battery Protection	11
Storage	11
Run Times	12

PARTS LIST AND IDENTIFICATION

Please verify the contents of your Classic Plus system:

- A. 12/20/32 Watt halogen headlamp
- B. 4.0 Ah-13.2 Volt NiMH battery (frame mount)
- C. 2.5-hour fast charger
- D Charger power cord

- E. Universal handlebar mount
- F. Velcro cable tie

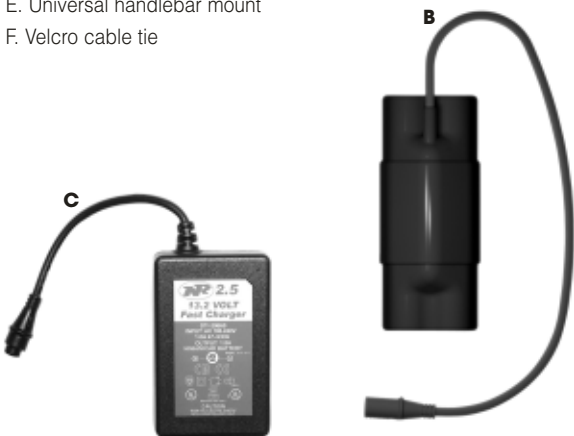



QUICK START

1. Fully charge the battery before the first use. See “Using the 2.5-hour Fast Charger” on page 10.
2. To mount the headlamp and battery, see “Mounting the Headlamp” on page 6 and “Mounting the Battery” on page 8.
3. Connect the battery to the headlamp.
4. Press and release the remote switch to turn the system on, to cycle between the three light modes, and to turn the system off.

MOUNTING THE HEADLAMP

Universal Handlebar Mount

The Universal Handlebar Mount (UHM) is designed to fit on virtually any handlebar. Included with the mount is a 2.5-mm Allen wrench, a pair of black rubber bumpers already in place, and a thin rubber shim to customize the fit on large handlebars up to 32 mm in diameter.



Turn the knob counter-clockwise, allowing the hinge to swing open. Place the mount on the handlebar on the left side the stem, orienting the rectangular notch in the slider clip to the rear. Swing the hinge down to make contact with the handlebar. Swing the hex bolt up, seating the knob into its recess. Turn the knob clockwise to tighten and secure the mount to the handlebar.

The UHM can be adjusted to accommodate any handlebar angle. By loosening the 2.5 x 30 mm Allen screw, you can move the swing arm back and forth to straighten the headlamp. Tighten the 2.5 x 30 mm screw after the adjustment.

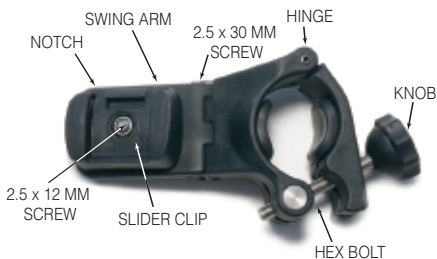

To pivot the headlamp, loosen the 2.5 x 12 mm screw located under the slider clip and swing arm and rotate the headlamp to the desired position. Make this adjustment before tightening the 2.5 x 30 mm screw.

Inserting the Headlamp into the UHM

Insert the headlamp mount into the UHM slider clip from the rear of the slider clip forward. Gently rocking the lamp as you slide it may help. Do not push the release lever when inserting the headlamp into the slider clip; let the lamp snap into place by itself.

Secure the remote switch to the handlebar with the Velcro strap so that the remote switch is easily accessed by the thumb while riding.

To remove the headlamp, push the release lever and slide the lamp backward.

Note: After mounting the headlamp, adjust the headlamp so it illuminates the road properly without distracting oncoming riders.

MOUNTING THE BATTERY

The NiMH battery is mounted to the bike frame.

1. Thread the wide Velcro strap through the slots on the top of the battery clip.
2. Attach the concave surface of the battery to a safe, convenient location on the frame (typically under the top or down tube), placing the Velcro strap over the tube but under any shift or brake cables.
3. Secure the handlebar cord to the frame using the thin Velcro tie. Make sure the cord does not interfere with any moving parts.

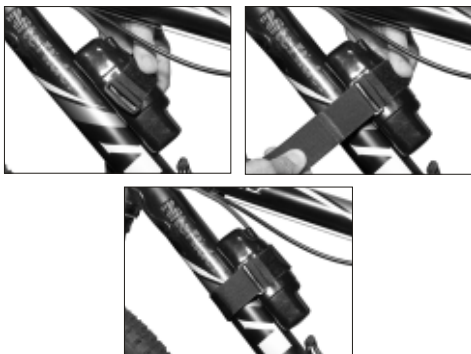

1. Connect the battery cord to the headlamp.
2. Press and release the thumb-operated remote switch once to turn on the 12-watt spotlight.
3. Press and release the remote switch a second time to turn on the 12-watt spotlight and 20-watt floodlight simultaneously.
4. Press and release the remote switch a third time to turn on only the 20-watt spotlight.
5. Press and release the remote switch a fourth time to turn off the system.

Warning: To protect the battery from over-discharging, turn off the lamp before it reaches complete darkness.

Warning: Headlamps require adequate airflow during operation (as in riding conditions). NiteRider discourages use of the light in stationary conditions as excessive heat retention can damage the lamp.

BATTERY CHARGING AND CARE

Rechargeable batteries can last years with proper care. Most importantly, fully charge your battery:

- before the first use
- after each use
- before storing
- every 45 to 60 days when not in use.

Using the 2.5-hour Fast Charger

Note: The charger will charge a fully depleted battery in approximately 2.5 hours.

1. Plug the power cord into the charger and then the wall socket. The charger will conduct a self-diagnosis and the charging indicator light (located on the back, upper-left corner of the charger) will illuminate green, then amber, and then back to green.
2. Connect the charger cable to the battery. If the battery is not fully charged, the indicator light will turn amber, signifying fast-charge mode. If the light flashes when you first plug in the battery, the charger is preparing an overly discharged battery for fast charging.
3. When the battery is fully charged, the indicator light will turn green and charging will shut off automatically.
4. Unplug the charger from the battery and wall socket, grasping the connectors rather than the cables. (Leaving the battery and charger connected indefinitely will not harm the cells.)

Battery Initialization

Until the battery has been charged and discharged up to ten times, you may experience shorter than expected run times as well as higher than normal charger and battery temperatures.

Warning: NiteRider discourages battery initialization through “bench testing” (operating the light in static conditions) as the excessive heat generated can damage the headlamp.

Smart Battery Protection

Classic Plus’ “smart” battery incorporates thermal protection circuitry that turns the battery off when it overheats from charging, external heat, or a short circuit. When the thermal protection circuit is activated, the system will lock and the fuel gauge will become dark. To clear the system and return it to normal operation, unplug the light from the battery and allow the battery to cool.

Warning: It is important to avoid over-discharging the battery. When operating the light, turn the lamp off before it reaches complete darkness.

Storage

Rechargeable batteries perform better and last longer if they are brought to a complete charge before storing and every 45 to 60 days when not in use.

Disconnect the battery from the headlamp, and store the system in a cool dry place.



RUN TIMES

<u>Setting</u>	<u>Run Time (hours)</u>
12 watt (spot)	3:10
20 watt (flood)	2:00
32 watt (spot and flood)	1:20

Run times are approximations and will vary.



NiteRider, Inc.
8205 Ronson Road, Suite E
San Diego, CA 92111 USA
800.466.8366
www.niterider.com