

BATTERY CHARGING AND CARE

1. Plug the AC Adapter into an electric outlet, then plug the cable from the AC Adapter into the battery.
2. The LED indicator on the battery will turn red while the battery is charging. When the battery is fully charged, the LED will turn blue.
3. Unplug the AC Adapter from the battery by grasping the connectors rather than the cable.
4. Always store your battery away with a full charge.
For extended periods, charge the battery every three months to maximize its lifespan.

USB OUTPUT PORT

Your battery pack is equipped with a USB output port for convenient recharging of electronic devices.

1. Plug in your USB adapter cord (not supplied) into USB output port, then connect your electronic device to charge.

Please note to power off lighting system before recharging your electronic device



USB OUTPUT PORT

RUN TIMES

PRO 2800 Enduro Remote

Low	6:00h	825 Lumens
Med	3:00h	1400 Lumens
High	1:30h	2800 Lumens
Flash	>56:00h	
Race	17:00h	375 Lumens
Walk	56:00h	125 Lumens

PRO 3600 Enduro Remote

Low	6:00h	1000 Lumens
Med	3:30h	1800 Lumens
High	1:30h	3600 Lumens
Flash	>16:30h	
Race	16:30h	450 Lumens

*Run times are approximations and will vary.

**Race mode is intended for endurance races.

RIDING AT NIGHT

While a Pro 2800 / 3600 Enduro lighting system will improve your view, control and enjoyment of night riding, please remember that cycling at night is an inherently dangerous activity. In addition to using your lighting system properly and riding with extreme caution, NiteRider® urges you to:

- **Never ride alone**
- **Always let someone know where you are going**
- **Wear a helmet and reflective clothing**
- **Carry an auxiliary light and emergency supplies**
- **Make sure the headlamp, mounting bracket and battery are securely fastened**
- **Always disconnect the battery from the headlamp when transporting the light system**

PROTECTING YOUR INVESTMENT

Properly charge your battery to maximize its lifespan (see the "Battery Charging and Care" section for detailed information). The Pro 2800 / 3600 Enduro will perform in wet weather conditions, but submerging it in water will damage the system.

SUPPORT

If you experience difficulties during product installation or operation, NiteRider® provides free telephone support on weekdays from

8:00 am to 4:30 pm (Pacific Time) at 800.466.8366, Ext 4.

You may also e-mail us at support@niterider.com.

WARRANTY

NiteRider® stands behind its products with the following warranties:

- **Lifetime warranty:** Covers any defects in material and workmanship, mechanical components (housings, covers, mounts and fasteners) and LEDs
- **2-year warranty:** Printed circuit boards, switches, and AC adapters
- **1-year Warranty:** Rechargeable battery cells

To obtain warranty service have your original sales receipt.

Contact the NiteRider® Customer Service

Department at 800.466.8366, Ext. 4 to obtain a Return

Merchandise Authorization (RMA) number. The RMA number must be prominently displayed on the outside of your package.

The product must be properly packaged to prevent damage in transit.

For complete warranty information, please visit our website at www.NiteRider.com

NiteRider® Technical Lighting Systems, Inc.
8295 Aero Place, Suite 200
San Diego, CA 92123
www.NiteRider.com



PRO 2800 ENDURO REMOTE
PRO 3600 ENDURO REMOTE
USER GUIDE

USE THE LIGHT THAT PROS USE

NiteRider® provides cyclists the most durable, reliable, and best performing lights in the market. It's not a statement we make lightly, as the backbone of our success has been built on providing lights of exceptional quality to this very demanding market sector. Through 24 years of actively supporting professional riders at 12 and 24 hour endurance events, we have learned what it takes to become the stand alone leader in bike lighting.

PARTS LIST AND IDENTIFICATION

Please verify the contents of your Pro 2800 / 3600 Enduro system:

- A. Pro 2800 / 3600 Enduro Headlamp
- B. Remote Switch
- C. Li-Ion Enduro Battery
- D. Universal Handlebar Mount (UHM)
- E. 36" Extension Cable (Pro 2800 Enduro only)
- F. AC Adapter

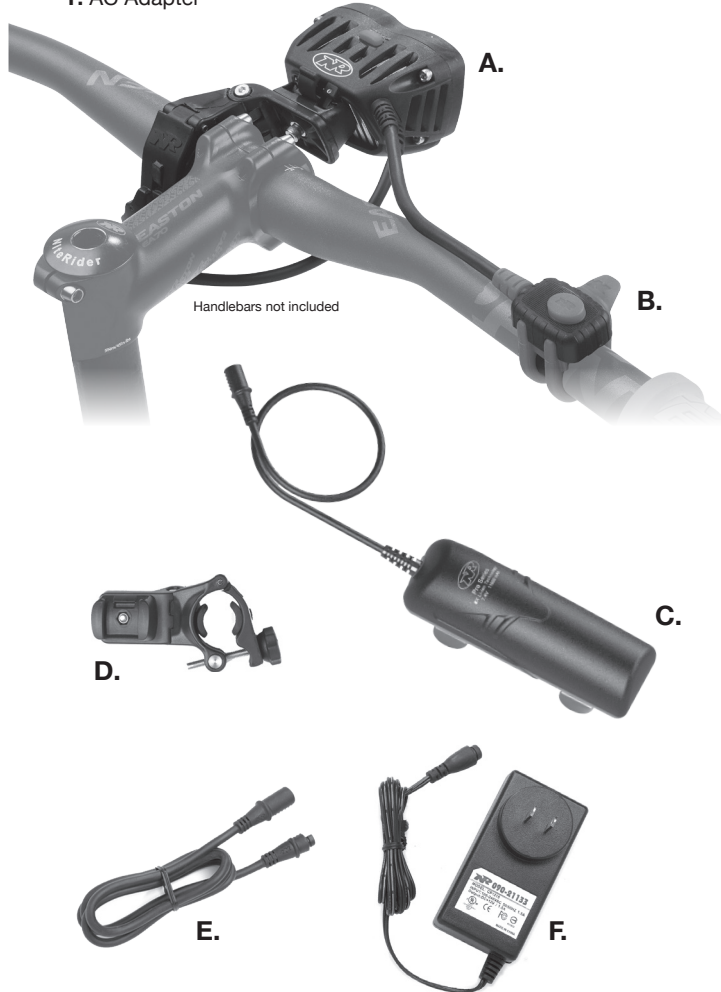

MOUNTING THE HEADLAMP

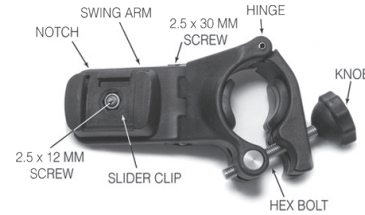

Universal Handlebar Mount

The Universal Handlebar Mount (UHM) is designed to fit on virtually any handlebar (25.4mm - 35mm diameter handlebars with the included extra length screw). Included with the mount is a 2.5 mm Allen wrench for adjusting the mount.

1. Turn the knob counter-clockwise, allowing the hinge to swing open.
2. Place the UHM on the handlebar on the left side of the stem, orienting the rectangular notch in the slider clip to the rear.
3. Swing the hinge down to make contact with the handlebar.
4. Swing the bolt up, seating the knob into its recess.
5. Turn the knob clockwise to tighten and secure the mount to the handlebar.

The UHM can be adjusted to accommodate any handlebar angle. By loosening the 2.5 x 30 mm Allen screw, you can move the swing arm back and forth to straighten the headlamp.

Tighten the 2.5 x 30 mm screw after the adjustment. To pivot the headlamp, loosen the 2.5 x 12 mm screw located under the slider clip and swing arm and rotate the headlamp to the desired position. Make this adjustment before tightening the 2.5 x 30 mm screw.

Inserting the Headlamp into the Handlebar

Insert the headlamp into the handlebar slider clip from the rear moving forward. Gently rocking the lamp as you slide it may help. Do not push the release lever when inserting the headlamp into the slider clip; let the lamp snap into place by itself.

To remove the headlamp, push the release lever forward and slide the lamp backward.

Note: After mounting the headlamp, adjust it so the beam illuminates the road without distracting oncoming riders.

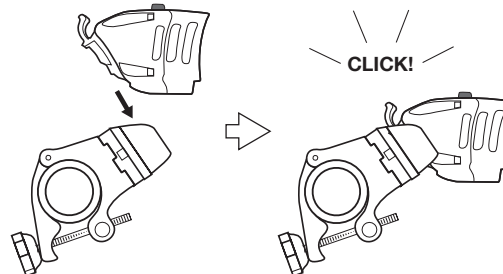

MOUNTING THE BATTERY

Warning: For safety reasons, a cyclist should never be tethered to the bike. When the headlamp is mounted to the handlebar, do not place the battery in a pocket or pack.

Mounting the Battery to the Bike Frame

1. Thread the hook/loop straps through the two slots on the bottom of the battery.
2. Attach the concave surface of the battery to a safe, convenient location on the frame (typically under the top or down tube), placing the hook/loop strap over the tube, but under any shift or brake cables. The cable from the battery should extend toward the stem.
3. Secure the headlamp and battery cable to the frame using the thin hook/loop strapettes. Make sure the cables do not interfere with any moving parts.

OPERATION

1. Connect the headlamp cable to the battery.
2. Press and release the Remote Switch power button to turn the light on. Cycle through the four brightness levels by pressing and releasing the power button.
3. To access the daylight safety flash mode, press and hold the power button until the headlamp starts to flash.
4. With the headlamp in flash mode, press and release the power button to access beacon, SOS or walk modes. From walk mode you can return to normal mode by pressing and releasing the power button.
5. To turn the headlamp off from normal, flash or walk modes, press and hold the power button until the headlamp shuts off.
6. **Always disconnect the battery from the headlamp when transporting the light system. This prevents accidentally turning the headlamp on, which may cause overheating and potential damage from high heat or even a risk of fire**

Fuel Gauge

The 8-step, LED Fuel Gauge is located on top of the headlamp in front of the power button. When all four LED's are lit solid green, the battery is fully charged. As the battery discharges $\frac{1}{8}$ increments of capacity, the LED's from right to left, successively go from solid green to blinking green, to out. With only the final $\frac{1}{8}$ capacity remaining one LED blinks red. At this time, the headlamp should be turned off and the battery recharged.