

EDGESMITH

P E R I M E T E R P E R F E C T I O N

FULL HEIGHT TURNSTILE

INSTALLATION INSTRUCTIONS

Single or Double - DR.TD.6771



GENERAL SAFETY PRECAUTIONS

This installation manual is intended for qualified personnel only. Please read this manual in full before operation.

Installation, electrical connections and adjustments must be performed by qualified personnel, in accordance with best practices and in compliance with applicable regulations. EDGESMITH cannot be held responsible for any damage or injury due to improper use or any use other than the intended usage indicated in this manual.

Before installing the product, make sure it is in perfect condition; if in doubt, do not use the equipment and contact qualified personnel only.

Do not install the product in explosive areas and atmospheres; the presence of inflammable gas or fumes represents a serious safety hazard.

PRODUCT INFORMATION

This full height turnstile is designed for places with stylish high security requirements such as; Building entrance ways, airports, schools, sports facilities, event stadiums etc. It is ideal for installs where high security is a must, it also works as traffic control and people management. The elegant stainless steel finish, precise motor design and management creates a system that is reliable and accurate.

MAIN COMPONENTS

The turnstile consists of 5 main components

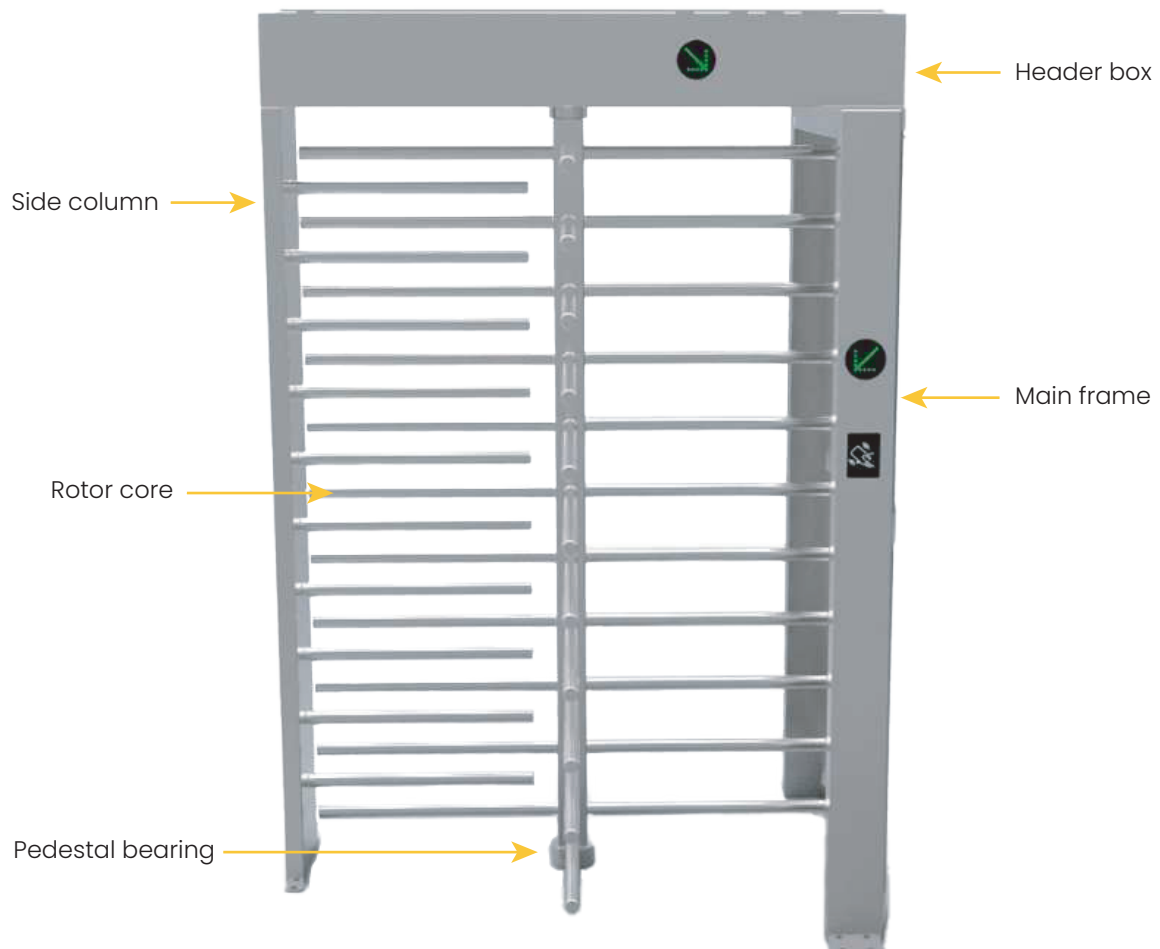

ASSEMBLY INSTRUCTIONS

- Place the main frame in the correct final position. Make sure it is level and square, this is EXTREMELY important as the rotor will not operate if the frame is missaligned.
- Place the side column in position. Ensure it is level and square.
- Lift the header box on top of the main frame and column.
- Once everything is in the correct position bolt down and fasten the main frame, side column and header box.
- Place the pedestal bearing in the centre of the turnstile.
- Lift the rotor core on the pedestal bearing and fix to the header box. Ensure that the rotor shaft is vertically level, if not, adjust and align until the entire turnstile is flat and level.
- Connect the electrical equipment and test the unit.
- Check that the battery back-up is working by turning off the mains.

SINGLE TURNSTILE DIMENSIONS

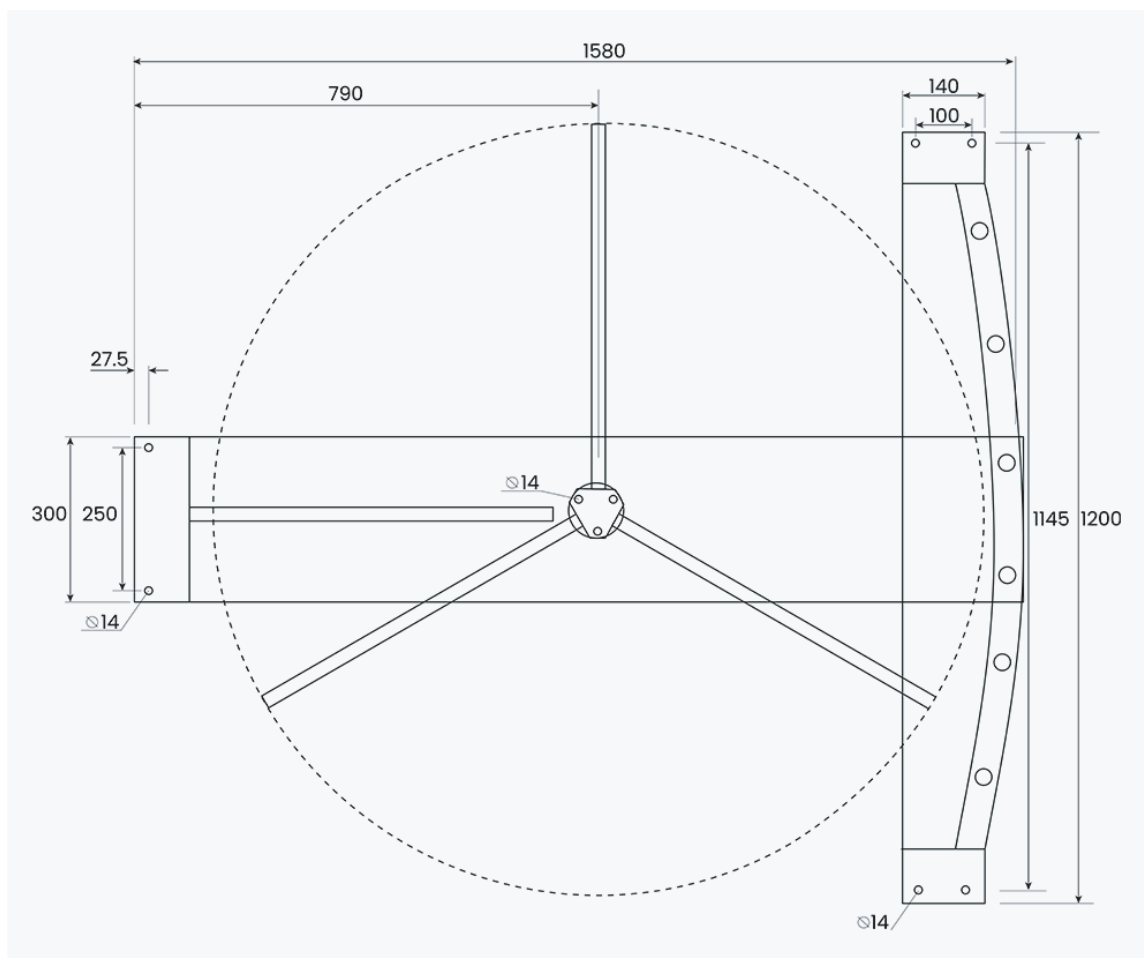

IMPORTANT - foundation for single must be minimum 1400 x 1800, foundation for double must be minimum 1400 x 2600. Foundation must be at least 200mm thick on a suitably compact foundation. Concrete to be a minimum 20mpa, cured for seven days. Hold down anchors to be M12x100mm.

DOULBE TURNSTILE DIMENSIONS

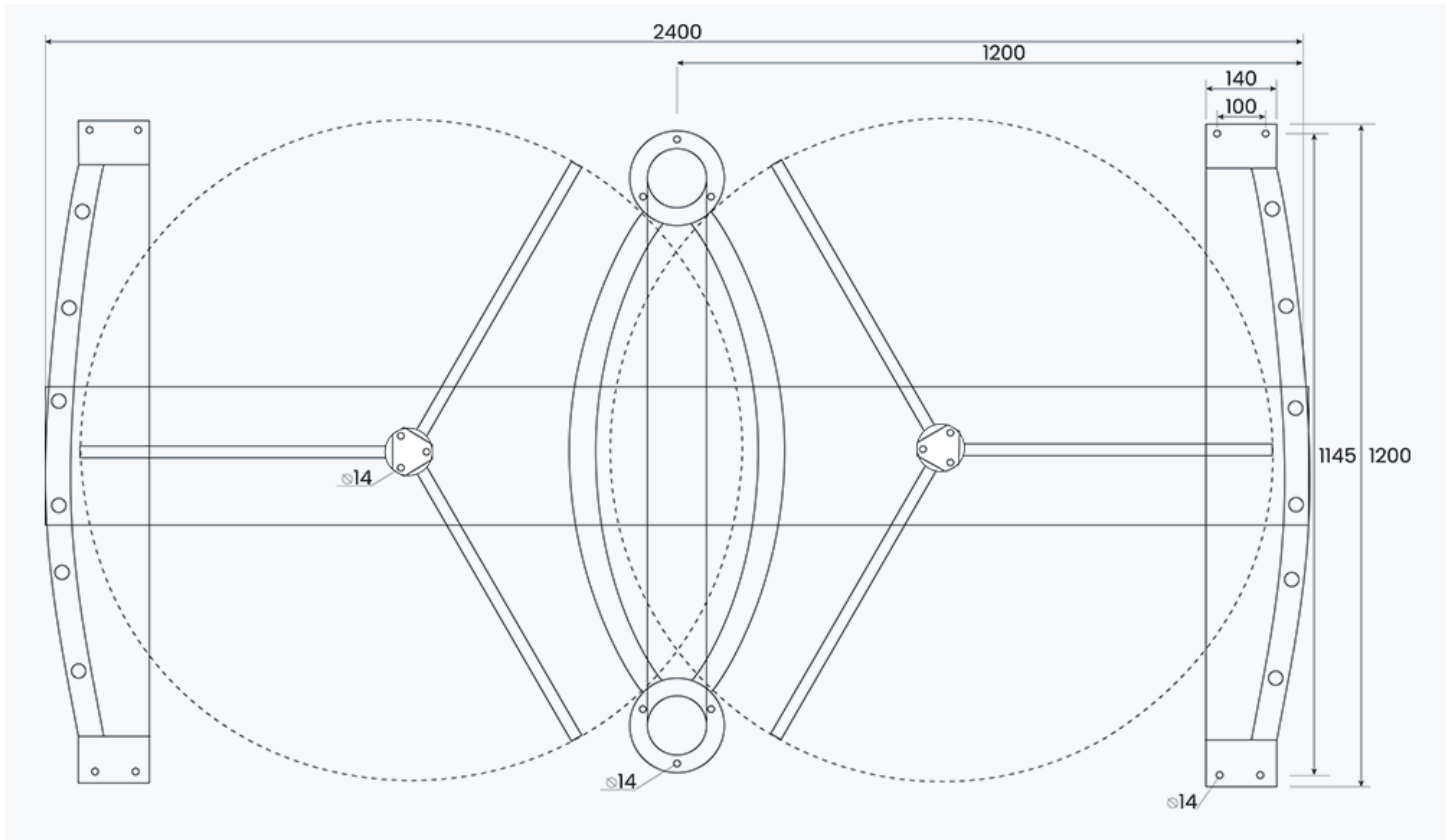

ELECTRICAL CONNECTIONS

Wiring in the indicator light

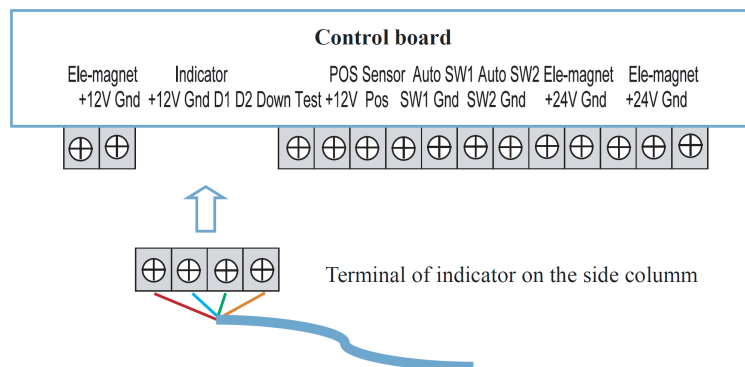

Wiring in the access control

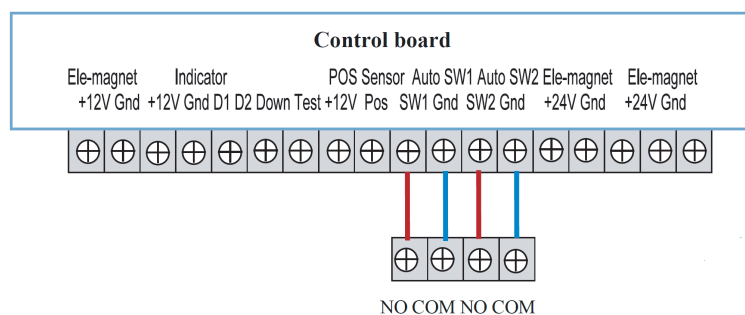

CONTROL OUTPUTS

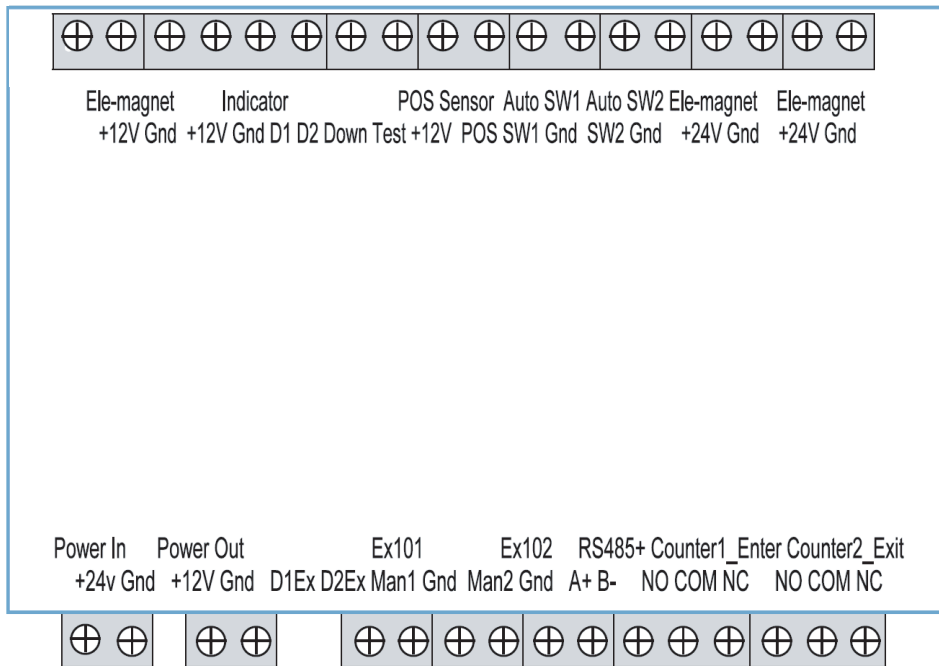

No	Port Sign	Description
1	+24V	24V input power supply
2	GND	
3	+12V	12V power output to indicator
4	GND	
5	D1Ex	NO USE
6	D2Ex	
7	Man1	Entry button for manual opening
8	GND	
9	Man2	Exit button for manual opening
10	GND	
11	A+	485 communication
12	B-	
13	NO	Entry relay interface for entry counter
14	COM	
15	NC	
16	NO	Exit relay interface for exit counter
17	COM	
18	NC	
19	+12V	Power supply for circular solenoid
20	GND	
21	D1	Entry LED indicator signal input
22	D2	Exit LED indicator signal input
23	+12V	+12V power supply for indicator
24	GND	
25	Down	
26	Test	
27	+12V	Position sensor for full close – 120 Degree
28	POS	
29	SW1	Entry opening signal for access control – Dry contact relay
30	GND	
31	SW2	Exit opening signal for access control – Dry contact relay
32	GND	
33	+24V	Output for entry solenoid
34	GND	
35	+24V	Output for exit solenoid
36	GND	

DIP SWITCH INSTRUCTIONS

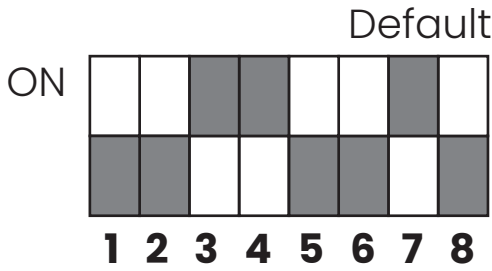

1-6 used for pass time setting

Grey box displays ON, white box displays OFF

7-8 used for function mode setting

DIP 7 - Not used (must be on)
 DIP 8 - Swipe card memory*

*swipe card memory used to allow more than one passage per swipe card. If card is swiped 5 times then 5 people can pass.

Time (s)	DIP Switch					
	1	2	3	4	5	6
2						
3						
4						
5						
6						
7						
8						
9						
10						
11						
12						
13						

SERVICE INSTRUCTIONS

This full height turnstile requires regular maintenance which can only be completed by qualified personnel.

Note: Top lid must be secured at all times and not left open

Keep the turnstile housing and card reader panels clean - wipe down dust and other dirt, use rust inhibitor on stainless steel to maintain its shine.

Fasten and Lubricate the internals - Check the connections of the various moving parts, fasten screws that may have come loose

Clean the control board - Cut off the power and wipe dust off the board using a clean brush.

Check the wiring connections to make sure none have come loose

Check the pedestal bearing and apply grease as needed

The Battery is rated to last 5 years but we suggested to replace the batteries every 2 years.



PERIMETER PERFECTION

North Auckland Branch

20 Anvil Road, Silverdale
Auckland 0932

Monday - Friday

8:00am - 4:30pm

T: 09 427 4980

E: crew@edgesmith.co.nz

South Auckland Branch

20 Kerwyn Avenue, East Tamaki
Auckland 2013