

**tommee
tippee**

quickchop™

baby food blender

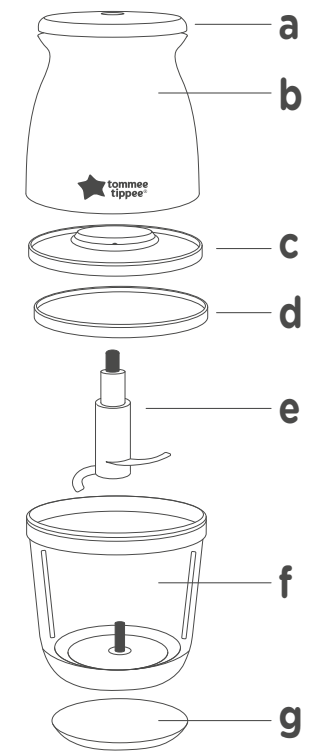

BABY FOOD BLENDER

- a. Top Push Button
- b. Motor unit
- c. Bowl lid
- d. Silicone sealing ring
- e. Blender blade
- f. Glass Bowl
- g. Non-slip silicone base

HOW TO ASSEMBLE

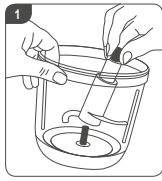

1. Slide the knife blade down over the shaft. **WARNING!** Handle the knife blade carefully as it is extremely sharp.

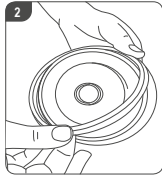

2. Stretch and attach the silicone sealing ring around the outside of the bowl lid. Make sure the flat side sits against the lid.

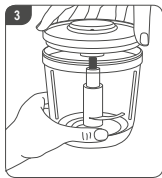

3. Insert the lid with the sealing ring into the bowl. Make sure to press firmly to make sure the lid is sealed correctly.



4. Lift the motor unit and place on top of the bowl with the lid. Turn until it drops into place.



WARNING! The motor unit does not attach to the glass bowl, please ensure you hold and lift the blender with both hands when handling or moving the blender.

WARNING! After operating 4 cycles, let it cool down to room temperature before operating it again. Keep hands and utensils away from the cutting blade while chopping food.

HOW TO USE

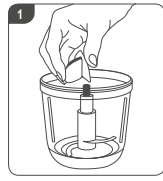

1. Remove the lid and place the food in the bowl. Do not fill the unit past the '500 ml'. This appliance is intended for processing small quantities of food.

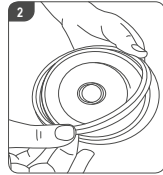

2. Insert the lid with the sealing ring into the bowl. Make sure to press firmly to make sure the lid is sealed correctly.



3. Lift the motor unit and place on top of the bowl with the lid. Turn until it drops into place.

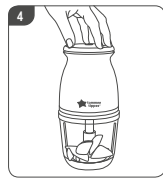

4. Simply push the top button to activate the blades. Keep it pressed to blend the food. **Do not keep the top button pressed for more than 30 seconds. If it is operated for more than 30 seconds let the unit cool down for at least 2 minutes before operating it again.**

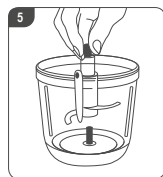

5. Make sure that the blade has stopped turning completely before removing the lid. Unplug the unit, remove the lid and remove the blender blade. Carefully pull the knife blade straight up. Empty the food from the bowl. Do not use the food blender bowl for storing food.

EN | IMPORTANT WARNINGS!

These instructions can also be found at www.tommeetippee.com

Keep this instruction sheet for future reference as it includes important information. This appliance is intended for household use only. Do not use outdoors. Before plugging in the blender for the first time ensure that the voltage is compatible with your electricity supply by checking the label on the base of the unit. Do not immerse in water. To protect against fire, electric shock and injury to persons do not immerse cord, plugs or other parts of the unit in water or other liquid. Misuse of the product may result in the risk of fire, electric shock, and/or personal injury. Cleaning and user maintenance shall not be made by children. Keep the appliance and its cord out of reach of children. Do not let the cord hang over edge of the kitchen work surface or touch hot surfaces. This appliance is not intended for use by persons (including children) with reduced physical, sensory or mental capabilities, or lack of experience and knowledge, unless they have been given supervision or instruction concerning the use of the appliance by a person responsible for their safety. Children do not understand the dangers associated with operating electrical appliances. Never allow children to use this appliance. User maintenance other than cleaning is not required for this product. Do not operate any appliance with a damaged cord or plug or after the appliance malfunctions or has been damaged in any manner. If the supply cord is damaged it must be changed by a qualified person in order to avoid hazard. If within a retail warranty period this product should be exchanged at place of purchase, the manufacturer will then be made aware. For questions or support visit our website www.tommeetippee.com. Always use on a flat heat resistant kitchen surface. Do not move appliance when in use. Do not use any accessories other than those supplied with this appliance. Always disconnect the appliance from the supply if it is left unattended and before assembling, disassembling or cleaning. Switch off the appliance and disconnect from supply before changing accessories or approaching parts that move in use. Allow to cool before putting on or taking off parts and use and after every use wash the bowl, silicone seal and bowl lid in warm soapy water or use a dishwasher (top shelf only) and dry thoroughly. Wash the knife blade in warm soapy water and dry thoroughly. **The knife blade is not dishwasher safe.** Handle the knife blade carefully as it is extremely sharp. Care shall be taken when handling the sharp knife blades, emptying the bowl and during cleaning. Never leave the appliance running whilst empty. Do not attempt to repair the appliance yourself. Do not put any utensils into the blender when the blender is turned on. Make sure that the blade has stopped turning completely before removing the bowl lid. Do not fill the unit past the MAX line. Do not put in the microwave. Do not sterilise. Be careful if hot liquid is poured into the blender as it can be ejected out of the appliance due to sudden steaming. Regularly check the cord and plug for signs of damage, if visible remove from use immediately.

Before first use and after every use, wash the bowl, lid and knife blade in warm soapy water and dry thoroughly.

WARNING! BE CAREFUL NOT TO TOUCH THE BLADE AS IT IS EXTREMELY SHARP.

The bowl and lid are dishwasher safe (top shelf only). **The knife blade is not dishwasher safe.**

Wipe the motor unit with a damp cloth but **DO NOT IMMERSE IN WATER**. The department of health recommends that solid food should not be introduced before 6 months. Although you can start earlier (but not before 4 months) if advised by your health visitor or GP.

Information on the disposal for Waste Electrical & Electronic Equipment (WEEE)

This symbol on the products and accompanying documents means that used electrical and electronic products should not be mixed with general household waste. For proper disposal for treatment, recovery and recycling, please take these products to designated collection points where they will be accepted on a free of charge basis. In some countries you may be able to return your products to your local retailer upon the purchase of a new product. Disposing of this product correctly will help you save valuable resources and prevent any possible effects on human health and the environment, which could otherwise arise from inappropriate waste handling. Please contact your local authority for further details of your nearest collection point for WEEE. Penalties may be applicable for the incorrect disposal of this product in accordance with national legislation. If the supply cord is damaged, it must be replaced by the manufacturer, its service agent or similarly qualified persons in order to avoid a hazard. The product is fitted with a BS 1363 mains plug containing a 3A fuse. If it ever becomes necessary to replace the fuse, only use fuses that are marked BS 1362, and rated at 3A. In the unlikely event that this plug is not suitable for the sockets in your home, it should be removed and a suitable plug fitted as follows: The wires of the mains lead are coloured in accordance with the following code: GREEN & YELLOW - EARTH, BLUE - NEUTRAL, BROWN - LIVE As these colours may not correspond with the coloured markings sometimes used to identify the terminals in the plug, connect as follows. The wire coloured GREEN AND YELLOW must be connected to the terminal marked E or by the earth symbol or coloured GREEN or GREEN AND YELLOW. The wire coloured BLUE must be connected to the terminal marked N or coloured BLACK. The wire coloured BROWN must be connected to the terminal marked L or coloured RED. If you are in any doubt about how to wire a plug or replace a fuse safely, consult a qualified electrician.



Mayborn (UK) Limited Balliol Business Park, Newcastle upon Tyne, NE12 8EW, UK
 EU Representative: Mayborn France Sarl, 56 Rue de Paris, Boulogne Billancourt, 92150, France.
 All IP rights held by Mayborn (UK) Limited and/or its affiliates.
 TOMMEE TIPPEE™, QUICKCHOP™. Copyright © 2022. Made in China.
 0447851 15060922_2

Any questions?
 Visit our website: tommeetippee.com

**tommee
tippee**

quickchop™

幼兒食物攪拌機

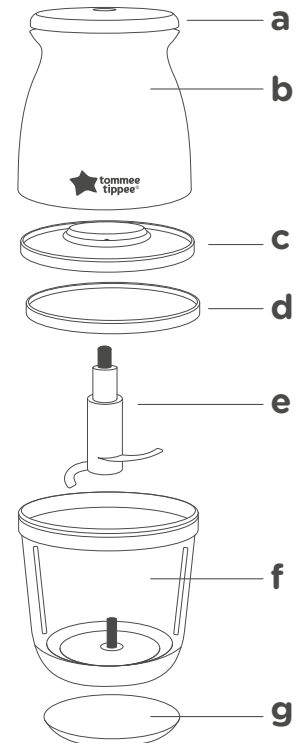
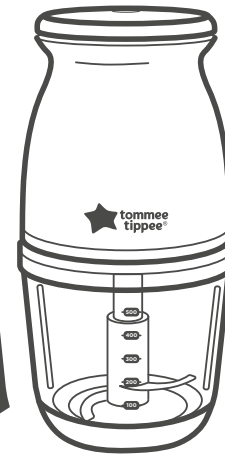

幼兒食物攪拌機

- a. 頂部按鈕
- b. 主機
- c. 碗蓋
- d. 矽膠密封圈
- e. 攪拌機刀片
- f. 玻璃碗
- g. 防滑矽膠底座



Mayborn (UK) Limited Balliol Business Park, Newcastle upon Tyne, NE12 8EW, UK
 EU Representative Mayborn France Sarl, 56 Rue de Paris, Boulogne Billancourt, 92100, France.
 All IP rights held by Mayborn (UK) Limited and/or its affiliates.
 TOMMEE TIPPEE®, QUICKCHOP™. Copyright© 2022. Made in China.
 0447851 15060922_2

Any questions?
 Visit our website: tommeetippee.com

安裝說明



將滑動刀片放置在玻璃碗底部軸承上。

警告！

刀片非常鋒利，請小心處理！

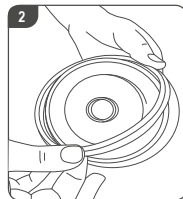

將矽膠密封圈套在碗蓋邊緣，確保平坦的一面靠在碗蓋上。

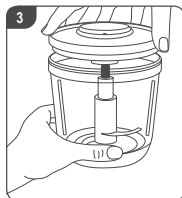

將帶密封圈的蓋子蓋在碗上。壓緊確保蓋子完全密封。



提起主機並將其放在碗蓋的上方。輕微轉動直到它落入卡位。



警告！

主體電機裝置并非固定在玻璃碗上，當提取或移動攪拌機時，請確保您雙手握住並提起。

使用說明

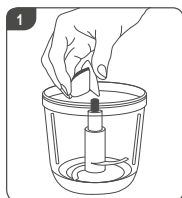

取下蓋子將食物放置在碗裡。不可以滿載超過“500毫升”食物。本設備只適用於加工少量食物。

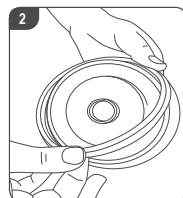

將帶有密封圈的碗蓋放入碗中。用力按壓以確保蓋子正確密封。



提起主機並將其放在碗蓋的上方。輕微轉動直到它落入卡位。



只需按下頂部按鈕即可啓動。請勿按住頂部按鈕超過 30 秒。如果操作超過 30 秒，請讓設備冷卻至少 2 分鐘，然後再操作。

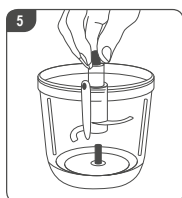

在打開碗蓋前，請確保刀片已完全停止轉動。拔下電源插頭，打開蓋子並取下攪拌機刀片。小心地將刀片筆直向上拉。倒空碗裡的食物。請勿使用攪拌碗儲存食物。

警告！ 在使用 4 次後，讓其冷卻至室溫，然後再運行。切碎食物時，請讓手和器具遠離刀片。

重要警告！

這些說明也可以在 www.tommeetippee.com 找到。

保留此說明書以備將來參考，因為它包括重要信息。該攪拌機僅供家庭使用。請勿在戶外使用。

首次插入攪拌機之前請確保電壓與您的電力系統兼容，可檢查設備底部的電壓標籤。不要浸入水中。請勿將電源線、插頭、或其他部件浸入水或其他液體中，以防止漏電或火災造成人身傷害。濫用該產品可能會導致火災、電衝擊和/或人身傷害。清潔和產品維護不得由兒童進行。請將該電器及其電源線放在兒童接觸不到的地方。不要讓電線懸在廚房工作檯面的邊緣或觸摸灼熱的表面。本設備不適合由身體、感官或心理能力減低，和缺乏經驗的人（包括兒童）使用，除非他們是在監督或指導下使用。兒童不了解相關的危險操作。絕不允許孩子使用本電器。除清潔外本產品不可以私自維修。如電源線或插頭損壞，請勿操作該設備。如果電源線損壞，則必須由合格人員更換，以避免危險。如果在零售保修期內，請聯絡生產商維修。如有疑問，請訪問我們的網站 www.tommeetippee.com。確保在平整和耐熱廚房表面使用。操作中不要移動設備。請勿使用除非本設備隨附的配件。在無人看管下，或在組裝、拆卸或清潔前取出設備，並斷開連接電源。更換配件或移動部件前，關掉設備和斷開電源。裝上或取下零件前，先讓其冷卻，及使用後清洗玻璃碗，矽膠密封圈和碗蓋在溫肥皂水中或使用洗碗機（僅限頂架）並徹底乾燥。刀片可以在溫肥皂水中清洗並徹底乾燥。刀片不適合在洗碗機內清洗。處理刀片時請小心它非常鋒利。清潔時必須將刀片從玻璃碗中取出。切勿讓攪拌機空轉。不要試圖自行維修。當攪拌機開機時，請勿將任何餐具放入攪拌機。取下碗蓋時，確保刀片已經完全停止轉動。不要承載食物超過 MAX 提示線。請勿放入微波爐。不可消毒。如果將熱液體倒入攪拌機，請小心突然冒出的蒸汽而從設備中彈出。定期檢查電源線和插頭是否有損壞跡象，如果有損壞，請立即停止使用。首次使用前和每次使用後，請使用溫肥皂水中清洗玻璃碗、蓋和刀片再擦乾徹底。

警告！小心不要碰到刀片因為它非常鋒利。

碗和蓋子可用洗碗機清洗（僅限頂層架子）。

刀片不可以用於洗碗機。

用濕布擦拭主機裝置，但不要浸於水中。在幼兒六個月前不建議引入固體食物。請參考兒科醫生建議。

電子電氣設備(WEEE)廢棄處置信息

此符號表示您應根據當地法律法規處理本產品，請與生活垃圾分開處理。當處置該產品時，請將這些產品帶到指定的收集點。正確處置本產品將有助可以節省寶貴的資源並防止任何可能的

對人類健康和環境的影響。請聯繫您當地的部門了解您的更多 WEEE 收集點信息。不正確處置本產品可能根據國家立法遭至處罰。