

# CABINETS

How to store everything from soup to nuts (and then some).



**A KITCHEN IS UNQUESTIONABLY** the biggest storage area in the house. And what's on the outside of the cabinets is as important as what goes inside.

## Colors That Will Never Look Dated

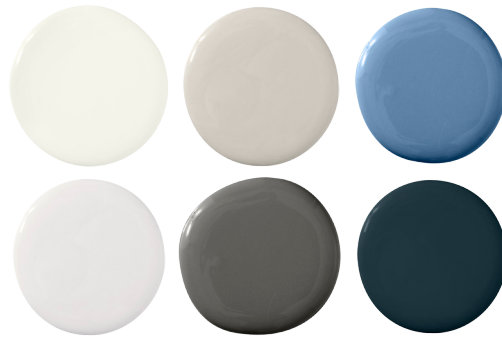

### White

Bobby Berk and Courtney McLeod swear by Benjamin Moore's Simply White. "It's fresh, clean, and bright," McLeod says. Nicole Fuller loves Farrow & Ball's Wevet.

### Neutral

Benjamin Moore's London Fog (a Robin Baron fave) and Kendall Charcoal (Kendall Wilkinson's go-to) are warm neutrals.

### Blue

Nicole Fuller recommends Farrow & Ball's Cook's Blue. For a tint that "makes the kitchen cozier," Sean Leffers prefers Sherwin-Williams's Dark Night.

## In Defense of...

Three designers fight for their favorite kind of kitchen storage.



### PULL-OUT SHELVES

"Pull-out shelves with a low lip maximize closed storage," Caroline Rafferty explains. "You can really use the full depth of the cabinet."



### DEEP DRAWERS

"We are putting more items below the counter, including glasses and dishes," says Jean Stoffer. "It's great for aging in place, too."



### OPEN SHELVES

"Use different glass textures in open cabinets, or metal mesh fronts with glass, for a distinctive look in your upper cabinets," says Robin Baron.

## A Design Decision That Really Matters

It's not only the style of your cabinet doors that determines how they'll look. **It's also how they sit on the frame.** Designer Jean Stoffer breaks down the pros and cons of each.

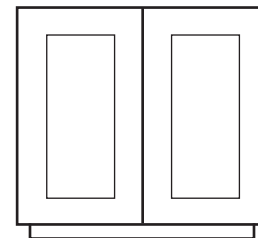

**FULL OVERLAY** "When doors and drawers completely cover the cabinetry face, it offers a streamlined aesthetic," Stoffer says. Plus, you'll gain an inch of space inside.

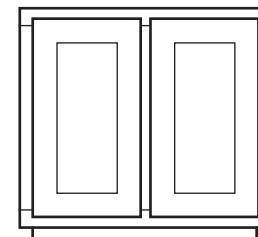

**PARTIAL OVERLAY** The doors sit on top of the frame, revealing a gap. They're the only kind you can open without hardware, and often the least-expensive option.

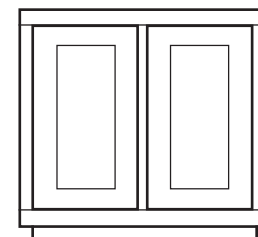

**INSET** With a frame construction—as opposed to frameless, which is more typical of European models—cabinet doors can be inset so they're flush with the frame.

PHOTOGRAPHERS: THIS PAGE: HEIDI'S BRIDGE; COURTESY OF JERSEY ICE CREAM CO.; TREVOR DIXON (HARDWARE); PHOTOGRAPHERS: OPPOSITE PAGE, COUNTERCLOCKWISE FROM TOP: BRITTANY AMBRIDGE; COURTESY OF HEATHER BULLARD; WESTENDS; THE CONTENTED NEST/GAP INTERIORS; HARDWARE PRODUCER: EMMA BAZILIAN; SCHAUB PULL; COURTESY OF DELAWARE VALLEY PLUMBING SUPPLY



Beaded? Beveled? Reeded? There are myriad cabinet options, but the most popular is **Shaker**: Its minimal design means it works with virtually every style.



## Pick the Perfect Hardware

Eddie Ross shares five winning knob-and-pull combos.

- 1. Sleek Neutral** "The leather detail makes it special." Pull, Atlas Home-ware. Knob, Target.
- 2. Barely There** "I love how the acrylic handle disappears into the black cabinet." Pull, Schaub. Knob, Anthropologie.
- 3. Furniture-Inspired** "The bamboo design adds whimsy to a traditional combo." Pull and knob, Addison Weeks.
- 4. Modern Farmhouse** "With elegant fronts, a classic cup pull is more chic than country." Cup pull, Liberty. Bar pull, Ballard Designs.
- 5. Midcentury Minimal:** "Mix scale! Try an extra-long pull with a petite knob." Pull and knob, J.Thom Design. *All cabinet fronts, J.Thom Design.*

