

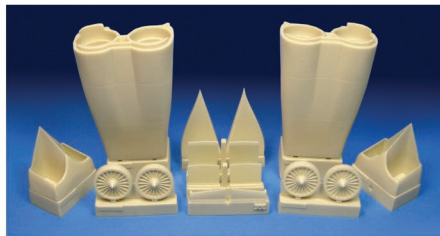

BR72300

## B-1B Lancer Engine Intake Upgrade Set

For the 1/72 scale Monogram B-1B kit. May be adapted with some work to the Airfix kit.



Please review your set with the images below to make sure you have all the parts needed. Check out the other 1/72 B-1B resin sets we produce for this kit. Enjoy!

*Roy*

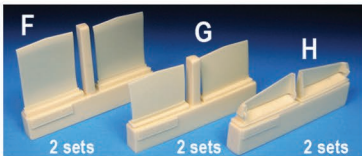
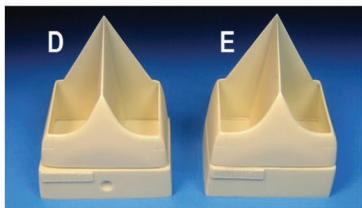
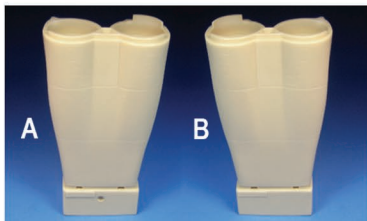

Please use sprue letters for customer service issues.

[www.barracudacals.com](http://www.barracudacals.com)



BR72300

## B-1B Lancer Engine Intake Upgrade Set

For the 1/72 scale Monogram B-1B kit. May be adapted with some work to the Airfix kit.

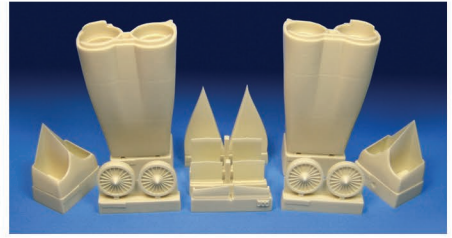

This set was designed specifically for the 1/72nd Monogram B-1B kit. It consists of new resin parts to replace the entire forward section of the engine nacelles. Resin nacelles incorporate complete seamless intake trunking with separate compressor faces and intake baffles. This set corrects the poorly shaped and undetailed nacelles. This is a huge upgrade to the kit parts. It will require some cutting and fitting, and the nacelles need to be blended into the kit nacelle assemblies. These instructions will walk you through the process. Relax! It will be fun & rewarding.

1. To install the intakes, tape together the kit nacelles, and make a vertical cut 2 mms (.080" or 5/64") behind the panel line as shown in Fig 1 and Fig 2. Block sand the kit nacelle to square up the cut line.
2. Using a deep bladed hobby saw, saw the mold block from the main nacelle casting, working carefully in from all four sides. Take care to keep the cuts even and straight. The center divider between the two intake trunks is thick here, so be patient. Once free, block sand the cut face to flatten it out. Repeat this process for the other nacelle body and the two intake fronts (they are marked L and R, but in reality they are identical).
3. Remove resin splitter plates and cleanup. Tape the intake front to the nacelle body (do not glue until step 6) and test fit the splitter plate. The slot on the top of the nacelle may be a little gunked up with resin, as these are very high stress features of the molds and they quickly get damaged. Use a motor tool to open back up the slot if necessary. It may be necessary to shorten the locating tab on the splitter plate by trimming a little off the rear end. See Fig 12. Test fit to the slot and adjust. Note that we have accidentally reversed the L & R designation on the nacelle bodies, so please ignore. Its easy to tell once you fit the splitter plates. One way looks natural. See Fig 12.
4. The normal configuration for an aircraft on the ground is to have the vertical lips hinged in the "open" position. If you wish to model your B-1B with the auxiliary inlet doors open, we have provided them as separate parts. Begin by cutting out the molded closed doors as shown. Remove and cleanup the open doors. Test fit to the intake front castings. When satisfied, set aside until the very final assembly of the completed model to keep from breaking them off a hundred times while working on the model!
5. Note the placement of the baffle plates before removing them from the mold block as they are all different. You may want to write the number on tape and stick it to each one. Remove plates and cleanup. Test fit into slots in intake throats as shown. Adjust fit and set baffles aside. This is a good point at which to paint the intake throats. Paint only from the rear of the rear intake baffle slots back to the engine faces. You can get much better access to deep inside the intakes for painting before baffles are installed. The intakes in service were a dirty or off white. Once painted and given time to dry, carefully coax the rear baffles into position. Attach with thinned white glue or thin CA.
6. Test fit the intake fronts to the resin nacelles. Take your time lining them up. Align the top surfaces of the nacelle and intake parts against a flat surface. When satisfied, join parts with CA. Set aside to dry. Fill and sand the join line to blend the parts together. Fit the pre-painted forward intake baffles at this point. They should snap into the molded in recesses inside the intakes. Secure them with CA or thinned white glue. When finished, spray paint the intake area from the rear baffle forward to the intake fronts the same color as above. The intakes fronts are split at the colour separation line, so mask using that line and paint the intake insides from the parting line forward with the exterior color.
7. Remove the compressor faces and cleanup. paint according to reference photos. Blades are a dull metallic dark grey and the central cone is dull aluminum. Attach the compressor faces with Cyanoacrylate (CA) glue.
8. Carefully test fit the forward nacelle casting to the kit rear nacelle part. The upper kit nacelles have a bulge that is exaggerated and needs to be sanded down after first backfilling the area with CA or epoxy putty. See figure 5. Take great care to insure alignment is correct. You can align the two parts by holding the upper surfaces of the intake and nacelle against a flat surface. To ensure the intake parts are lined up, use the vertical splitter plates as visual guides. Once you are satisfied, attach with CA glue or 5 minute epoxy. Fill and sand out the seam, and you will be pretty much done with this part of the build!

Note: You might want to paint the intakes with Stynylres white primer. It can be sprayed deep inside the intakes without the roughness, caused by vortexs inside the intake, common with solvent paints. You can shoot it quite heavily and it will dry down to a very thin and tight layer.



BR72300

## B-1B Lancer Engine Intake Upgrade Set

For the 1/72 scale Monogram B-1B kit. May be adapted with some work to the Airfix kit.

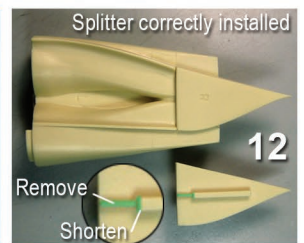
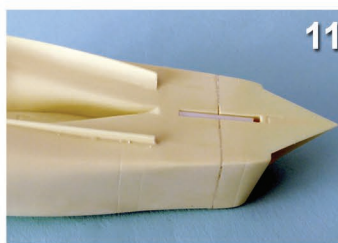
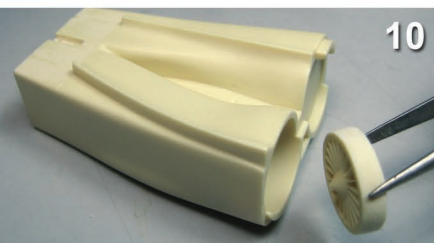
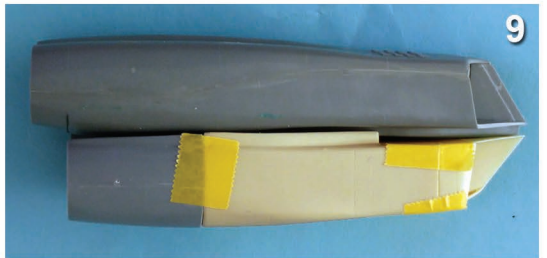
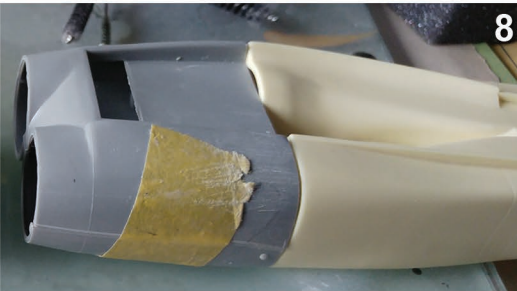
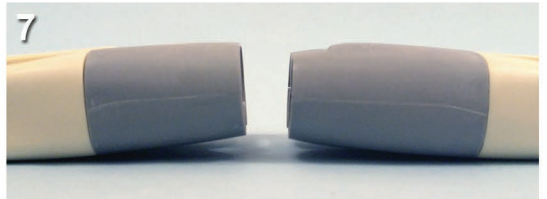
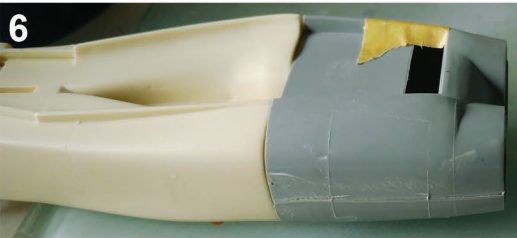
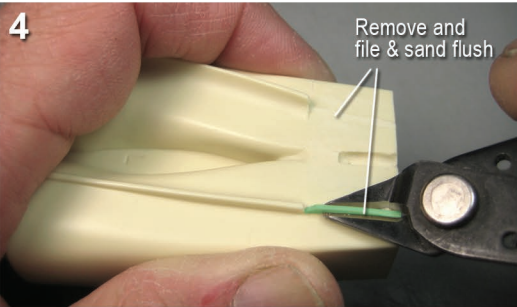
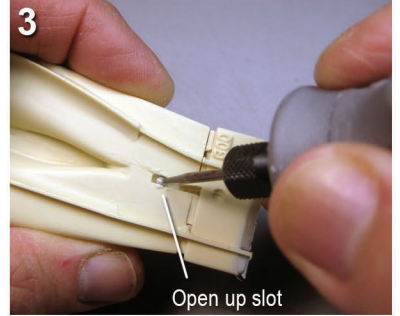
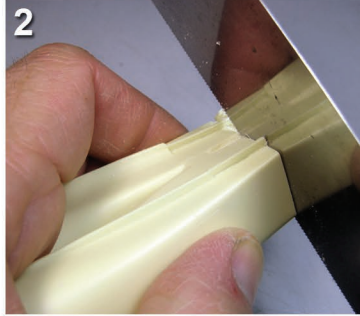
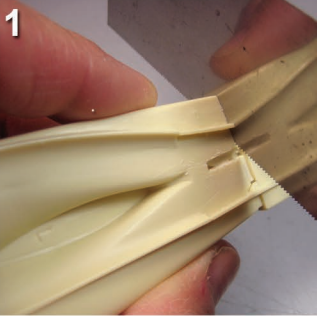
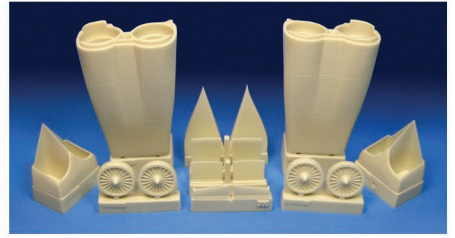

**VERY IMPORTANT!** Do not assemble nacelles yet if you will be also installing our exhaust upgrade set, as the kit nacelle parts (in gray) need further modification to properly install the exhaust sets. Read both sets of instructions before proceeding.



BR72300

## B-1B Lancer Engine Intake Upgrade Set

For the 1/72 scale Monogram B-1B kit. May be adapted with some work to the Airfix kit.

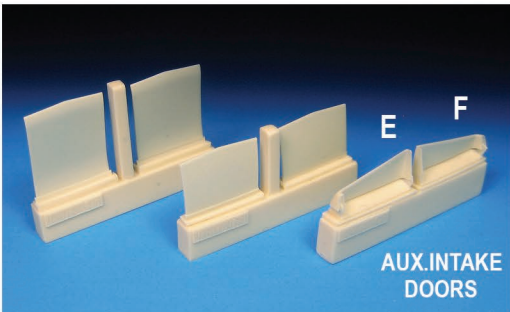
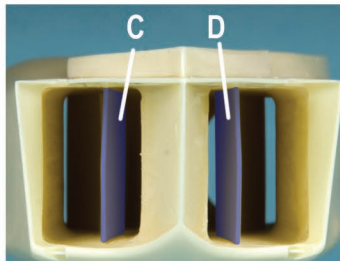
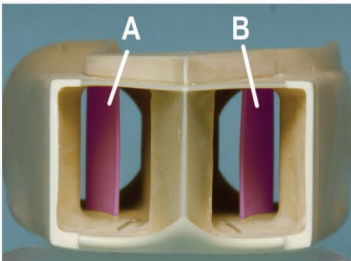
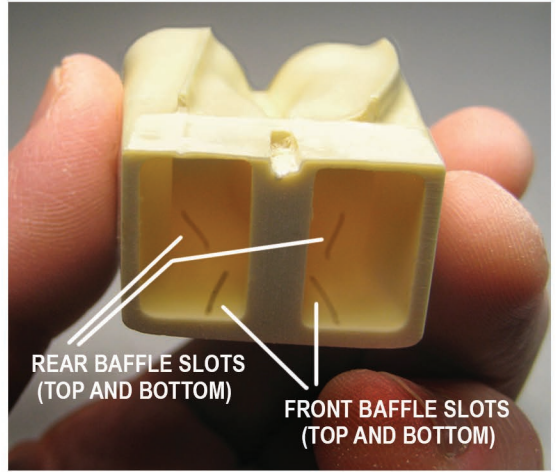
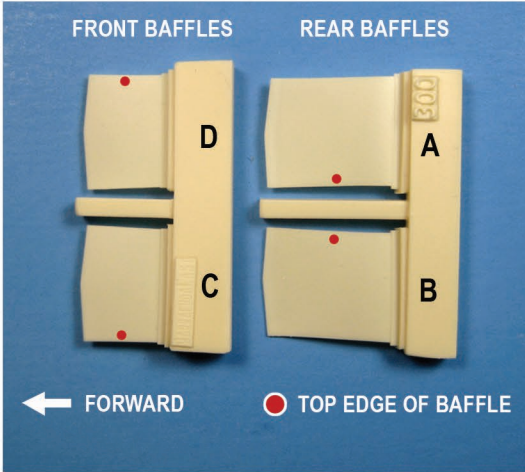
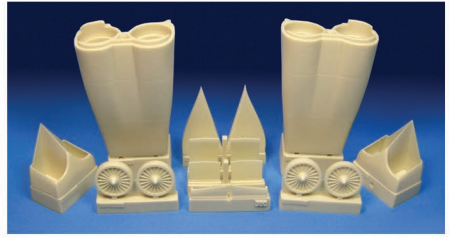

Check out these other great detail and upgrade sets for the B-1B in 1/72nd scale from BarracudaCast.

- BR72296 B-1B Nose & Tail Correction Set - Early
- BR72296 B-1B Nose & Tail Correction Set - Late
- BR72298 B-1B Early Exhaust Upgrade Set
- BR72298 B-1B Late Exhaust Upgrade Set
- BR72299 B-1B Lancer Main and Nosewheel Set
- BR72301 B-1B Lancer Wing Glove Set

See our website for more information!

