



BR32334

Hawker Tempest Mk V Nose Correction Set

For the 1/32 scale Special Hobby Tempest Mk. V kit. May be adapted with some work to fit the Pacific Coast Hobbies kit.



Designed by Anthony Galbraith, Kerry Carlyle and Roy Sutherland

This set was designed specifically for all Special Hobby 1/32nd scale Tempest Mk V kits. It may also be possible to adapt it to fit the older Pacific Coast Models kit, although we have not tried it, and can make no guarantees!

The SH kit is generally excellent, but they somehow managed to make the spinner too large in diameter and the wrong shape. This throws out the taper of the forward nose down to the spinner. The opening for the chin intake is also oversized. We have corrected that, and also improved the general shape of the chin intake fairing. Finally, the kit blades are not quite right, so we have supplied you with accurate new ones in resin. This set will make a real improvement in the overall accuracy of an otherwise fine kit.

- 1) Begin by sawing vertically from the bottom of the casting plug. Be very careful when breaking through to not cut into the nose. Carefully saw as shown in figure 1 to separate the casting web from the Intake lip. Masking off the intake with tape will prevent any slips marring the surface detail. Remove the casting web and plug. Saw off casting block from nose casting. Mask with tape and saw in from multiple directions a little bit at a time. See figure 3. This will prevent the blade from wandering. When finished, block sand to flatten it out. See figure 4. Sand and cleanup intake opening. The hard part is now over!
- 2) Saw the spinner backplate from the mounting block. Remove the raised rib on the back of the casting with nippers. Trim excess web from backplate, leaving a small surround. Block sand the rear of the casting, checking often to make sure you are getting a flat, even cut. When finished, there will be a thin arc of flash that can be pulled off. See figure 7.
- 3) Saw the spinner cap from the molding block. Remove the 3 raised ribs with nippers as shown in figure 9. Trim excess web from baseplate leaving a small surround. Repeat block sanding procedure. Note small circular depressions on the edge of the casting web. These are depth gauges. Figure 8. Sand till the surrounding web is flush with these. Break off any flash and cleanup. Trim off pour channel from inside spinner. Grind flush with a round burr in a motor tool. Test fit to baseplate. Adjust fit with motor tool.
- 4) Note fine scribe lines in backplate. See figure 14. These will determine proper position of spinner cap. Paint inside of spinner's blade openings and baseplate (not blade mounting areas) black. Assemble the spinner with Cyanoacrylate glue. Remove the 4 prop blades by sawing carefully at the scribe line. Carefully block sand cut line. The blades have a shallow dimple at the root. This denotes the forward side of the blade. Take care during assembly to ensure the blades are not installed backwards! This is a good point at which to paint the spinner and blades. Note that British blades have a 4" yellow tip. That's 1/8" or just over 3mm.
- 5) Remove and cleanup the 2 prop alignment jig parts. Attach them to the paper template as shown. You can use CA glue. Fit the assembled spinner into jig and rotate til the tab aligns with the edges of the spinner opening. See figure 15. Place the blade into jig to make sure it fits. See figure 16. When satisfied, attach with 5 minute epoxy or CA. When set, repeat with other 3 blades.
- 6) Due to the flexible nature of rubber molds and variable shrinkage rates, its not always possible to insure perfect match of the spinner backplate and the front of the nose. You may have to do some sanding to match to contours exactly. Its just the nature of resin casting large parts. Test fit spinner and adjust if needed.
- 7) Build the rest of the model per the kit instructions. Test fit kit intake parts and adjust as needed. They should fit with very little extra work. We recommend test fitting the nose before assembling the fuselage halves. Test fitting and adjusting at this point will save a lot of filling and sanding later. The key is to make sure the widths are the same before installing the new nose. Attach with CA. You may wish to add some internal ribs to strengthen the joint.

Happy modelling!



BR32334

Hawker Tempest Mk V Nose Correction Set

For the 1/32 scale Special Hobby Tempest Mk. V kit. May be adapted with some work to fit the Pacific Coast Hobbies kit.



Designed by Anthony Galbraith, Kerry Carlyle and Roy Sutherland

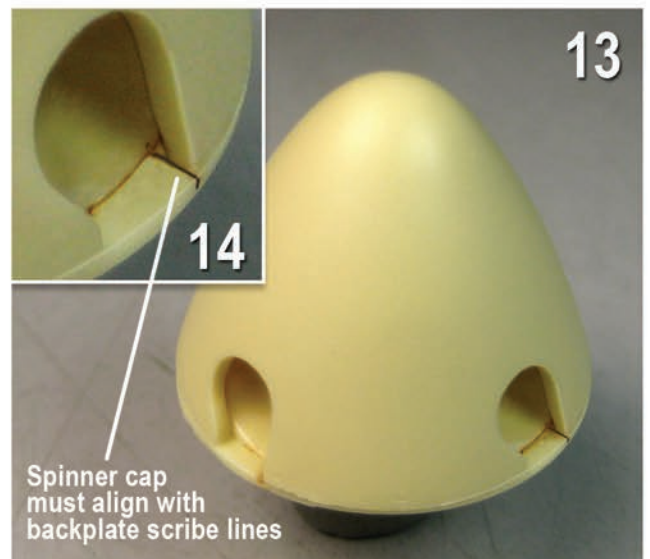
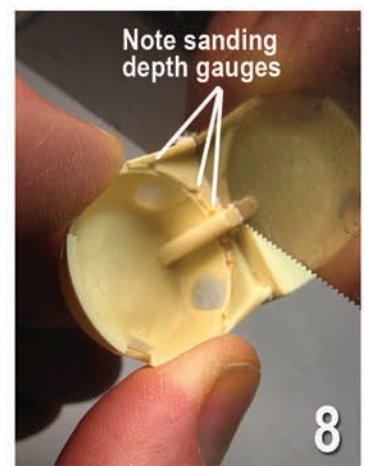
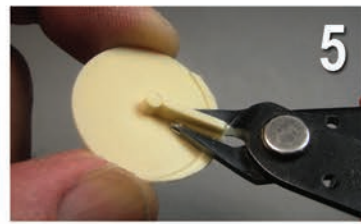
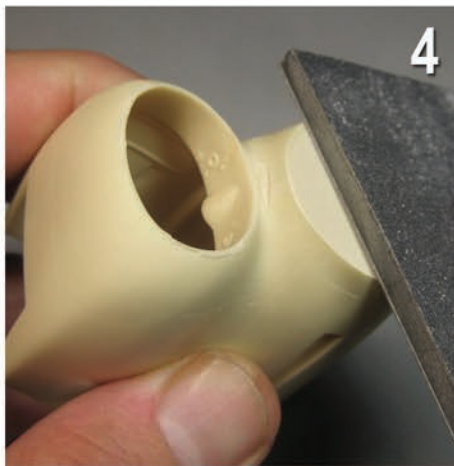
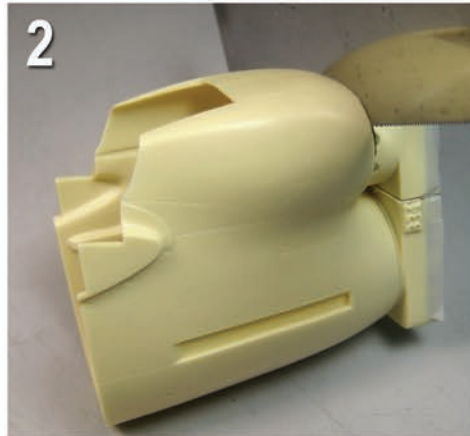
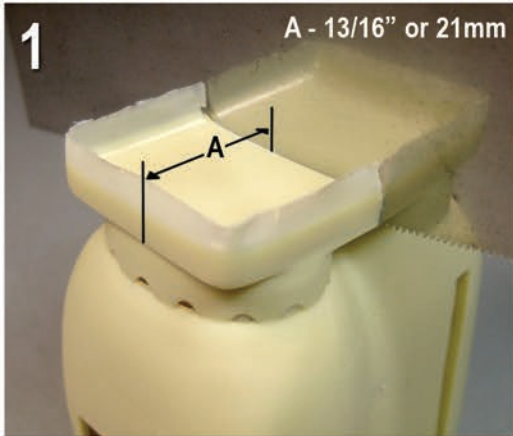



BR32334

Hawker Tempest Mk V Nose Correction Set

For the 1/32 scale Special Hobby Tempest Mk. V kit. May be adapted with some work to fit the Pacific Coast Hobbies kit.



Designed by Anthony Galbraith, Kerry Carlyle and Roy Sutherland

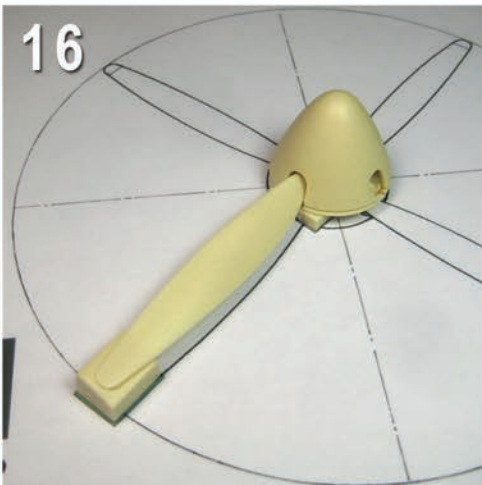
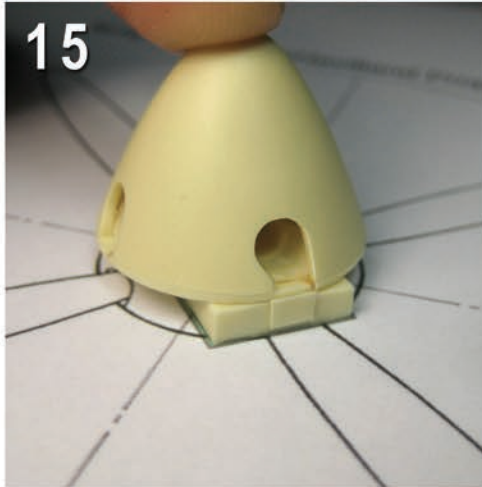

1/32 Tempest Mk V deHavilland Prop Assembly Jig

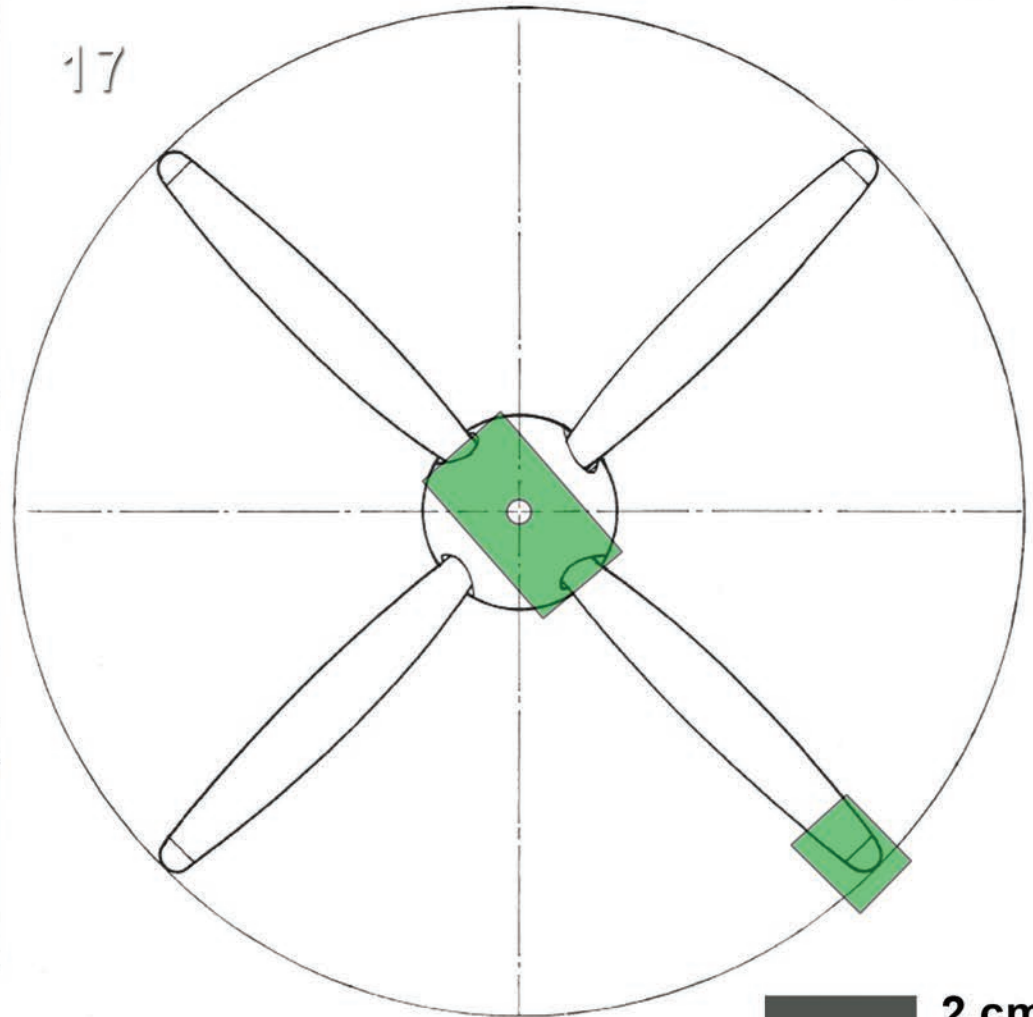

www.barracudacals.com

2 cm
1"