



BR32020
**Mercedes D.III/
 D.IIIa/D.IIIau
 Intake Manifold**



Master by Mike Braun

Designed for the 1/32 Wing Nut Wings Roland D.VIa, Pfalz D.III, Pfalz D.IIIa, Albatros D.V and D.Va, Pfalz D.XII, and Fokker D.VII

The Mercedes D.III six cylinder inline engine was widely used in the German Air force during World War I. It was modified and uprated a number of times to boost horsepower from the original 150 hp. The later versions developed nearly 200 hp! This simple two part resin upgrade set replaces the kit intake manifolds. The manifold has been detailed to include the asbestos cord insulation wrapped around the intake pipes. The sheet metal shielding has also been modelled and the mounting clamps are petily reproduced. Castellated couplings and additional details round out this simple upgrade. This set can be made to fit kits from Roden and others with a small amount of modification.

1. The only work required for this set is removing the block and cleaning up the lasting. Start by sawing free the 6 cylinder intake ports as shown.
2. Cut the carburetor free by removing a wedge from the supporting rib with flush cutters as shown.
3. Using a hobby knife carefully cut through the 4 sprue points on the vertical sections of the intake pipes. The manifold will now be mostly free. Carefully work casting until it comes free. There may be some thin flash holding it to the block.
4. Carefully remove small wiring part. Attach as shown, including additional line for later versions of the engine. Two holes on horizontal portion of exhaust are for mounting the water cooling pipe used on later engines. Fill these holes if you are building an early engine.
5. Cleanup as shown and test fit to engine. Attach after painting engine and manifold with cyanoacrylate.

Happy modelling,

Royd

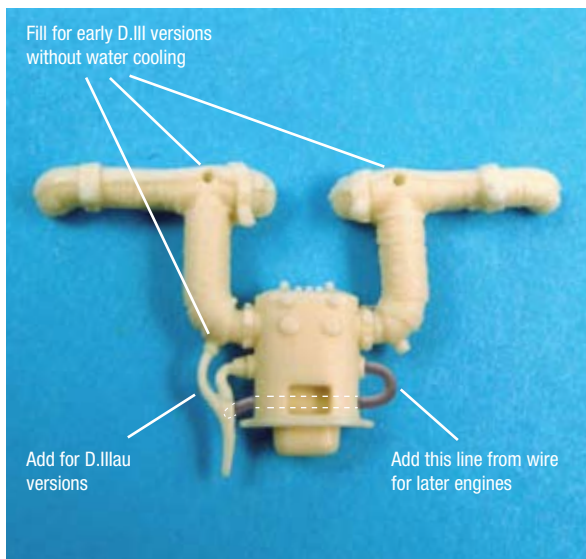
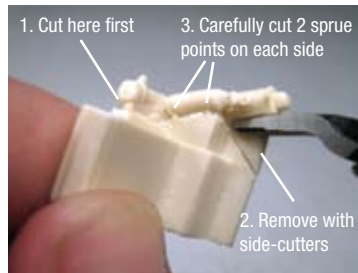
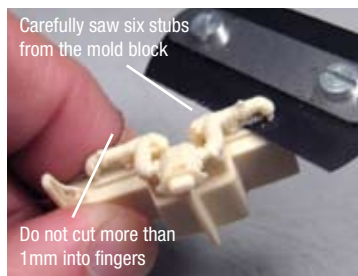

For painting details, go to www.wingnutwings.com. See the color photos file on the Pfalz D.XII product page.
 To view out other products visit our website at www.barracudacals.com



BR32020
**Mercedes D.III/
 D.IIIa/D.IIIau
 Intake Manifold**



Master by Mike Braun

Designed for the 1/32 Wing Nut Wings Roland D.VIa, Pfalz D.III, Pfalz D.IIIa, Albatros D.V and D.Va, Pfalz D.XII, and Fokker D.VII

The Mercedes D.III six cylinder inline engine was widely used in the German Air force during World War I. It was modified and uprated a number of times to boost horsepower from the original 150 hp. The later versions developed nearly 200 hp! This simple two part resin upgrade set replaces the kit intake manifolds. The manifold has been detailed to include the asbestos cord insulation wrapped around the intake pipes. The sheet metal shielding has also been modelled and the mounting clamps are petily reproduced. Castellated couplings and additional details round out this simple upgrade. This set can be made to fit kits from Roden and others with a small amount of modification.

1. The only work required for this set is removing the block and cleaning up the lasting. Start by sawing free the 6 cylinder intake ports as shown.
2. Cut the carburetor free by removing a wedge from the supporting rib with flush cutters as shown.
3. Using a hobby knife carefully cut through the 4 sprue points on the vertical sections of the intake pipes. The manifold will now be mostly free. Carefully work casting until it comes free. There may be some thin flash holding it to the block.
4. Carefully remove small wiring part. Attach as shown, including additional line for later versions of the engine. Two holes on horizontal portion of exhaust are for mounting the water cooling pipe used on later engines. Fill these holes if you are building an early engine.
5. Cleanup as shown and test fit to engine. Attach after painting engine and manifold with cyanoacrylate.

Happy modelling,

Royd

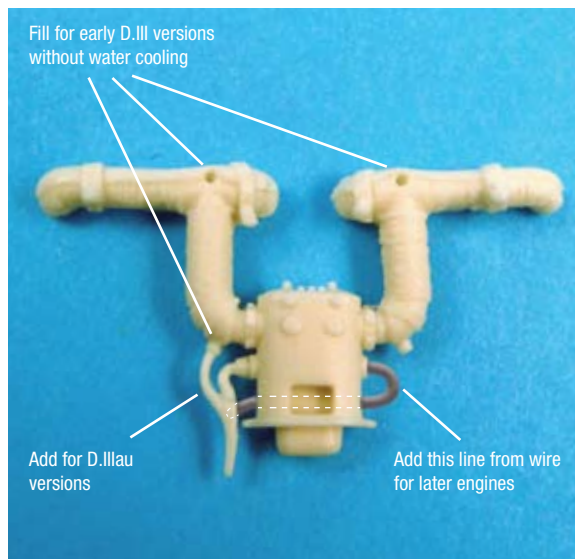
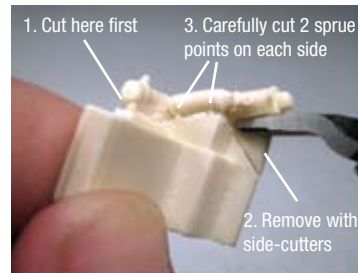
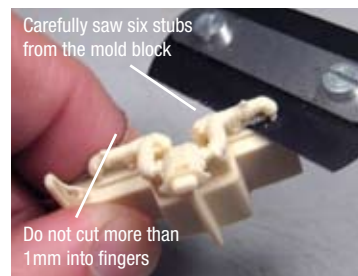

For painting details, go to www.wingnutwings.com. See the color photos file on the Pfalz D.XII product page.
 To view out other products visit our website at www.barracudacals.com