

## Thermoelectric cooler TG 3030-12V Recessed



### Product Features

<b>Brand Name:</b>	SoliTherm Peltier
<b>Order Number:</b>	3030303
<b>Housing Material:</b>	Stainless steel AISI 304 (V2A)
<b>Ingress protection:</b>	IP 66, Type 4X
<b>Note:</b>	The torque for the mounting nuts should be 4.5 Nm.
<b>Approvals:</b>	CE, cURus, RoHS

#### Accessories:



[Condensate Kit](#)



[Wall Mounting Kit](#)

<b>Taric Code:</b>	84158300
--------------------	----------

## Technical data TG 3030-12V Recessed

<b>Cooling capacity 95F/95F:</b>	100 BTU
<b>Temperature range:</b>	-4°F - 149°F
<b>Air volume flow (system / unimpeded):</b>	Ambient air circuit: 23 / 44 cfm Cabinet air circuit: 12 / 36 cfm
<b>Mounting:</b>	Recessed
<b>Dimension H x W x D:</b>	4.3 x 6.1 x 5 inch
<b>Weight:</b>	4 lbs.
<b>Cut out dimensions:</b>	4.8 x 3.54 inch
<b>Voltage / Frequency:</b>	12 V DC (use NEC Class 2 supply)
<b>Current 95F95F:</b>	2.8 A
<b>Starting current:</b>	4.3 A
<b>Max. current:</b>	2.9 A
<b>Nominal power 95F95F:</b>	34 W
<b>Max. power:</b>	35 W
<b>Fuse:</b>	5 A (T)
<b>Connection:</b>	Connection terminal block

Please click on the graphics to download.  
 More CAD drawings can be found under [Product Download](#).  
 > [Overview product group Thermoelectric coolers](#)

**Performance Graph:**

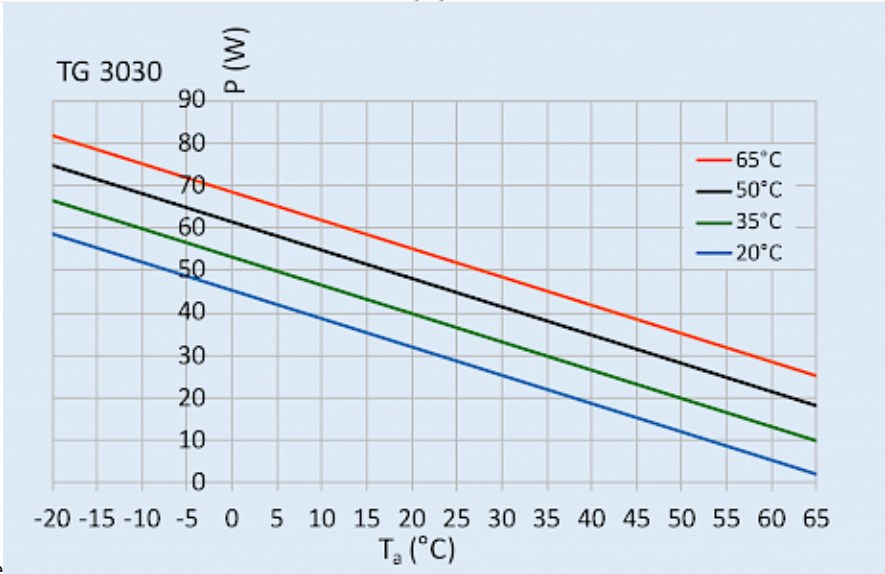
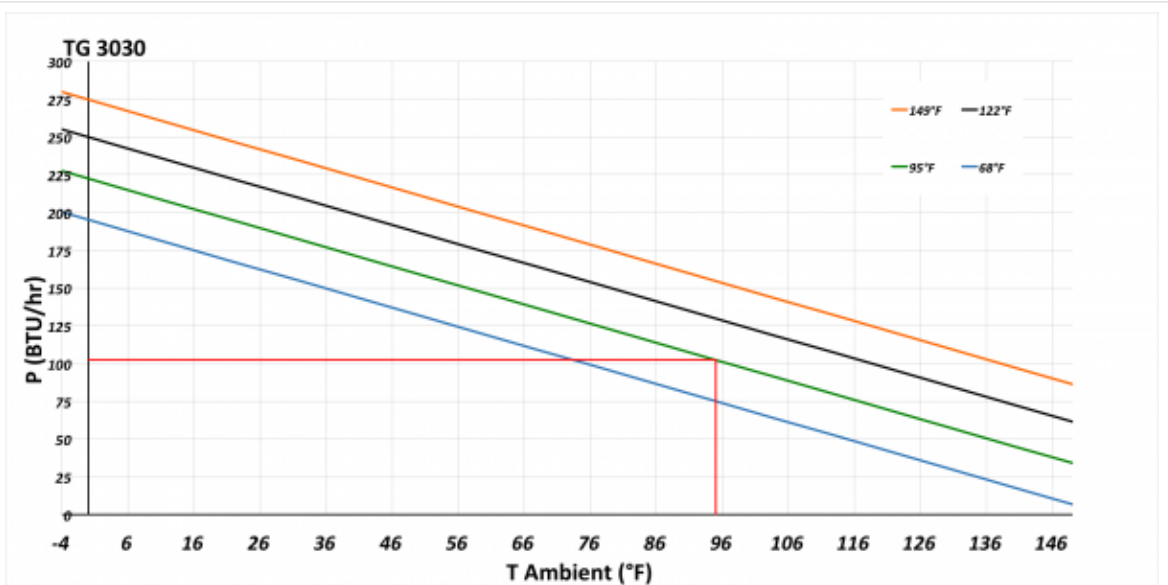

click image to enlarge

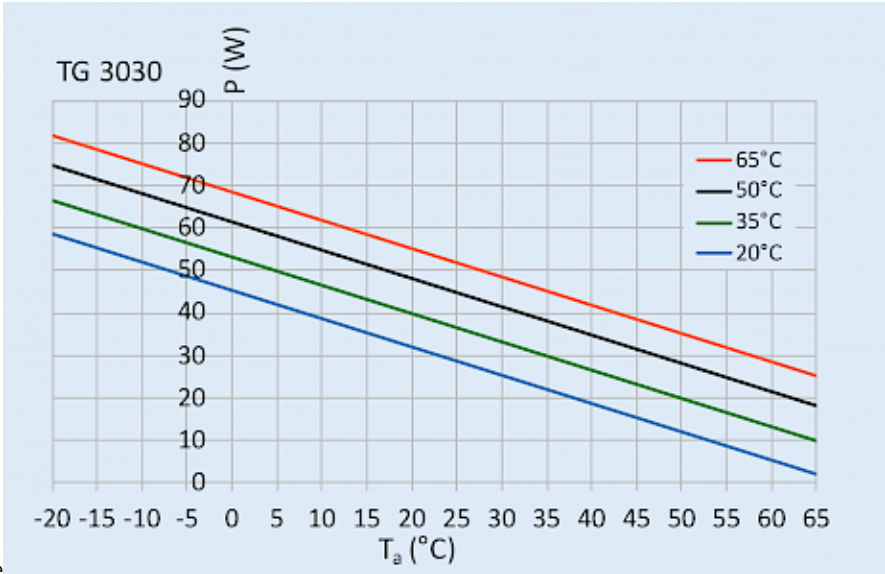

click image to enlarge  
click image to enlarge

**Air flow:**

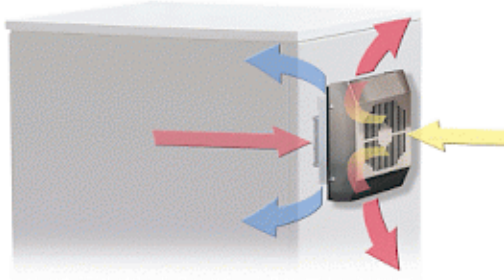

[click image to enlarge](#)

**Cut out dimensions:**

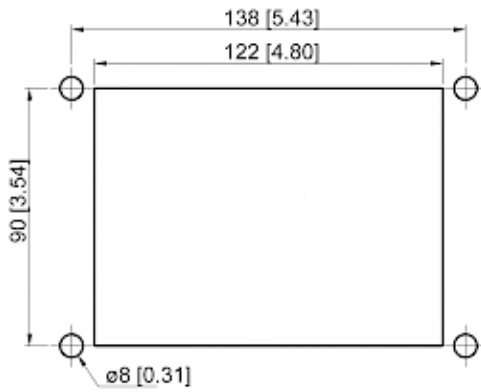

Note:  
Primary dimensions in millimeters.  
Secondary dimensions in inches.

[click image to enlarge](#)

**Product Accessories:**



[click image to enlarge](#)