

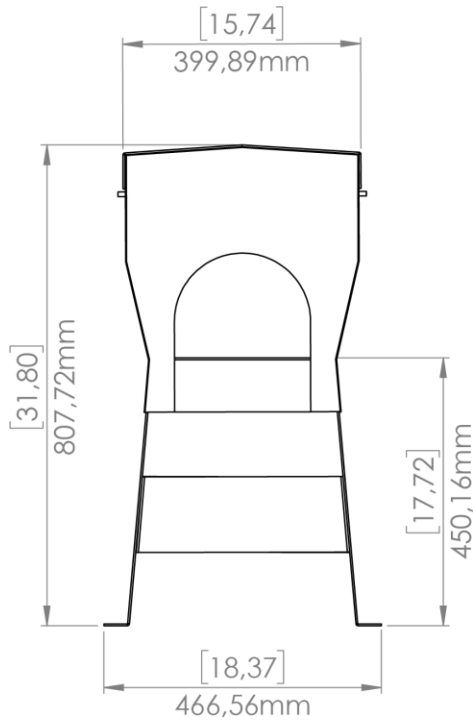

ALUMINUM WEATHER HOOD/ PEDESTAL

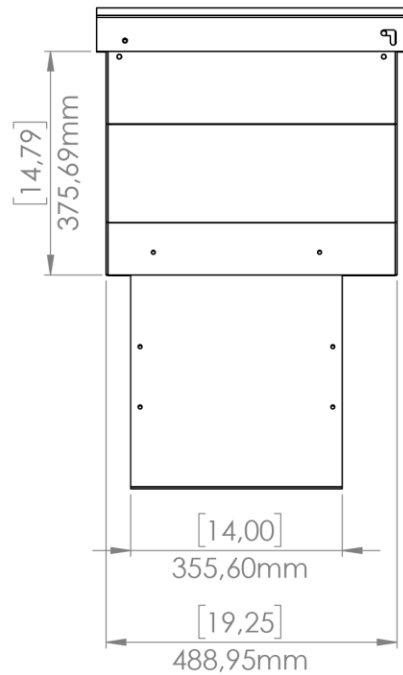

Values with [] are in inches.



FEATURES

Aluminum weather hood mounted on an aluminum support pedestal for excellent weather protection. Grey powder coat finish, 0.125" cast aluminum, type 5052 H32 aluminum with stainless steel hardware. Temperature limitation is 400° F.

- Corrosion resistant grey powder coat finish.
- Corrosion resistant aluminum construction.
 - 5052 H32 aluminum.
 - Gauge thickness 0.125".
 - Pedestal weight limitation of 800lbs static vertical load.
- Stainless steel assembly hardware.
- User friendly inspection hood.
 - Reversible front to back and back to front opening.
 - Easy to apply locks, disconnect switch, etc.
 - Self-locking in open position.

Project Name	
Date	
Engineer / Sales Rep	
Client	
Contractor	

Property rights to all drawings, details, representations, ideas, data, notes and specifications either copies or originals thereof that may be incorporated into the design and/or project are the property solely of Plastec Ventilation, Inc. Permission for any copies of said copyrighted materials, drawings, details, representations, ideas, data, notes and specifications either originals or copies thereof to be made, copied or altered by any person, business, or corporation may only be authorized with the expressed written permission of Plastec Ventilation, Inc. By the use of this data, the user acknowledges that he/she has read and understand all of the notes included herein.