

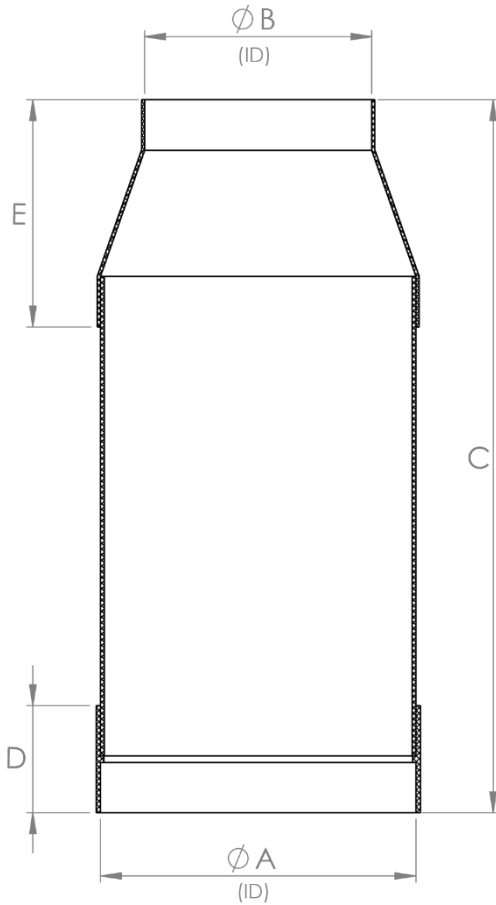

# DISCHARGE NOZZLE



Model Number	A mm (in)	B mm (in)	C mm (in)	D mm (in)	E mm (in)	Weight Kg (Lbs)	Blower compatibility
SN160	160 (6.3)	125 (4.9)	396 (15.6)	60 (2.4)	180 (7.1)	0.22 (0.5)	P20/J20/S16
SN200	200 (7.9)	160 (6.3)	505 (19.9)	85 (3.3)	200 (7.9)	1.4 (3)	P25/J25/S18
SN250	250 (9.8)	180 (7.1)	565 (22.2)	85 (3.3)	180 (7.1)	1.8 (4)	P30/J30
SN315	315 (12.4)	250 (9.85)	674 (26.5)	105 (4.1)	190 (7.5)	3.6 (8)	P35

## FEATURES

Polypropylene high velocity discharge exhaust nozzle optimized for plume height requirements resulting in higher discharge momentum and displacement of chemicals high above the roof.

- Color: Grey
- Material of construction: Polypropylene
  - Thermal conductivity:  $0.22 W. (m. K)^{-1}$
  - Modulus of elasticity:  $1300 MPa$
  - Impact strength:  $2.8 kJ. cm^{-3}$
  - Density:  $0.91 g. cm^{-3}$
  - UV Stabilized
- Designed to avoid re-entry of corrosive and toxic fumes or gases into make-up air equipment, outside air louver intakes, or public areas.
- Available with optional stackable polypropylene discharge stack system.
- Compatible with the Standard and XP blowers

<b>Project Name</b>	
<b>Date</b>	
<b>Engineer / Sales Rep</b>	
<b>Client</b>	
<b>Contractor</b>	

Property rights to all drawings, details, representations, ideas, data, notes and specifications either copies or originals thereof that may be incorporated into the design and/or project are the property solely of Plastec Ventilation, Inc. Permission for any copies of said copyrighted materials, drawings, details, representations, ideas, data, notes and specifications either originals or copies thereof to be made, copied or altered by any person, business, or corporation may only be authorized with the expressed written permission of Plastec Ventilation, Inc. By the use of this data, the user acknowledges that he/she has read and understand all of the notes included herein.