

Drilling template for BLUMOTION/TIP-ON

Web-Link

assemblydevices.blum.com

Assembly possibilities

AVENTOS
CLIP top



Symbol image

- Template for drilling the side fixing positions for BLUMOTION for doors handle side (970.1002) and hinge side (970A1002) as well as for TIP-ON for doors (955x1004)
- Assembly on a marking line
- Material: nylon/steel

Order information

	Part no.
Drilling template for BLUMOTION/TIP-ON	65.5010

Composed of:

Drilling template for BLUMOTION/TIP-ON	1 x
Drilling depth spacer Ø 10 mm	1 x

Page instructions

Overview – templates, jigs and assembly devices

609

Assembly possibilities

AVENTOS/CLIP top

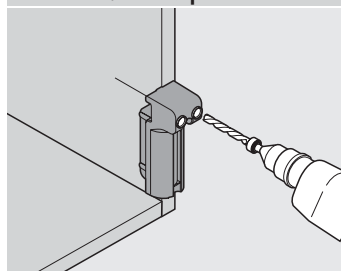

TIP-ON assembly

- Position template on marking line
- Distance from cabinet inner side to centre drilling 7.5 mm
- Perform drilling for TIP-ON (Ø 10 mm)

CLIP top

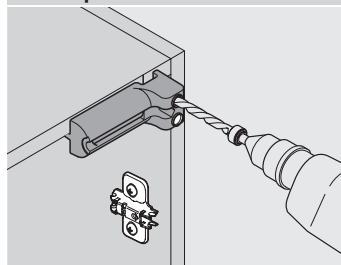

BLUMOTION assembly

- Position template on marking line
- Distance from cabinet inner side to centre drilling 7.5 mm
- Perform drilling for BLUMOTION (Ø 10 mm)