



► Templates, jigs and assembly devices

Drilling template for the SERVO-DRIVE switch

Web-Link

assemblydevices.blum.com

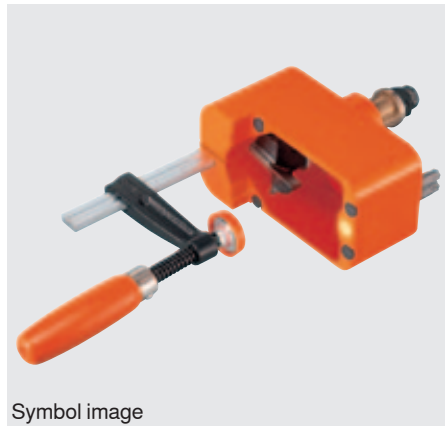

Symbol image

- Simple hand-held tool for drilling accurate holes for the SERVO-DRIVE switch attachment
- Driven by hand drill
- Drilling template can be used with assembled and unassembled cabinets
- Assembly on a marking line
- Material: aluminium die casting

Assembly possibilities

AVENTOS

Order information

	Part no.
Drilling template for the SERVO-DRIVE switch	M31.2000

a Accessories		Part no.
	Fittings drill bit Ø 35 mm	M31.ZB35.02

Composed of:

Drilling template	1 x
Fittings drill bit Ø 35 mm	1 x
Torx bit	2 x

Page instructions

Overview – templates, jigs and assembly devices

609

Assembly possibilities

AVENTOS

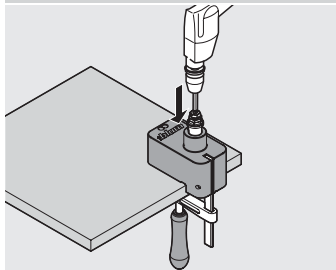

SERVO-DRIVE assembly

- Mark desired SERVO-DRIVE switch position
- Position template on marking line and fix with clamping screw
- Perform attachment drillings for the SERVO-DRIVE switch with the hand drill