

Assembly devices

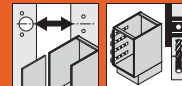

► Templates, jigs and assembly devices

Universal drilling template

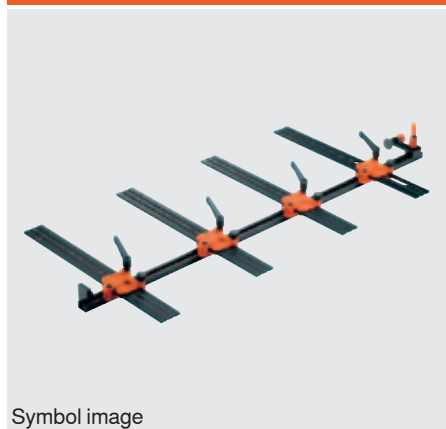

Symbol image

- Template for pre-drilling the fixing positions for cabinet profiles, lift mechanisms, mounting and adapter plates
- The template can be used with assembled and unassembled cabinets
- Setting the height and depth position using the calibration
- Suitable for overlay and inset applications
- For system and chipboard screws
- Assembly on marking line possible
- Material: nylon/steel/aluminium/zinc

Web-Link

assemblydevices.blum.com

Assembly possibilities

AVENTOS
CLIP top BLUMOTION/CLIP top
MODUL
TANDEMBOX intivo
TANDEMBOX antaro
TANDEMBOX plus
METABOX
MOVENTO
TANDEM
STANDARD

Order information

	Part no.
Universal drilling template	65.1000.01

Composed of:

Extension rail 1000 mm	1 x
Universal drilling template	4 x
Drilling depth spacer Ø 5 mm	1 x
Reducing bush Ø 5 to Ø 2.5 mm	1 x
Allen key	1 x

a Accessories

	Extension rail 2200 mm	Part no. 65.7590
--	---------------------------	---------------------

	Add-on for SPACE CORNER	Part no. 65.1106
--	----------------------------	---------------------

	Universal drilling template	Part no. 65.1001.01
--	--------------------------------	------------------------

Page instructions

Overview – templates, jigs and assembly devices

609

Assembly possibilities

AVENTOS

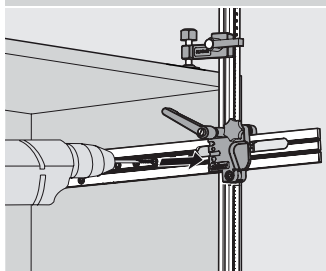

Cabinet assembly

- Set template height and depth position using the calibration
- Pre-drill fixing positions for lift mechanism pegs

CLIP top BLUMOTION/CLIP top/MODUL

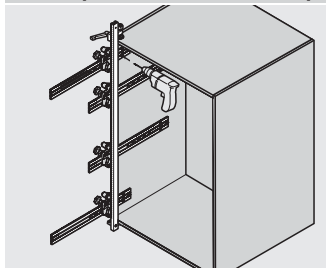

Hinge system assembly

- Set template height and depth position using the calibration
- Position template on cabinet
- Pre-drill fixing positions for mounting and adapter plates (BLUMOTION/TIP-ON for doors)

TANDEMBOX intivo/TANDEMBOX antaro/TANDEMBOX plus/METABOX/MOVENTO/TANDEM/STANDARD

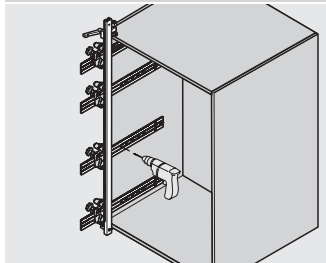

Cabinet assembly

- Set template height and depth position using the calibration
- Position template on cabinet
- Pre-drill fixing positions for cabinet profiles
- Pre-drill fixing positions for BLUMOTION for METABOX
- The additional part (65.1106) enables SPACE CORNER assembly