

Prosport Inc. Premium Boost Gauge

Blue/White Display (270° Scale)

1. Wiring Back of Gauge

(Daisy Chain power wire to next gauge plugs in here.)

Optional External Warning light Plugs in here.

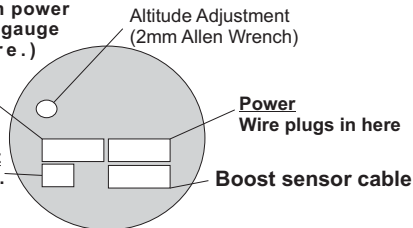

Red- Constant Power (A power source that has power with the car on or off)
Black- Ground
White- Accessory(Acc.) Power (Power when Ignition key is on)
Orange- Headlights (Power when Headlights are on). This will make the gauge change color when the headlights are turned on.

Wiring Instructions

2. Setting warning / Mute Feature

To set the warning feature:

After the opening ceremony is complete, Press and hold the button down for approx 5 seconds until the pointer begins to blink. Release button. Push and hold button to move quickly across the scale or Toggle button to move pointer in small increments. Once you have the pointer where you want it, wait 5 seconds to "set" and pointer will stop blinking

Mute feature:

- 1.) With ignition key in off position, press and hold button- Turn Ignition on, wait for pointer to come to a rest then release button.
- 2.) To turn sound back on-Repeat step 1

Peak recall

- 1.) Push button one time to recall peak level. The Blue light will come on when gauge is in recall mode. The pointer will rise to the Highest level attained by the gauge and remain there approximatley 5 seconds.
- 2.) To reset peak level: While in peak mode (blue light is on) press and hold button down

3. Installing Boost sender

Cut boost line and install supplied plastic "T" fitting. Connect "T" fitting to In-Line Filter with supplied hose. Then connect In-Line Filter to sender with supplied hose.

****Very important to keep foreign material out of the boost sender.**

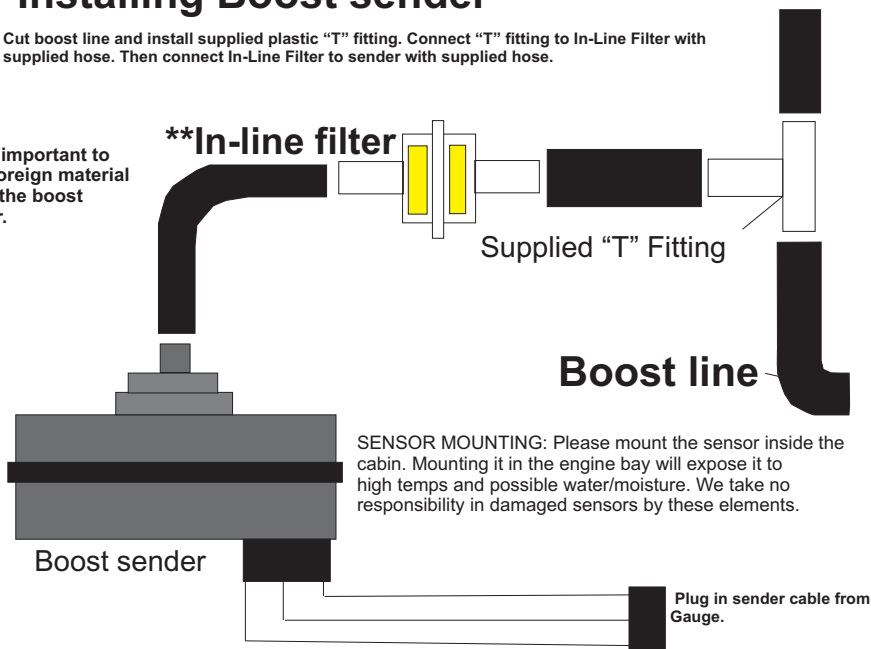

Lighting Diagram

Day Time	Night Time	Installation
White	White	White — Connect to acc. Power Amber — Do not connect
Blue	Blue	White — Do not connect Amber — Connect to acc. Power
White	Blue	White — Connect to acc. Power Amber — Connect to parking lamp
Blue	White	Amber — Connect to acc. Power White — Connect to parking lamp

