

ZF-31 / VIBRATION REDUCTION AIR PIPE SAW

**VIBRATION
REDUCTION**

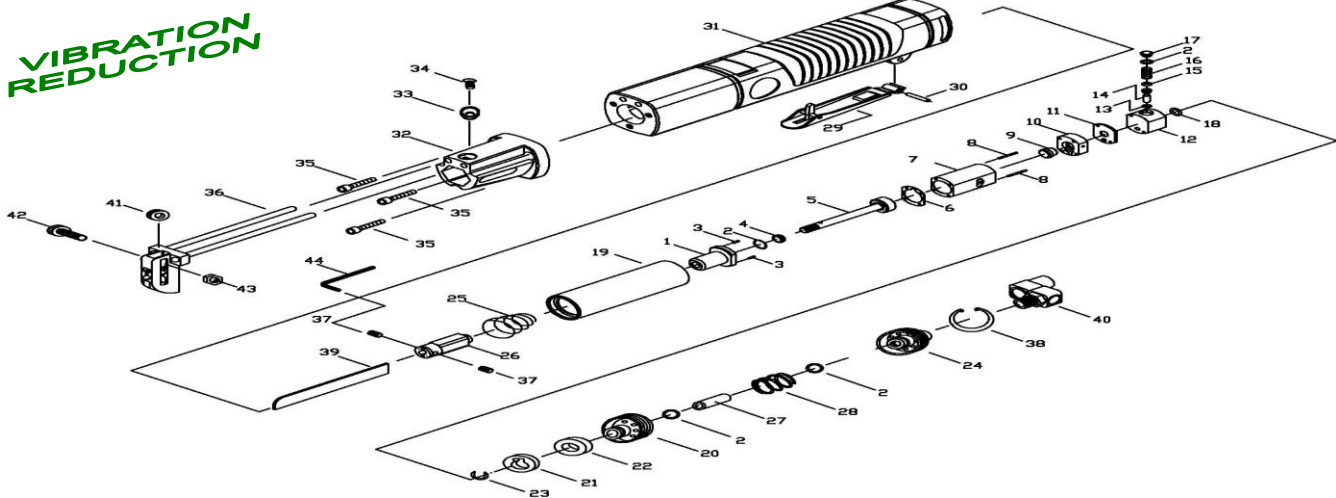

TECHNICAL DATA

Cutting Capacity	Cut a wide range of materials small pipe, rods and bars. Trim or shape sheet metal, light plate and plastics.
Operating Air Pressure (Maximum)	6.3 Kg/Cm ² (90PSI)
Strokes Per Minute @90psi	5,000
Stroke Length	25 mm (1")
Avg. Air Consumption	6 CFM
Air Inlet (NPTF)	1/4"
Min. Hose Size	3/8" I.D.
Net Weight	0.96 kgs (2.11 Lbs)
Overall Length	268 mm
Sound Pressure	< 85 dBA
Vibration	< 9 m/s ²
Standard Accessories Include	1 pc of 3mmHex Wrench 1 each of 24T,18T Saw Blade

PARTS LIST

Index #	Part #	Description	Q'ty	Index #	Part #	Description	Q'ty
1	314403	Cylinder Head Ass'y	1	24	317702	Air Inlet	1
2	OR0812	O-Ring (4)	4	25	318607	Shock Absorbent Spring	1
*3	RP2006	Front Dowel Pin (2)	2	26	316407C	Blade Holder Ass'y	1
4	314418	Bumper	1	27	315202	Connecting Hose	1
5	317402	Piston Ass'y	1	28	315608	Spring	1
6	314405	Gasket	1	29	315601	Safety Lever Ass'y	1
7	317401	Cylinder	1	30	SP3018	Spring Pin	1
8	RP2020	Rear Dowel Pin (2)	2	31	317111B	Body	1
9	314302	Automatic Valve	1	32	315102	Front Head	1
10	314311	Valve Chest	1	33	315104	Spacer	1
11	314303	Valve Seat	1	34	040706M	Screw	1
12	314222	Valve Case	1	35	40712	Screw (3)	1
13	OR0507	O-Ring	1	36	315700	Saw Blade Guide	1
*14	314612	Valve Stem	1	37	61006	Set Screw (2)	1
15	OR0307	O-Ring	1	38	CH3538	Retaining Ring	1
*16	318603	Spring	1	39	317924Z-1	24T Saw Blade	1
17	314606	Valve Cap	1		317918Z-1	18T Saw Blade	1
*18	318203	Rubber Washer	1	40	922A18	1/4"NPT Universal Swivel Air Inlet Joint (opt.)	1
19	318101	Main Liner	1	41	315707	Guide Wheel	1
20	318211	Adaptor	1	42	40713	Screw	1
21	318704	Muffler Cap	1	43	NN0407B	Nut	1
22	301709	Muffler	1	44	314933	3mm Hex Wrench	1
23	EC1317	Retaining Ring	1				

***FOR FREQUENCY REPLACEMENT PARTS**

DATE : 12/01/2014