

MASTER COPY

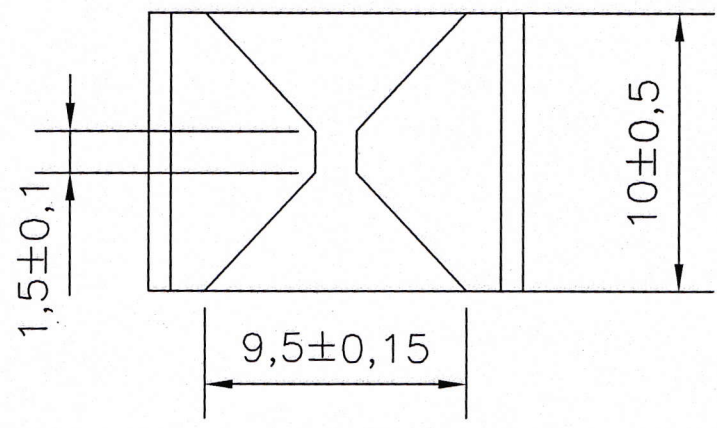
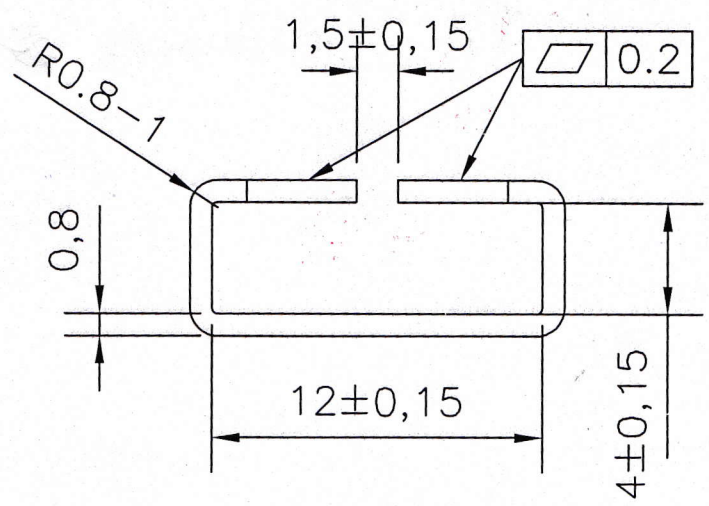

DO NOT SCALE THE DRG.  
IF IN DOUBT PLEASE ASK.

THE COPYRIGHT OF THESE DRAWINGS AND OF ALL ENCLOSURES  
ENTRUSTED TO THE RECIPIENT PERSONALLY REMAINS THE EXCLUSIVE  
PROPERTY OF THIS FIRM WITHOUT OUR WRITTEN CONSENT THEY  
MAY NOT BE COPIED OR REPRODUCED OR DELIVERED OR MADE  
KNOWN TO THIRD PARTIES

|  |                            |          |  |  |                                     |              |   |          |        |          |         |            |         |          |                    |
|--|----------------------------|----------|--|--|-------------------------------------|--------------|---|----------|--------|----------|---------|------------|---------|----------|--------------------|
| UNSPECIFIED TOL. OF MACHINED<br>DIMS. AS PER IS:2102 TABLE 1 (MEDI.)<br>FABRICATED DIMS. AS PER IS:7215. | Sr.No.                     |          |  |  |                                     |              |   |          |        |          |         |            |         |          |                    |
|  | MODIFICATIONS              |          |  |  |                                     | UNITS: MM.   |   |          |        |          |         |            |         |          |                    |
|  | <b>Material: 48% Ni-Fe</b> |          |  |  |                                     | SCALE<br>NTS | <table border="1"> <tr> <td>PREPARED</td> <td>Melwyn</td> <td>22/01/14</td> </tr> <tr> <td>CHECKED</td> <td><i>Rgk</i></td> <td>22/1/14</td> </tr> <tr> <td>APPROVED</td> <td><i>[Signature]</i></td> <td>22/1/14</td> </tr> </table> | PREPARED | Melwyn | 22/01/14 | CHECKED | <i>Rgk</i> | 22/1/14 | APPROVED | <i>[Signature]</i> |
| PREPARED   | Melwyn                     | 22/01/14 |  |  |                                     |              |   |          |        |          |         |            |         |          |                    |
| CHECKED  | <i>Rgk</i>                 | 22/1/14  |  |  |                                     |              |   |          |        |          |         |            |         |          |                    |
| APPROVED   | <i>[Signature]</i>         | 22/1/14  |  |  |                                     |              |   |          |        |          |         |            |         |          |                    |
| PERMANENT MAGNETS LTD.<br>MIRA ROAD (E), MUMBAI - 401 104  |                            |          |  |  | Drawing No.<br><b>Z-C-SH-052-R0</b> |              |   |          |        |          |         |            |         |          |                    |