



ZZ

ZZAIR-CP

Converts factory wired to wireless CarPlay

10.15.2020



1 - Contents



• ZZAIR-CP Interface



• Manual

2 - Overview

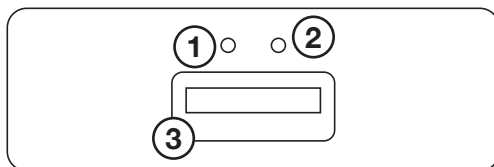

- 1 - Red LED - There is no phone connected to the ZZAIR-CP.
- 2 - Blue LED - There is a phone connected to the ZZAIR-CP.
- 3 - USB input - The input can be used to charge the phone.

3 - Main Menu

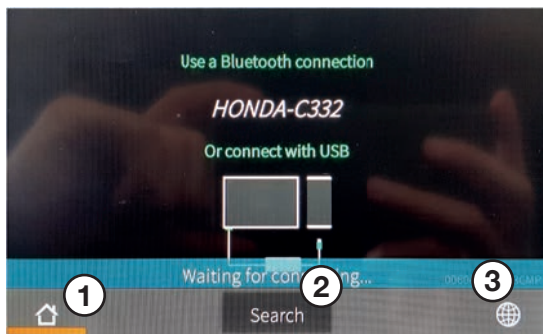

- 1 - Home: Factory radio screen
- 2 - Search for new devices
- 3 - Change Language

4 - How to pair with an iPhone

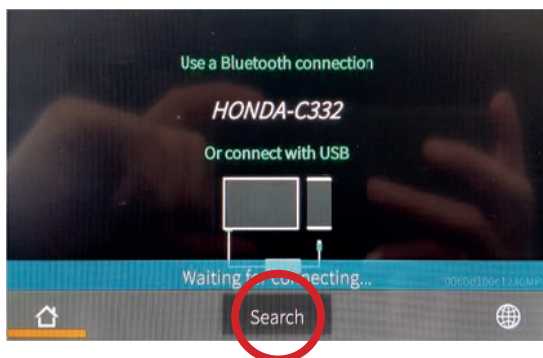

- Plug the ZZAIR-CP unit into the factory CarPlay USB input.
- The factory radio will ready it as an iPhone and the CarPlay icon will be available on the screen. Select the CarPlay option and the ZZAIR-CP main menu will be displayed on the screen.
- Turn the Bluetooth and WiFi ON. Go to Settings > Bluetooth > ON and then WiFi > ON.

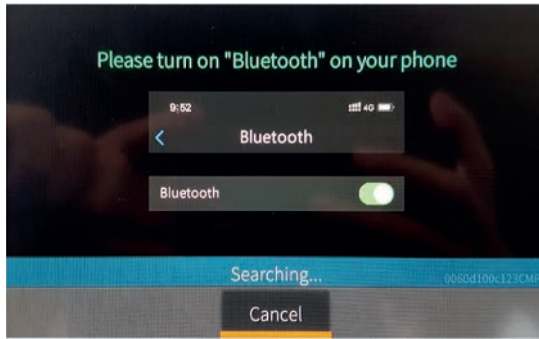

- Wait until ZZAIR-CP find your iPhone.

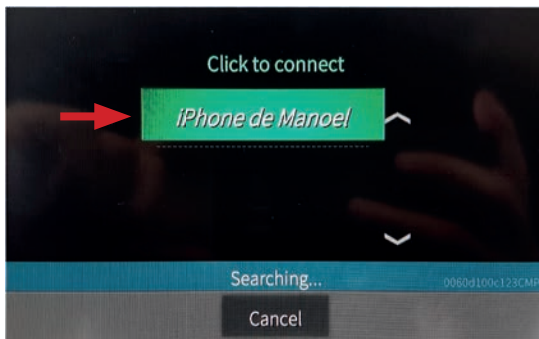

- Select the phone on the screen to connect to ZZAIR-CP.

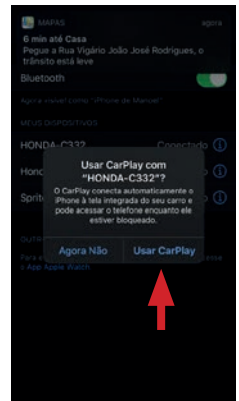
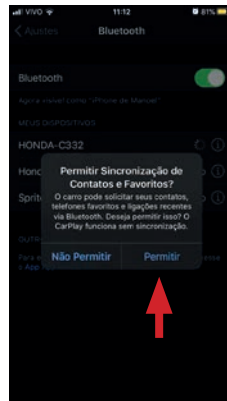
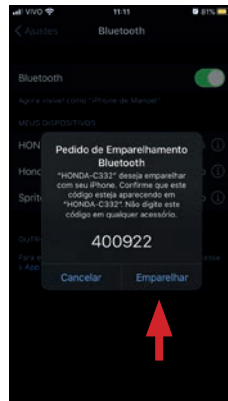
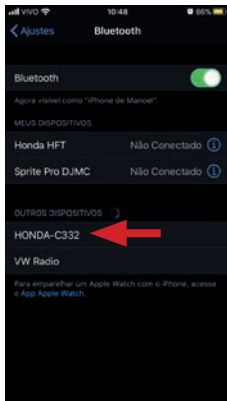

- Under "Other Devices" you will select the ZZAIR-CP, which begins with the brand of the vehicle followed by a "-" and 4 digits. Once that is selected please tap on "Pair" > "Allow" and finally "Use CarPlay".

5 - How to delete a phone from the ZZAIR-CP

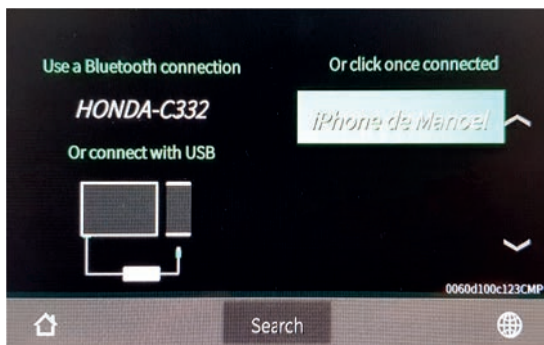

- Turn the bluetooth option in your iPhone OFF.
- With ZZAIR-CP connected into the car USB input, select CarPlay mode on your factory screen.
- On the right side of the screen all devices connected to ZZAIR will be displayed.
- Tap and hold the name of the iPhone for 3 seconds and the option to delete the device will be available.

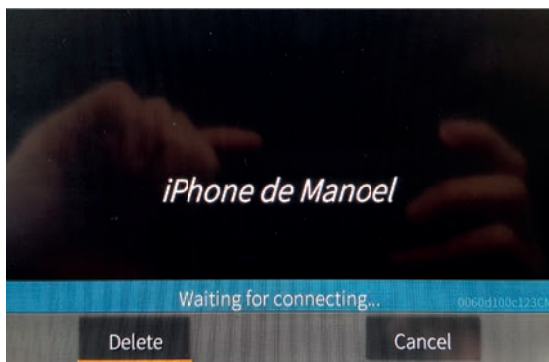

Press the "Delete" button to remove the device from the ZZAIR memory

6 - How to update the ZZAIR-CP

Our team is constantly making improvements to our ZZAIR-CP. The updates expand compatibility, improving usage and functionality. In order to update your ZZAIR follow the steps below:

- Make sure the ZZAIR is connected to the car and you have your phone paired to the ZZAIR and CarPlay is visible on the screen.
- On your iPhone go to SAFARI and enter **192.168.50.2**
- The phone will communicate with the ZZAIR via Bluetooth. If your device is not up to date, a message on your phone stating a new software is available will appear.
- Tap on the button to update the ZZAIR and wait for the loading bar to reach 100%. This process may take up to 6 minutes.
- Once the update is complete, the ZZAIR will reboot and reconnect with your device automatically. This completes the update.



info@zz-2.com

929-220-1212

Toll free: 877-241-2526

www.zz-2.com