

IT2-TRG8

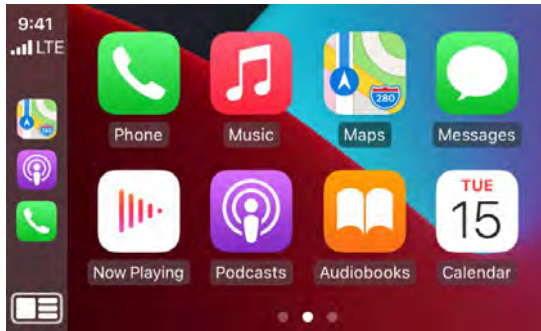

Apple Car Play



Android Auto

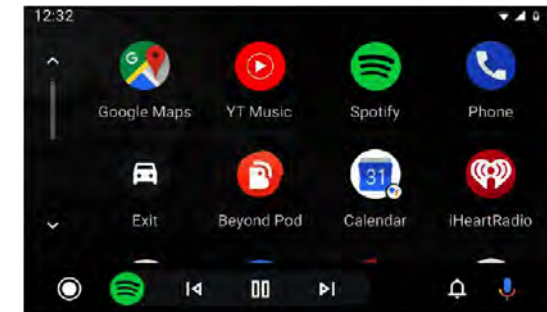

**CarPlay / Android Auto + Camera input for Volkswagen Touareg
equipped with RNS850 8" Screen Radio system**



929-220-1212 / 877-241-2526 - www.zz-2.com

09/14/2021



IT2-TRG8

CarPlay / Android Auto + Camera input for Volkswagen Touareg equipped with RNS850 8" Screen Radio system

Kit Components:



ZZPlay Interface (IT2)



Power Harness



CAN extension harness

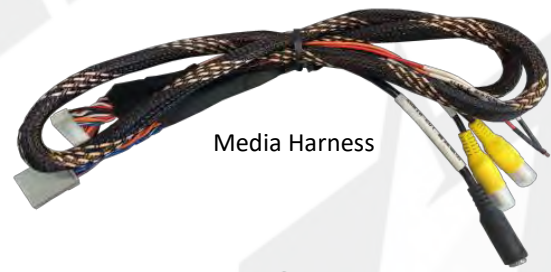

Media Harness

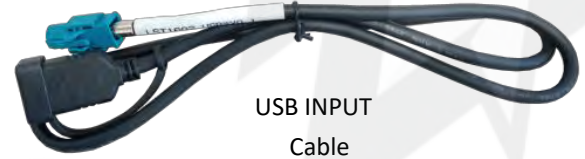

USB INPUT Cable



AUDIO T-Harness



Microphone



USB Adapter (updates)



BT/WIFI Antenna (SMB)



AUX dummy plug

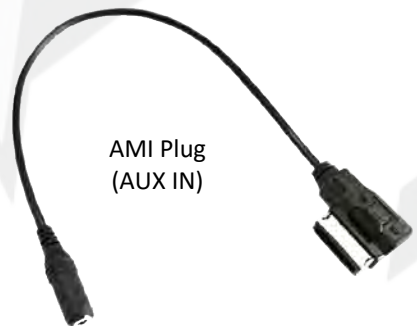

AMI Plug (AUX IN)



LVDS IN Cable



LVDS OUT Cable



IT2-TRG8

CarPlay / Android Auto + Camera input for Volkswagen Touareg equipped with RNS850 8" Screen Radio system

Installation Diagram:

NOTES:

- You must be in AUX mode in order to hear audio playback from CarPlay mode.

- The OE gray LVDS must be removed from the radio (leave connected to screen) and connected to the gray extension, to 'VIDEO OUT' port on the interface.

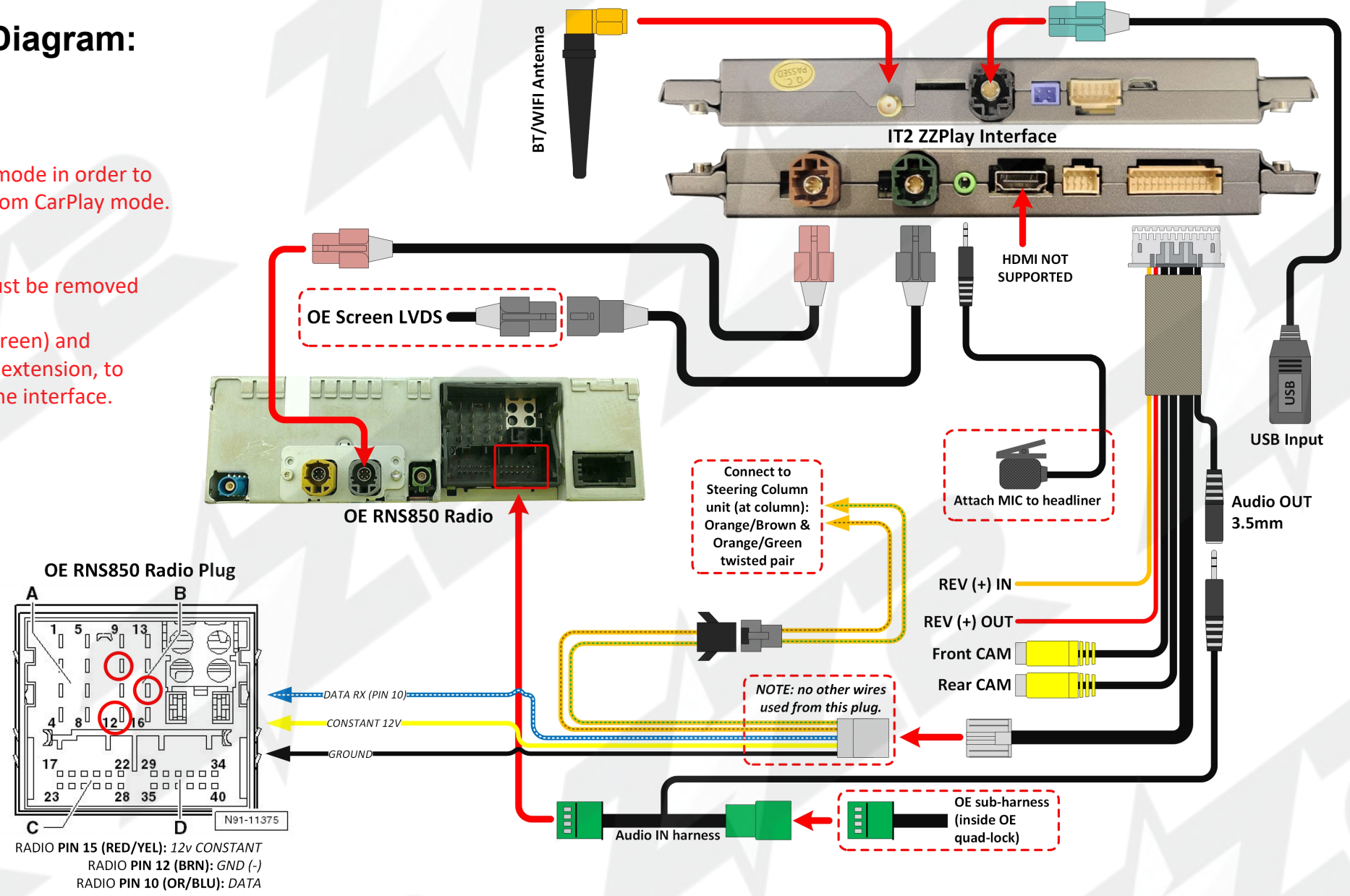



IT2-TRG8

CarPlay / Android Auto + Camera input for Volkswagen
Touareg equipped with RNS850 8" Screen Radio system

CAN Gateway location:

Orange/Green & Orange/
Brown twisted pair from
provided harness must
connect to the CAN
Gateway for reverse data:
Orange/Green & Orange/
Brown twisted pair (cut off
pins on provided harness
and tap OE wires)

*Alternatively, the same CAN wires can be
spliced at the Steering Column unit: Orange/
Green & Orange/Brown twisted pair (cut off
pins on provided harness and tap OE wires)*

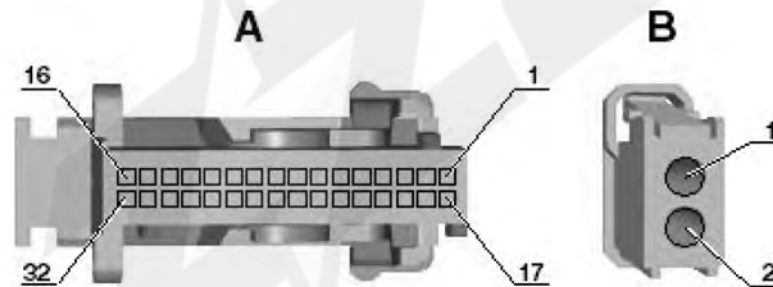



IT2-TRG8

CarPlay / Android Auto + Camera input for Volkswagen
Touareg equipped with RNS850 8" Screen Radio system

DIP SWITCH:

DIP SWITCH SETTINGS -
Cycle the power every time the
settings are modified!



DIP	Status	Functions
4	ON	Reverse detect guidelines off
	OFF	CAN Reverse guidelines on
6	ON	RGB input
	OFF	Rear view CVBS (default)
8	ON	Original camera
	OFF	aftermarket camera

Note: 1,2,,3,5,7 no definition, all be off as default



IT2-TRG8

CarPlay / Android Auto + Camera input for Volkswagen Touareg equipped with RNS850 8" Screen Radio system

How to access CarPlay/ Android Auto:

NOTE: Switch to AUX audio source before entering CarPlay/Android Auto!



Long-Press 'NAV' to switch into CarPlay/Android Auto mode.

Press and release 'NAV' once to switch back to OE PCM system.

To force Front View Camera on the screen at any time go to Settings>DVR and make sure the option is ON.

If CarPlay/Android Auto is on the screen, press and hold NAVI button to force front camera on.

CALL AUDIO ROUTING: If using the OEM system to handle phone calls, answer incoming calls with the steering wheel. **Also if using iPhone**, set 'Call Audio Routing' to 'Bluetooth Headset' (default is 'Automatic').

Settings > Accessibility

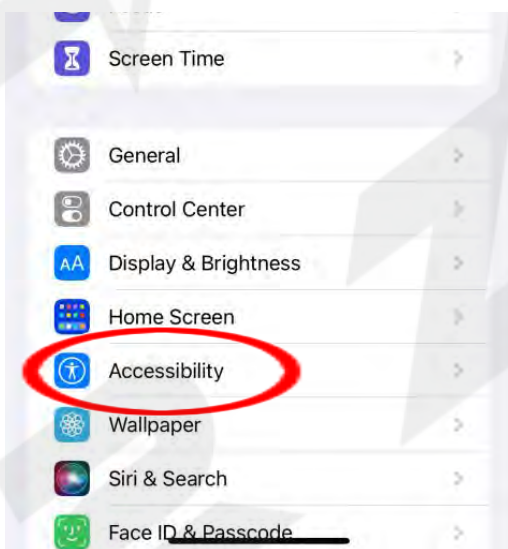

Touch

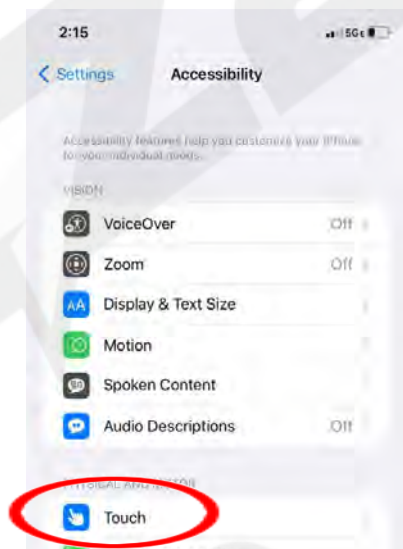

Call Audio Routing

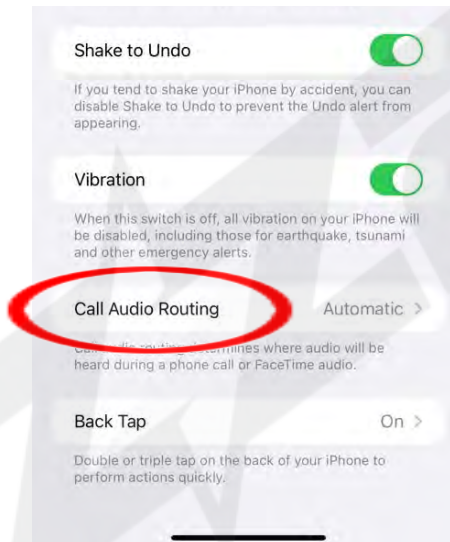

Call Audio Routing > set to 'Bluetooth Headset'

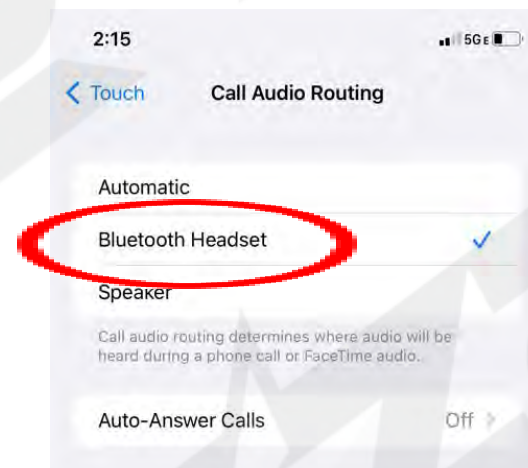



IT2-TRG8 iPhone Pairing

CarPlay / Android Auto + Camera input for Volkswagen Touareg equipped with RNS850 8" Screen Radio system

For this system, it's best to try connecting to the Phone **via the interface first**, and if its having trouble connecting, find the interface through the phone (via Bluetooth) during this operation.

1. Begin by turning Bluetooth and WIFI ON on the iPhone first (Settings > Bluetooth – set ON, then Settings > WIFI – set ON)
2. Next, with the interface menu screen on the radio screen (see further down document for information on switching to the interface), choose **Setup**.
3. Once in settings, swipe down to **Bluetooth**.
4. Once in 'Bluetooth', choose **Discover**.
5. Shortly after entering the 'Discover' menu, 'iPhone' should appear.

Select it, and it will ask to pair. Pair with the phone to begin the CarPlay registration process.

6. Follow the prompts on the phone to allow and use CarPlay. For a detailed step by step on this process, see the next page. Once the initial pairing is complete, CarPlay should load shortly. If not, go back to the main menu, and select 'CarPlay'.

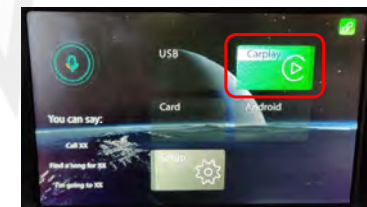
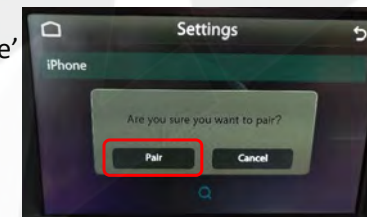
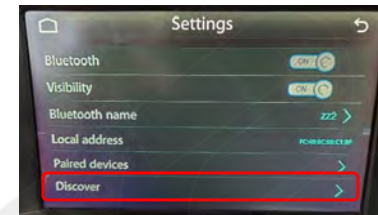
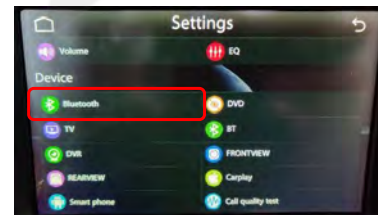

1. When using a USB cable to connect your iPhone, **only use a certified Apple cable**.
2. To use wireless connectivity, follow these steps:
 - a. Go to Settings > Bluetooth and the phone should be able to find a Bluetooth device called 'IDCORE' or 'ZZ2' under 'Other Devices'.
3. A Bluetooth Pairing Request will be displayed on the screen with a specific code which should match what is shown on CarPlay. Select 'Pair'. Note: following the BT connection, there is no need to try and connect WIFI manually (although it does need to be ON), after the BT connection process is complete, the WIFI will connect automatically on its own.
4. Immediately following the Pairing notification, a new request to Sync your contact with the car will be displayed. Select 'Allow' in order to have caller ID and access to your contacts through CarPlay.
5. A notification asking for a permission to connect your iPhone to the car even when the phone is locked will pop up. Select 'Use CarPlay' and the CarPlay main screen should show up on the factory radio screen. If not, press & hold the NAV button for 2 seconds to switch into CarPlay (from OE radio mode).

NOTE: If you're having pairing issues:

- Perform a 'hard reset' on the phone (will not delete data) in order to prevent any malfunction: With the phone unlocked, press & release VOL+, then press & release VOL-, then press and HOLD power for 10 seconds (wait for reboot – do not touch the screen).
- DELETE ALL other 'CarPlay' devices out of the phone (delete all in 'Settings – General – CarPlay')+
- Verify 'Low Data Mode' is not enabled in phone settings.
- Verify that the antenna is not mounted behind any metal dash panels.

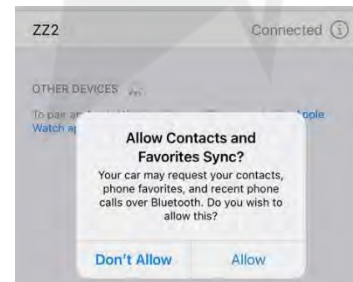
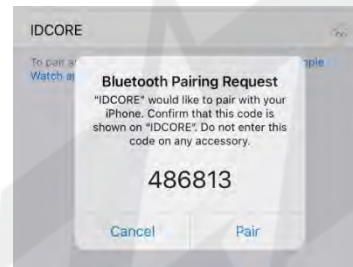



IT2-TRG8 Android Pairing

CarPlay / Android Auto + Camera input for Volkswagen Touareg equipped with RNS850 8" Screen Radio system

For this system, it's best to try connecting to the Phone **via the interface first**, and if its having trouble connecting, find the interface through the phone (via Bluetooth) during this operation.

1. Begin by turning Bluetooth ON on the iPhone first (Settings > Bluetooth – set ON, then Settings > WIFI – set ON)
2. Next, with the interface menu screen on the radio screen (see further down document for information on switching to the interface), choose **Setup**.

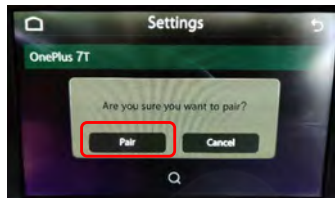
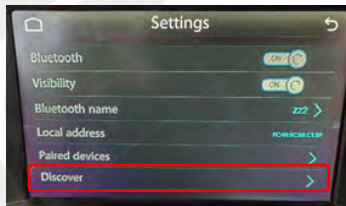
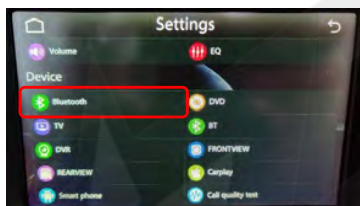

3. Once in settings, swipe down to Bluetooth.

4. Once in 'Bluetooth', choose Discover.

5. Shortly after entering the 'Discover' menu, the Android phone name should appear. Select it, and it will ask to pair. Pair with the phone to begin the Android registration process.

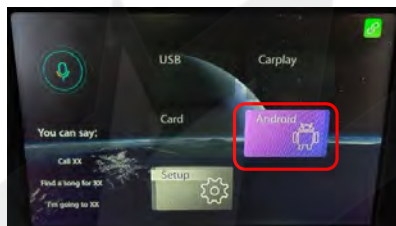

6. Follow the prompts on the phone to allow and use Android Auto. For a detailed step by step on this process, see the next page. Once the initial pairing is complete, Android Auto should load shortly. If not, go back to the main menu, and select 'Android'.

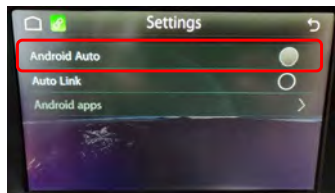
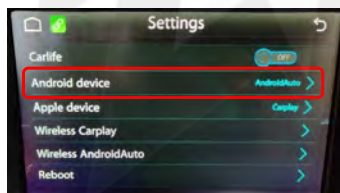
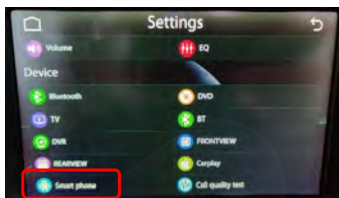

Inside **Setup**, swipe all the way down, press **Smart phone**

Choose **Android device**

Make sure **Android Auto** is selected. Go back to the main menu and you should be able to choose **Android Auto** now.

1. When using a USB cable to connect your Android, only use a certified Android OE cable.
2. To use wireless connectivity (Android 11+ only), follow these steps:
 - a. Go to Settings > Bluetooth Device Connection, or LONG PRESS on the Bluetooth toggle to enter Bluetooth connections
 - b. Select 'Pair new device'
 - c. Choose 'IDCORE' or 'ZZ2'
 - d. Bluetooth Pairing Request will be displayed on the screen with a specific code. Select 'Pair'. Note: following the BT connection, there is no need to try and connect WIFI manually (although it does need to be ON), after the BT connection process is complete, the WIFI will connect automatically on its own.
 - e. Immediately following the Pairing notification, a system prompt may or may not appear for contacts sharing with the system. Allow all requests for the best user experience.
 - f. Shortly after allowing/denying pairing requests, Android Auto will appear on the main screen automatically (for most phones). If not, press & hold the NAV button for 2 seconds to switch into Android Auto (from OE radio mode).

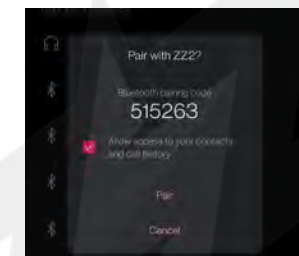
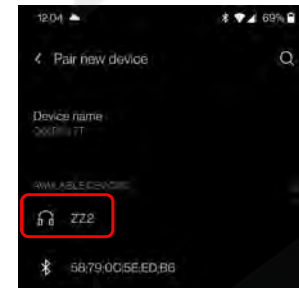

NOTES:

- Not every Android phone will work wirelessly. Pixel, Samsung & OnePlus devices equipped with Android 11 (or higher) have been tested to function well wirelessly. If your phone is having issues with wireless connectivity, verify with the installer that the antenna is not mounted behind any metal. If issues continue, use the original USB-C cable instead and connect to the interface's USB Input (do NOT use an aftermarket USB cable! – also, the vehicle's USB port is NOT used).
- Verify that 'Android Auto' is installed on your phone.
- Verify that in Android Auto settings (phone) that 'Wireless' is turned ON.
- Verify that WIFI is ON. The WIFI will connect automatically after Bluetooth has been properly paired.

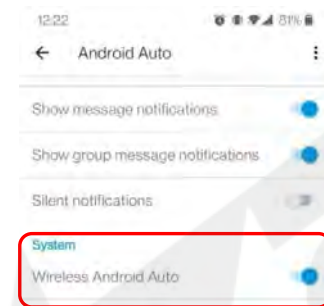

IT2 Interface Menu Overview

To gain access to the Interface menu, start in CarPlay/AA mode, and locate the exit tile, labeled as **'Volkswagen'**. Selecting this tile will bring you in the interface setup menu, NOT the OE system.

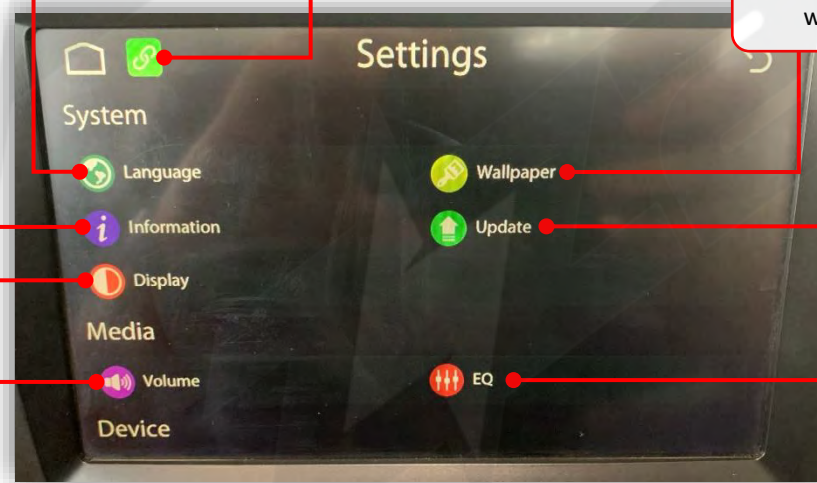
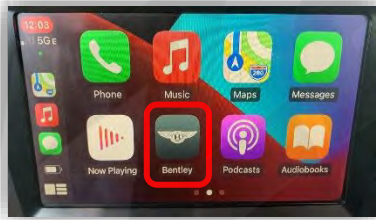

Change language here.

Indicates a Phone is currently linked.

Change (interface) wallpaper.

Interface Version info.

Display settings adjustments.

System updates require access to this menu.

EQ setup adjustments (for AUX mode only)

Volume settings adjustments (alerts, Navigation, etc)

NOT USED in North America

Bluetooth Connection Settings for initially pairing.

NOT USED in North America

Toggle Interface Bluetooth OFF/ON here

Activate FRONT CAM toggle – if a front camera was added, turn this setting ON to view the camera at any time by pressing and holding the CarPlay activation button (NAV) Note: 'FRONTVIEW' must be set OFF for this feature to work.

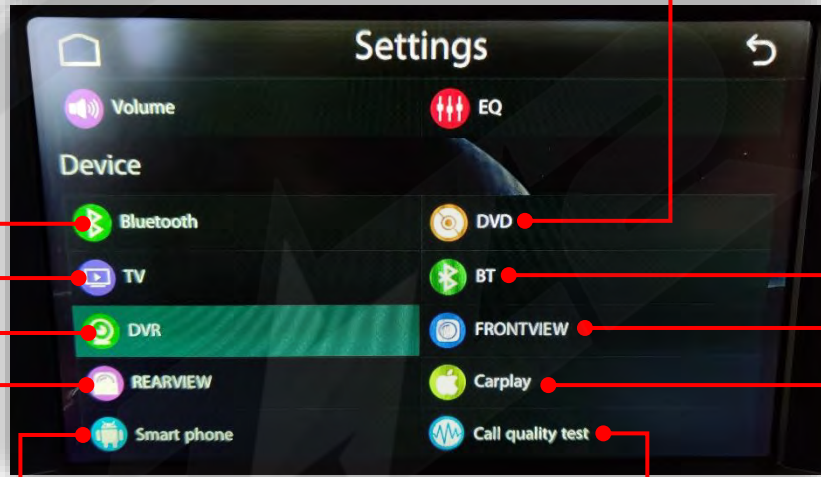

Turns on Front Camera view for showing front camera after leaving reverse gear for ~10 seconds. NOTE: DVR must be set to 'OFF' for this feature to work.

Adjust Rearview guideline settings or turn off rearview camera entirely

Smartphone settings (general) If using Android, 'Android Device' must be set to 'Android Auto' here.

Run this call quality test with all doors closed, engine running, no phone connected for improved MIC performance.

CODE: 1123. Adjusts the vehicle MAKE ICON button – This button exits CarPlay/AA and enters you into the interface menu (this menu)



Question: *I can't hear any audio from the CarPlay/Android Auto system.*

Answer: Your OE system must be resting on AUX mode in order to hear any sound from the kit. This includes during phone calls. NOTE: Some systems AUX input are not labeled 'AUX', it may be labeled 'Media Interface' or there may be an audio conversion to the vehicle's USB input. Check with your installer for more information.

Question: *I'm hearing reports of a lot of echo or delayed echo on audio during a phone call. Why is this happening and how can I eliminate this?*

Answer: This happens because we are using the OEM AUX input for audio, and the AUX path travels through the OEM amplifier, where there is active time-alignment & processing on this audio channel. There are a few ways to fix this problem, and there are Pros & Cons to each choice:

1. Use the OE Bluetooth system to handle all phone calls, and answer all incoming phone calls **from the steering wheel, always. To dial out using this method, you must use SIRI or voice command activation (typically hold control knob down for 4 seconds). Some vehicles, when using the CarPlay/AA control in recent calls, the system will still use the OE Bluetooth to handle phone calls, but not all vehicles will operate this way.** NOTE: This method will sound the best for both parties on the phone call - to use this method, you MUST be paired to the OEM Bluetooth system simultaneously with the ZZPLAY unit. **PROs:** sounds the best, and regardless of what audio source you're currently on, using this method will switch to a 'phone call state' and return you back to the source you were on (FM, AUX, etc) once the call is ended. **CONS:** Your phone must connect to both the ZZPLAY unit and the OE Bluetooth for every drive, and the reliability of these connections happening properly upon every startup will be lower (only about 90% vs 100%).
2. Use the built-in 'AEC Auto Setup', or 'Call Quality Test', or 'Echo Cancellation' tests to adjust MIC settings for the microphone input of the ZZPLAY unit. These tests are found in the ZZPLAY setup menu typically under 'Audio' or somewhere similar. Some vehicles require a level of adjustment which will never be achieved, in these cases use the OE Bluetooth system (see choice 1). **PROs:** If this method works, it is the most reliable way of using the kit. **CONS:** You MUST be on AUX in order to hear the person you're speaking with. IE: if you use FM or SAT, while using the visual from CarPlay (maps, for example) and a phone call comes in, you must switch to AUX mode before you will hear the person when you answer the call. This is very cumbersome which is why we suggest to stay connected to the OE Bluetooth and allow the car to handle the phone calls.

Question: *Sometimes my phone won't connect lately / Sometimes when it connects the screen goes black / Sometimes CarPlay kicks me out back to the interface menu.*

Answer: For iPhone users, you must perform a 'Hard Reset' on the phone in use on average twice a month to clear certain cache and reset the processors (this will not wipe any data). Google search 'Hard Reset iPhone 13' (or whatever version iPhone version you have) and perform that task. After this is done, you will see a difference in speed and reliability (of pairing/connecting).

Question: *Incoming text responses from SIRI are silent on CarPlay. It mutes the audio but I don't hear the read-out.*

Answer: This often happens for 2 reasons: The iPhone needs a hard-reset (see previous question), or the phone is connected to the vehicle's OE Bluetooth for both **phone calls & audio (and the text read-outs are being sent to the vehicle BT source - you're on AUX source)**. You want to be connected to the vehicle for phone calls ONLY - for iPhone the only way to make this distinction is to adjust the phone setup on the OE radio side. Find your phone (name) in the Bluetooth or Phone setup in the OEM radio settings and disconnect as an audio player. NOTE: *not all vehicles have this option, but it seems to happen mostly with cars that do have this option (Lexus, etc).*

Question: *Using Android, I cannot get the phone to reliably connect wirelessly (or at all).*

Answer: Android phones are more finicky and iPhones with their wireless connectivity. Make sure the OS is fully up-to-date. Clear the cache on the Android Auto application. The Android OS must be at least version 11. Some phones (TCL, Motorola) seem to have protocols that don't play nice with every system. If you run into this, use a good USB-C cable for the Android Auto Connection instead.



support@zz-2.com

929-220-1212

Toll free: 877-241-2526

Extension 2: Tech Support

Agreement: End user agrees to use this product in compliance with all State and Federal laws. ZZDOIS LLC dba ZZ-2 is not to be held liable for misuse of its product. If you do not agree, please discontinue use immediately and return product to retailer. This product is intended for off-road use and passenger entertainment only.