

Package Includes

- (1) SiriusXM PowerConnect™ Vehicle Cradle
- (1) SiriusXM 5 Volt Hardwired Power Adapter
- (1) Handlebar Clamp Mount
- (1) Handlebar Strap Mount
- (1) RAM Ball Mount Adapter (25 MM)
- (1) Weatherproof Protective Case
- (1) SiriusXM Magnetic Antenna with Plate
- (1) Auxiliary Cable
- (1) AMPS Plate with Screws

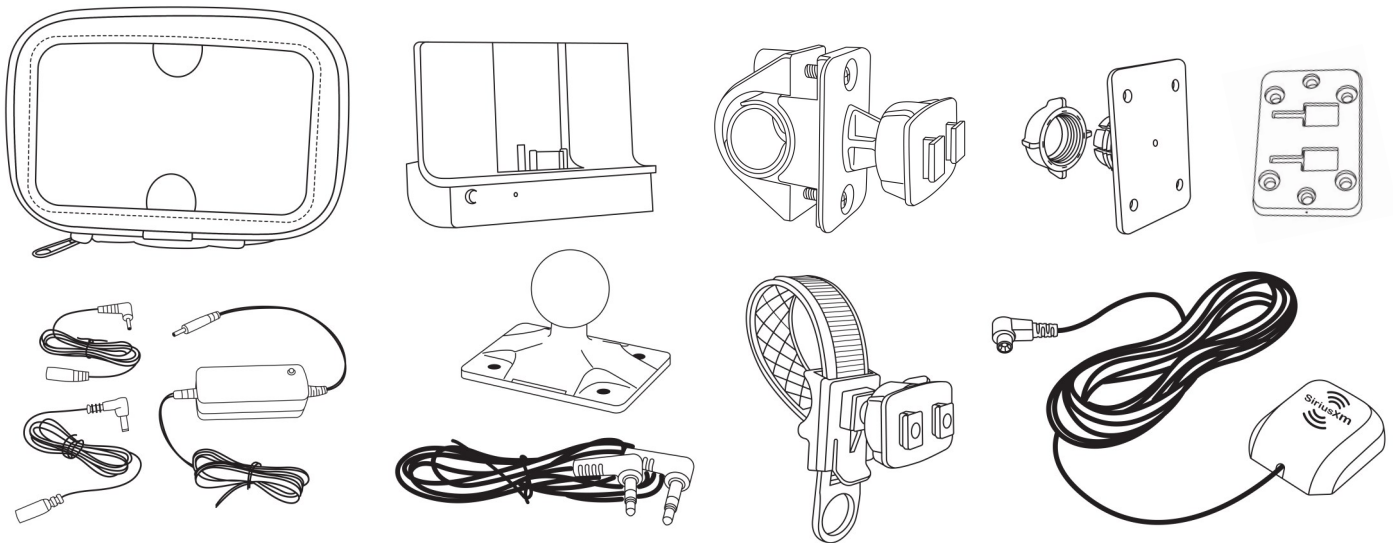

Protective Case Installation Location

Before getting started, it is important to select an installation location for the protective case with receiver and the strap mount antenna. It is also recommended to run the cables from your power source to the dock, before hooking up the wires to ensure the cables will reach the dock inside the protective case.

Step 1 - Install Clamp Mount (or Strap Mount)

After selecting the installation location for the protective case, loosen the two screws on the handlebar clamp mount all the way out and separate it from the back side of the clamp mount. Place the clamp mount on the handlebars, line up the screw holes, and tighten the screws to mount the clamp. Use the supplied rubber strips to increase the grip of the mount.

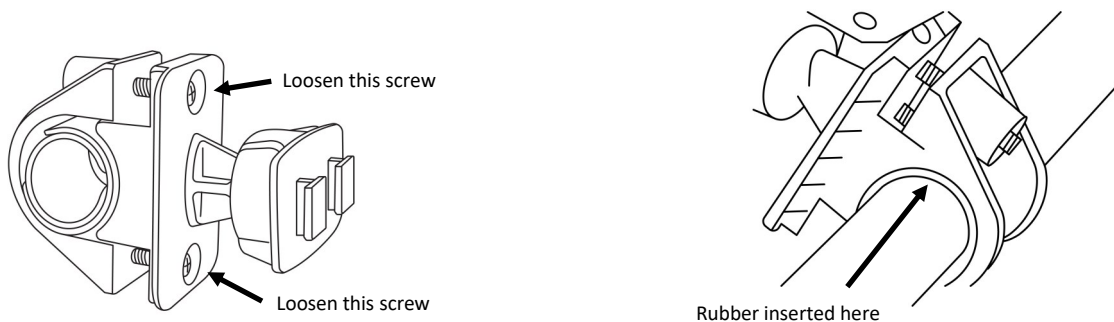

Step 2 - Connect Protective Case to Mount

After the clamp mount is attached to the handlebar, take the protective case and slide it over the dual T-notches on the back of the case with the T-notches on the handlebar clamp mount. Secure the mount by tightening the lock ring on the handlebar clamp (or strap) mount, located just behind the T-notch adapter.

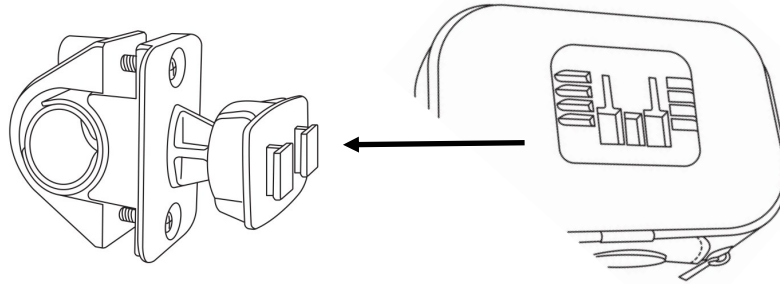

Step 3 - Connect Power

Included in the package is a hardwired power adapter. Find a power source on the motorcycle, either in a fuse box or an auxiliary power source on the motorcycle. The hardwired power adapter comes with two interchangeable cables, one older Sirius and XM receivers and one for newer PowerConnect receivers. For installations with an older 5 volt Sirius or XM receiver (non PowerConnect), use the cable with the smaller connector tip. For installations using the supplied PowerConnect docking cradle, you will use the cable with the larger tip.

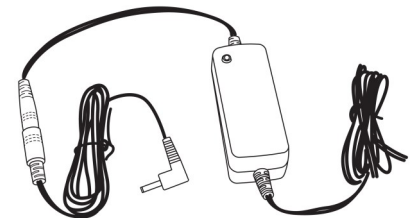
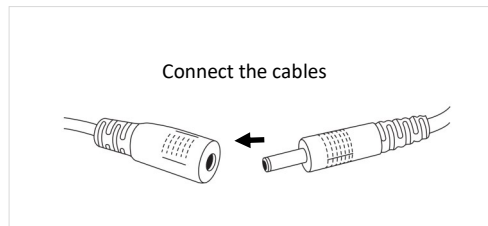
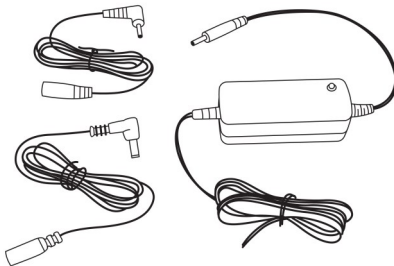

Adapter fully assembled

Step 4 - Connect Audio

Included in the kit is an auxiliary cable for audio. Connect the auxiliary cable to the aux input on the motorcycle sound system, headset, or other audio system. Run the auxiliary cable to the location of the mount and leave the cable loose. We will connect it to the docking cradle in step 6.



Step 5 - Antenna Installation

To receive signal, the antenna must be installed on the motorcycle with maximum clearance and no obstructions from the sky while the motorcycle is moving. Once the antenna location is determined, run wire to the protective case. Be sure to leave a couple of inches of play in the cable to allow for movement of the receiver. The antenna requires a ground plane for optimal reception. A thin metal plate with adhesive backing has been included in the kit to allow the antenna to be placed on any surface. This will allow the magnet inside the antenna to create a ground-plane around the antenna and optimize signal reception.

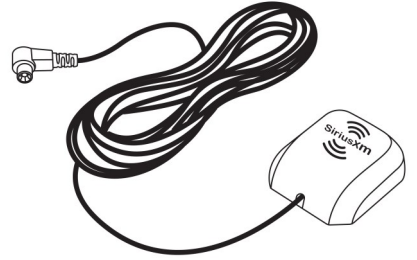

Metal Plate Installation

1. Locate the metal plate in the packaging.
2. Peel the paper covering the sticky side.
3. Place the plate on the roof at least 3 inches from the edge of the surface.

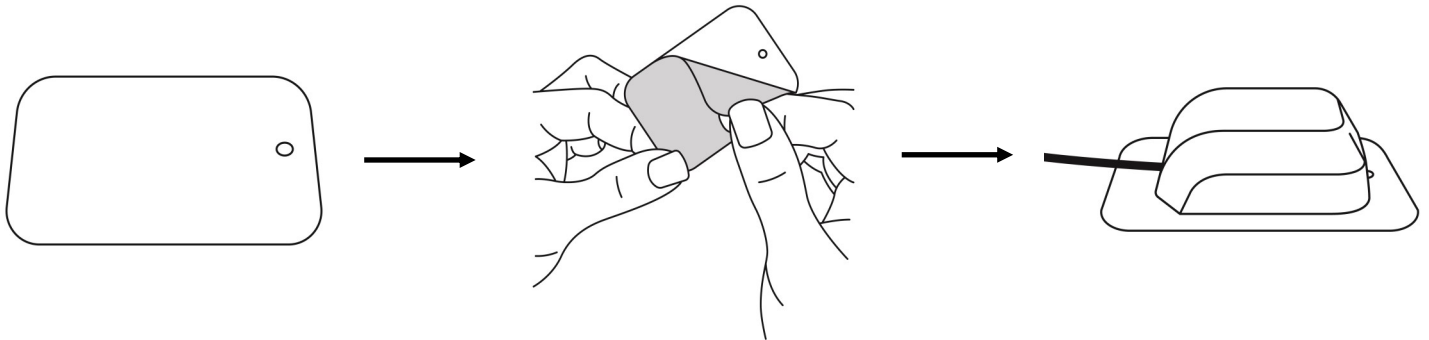

Step 6 - Connecting Docking Cradle

After all cables have been run to the protective case, feed the wires up through the bottom of the case shown in the image on the right. Pull enough cable through to allow for extra play in the wire. If there is extra antenna wire it is recommended to wrap up the excess antenna wire, inside the protective case.

Once the cables have been run through the bottom of the protective case, connect each cable to the corresponding port on the dock. (Some docks may have the connections on the sides and not the back as shown in the figure to the right)

Note: If installing a Bluetooth SiriusXM Dock, only power and antenna are required. The FM port on the dock is not used unless installing the FMDA25 Direct Wire Audio Adapter.

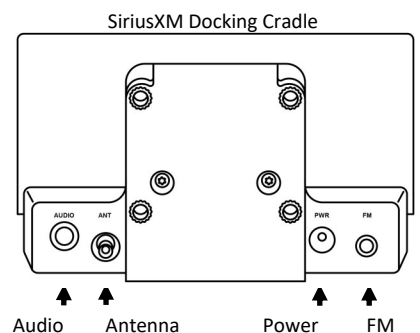
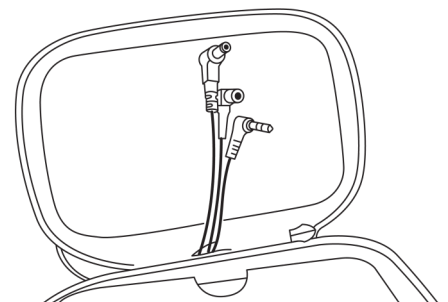

Activate and Subscribe to SiriusXM Radio Programming

Follow these steps to subscribe your SiriusXM receiver. Once you have successfully activated the receiver, you will be able to tune to other channels.

1. Make sure your receiver is turned on, receiving the SiriusXM signal, and tuned to Preview Channel 1 so that you can hear the SiriusXM audio.
2. Make a note of your Radio ID. You can find it by swiping to Settings and tapping About, by tuning to channel 0, on a label on the side bottom of the box, and on the label on the back of the receiver.
3. NOTE! The Radio ID does not use the letters I, O, S, or F.
4. **To subscribe:**
 - **Online:** www.siriusxm.com/activatenow to access or set up an online account, subscribe to the service, and activate your receiver.
 - **Phone:** **Call 1-866-587-4225** - Activation usually takes 10 to 15 minutes after you have completed the subscription process, but may take up to an hour. We recommend that your receiver remains on until subscribed. Once subscribed, the receiver will receive and you can tune to the channels in your subscription plan.

Appendix A - Installing Without the Protective Case

For those who want to install the system without using the protective case and just have the receiver mounted directly to the clamp or strap mount, we have included an AMPS plate. To install the AMPS plate to the mount, unscrew the lock ring on the clamp or strap mount and remove the dual T-notch. Place the AMPS plate on the ball adapter joint and tighten the lock ring to secure the plate to the mount. Next, using the supplied screws, connect the AMPS plate directly to the back of the SiriusXM docking cradle via the four screw holes.

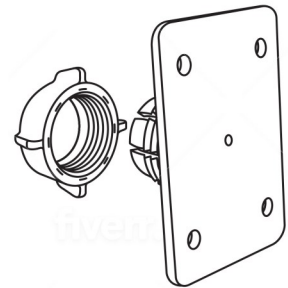

AMPS Plate and Lock Ring

Appendix B - Installing the RAM Adapter Plate to Case

Included in the kit is a 25mm RAM ball adapter plate. This allows the kit to be used with any 25mm RAM mount, either connected to the protective case or directly to the SiriusXM docking cradle. To use the RAM adapter with the protective case, connect the make AMPS plate (shown below) to the back of the RAM adapter plate with the supplied screws. Next, slide the dual T-notch plate onto the back of the case (as shown in the figure below).

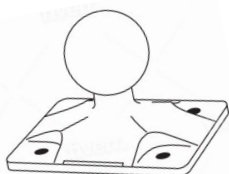

RAM Mount Adapter

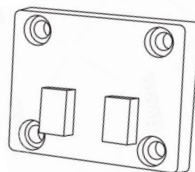

Dual Male AMPS Plate

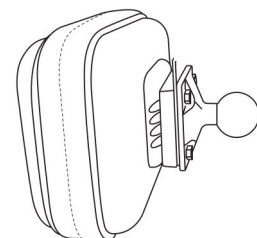

Appendix C - Installing the RAM Adapter Plate to Docking Cradle

For installations using a RAM mount and not the protective case, use the supplied screws and connect the RAM adapter plate to the back of the SiriusXM™ docking cradle via the four screw holes. Once connected, follow the instructions above to complete the connections to install the system.

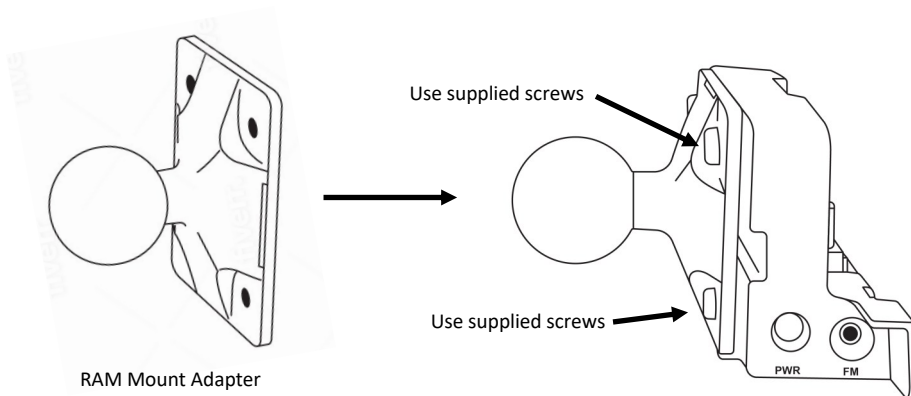

Appendix D - Optional Strap Mount

Included in the kit is an adjustable strap mount for mounting the protective case to square or oversized handlebars. To open the strap, pull up on the release tab and pull the strap back through the mount. To tighten the strap, pull the pull tab at the end of the strap until the strap clicks into place. The dual T notch from the Clamp Mount fits onto the ball on the end of the mount, allow the case to slide over the notches for mounting.

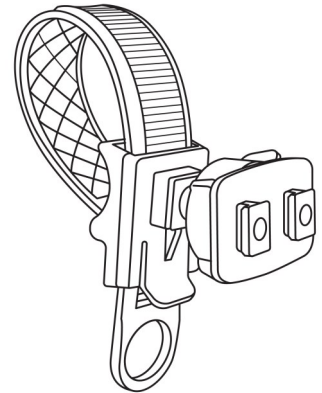

To learn more on how to operate your specific satellite radio receiver, refer to the user guide.

Need a use guide? Scan the QR below to download the user guide for your receiver.

