

Thank you for purchasing the SiriusXM™ Commander Touch Motorcycle Kit! The SiriusXM™ Commander Touch™ has these exciting features to enhance your overall experience:

- Enjoy SiriusXM through your vehicle's in-dash audio system with controls on the color touchscreen display
- Compact touchscreen controller mounts directly to the motorcycle mount for a fully integrated full-color display with album art, artist name, song title, channel logos and program information
- Pause, Rewind and Replay live Satellite Radio
- Automatically start songs from the beginning on your favorite channels with TuneStart™
- Use TuneMix™ to hear a mix of songs from your favorite channels
- Keep moving with the most current updates using Traffic & Weather Now™
- Connects to any radio with either an AUX input or FM connection
- Professional installation recommended for best results
- Can be updated by a USB flash drive (not included) to add new features and capabilities as they become available
- Works on the XM Network

#### Package Includes:

- (1) Commander Touch™ Controller
- (1) SiriusXM™ Radio Tuner with Multi Pin Cable
- (1) SiriusXM™ Magnetic Antenna
- (1) FMDA25 Direct Wire Adapter
- (1) Rubber Wrap for Controller
- (1) Strap Mount, (1) RAM Mount, (1) Handlebar Mount
- (1) Female AMPS Plate (1) Male AMPS Plate (1) Lock Ring
- (1) Metal L Bracket
- (1) AUX Cable

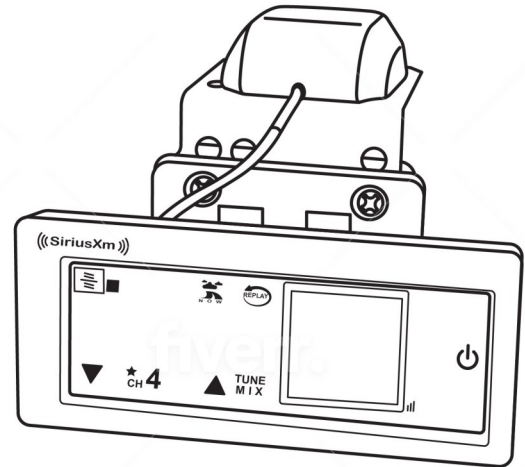

#### Additional Resources

Scan the QR codes below for additional installation documentation, support articles and user manuals.



Online Installation Guide



Commander Touch™  
User Guide



Commander Touch™  
Update Instructions



Need help?  
Scan the QR code for  
SMS/Text support

## Prepping the Rubber Case

The rubber case is used to keep out dust and water from the edges of the Commander Touch™ controller. On the back of the case are four holes used to mark the location of the four screw holes on the back of the controller. It is recommended to use a small screw driver to push through the case inside the circles and make a small hole. This will allow the screws to pass through the case when mounting the case. This step can also be done after the case has been installed on the Commander Touch™ controller.

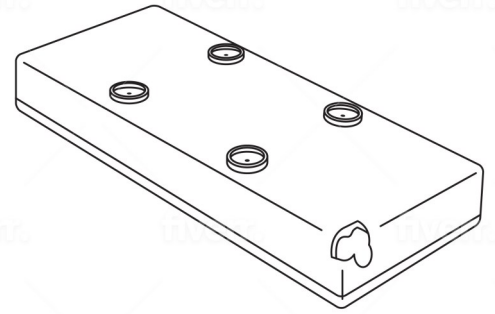

## Install the Rubber Case Around Controller

Follow the steps below to install the case around the controller.

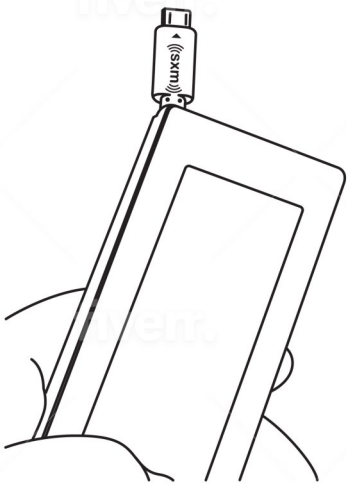

Insert the cable into the hole in the bottom left of the case from inside out.

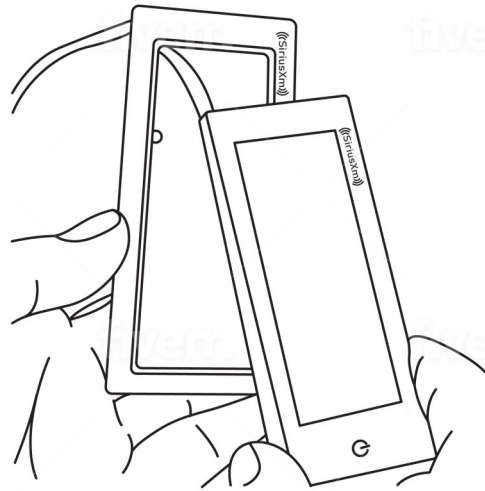

Pull the cable all the way through the hole and push the controller flush to the end of the case.

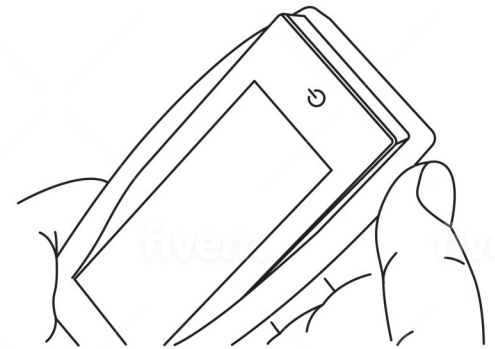

Pull the rubber case around the controller.

## Attaching the Dual Mounting Plate

Locate the Dual Male AMPS Plate from the bag of parts along with the screws. Use a screw driver or other tool to push a hole through the back of the case in the designated circles marked on the back of the case. Next, take the Dual Male AMPS Plate and screw it to the back of the rubber case making sure the screw goes all the way through the case to the screw hole. Do not overtighten the screws.

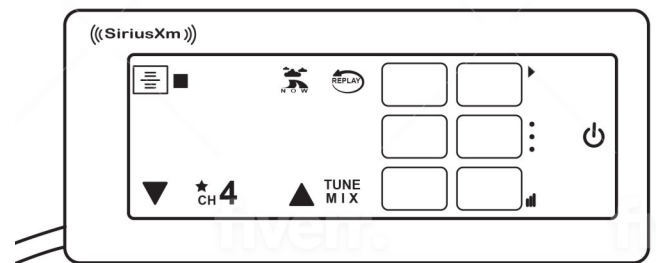
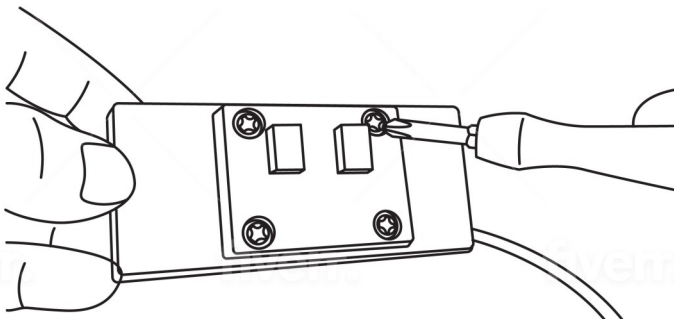

The case should be flush around the controller as shown above.

# Mount Assembly Options

Before getting started, it is recommended to locate an installation spot on your motorcycle that will allow you to see the screen of the receiver and operate the unit safely while driving. There are three different mounting options included with this kit. Select the option that best fits your motorcycle and installation requirements.

## BACK PLATE ASSEMBLY

1) Locate the bag containing the parts shown below.

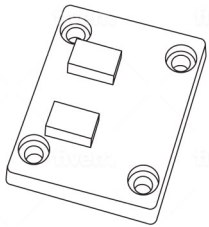

Dual Male AMPS Plate

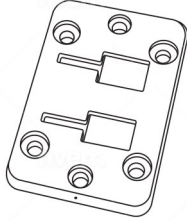

Dual Female AMPS Plate

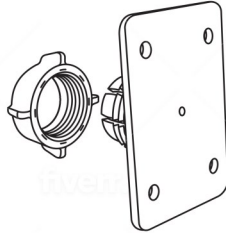

AMPS Socket Plate / Lock Ring

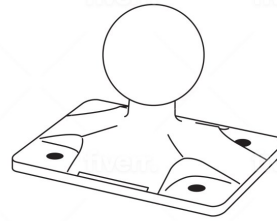

RAM Mount Adapter

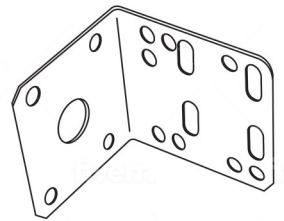

Metal L-bracket

2) Take the **AMPS Socket Plate** and place it on one side of the **L-bracket** as shown below. Next place the **Dual Female AMPS Plate** on the opposite side as the **AMPS Socket Plate** and line up the screw holes. Please note the positioning of the **Dual Female AMPS Plate** with the notches at the top. The dual notches must be positioned at the top in order to properly seat into the back of the case. Use the supplied screws and nuts to secure the plates to the **L-bracket**. **Note:** The mount can be assembled with the top plate of the **L-bracket** facing forward or backwards to fit your installation needs.

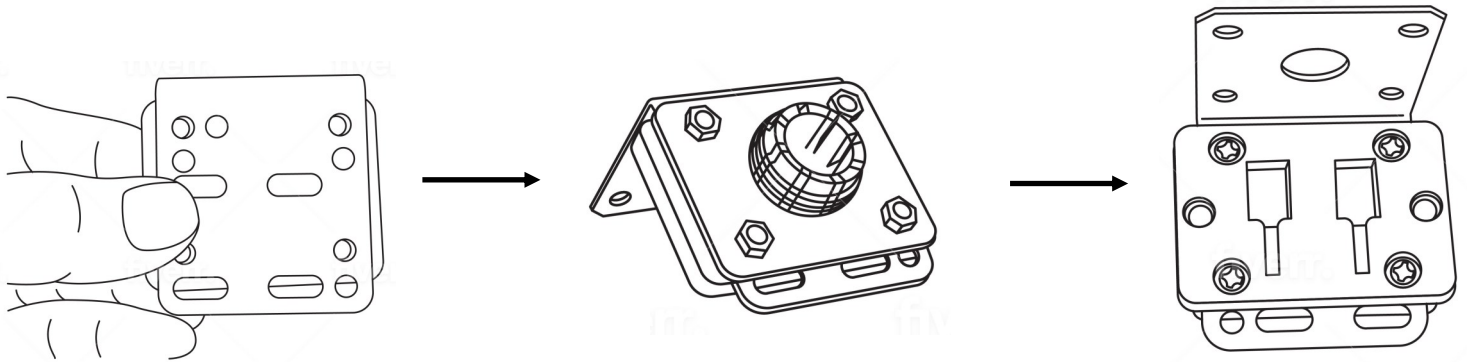

3) Locate the **Handlebar Clamp Mount** from the bag of parts along with the **Lock Ring**. Place the **Lock Ring** over the ball joint on the mount with the large end facing away from the **Handlebar Clamp Mount**. Next, insert the ball joint into the **Female AMPS Socket Plate** and tighten the **Lock Ring**. Repeat this process if using the **Adjustable Strap Mount** which is also located in the bag of parts.

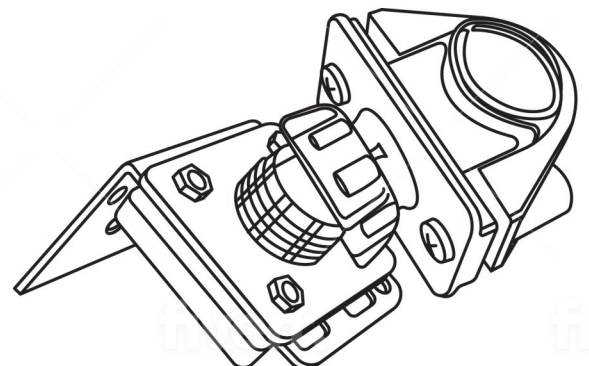

#### 4) RAM Mount Assembly (optional)

If you have a RAM mount on your motorcycle, you can use the supplied **RAM Mount Adapter Plate** to install the kit onto a RAM mount. Locate the **RAM Mount Adapter Plate** in the bag with the parts shown below. Screw the **RAM Mount Adapter Plate** to the L-bracket with the **Dual Female AMPS Plate** on one side and the **RAM Mount Adapter Plate** on the other side. The **RAM Adapter Plate** ball joint fits a 25mm RAM Mount receptor.

**Note:** the L-bracket can be mounted with the upper plate facing either direction.

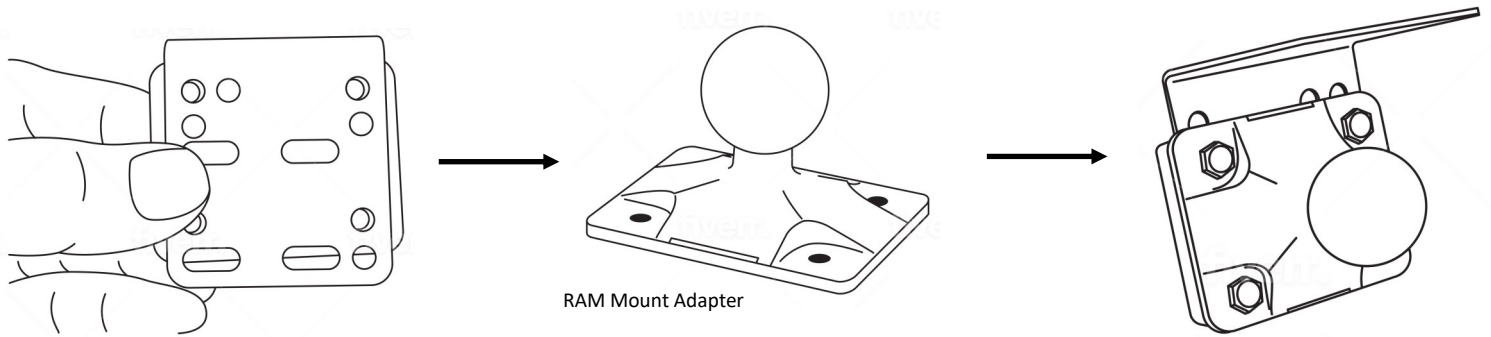

#### 5) Mounting the SiriusXM Antenna

Supplied in the kit is a **SiriusXM Radio Magnetic Antenna** with an 8FT cable. Run the antenna wire along with the controller wire to the location of the **SiriusXM Tuner** and connect the antenna to the antenna port on the tuner. Next, place the antenna on the **Metal L-bracket**. For maximum reception do not cover the antenna.

#### Attached Display Controller / Finished Mount Assemblies

To attach the controller line up the T-notches on the controller with T-notches on the mounting plate and slide the controller down to lock the T-notches together. Below are examples of the three assembly options.

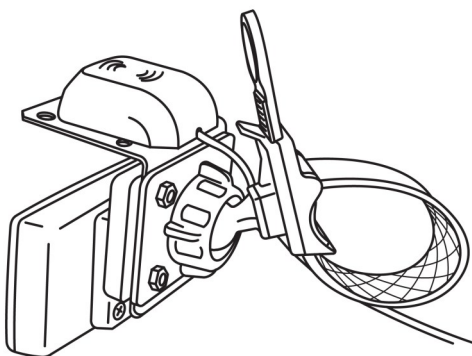

Strap Mount Assembly

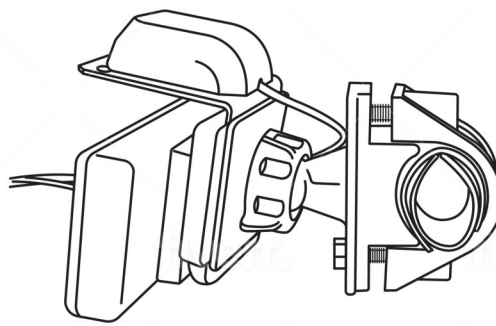

Clamp Mount Assembly

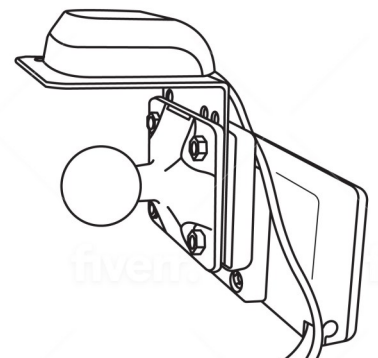

RAM Mount Assembly

# Installation Wiring Diagram

Refer to the wiring diagram below and install the Power Wiring Harness, and the AUX In or FM Input audio connection.

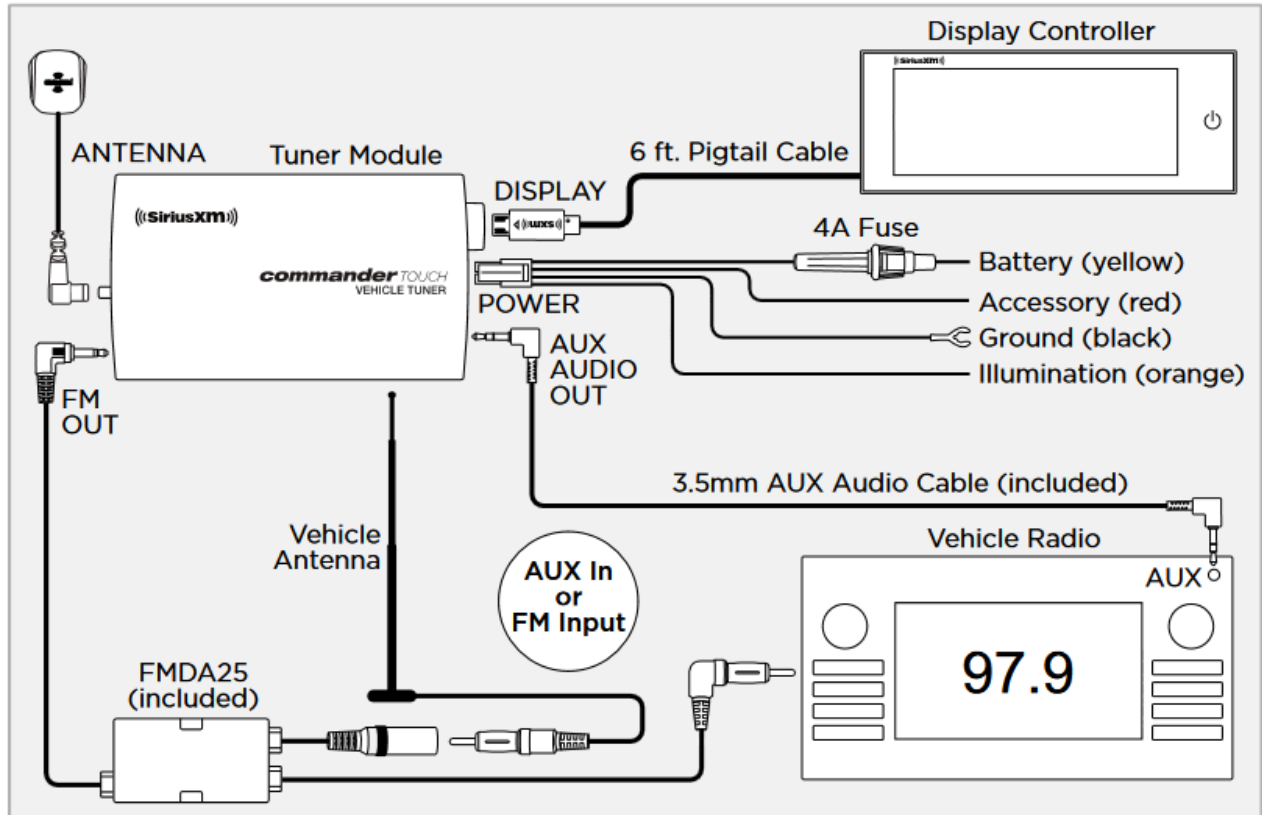

## Commander Touch Connections

### Display Controller Connections

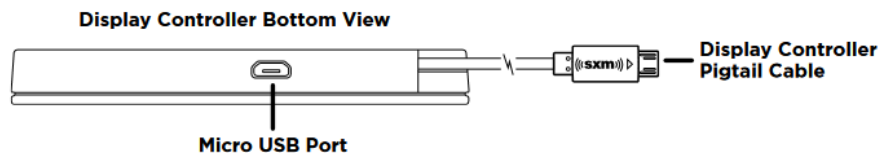

**Display Controller Pigtail Cable:** Connects to the DISP connection on the Tuner Module.

**Micro USB Port:** SiriusXM may occasionally release a system software update for Commander Touch. The update can be installed by connecting a USB Flash Drive with the software update to the micro USB port located at the bottom of the Display Controller. A micro USB Flash Drive or a USB type A Flash Drive with a USB type A to Micro USB Adapter is required (not included)

### Tuner Module Connections

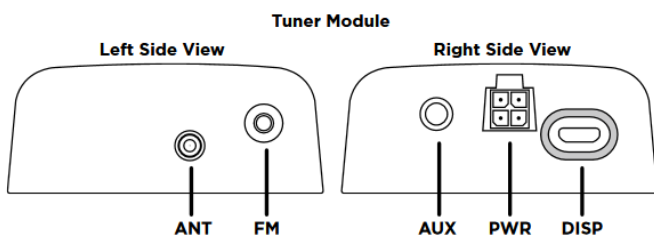

- ANT** (Antenna): Connection for the Magnetic Mount Antenna.
- FM**: Connection for the FM DA25 FM Direct Adapter.
- AUX** (Auxiliary audio output): Connection for the AUX Audio Cable.
- PWR** (Power): Connection for the Wiring Harness.
- DISP** (Display): Connection for the Display Controller pigtail cable.



## Install the Power Wiring Harness

The wiring harness has 4 wires: **BAT** (battery, yellow); **ACC** (accessory, red); **ILL** (illumination, orange); **GND** (ground, black). When installing the harness, keep the fuse holder which is connected to the **BAT** wire in a location that is accessible in case the fuse ever needs to be replaced.

1. Plug the Wiring Harness connector to the **PWR** connector on the Tuner Module.

2. Route and connect the **BAT** yellow wire to a constant 12 volt source, a source which is always on even when the motorcycle is turned off.

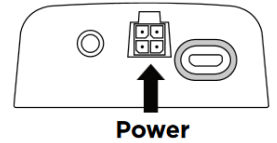

3. Route and connect the **ACC** red wire to a switched 12 volt source, a source which provides power only when the vehicle is turned on . This should be tied to the motorcycle's accessory wire.

4. Route and connect the **ILL** orange wire to a 12 volt source which is on **ONLY** when the motorcycle's exterior parking or headlights are turned on. **DO NOT** connect to the Dimmer line as the voltage fluctuates. Connection to the **ILL** wire is optional, but it will allow you to take advantage of the independent Auto Day/Night brightness setting option.

5. Route and connect the **GND** black wire to the motorcycle ground connection, usually the motorcycle's chassis.

## Install Audio Connection

There are two ways to connect the audio for the Commander Touch: using the AUX Audio Cable, or using the FMDA25 FM Direct Adapter. Both audio connection solutions are included with the Commander Touch and both audio solutions can be active at the same time.

- **AUX Audio Cable: Best:** If your motorcycle's radio has a auxiliary input jack, this is the easiest way to connect the audio and provides excellent audio .
- **FMDA25 FM Direct Adapter: Good:** The FMDA25 FM Direct Adapter directly connects the FM signal from the Commander Touch to the motorcycle's radio, reducing any interference which might be present from FM radio stations. When the Commander Touch is turned off, the motorcycle's FM antenna is automatically connected back to the motorcycle's radio. The FMDA25 FM Direct Adapter connects directly in-line with the motorcycle's existing AM/FM antenna input. Follow the instructions below for the audio connection you have selected.

## Connecting the Audio Using the AUX Audio Cable

The auxiliary input jack may be located on the face plate of the motorcycle's radio, on the back of the radio, or anywhere on the front dash panel.

1. Connect the AUX Audio Cable to the auxiliary input jack of the motorcycle radio.

2. Connect the other end of the AUX Audio Cable to the AUX Connector on the Tuner Module.

3. Turn the motorcycle's radio on, and set it to the AUX In source.

4. Press the Power button on the Commander Touch Display Controller. After the start up sequence you should hear SiriusXM Preview Channel 1 through your motorcycle's radio.

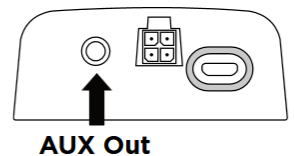

5. The audio level can be adjusted by swiping to the Settings page, tap Audio Options, then tap **Audio Output Level** and adjust the audio output level.

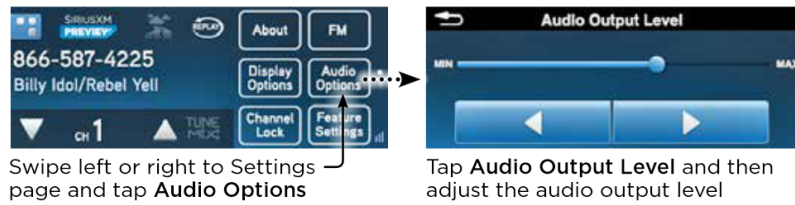

### Connecting the Audio Using the FMDA25 FM Direct Adapter

Certain models of motorcycles will require adapters to connect the AM/FM antenna to the FMDA25 and to connect the FMDA25 to the motorcycle's radio. These adapters are sold separately at auto parts stores or by professional installers.

1. Remove the motorcycle's radio from the dash and disconnect the AM/FM antenna cable from the rear of the motorcycle's radio.
2. Plug the **FM Antenna Connector (A)** from the FMDA25 into the same connector on the vehicle's radio. (Additional antenna adapter may be required.)

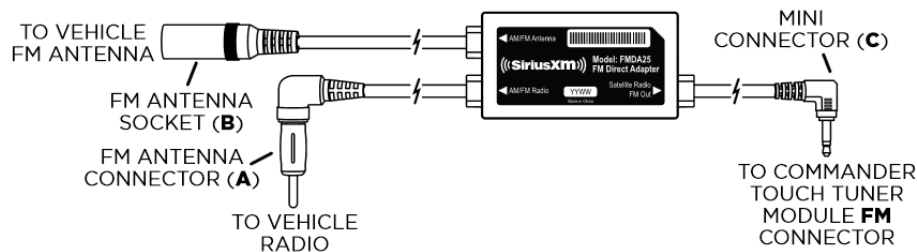

3. Plug the motorcycle's AM/FM antenna cable into the female **FM Antenna Socket (B)** of the FMDA25. (Additional antenna adapter may be required.)
4. Plug the **Mini Connector (C)** of the FMDA25 into the **FM** connection of the Tuner Module.
5. If needed reinstall the radio.
6. The FMDA25 should be secured in a hidden location on the bike.
7. Turn the vehicle's radio on and tune it to FM channel 97.9.

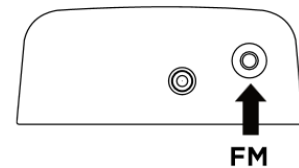

8. Press the Power button on the Commander Touch Display Controller. After the start up sequence, you should hear SiriusXM Preview Channel 1 through your vehicle's radio.

9. The audio level can be adjusted by swiping to the **Settings** page, tap **Audio Options**, then tap **Audio Output Level** and adjust the audio output level.

**NOTE!** The Audio Output Level adjusts both the AUX audio output level as well as the FMDA audio output level. Use caution when making the adjustments. For FM, it is recommended to adjust the level to MAX.

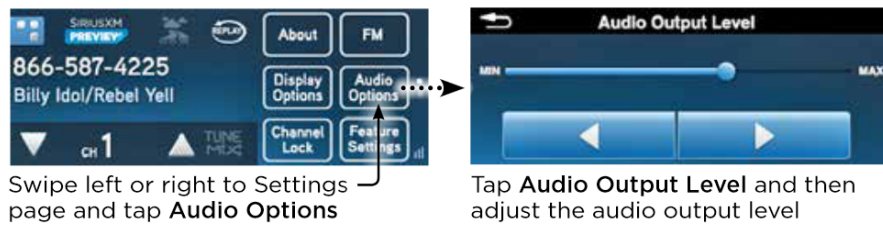

10. If channel 97.9 has static or interference, other FM channels can be selected by swiping to the **Settings** page, tap **FM** and adjust the FM channel. Tap a **+** button to save it as a preset. Set the vehicle's radio to the same FM channel.

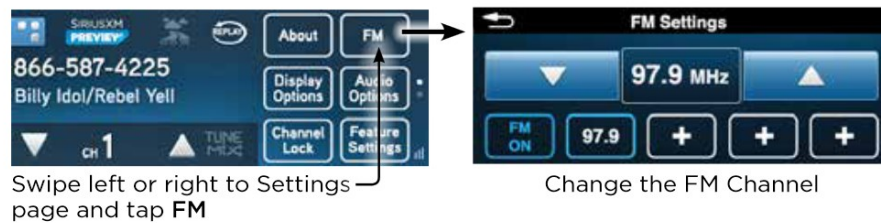

The installation is now complete you are ready to activate the CommanderTouch.

### Subscribe to SiriusXM Radio Programming

Follow these steps to subscribe your Commander Touch. Once you have successfully activated the Commander Touch, you will be able to tune to other channels.

1. Make sure your Commander Touch is turned on, receiving the SiriusXM signal, and tuned to Preview Channel 1 so that you can hear the SiriusXM audio.
2. Make a note of your Radio ID. You can find it by swiping to Settings and tapping About, by tuning to channel 0, on a label on the bottom of the gift box, and on the label on the back of the Commander Touch Tuner Module .
3. **NOTE!** The Radio ID does not use the letters I, O, S, or F .
4. **To subscribe:**
  - **Online:** [www.siriusxm.com/activatenow](http://www.siriusxm.com/activatenow) to access or set up an online account, subscribe to the service, and activate your Commander Touch
  - **Phone:** Call 1-866-587-4225 (If calling to activate, be sure to mention "**Never Miss A Beat**"). Activation usually takes 10 to 15 minutes after you have completed the subscription process, but may take up to an hour. We recommend that your Commander Touch remain on until subscribed. Once subscribed, the Commander Touch will receive, and you can tune to, the channels in your subscription plan.