

1. Organize Parts



- A – Headrest
- B – Mounting bracket
- C – Bracket support (2)
- D – Bracket extension (2)
- E – Locking pins (2)
- F – Corkscrew fastener (3)
- G – Bracket assembly fastener (2)

2. Bracket Assembly



Insert the bracket extensions (D) into the mounting bracket (B). Ensure the pin holes of on both the bracket extensions and the mounting bracket are face-up. Bracket extension pin holes should be on in the lower position. Mounting bracket pin holes in the upper position (center hole on top).



Next, insert the two Bracket Supports bars (C) into the backrest assembly. Align the pin holes of the support bar with the backrest assembly. Insert the Locking Pins (E) to fasten the backrest support bars to the backrest assembly. Do this on both sides.

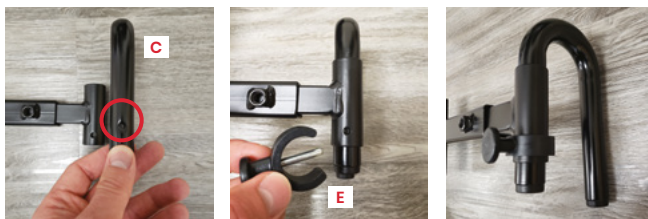

3. Mounting the Backrest Assembly

Loosely attach the bracket assembly fasteners (G) to the top of the Travel Buggy backrest bars on both sides using the Allen key provided with your power chair.

Slide the completed back rest assembly into the bracket assembly fasteners (G). Ensure the assembly is mounted level and continue to tighten bolts while modifying the backrest assembly position.

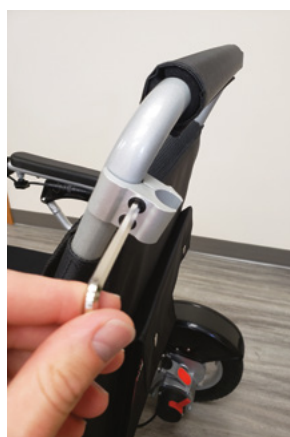
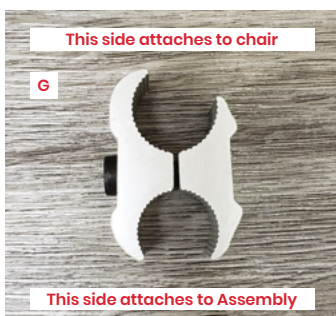

4. Attach the Headrest



Center the bracket assembly such that the center post is aligned to the center of the chair. Fasten the left and right sides in place with the Corkscrew Fasteners (F)

Insert the Headrest piece (A) into the center post of the backrest assembly. Fasten with remaining Corkscrew (F)

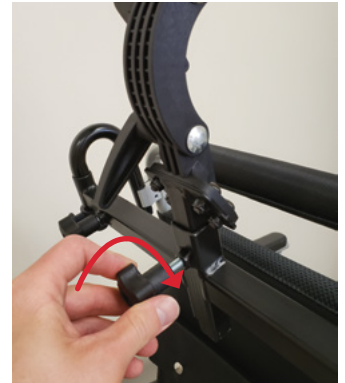

5. Adjusting Headrest Position

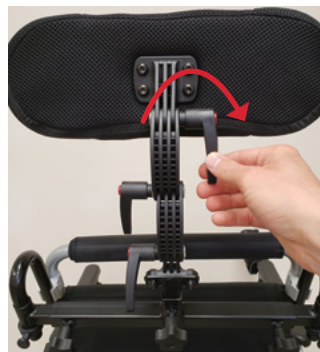
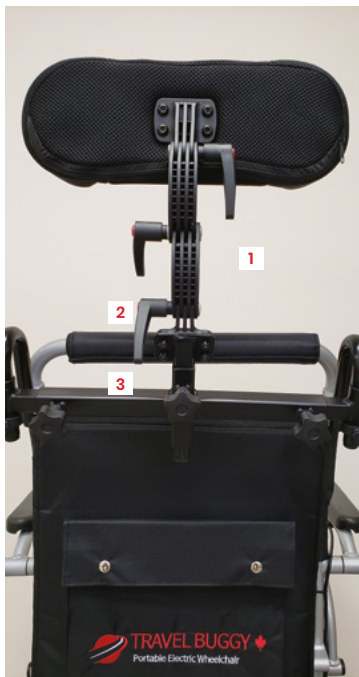

To adjust the headrest position loosen the required handle, reposition the headrest, and then tighten the handle again. You can do this with each handle for the optimal position.



There are 3 adjustment handles located on the headrest as indicated below.

To reposition the handle without tightening it, pull the handle out, rotate accordingly, then release it. Note – this may be required in order to fasten the handle into position when headrest cushion interferes.