

Under Counter Refrigerator



Features

- CFC free refrigerant and foam insulation
- Electronic thermostat and digital LED temperature display for accurate control and easy reading
- Self-Closing Swing Door
- Magnetic gasket can be replaced without any tools
- External: Stainless Steel framework construction
- Internal: 304 Stainless Steel
- Auto defrosting and auto evaporation to prevent condensation
- The coated copper tube, with a robust 0.7mm thickness, ensures durability.
- Crafted from a single bent tube, it has only two welding joints, reducing the risk of leaks
- Condensator sits inside the condensation pan efficiently evaporates excess water
- Adjustable, heavy-duty epoxy coated wire shelves
- Easy to mount 4" casters (front casters with brakes) are standard with all units
- Electrical: 115/60/1 with NEMA 5-15P plug, 10ft cord

Temperature

- Interior temperature range: 1°C to 4°C (33°F to 40°F)
- Ambient temperature upto 45°C (113°F)

Warranty

- 3 years parts and labour
- 5 years compressor warranty

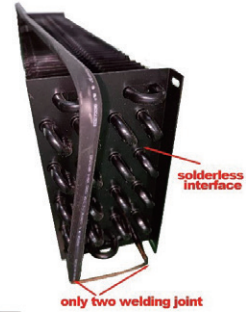

CUC27 / CUC29

CUC36

CUC48 / CUC60

CUC72

Specifications

Model	Door	Ext. Dimensions W x D x H (in)	Int., Dimensions W x D x H (in)	Shelves	V/Hz/Ph	AMPS	HP	Storage Capacity(cu./ft)	NEMA PLUG	Ship Weight(lbs)	Ship Data W x D x H (in)
CUC27	1	27 3/4 x 29 7/8 x 35 5/8	24 x 24 x 24 3/8	2	115/60/1	3	1/3	6.5	5-15P	210	32 1/8 x 33 3/8 x 39
CUC29	1	29 x 29 7/8 x 35 5/8	25 1/8 x 24 x 24 3/8	2	115/60/1	3	1/3	7	5-15P	214	33 3/8 x 33 3/8 x 39
CUC36	2	36 1/4 x 29 7/8 x 35 5/8	32 1/2 x 24 x 24 3/8	2	115/60/1	3	2/5	9	5-15P	225	39 1/2 x 33 3/8 x 39
CUC48	2	48 1/4 x 29 7/8 x 35 5/8	42 7/8 x 24 x 24 3/8	2	115/60/1	4	1/2	12	5-15P	284	51 1/2 x 33 3/8 x 39
CUC60	2	61 1/8 x 29 7/8 x 35 5/8	55 7/8 x 24 x 24 3/8	2	115/60/1	4	1/2	15	5-15P	335	64 1/2 x 33 3/8 x 39
CUC72	3	71 3/4 x 29 7/8 x 35 5/8	66 3/8 x 24 x 24 3/8	2	115/60/1	4.5	3/5	18	5-15P	397	75 x 33 3/8 x 39



If the data and structure update, without notice, subject to material object



Under Counter Refrigerator



CUC27

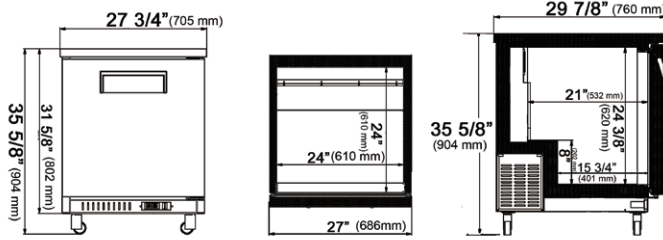

CUC29

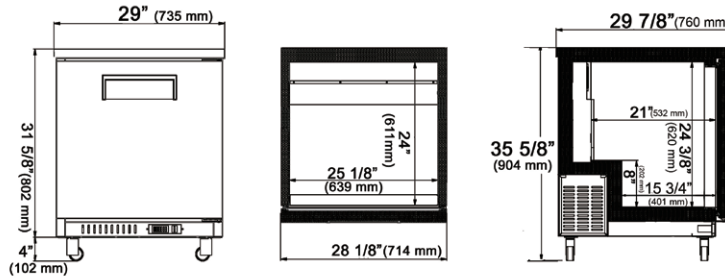

CUC36

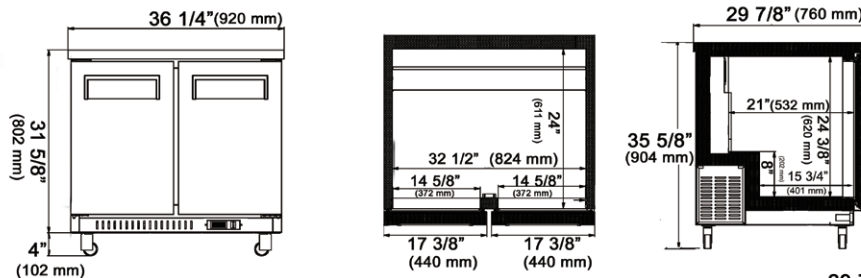

CUC48

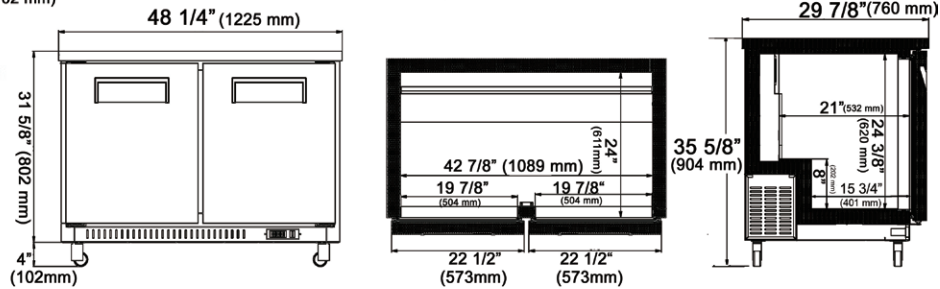

CUC60

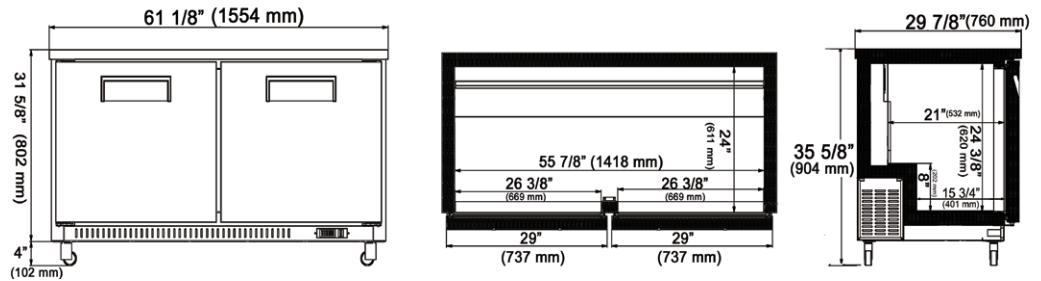

CUC72

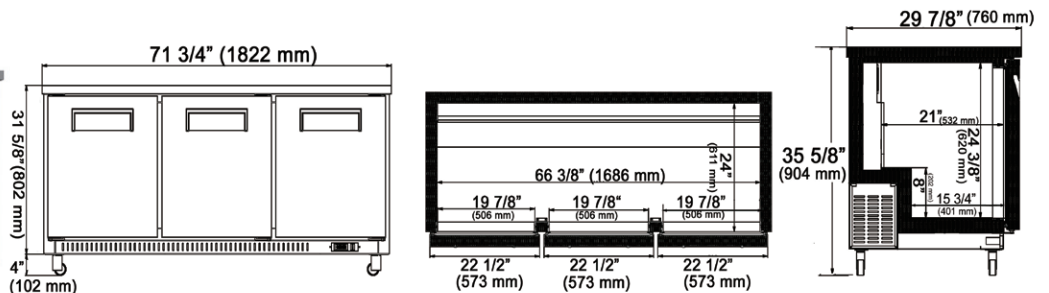

45°C / 113°F
 AMBIENT
 TEMPERATURE



NEMA 5-15P



If the data and structure update, without notice, subject to material object



WARRANTY