

Under Counter Freezer

With Side Mounted Compressor & Drawer



Features

- CFC free refrigerant and foam insulation.
- Equipped with an electronic thermostat and digital LED temperature display for precise control and convenient reading.
- Features a self-closing swing door for added convenience.
- The magnetic gasket can be replaced without the need for any tools.
- External construction comprises stainless steel framework.
- Internally constructed with 304 stainless steel.
- Incorporates auto defrosting and auto evaporation mechanisms to prevent condensation.
- The coated copper tube, boasting a sturdy 0.7mm thickness, ensures durability.
- Crafted from a single bent tube, minimizing the risk of leaks with only two welding joints.
- The condenser is efficiently positioned inside the condensation pan to facilitate the evaporation of excess water.
- Adjustable and heavy-duty epoxy-coated wire shelves for flexible storage options.
- Comes with easy-to-mount 4" casters (front casters equipped with brakes), standard with all units.
- Electrical specifications: 115/60/1 with a NEMA 5-15P plug and a 10ft cord.



Temperature

- Interior temperature range: -17°C to -23°C (0°F to -10°F)
- Ambient temperature upto 45°C (113°F)

Warranty

- 3 years parts and labour
- 5 years compressor warranty



CUSC-84F-2D
CUSC-96F-2D



CUSC-84F-4D
CUSC-96F-4D



CUSC-48F-2D



CUSC-60F-2D
CUSC-72F-2D



CUSC-60F-4D
CUSC-72F-4D



CUSC-84F-6D
CUSC-96F-6D

Specifications

Model	Doors & Drawers	Ext. Dimensions W x D x H (in)	Shelves	V/Hz/Ph	AMPS	Power	Storage Capacity(cu./ft)	NEMA PLUG	Ship Weight(lbs)	Ship Data W x D x H (in)
CUSC-48F-2D	0&2	48 x 31 1/2 x 35 1/2	2	115/60/1	4	380W/0.51 HP	9.5	5-15P	320	51 3/8 x 35 1/4 x 39 1/4
CUSC-60F-2D	1 &2	60 x 31 1/2 x 35 1/2	2	115/60/1	4.5	450W/0.61 HP	14.2	5-15P	370	63 5/8 x 35 1/4 x 39 1/4
CUSC-60F-4D	0&4	60 x 31 1/2 x 35 1/2	2	115/60/1	4.5	450W/0.61 HP	14.2	5-15P	410	63 5/8 x 35 1/4 x 39 1/4
CUSC-72F-2D	1 &2	72 x 31 1/2 x 35 1/2	2	115/60/1	5	500W/0.67 HP	19.1	5-15P	445	76 5/8 x 35 1/4 x 39 1/4
CUSC-72F-4D	0&4	72 x 31 1/2 x 35 1/2	2	115/60/1	5	500W/0.67 HP	19.1	5-15P	480	76 5/8 x 35 1/4 x 39 1/4
CUSC-84F-2D	2&2	84 x 31 1/2 x 35 1/2	2	115/60/1	5	600W/0.81 HP	23.4	5-15P	499	88 5/8 x 35 1/4 x 39 1/4
CUSC-84F-4D	1 &4	84 x 31 1/2 x 35 1/2	2	115/60/1	5	600W/0.81 HP	23.4	5-15P	531	88 5/8 x 35 1/4 x 39 1/4
CUSC-84F-6D	0&6	84 x 31 1/2 x 35 1/2	2	115/60/1	5	600W/0.81 HP	23.4	5-15P	564	88 5/8 x 35 1/4 x 39 1/4
CUSC-96F-2D	2&2	96 x 31 1/2 x 35 1/2	2	115/60/1	5	600W/0.81 HP	27.7	5-15P	533	99 5/8 x 35 1/4 x 39 1/4
CUSC-96F-4D	1 &4	96 x 31 1/2 x 35 1/2	2	115/60/1	5	600W/0.81 HP	27.7	5-15P	567	99 5/8 x 35 1/4 x 39 1/4
CUSC-96F-6D	0&6	96 x 31 1/2 x 35 1/2	2	115/60/1	5	600W/0.81 HP	27.7	5-15P	601	99 5/8 x 35 1/4 x 39 1/4

If the data and structure update, without notice, subject to material object.

Under Counter Freezer

With Side Mounted Compressor & Drawer

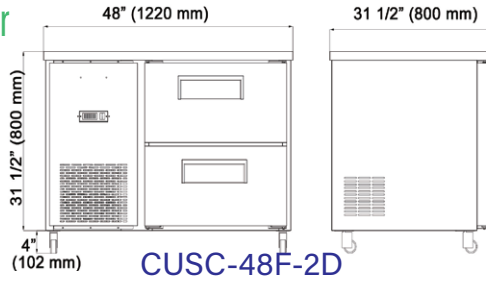

CUSC-48F-2D

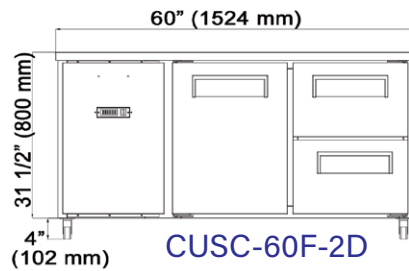

CUSC-60F-2D

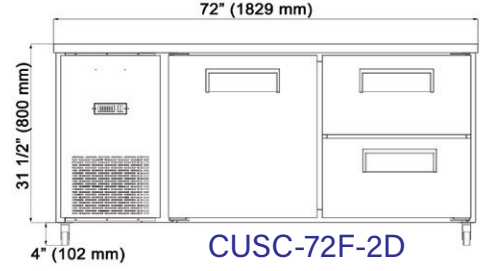

CUSC-72F-2D

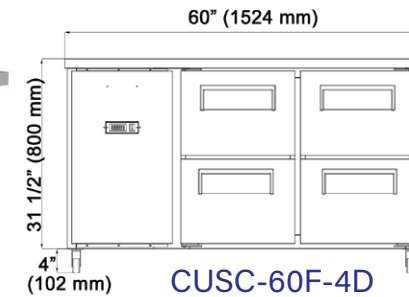

CUSC-60F-4D

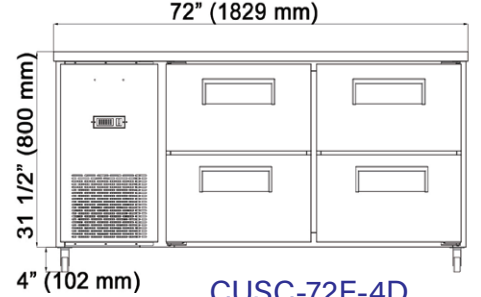

CUSC-72F-4D

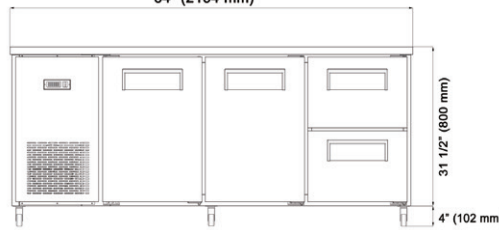

CUSC-84F-2D

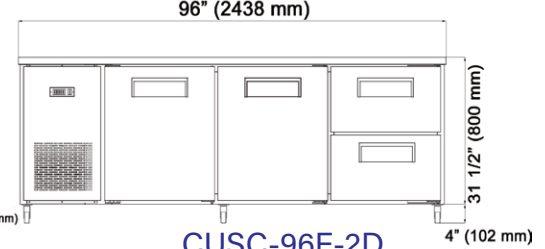

CUSC-96F-2D

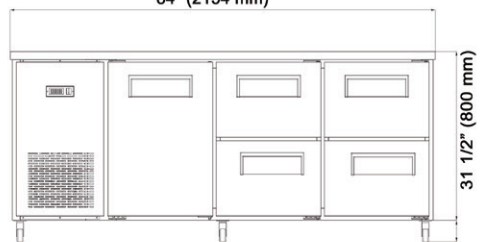

CUSC-84F-4D

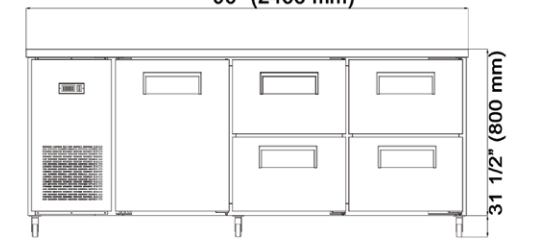

CUSC-96F-4D

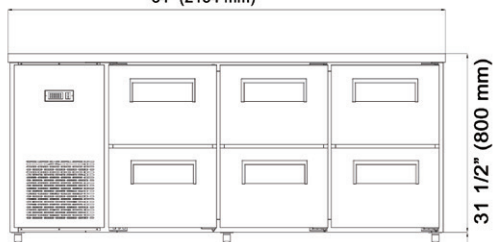

CUSC-84F-6D

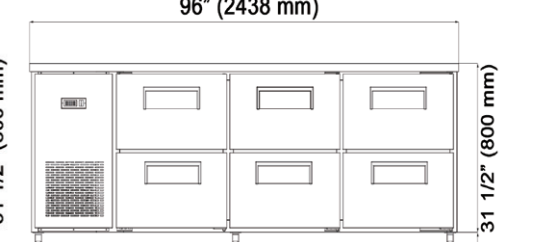

CUSC-96F-6D



If the data and structure update, without notice, subject to material object.