

# Workstation Refrigerator

## Features

- CFC free refrigerant and foam insulation.
- Equipped with an electronic thermostat and digital LED temperature display for precise control and convenient reading.
- Features a self-closing swing door for added convenience.
- The magnetic gasket can be replaced without the need for any tools.
- External construction comprises stainless steel framework.
- Internally constructed with 304 stainless steel.
- Incorporates auto defrosting and auto evaporation mechanisms to prevent condensation.
- The coated copper tube, boasting a sturdy 0.7mm thickness, ensures durability.
- Crafted from a single bent tube, minimizing the risk of leaks with only two welding joints.
- The condenser is efficiently positioned inside the condensation pan to facilitate the evaporation of excess water.
- Adjustable and heavy-duty epoxy-coated wire shelves for flexible storage options.
- Includes 1/6 size polycarbonate GN pans.
- Comes with easy-to-mount 4" casters (front casters equipped with brakes), standard with all units.
- Electrical specifications: 115/60/1 with a NEMA 5-15P plug and a 10ft cord.

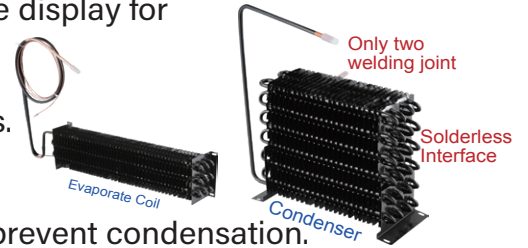

## Temperature

- Interior temperature range: 1°C to 4°C ( 33°F to 40°F)

## Warranty

- 3 years parts and labour
- 5 years compressor warranty

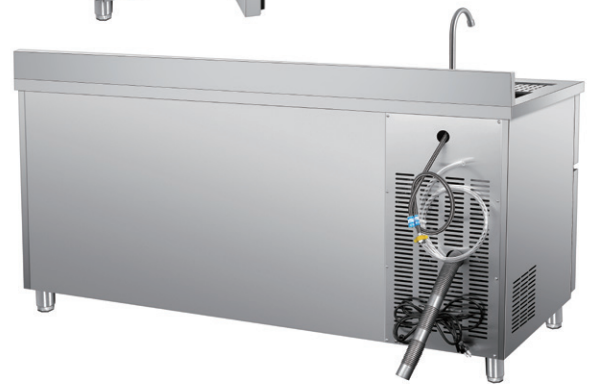

## Specifications

Model	Doors	1/6 Size Pan	Ext. Dimensions W x D x H (in)	V/Hz/Ph	AMPS	Power	NEMA PLUG	Ship Weight(lbs)	Ship Data W x D x H (in)
CUSS-60	3	5	60 1/8 x 32 1/2 x 39 1/2	115/60/1	4	380W/0.51HP	5-15	529.2	65 1/2 x 37 1/4 x 47 3/4
CUSS-72	3	6	72 1/8 x 32 1/2 x 39 1/2	115/60/1	4	380W/0.51HP	5-15	573.2	75 x 37 1/4 x 47 3/4
CUSS-84	3	7	84 x 32 1/2 x 39 1/2	115/60/1	5.3	450W/0.61HP	5-15	693.4	87 1/2 x 37 1/4 x 47 3/4
CUSS-96	3	9	96 x 32 1/2 x 39 1/2	115/60/1	5.3	450W/0.61HP	5-15	705.5	99 1/2 x 37 1/4 x 47 3/4



If the data and structure update, without notice, subject to material object.

# Workstation Refrigerator

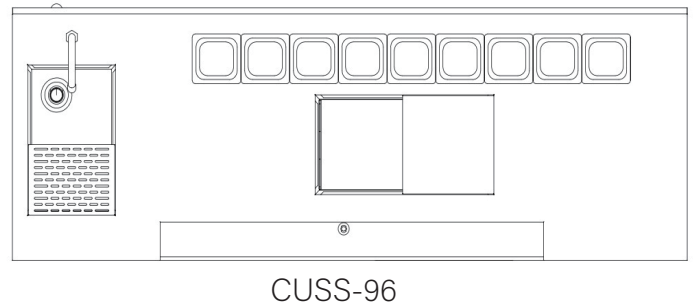
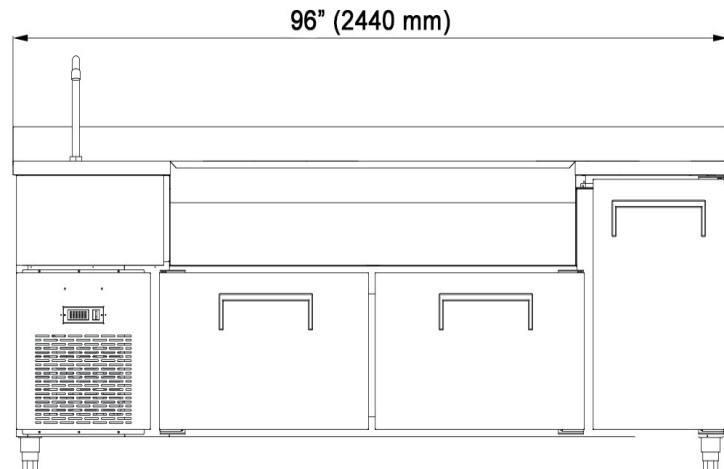
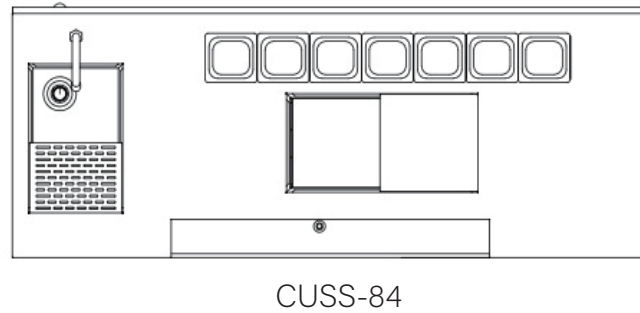
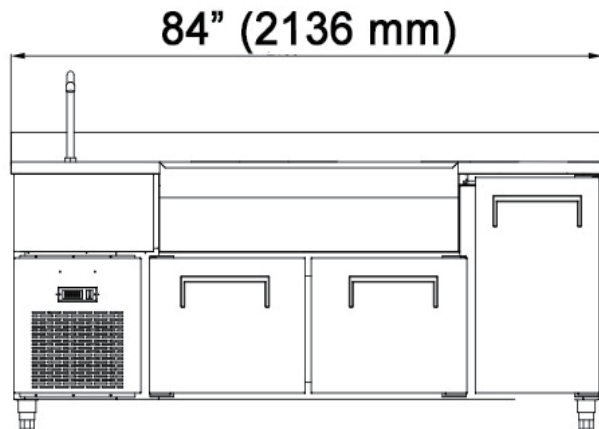
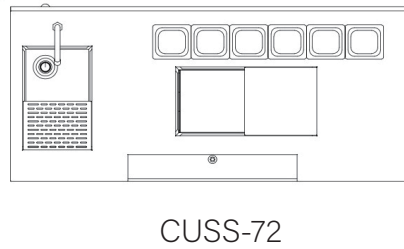
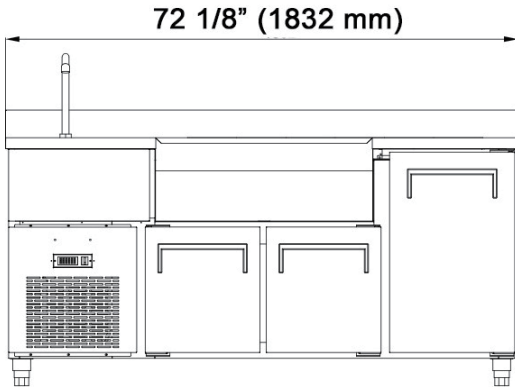
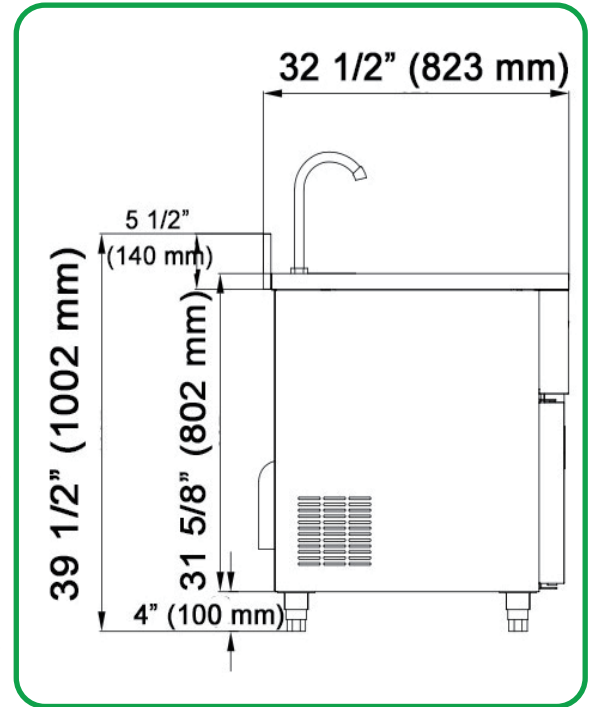
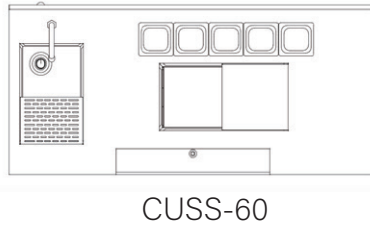
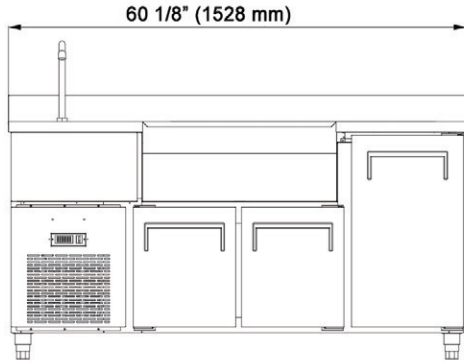

If the data and structure update, without notice, subject to material object.