

Grab and Go refrigerator

self-serve counter case

All-steel base construction with Stainless Steel exterior
 Easily accessible light and power switch
 Rear access to refrigeration system for quick and easy service
 Adjustable leg levelers
 On-Demand PTC condensate evaporator provided for a totally self-contained system
 Stainless Steel step riser
 Auto defrosting and auto evaporation to prevent condensation
 Condensation pan efficiently evaporates excess water
 INTERIOR: Stainless steel
 EXTERIOR: Stainless steel
 Temperature : 36 to 46°F / 2 to 8°C
 Electrical: 115/60/1 with NEMA 5-15P plug, 10ft cord

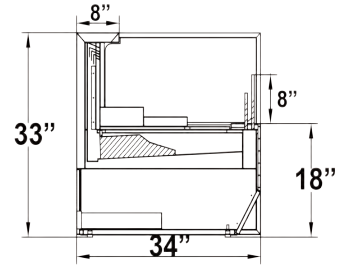
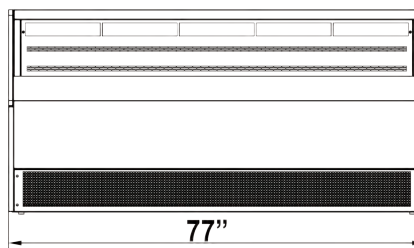
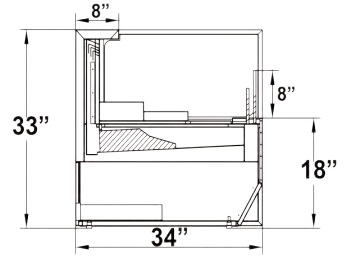
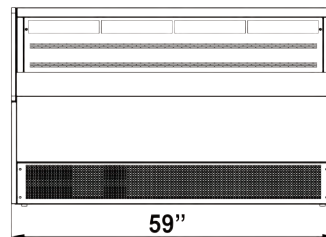
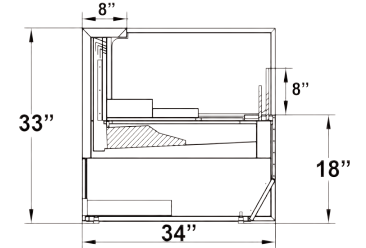
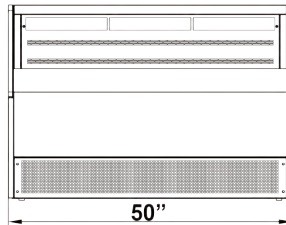
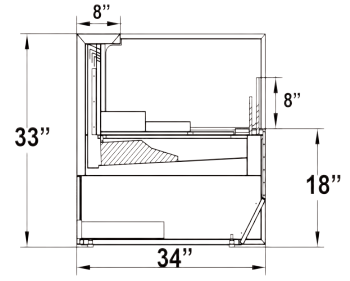
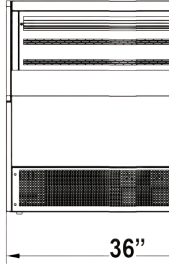
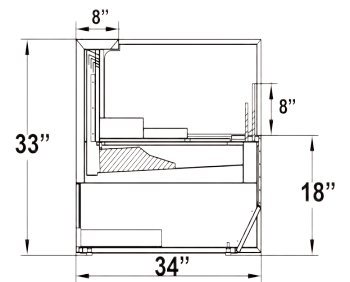
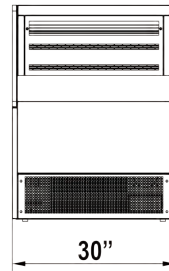

SPECIFICATIONS

Refrigerator

Model	Type	Ext. Dimensions W x D x H (in)	Int.. Dimensions W x D x H (in)	V/Hz/Ph	AMPS	HP	NEMA PLUG	Ship Weight(lbs)	Ship Data W x D x H (in)
GNG-F30	square ends	30x34x33		115/60/1			5-15P	287	33.46x38.19x40.83
GNG-F36	square ends	36x34x33		115/60/1			5-15P	309	39.17x38.19x40.83
GNG-F50	square ends	50x34x33		115/60/1			5-15P	353	52.95x38.19x40.83
GNG-F59	square ends	59x34x33		115/60/1			5-15P	397	62.2x38.19x40.83
GNG-F77	square ends	77x34x33		115/60/1			5-15P	485	80.12x38.19x40.83



Inspected by QAI when the product bears the QAI SPE-1000 label

If the data and structure update, without notice, subject to material object