

# Cake Display Showcase



## Features

- Energy efficient Low-e triple Four sides right angle design, good insulation and display effect
- CFC Free Refrigerant And Foam
- Electronic Thermostat And Digital LED Temperature Display For Accurate Control And Easy Reading
- Adjustable heavy Duty Shelves and Concealed Refrigerated Drawers design
- LED Light For Better Display.
- Efficient electrothermal defogging
- With fan cooling system.
- Auto defrosting and auto evaporation to prevent condensation
- Condensation pan efficiently evaporates excess water
- High quality marble base, stylish appearance, durable, easy to clean
- Easy to mount 3" casters (lockable in front) are standard with all units.
- Electrical: 115/60/1 with NEMA 5-15P plug, 10ft cord
- Dual Compressors & Dual Plug: FDC-79-4D,FDC-95-4D

## Temperature

- Interior temperature range: 2°C to 8°C ( 36°F to 46°F)

## Warranty

- 3 years parts and labour
- 5 years compressor warranty

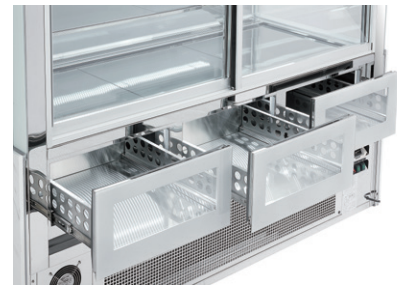

## Specifications

Model	Drawers	Ext. Dimensions W x D x H (in)	V/Hz/Ph	AMPS	Power	NEMA PLUG	Ship Weight(lbs)	Ship Data W x D x H (in)
FDC-48-2D	2	47 1/4 x 31 1/2 x53 1/2	115/60/1	17.03	1468W/1.97HP	5-15P	728	50 1/2 x 35 x 61
FDC-60-3D	3	59 x 31 1/2 x53 1/2	115/60/1	17.36	1448W/1.94HP	5-15P	882	62 1/4 x 35 x 61
FDC-71-3D	3	70 7/8 x 31 1/2 x53 1/2	115/60/1	17.81	1502W/2.01HP	5-15P	1036	74 x 35 x 61
FDC-79-4D	4	78 3/4 x 31 1/2 x53 1/2	115/60/1	24.01	1912W/2.56HP	dual 5-15P	1191	82 x 35 x 61
FDC-95-4D	4	94 1/2x 31 1/2 x53 1/2	115/60/1	24.37	2000W/2.68HP	dual 5-15P	1323	97 3/4 x 35 x 61



Inspected by QAI when the product bears the QAI SPE-1000 label

If the data and structure update, without notice, subject to material object



# Cake Display Showcase

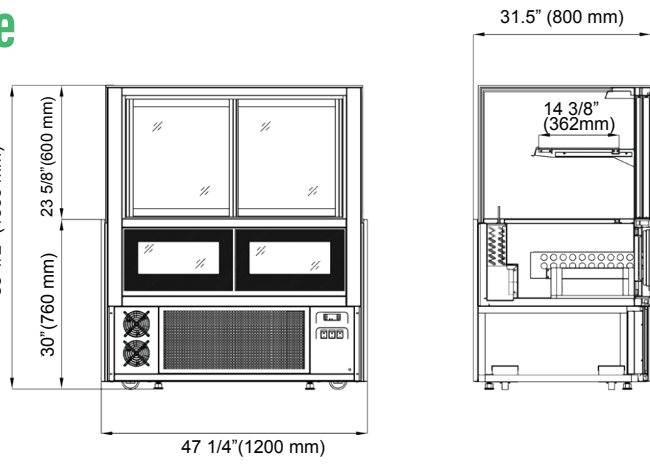

FDC-48-2D

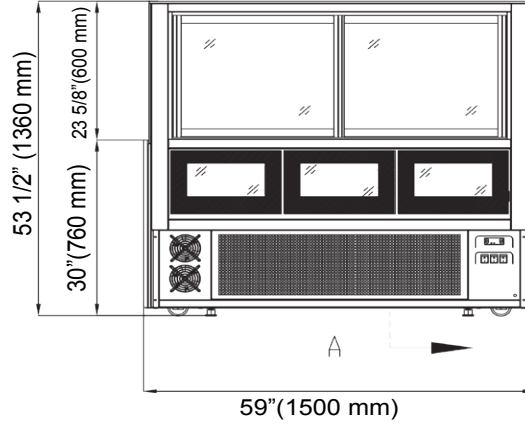

FDC-60-3D

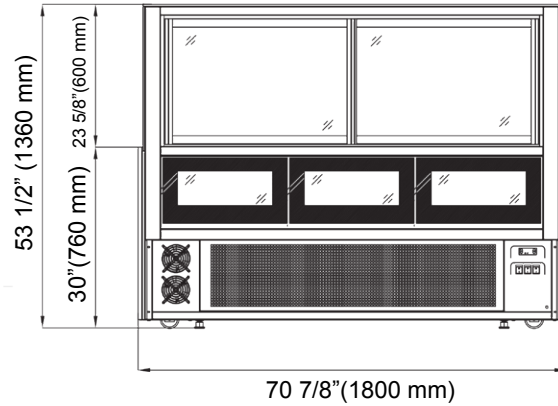

FDC-71-3D

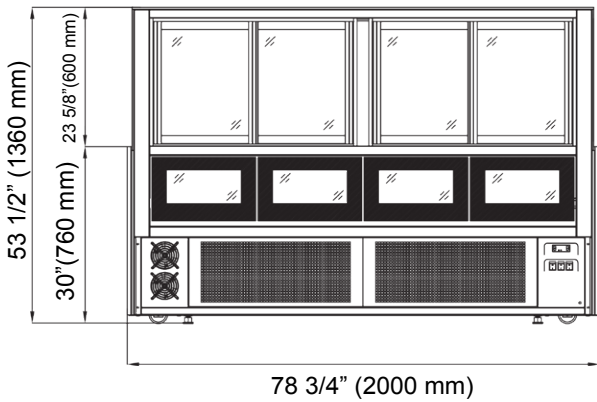

FDC-79-4D

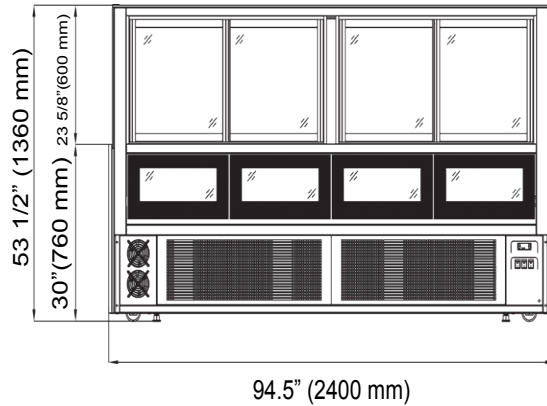

FDC-95-4D



Inspected by QAI when the product bears the QAI SPE-1000 label  
If the data and structure update, without notice, subject to material object

