

BOLT Space Printable Code Mat Instructions

CUT LINE

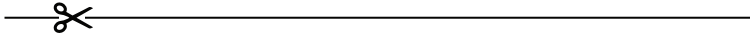

OVERLAP EDGE



ADHESIVE/ OVERLAP AREA

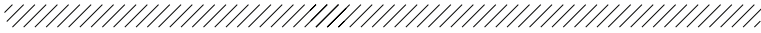

This 60 page document will be used to assemble your map. Print out each page on 8.5x11" paper and tape or paste them together using the instructions.

1. Print all 60 pages of the PDF. In the print dialogue box, select "Scale: 100%". This will ensure the Code Mat is printed at the correct size.

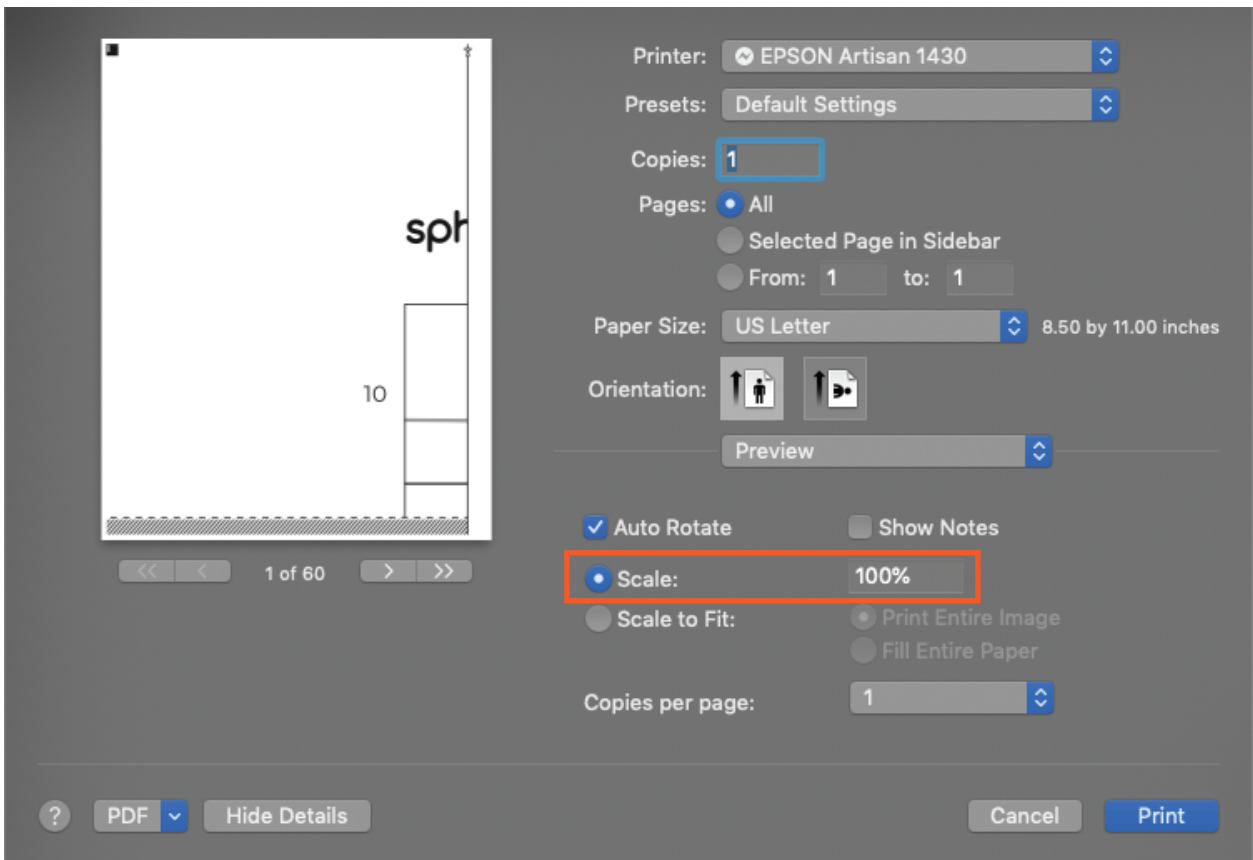

BOLT Space Printable Code Mat Instructions

CUT LINE

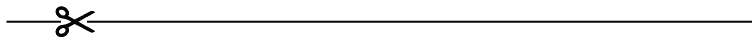

OVERLAP EDGE



ADHESIVE/ OVERLAP AREA

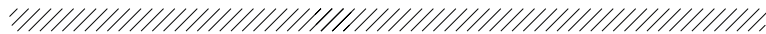

2. Cut along the solid scissor lines on the top and right sides of each page.
3. Line up the cut edges on the top and right side of the page with the dashed lines on the sheets above and to the right. Pages will overlap on top of each other.
 - Line up the cut edge on the right side with the vertical dashed line on the page to the right.
 - Line up the cut edge on the top with the horizontal dashed line on the page above it.

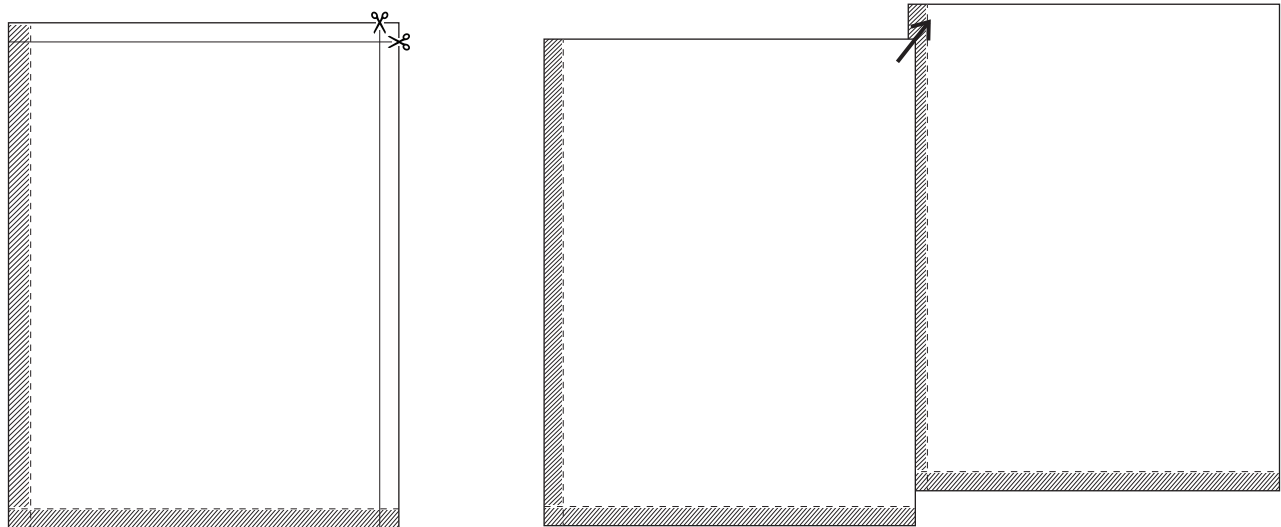

6. Tape pages together on the bottom of the map or glue on the adhesive area so the robot has a smooth surface to roll on.
7. Repeat steps for each page until the map is assembled.

BOLT Space Printable Code Mat Instructions

Assemble pages in chronological order from left to right.

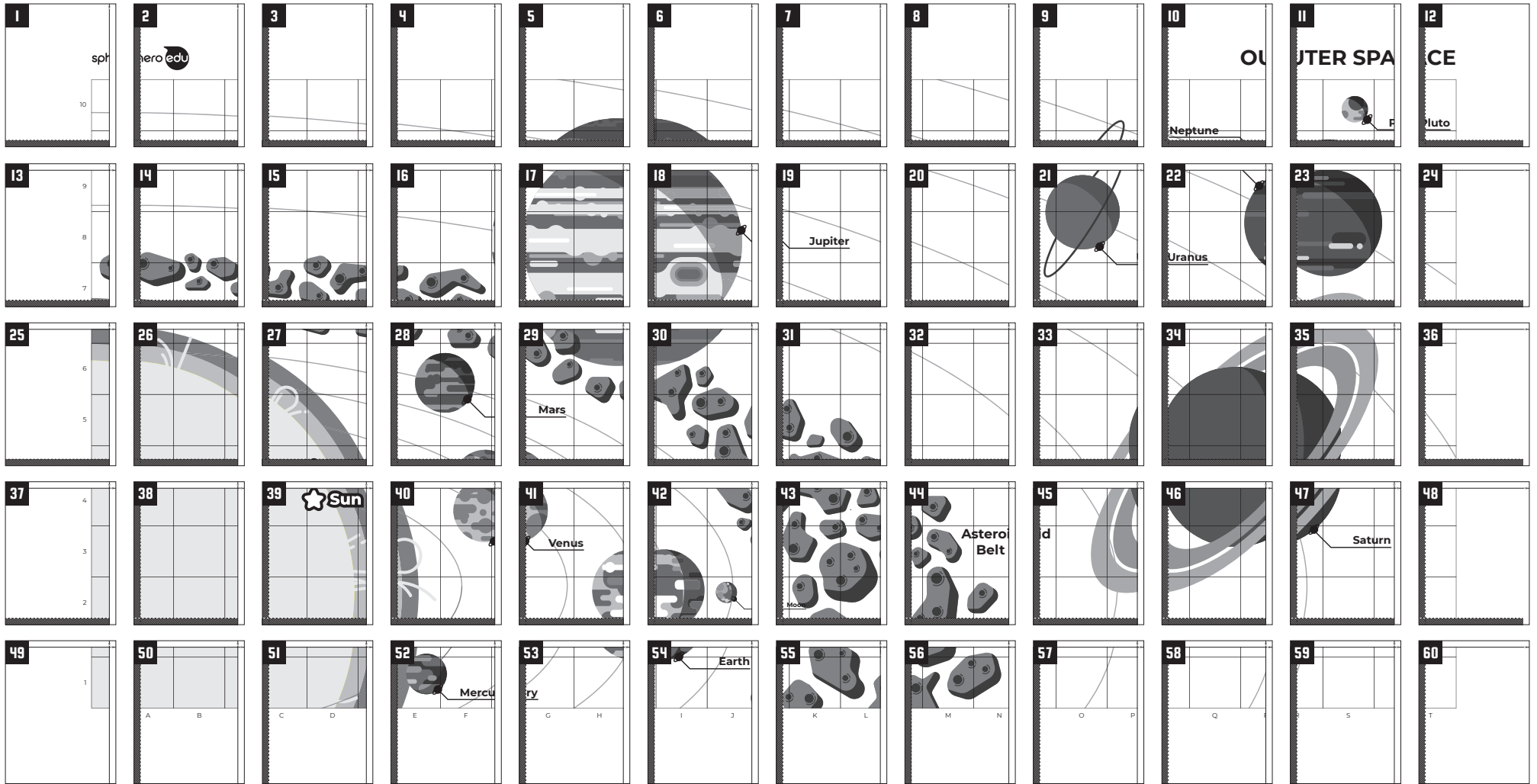

BOLT Space Printable Code Mat Instructions



OUTER SPACE

