

# F300IIFC

300 W FULL COLOUR FRESNEL WITH MOTORISED ZOOM

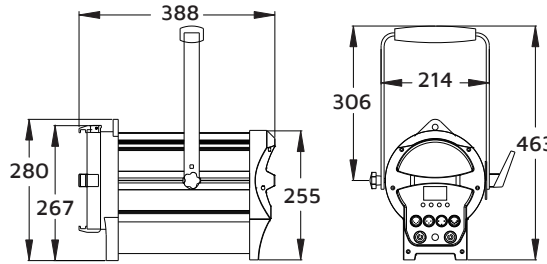

<b>Photometrics</b>	F300IIFC
Light Source	300 W RGBALC LED Module, CRI 86+
Beam Angle	12°~25°
Field Angle	15°~55°
Output	10,706 lux @ 2.5 m @ 15°
Lens	175 mm Fresnel
PWM	8,000 Hz
LED Lifespan	50,000 hours
<b>Effects</b>	
Dimming	0~100%, 8/16-bit
Strobe	1~25 Hz
Zoom	Motorised, 12°~55°
<b>Power</b>	
Input Voltage	100~240 V AC, 50/60 Hz, 300 W
Connection	Seetronic® True1 in/out
<b>Control</b>	
Operation Modes	DMX, manual, master/slave
Control Protocol	DMX512
DMX Channels	9/10/17/8H/9H
Control Interface	3-pin XLR, 5-pin XLR
Display	4-button OLED control panel
<b>Housing</b>	
Housing Materials	Aluminium, matte black finish
Cooling	Sensor thermostat controlled variable speed fan
IP Rating	IP20
Net Weight	10 kg
<b>Accessories</b>	
Included	Barn door, gel frame

	Lux @ 12°		
	2.5m	5.0m	7.0m
	Ø0.53	Ø1.05	Ø1.47
<b>R</b>	1,098	275	140
<b>G</b>	2,036	509	260
<b>B</b>	500	125	64
<b>A</b>	1,322	330	169
<b>L</b>	5,719	1,430	729
<b>C</b>	1,174	293	150
<b>Full</b>	10,706	2,676	1,366

	Lux @ 25°		
	2.5m	5.0m	7.0m
	Ø1.11	Ø2.22	Ø3.1
<b>R</b>	436	109	56
<b>G</b>	947	237	121
<b>B</b>	234	59	30
<b>A</b>	586	137	75
<b>L</b>	2,486	621	317
<b>C</b>	510	128	65
<b>Full</b>	4,590	1,148	585

# F200VMZ

200 W VARIABLE COLOUR TEMPERATURE FRESNEL WITH MANUAL ZOOM

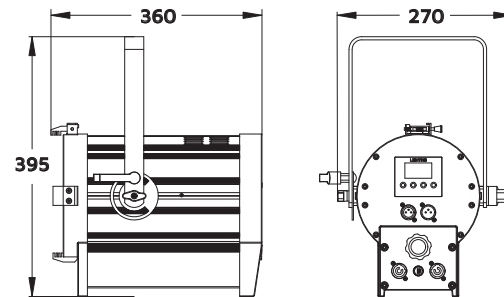

<b>Photometrics</b>	F200VMZ
Light Source	500 W 3,200 and 5,600 K COB LED, CRI: 95+
Beam Angle	16~25°
Field Angle	30~65°
Output	2,560 lux @ 2.5 m @ 12°
Lens	150 mm Fresnel
PWM	8,000 Hz
LED Lifespan	50,000 hours
<b>Effects</b>	
Dimming	0~100%, 16-bit
Dimming Curves	3
Strobe	1~25 Hz
Zoom	Manual 16°~25°
<b>Power</b>	
Input Voltage	100~240 V AC, 50/60 Hz, 300 W
Connection	NEUTRIK® powerCON in/out
<b>Control</b>	
Operation Modes	DMX, manual, master/slave
Control Protocol	DMX512
DMX Channels	2/3
Control Interface	3-pin XLR (optional: 5-pin XLR)
Display	4-button LCD control panel
<b>Housing</b>	
Housing Materials	Aluminium and ABS, matte black finish
Cooling	Sensor thermostat controlled variable speed fan
IP Rating	IP20
Net Weight	5 kg
<b>Accessories</b>	
Included	Barn door, gel frame

	Lux @ 16°		
	2.5m	5.0m	7.5m
	Ø0.70	Ø1.41	Ø2.11
<b>3,200K</b>	2,560	640	284
<b>5,600K</b>	4,224	1,056	469

	Lux @ 25°		
	2.5m	5.0m	7.5m
	Ø1.11	Ø2.22	Ø3.33
<b>3,200K</b>	1,126	282	125
<b>5,600K</b>	1,997	499	222