

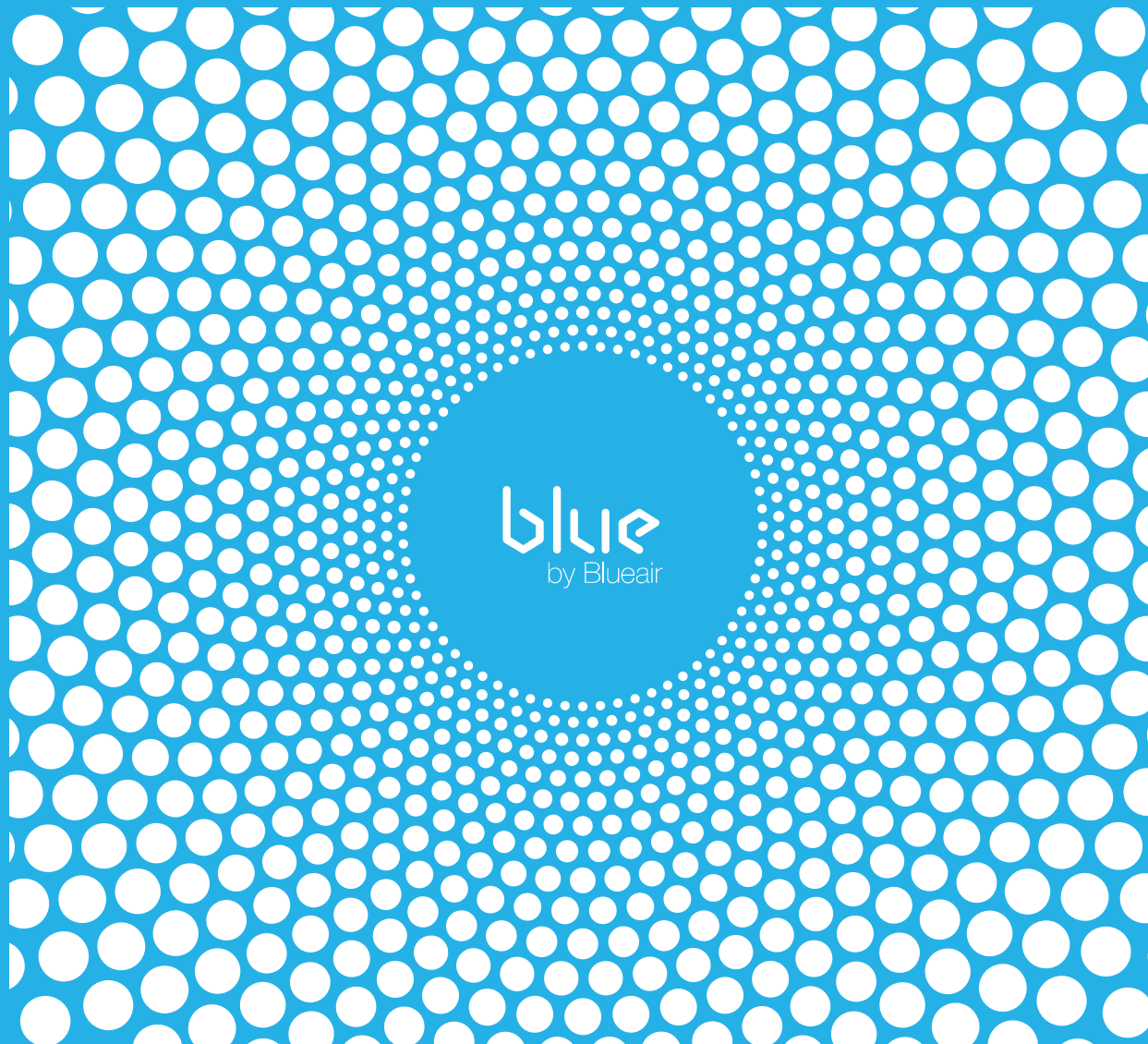

Air purifier /
Luftreiniger /
Purificador de aire /
Purificateur d'air /
Oczyszczacz powietrza



User Manual / Benutzerhandbuch /
Manual de usuario / Guide
d'utilisation / Instrukcja obsługi

Blue
PURE 411

General safety instructions

Remember, Pure 411 is an electrical appliance. Please read these safety instructions carefully before use and take the necessary precautions to reduce the risk of fire, electric shock or injury. **The Pure 411 warranty applies only if the unit is used according to these instructions.**



WARNING: Indicates a hazardous situation that, if not avoided, could result in death or serious injury.



CAUTION: Indicates a hazardous situation that, if not avoided, could result in minor or moderate injury.

General



WARNING:
To avoid hazardous conditions, only the manufacturer, a service center authorized by Blueair or similarly qualified persons shall replace the power cord, if damaged.



CAUTIONS:

- Use the power cable provided with your Pure 411 unit to plug directly into an appropriate, electrical outlet. (Refer to the rating label on your unit).
- Do not alter the plug in any way.
- Remember to always disconnect the power supply before servicing the unit.
- Do not use the unit if the power cable or plug is damaged or malfunctions in any manner.

- Keep the power cable away from heated surfaces.
- Do not sit on, stand or climb onto the unit or use the unit either as a table or for storage.
- Do not place any objects on top of the unit, block air outlets or intakes, or allow foreign objects to enter the unit as this may cause an electric shock or damage the unit.

Intended Use



CAUTIONS:

- Supervise children to ensure that they do not play with the appliance.
- This appliance is not intended for use by persons (including children) with reduced physical, sensory or mental capabilities, or lack of experience and knowledge, unless they have been given supervision or instruction concerning use of the appliance by a person responsible for their safety.

Blueprint

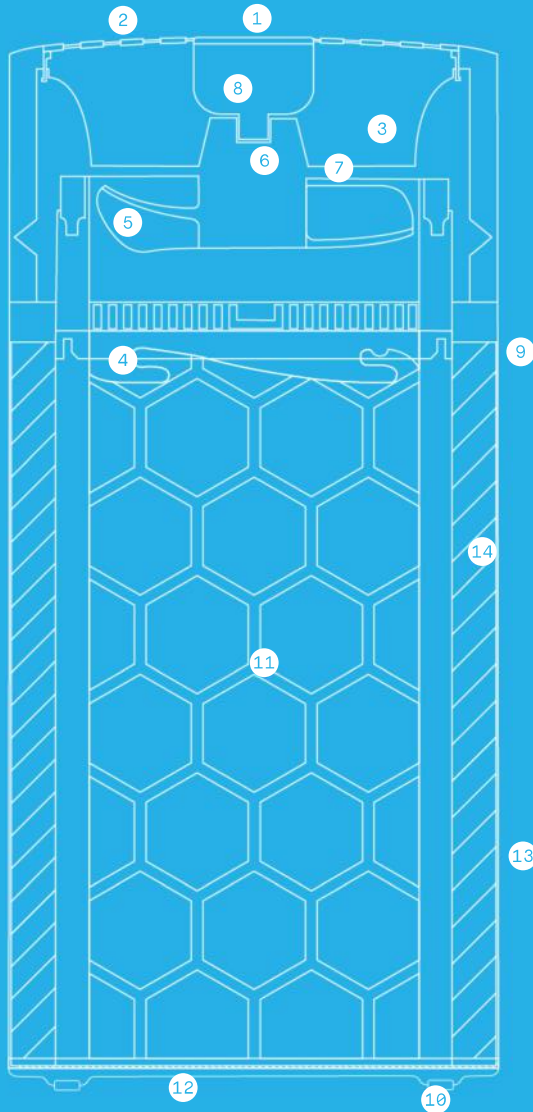

- ① Touch button
- ② Air outlet
- ③ Ion chamber (Air stream optimizer)
- ④ Bayonet connection
- ⑤ Fan
- ⑥ Motor
- ⑦ Fan holder
- ⑧ PCB - Printed Circuit Board
- ⑨ Filter shelf
- ⑩ Circular rubber foot
- ⑪ Inner structure
- ⑫ Bottom plate
- ⑬ Pre-filter
- ⑭ Main filter (Particle filter or Particle + Carbon filter)

Pure 411 package

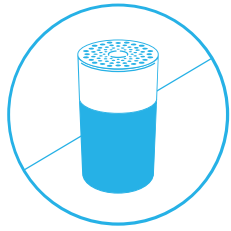

The Pure 411 air purifier

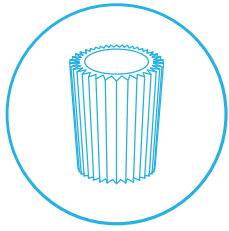

Particle or Particle + Carbon filter



Fabric pre-filter

Options

- Particle filter (replacement filter)
- Particle + Carbon filter (replacement filter)
- Choice of color and design for the fabric pre-filter.

Placement

Place Pure 411 in an upright position on the floor in your room. Be sure to place the unit where it won't be knocked over by any person or pet in the household.

Using Pure 411 in your bedroom:

After 5 seconds the light automatically dims.

Placing the unit:

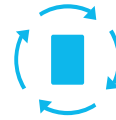

Place the unit in a location where air can circulate freely in, out and around the unit.



Do not place the unit near sources of heat, such as radiators, fireplaces or ovens.



Do not place the unit closer than 10 cm (4") from another object.



Do not place the unit near wet areas, such as bathrooms or laundry rooms where it may come into contact with water.



Do not place the unit directly on or against soft furnishings such as bedding or linen.



Do not place the unit outdoors.

Getting started

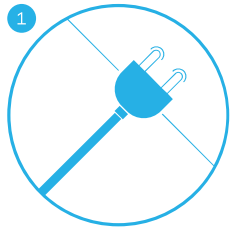

1 Plug in your Pure 411 air purifier.

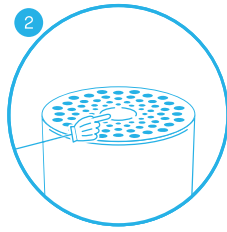

2 Press the top button to turn the unit on.
Adjust the speed setting to the required level (see "On/off and speed control")

On/off and speed control

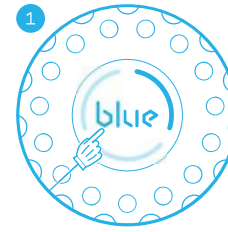

On/Low
Press once to turn the unit on and set it to the recommended energy-efficient speed.

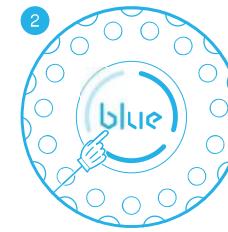

Medium
Press twice to set to medium speed 2.

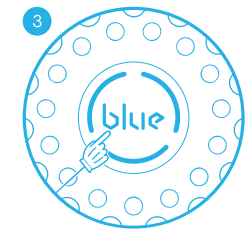

High
Press three times to set to high speed 3.

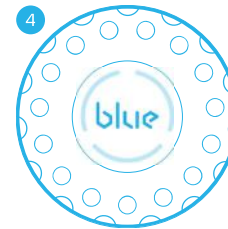

Off
Press a fourth time to turn the unit off.

The light on the touch button indicates the selected speed.

Moreover, Pure 411 has an Autostart feature. This means that Pure 411 will automatically restart at the set speed if a power failure occurs, the unit is unplugged or a power switch timer is used.

Filters

General information:

The unit is delivered with the fabric pre-filter and either a Particle filter or a Particle + Carbon filter. These filters remove the following pollutants:

Particle filters remove:

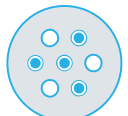

PM2.5*



Dust



Pollen



Pet dander



Mold



Dust mites



Bacteria

Particle + Carbon filters remove all the above pollutants, plus:



VOC



Smoke



Chemicals



Cooking odors

*Particle matter smaller than 2.5 microns

IMPORTANT!

Use only genuine Blueair filters to ensure proper function of your unit and to qualify for full warranty coverage.

Button control functions

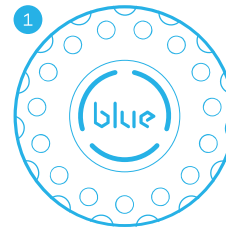

Change filter

When the indicator light turns red (after 6 months of operation) you should change the main filter.

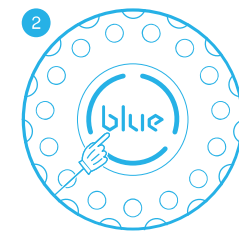

Reset filter alert

Press the button down for a duration of five seconds to reset the filter alert.

Vacuum or wash the pre-filter

Occasionally vacuum the exterior of the fabric pre-filter to remove dust.

Always unplug the unit before removing the fabric pre-filter

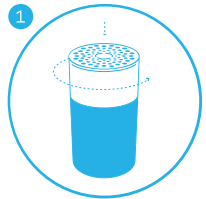

1 Carefully push the top cylinder down, at the same time rotating it *counter-clockwise* to open the bayonet lock inside.

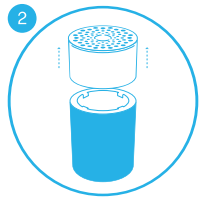

2 Remove the top cylinder from the unit.

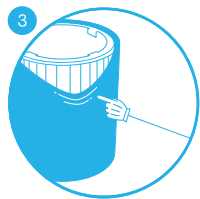

3 Remove the pre-filter from the unit.

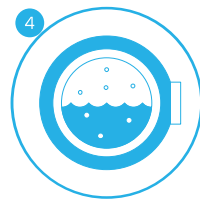

4 Wash the pre-filter in the washing machine, according to instructions on the pre-filter's label.

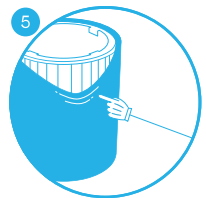

5 Attach the pre-filter onto the unit.

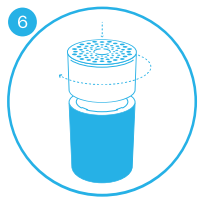

6 Carefully push the top cylinder down, at the same time rotating it *clockwise* to secure it back into the bayonet lock.

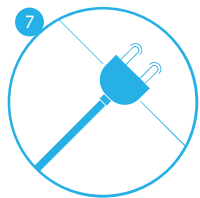

7 Plug in your Pure 411 air purifier.

Change the main filter

Always unplug the unit before changing the main filter.

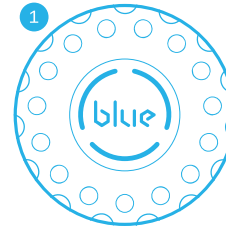

1 When the indicator light glows red, it's time to change the main filter.

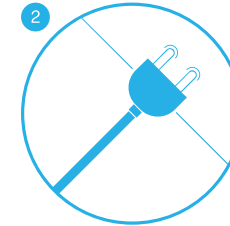

2 Turn off the unit and unplug it.

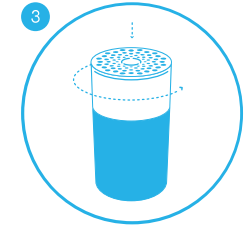

3 Carefully push the top cylinder down, at the same time rotating it *counter-clockwise* to open the bayonet lock inside.

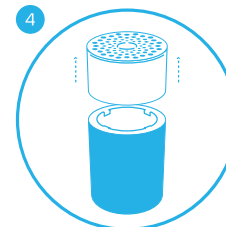

4 Remove the top cylinder from the unit.

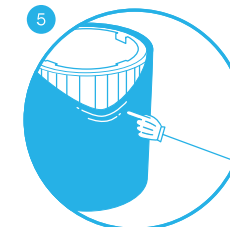

5 Remove the pre-filter from the unit.

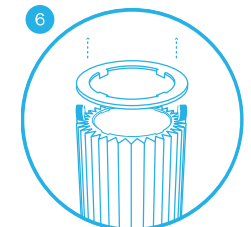

6 Carefully remove the filter shelf.

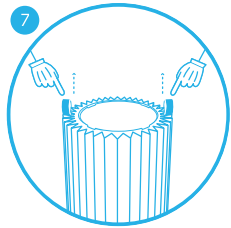

7 Grip the filter handles and pull upwards to remove the main filter from the unit.

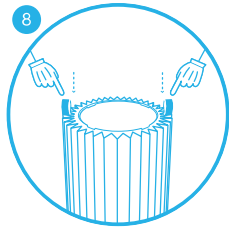

8 Position the new main filter onto the inner structure. The filter handles should face upwards.

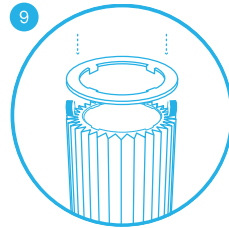

9 Press the filter shelf firmly into position above the main filter. The filter shelf protects the top edge of the main filter from damage.

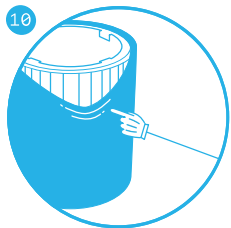

10 Attach the pre-filter over the main filter. The pre-filter should only cover the filter shelf, and not the inner filter ring of the filter holder unit.

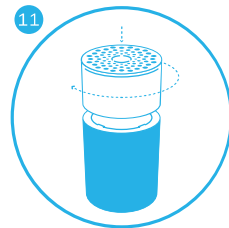

11 Carefully push the top cylinder down, at the same time rotating it *clockwise* to secure it back into the bayonet lock.

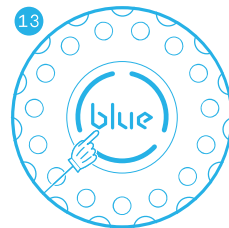

12 Press the touch button for a duration of 5 seconds to reset the filter replacement timer. This lets Pure 411 know that you have changed the filter. The indicator light flashes 3 times, and then changes from red to white.

12 Plug in your Pure 411 air purifier.



General care

Take good care of your Pure 411 to ensure that it delivers optimal performance.

- Vacuum the pre-filter occasionally to remove dust, or wash it on a gentle, low temperature cycle in the washing machine.
- Change the main filter every six months, depending on the operating conditions. Remember to unplug the unit before changing the main filter.
- When the unit is open to change the filter, vacuum any dust that may have accumulated inside the unit.
- Occasionally wipe the top of the unit with a dry dust cloth.

SPECIFICATIONS

Specifications¹

Room size:	15 m ² (161 sq. ft.)			
Clean Air Delivery Rate (CADR)	cfm m ³ /h	Smoke  105 180	Dust  120 200	Pollen  120 200
Filter replacement indicator	Yes			
On/Off timer	No			
Speeds	1-2-3-off			
Dimensions	Height:	425 mm (16.7 in)		
	Width:	200 mm (7.8 in)		
	Depth:	200 mm (7.8 in)		
	Weight:	1.52 kg (3.35 lbs)		
Airflow rate	60 - 200 m ³ /h (35 - 120 cfm)			
Air exchange ²	5 per hour (15 m ² or 161 sq.ft.room)			
Power usage	1.5 - 10 W			
Noise level	17 - 46 dB(A)			
Average filter service life	six months ³			
Warranty	Local regulations			

Blue is available in different colors for model Pure 411. The colored fabric works as a pre-filter.

¹Certified ratings as stated are based on models with Particle Filter for Blue Pure 411. Ratings may be affected by use of other Blue filter models.

²Air changes per hour are calculated on the recommended room size, assuming 8-foot (2.4-m) ceilings. For smaller rooms, the air changes per hour will increase.

³Depending on air quality in the area of use, the recommended six-month filter lifetime may be longer.

Blue PURE 411

Deutsche Bedienungsanleitung
Modell: Pure411

SICHERHEIT	20
SYSTEMÜBERSICHT	22
LIEFERUMFANG	24
VERWENDUNG	25
EINRICHTUNG	26
EIN/AUS UND BETRIEBSGESCHWINDIGKEITEN	27
FILTER	28
PFLEGE UND WARTUNG	33
TECHNISCHE DATEN	34



www.blueair.com
www.blueair.com/contact-us

Blueair AB

Karlavägen 108
115 26 Stockholm
Sweden
Tel: +46 8 679 45 00

Blueair Inc.

Suite 1900
100 N LaSalle Street
Chicago, IL 60602
Tel: +1 888 258 3247

Blueair India Pvt. Ltd.

Embassy of Sweden
Nyaya Marg, Chanakyapuri
New Dehli - 110021
Tel: +91 11 4606 7121

Blueair (Shanghai) Trading Co. Ltd.

Rm 1005 City Gateway
No. 398 North Caoxi Road
Xuhui Distr, Shanghai
Tel: +86 21 6091 0981