

## TRI-BULB RIVETS

### An all-aluminium tri-folding structural rivet with washer



Tri-Bulbs are a high-performance structural rivet that differ from other types due to its propeller shape blind-side anchor and washer combo, providing a weatherproof joint with a large blind side bearing area for lightweight applications.

The Tri-Bulb spreads the clamping force through the anchor blades whilst providing excellent pull through resistance, making them an ideal choice for numerous lightweight panel applications. This rivet is renowned for its extended material grip range, enabling a single rivet to cover a greater range of gauges including curved or uneven surfaces. Tri-Bulb rivet diameter 7.7 mm is recommended for safety anchor points.

**Diameter Size:** 5.2, 6.3, 7.7 mm

**Material:** Aluminium

**Head Styles:** Dome, Truss (large flange)

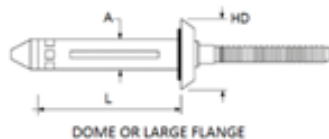

Tri-Bulb All Aluminium							
Rivet Diameter A (mm)	Huck Aerobolt Product Code	Grip Min-Max (mm) Material Thickness	Hole Size $\pm 0.1$ (mm)	Head Dia. HD (mm)	Length L (mm)	Shear Typical (Kn)	Tensile Typical (Kn)
<b>Dome Head</b>							
5.2	RV660-6-04W(a)	1.6 – 6.4	5.4	11.3	19.1	2.5	1.8
	RV660-6-06W(a)	4.7 – 9.5			22.2		
6.3	RV660-8-04W(a)	1.6 – 6.4	6.5	14.2	20.2	3.8	2.2
	RV660-8-06W(a)	3.2 – 9.5			23.4		
<b>Truss (large flange)</b>							
7.7	RV660-9-06W(a)	1.1 – 9.5	7.9	18.9	28.2	6.0	4.3

\* Due to the variables, the data is a guide & specific testing is recommended. Contact us for further information.

#### Tri-Bulb Rivet Advantages

- Ideal for fiberglass, plastics, composites etc.
- Excellent for curved or uneven surfaces
- Weather, water and vibration resistant joints.
- Propeller shaped blind side footprint.

#### Tri-Bulb Rivet Applications

- Pantech & refrigerated trucks.
- Height & safety anchor points.
- Truck body & roof fabrication
- Construction, cladding & more.