

■ HUCK RIVET MAGNA-LOK®

The original extended grip range rivet with internal locking system

The Huck rivet is renowned for its versatility making it ideal for multiple material thicknesses and applications. These rivets have Huck's unique internal locking mechanism providing a high resistance to vibration and moisture along with ensuring the head has a neat flush finish when installed irrespective of material thickness.

Huck rivets Magna-Lok® have been tested against their nearest competitor product and outlasted them by almost 20 to 1. Huck rivets lasted 2 million cycles whilst the other lasted 100,000.

Diameter Sizes: 4.8, 6.4, 7.9, 9.5, 12.7 mm

Materials: Steel, Aluminium, Stainless (304 & 316*)

Head Styles: Dome, Countersunk, Truss

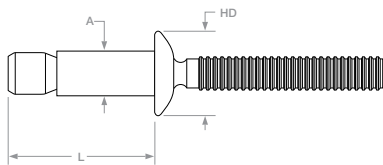

DOME HEAD

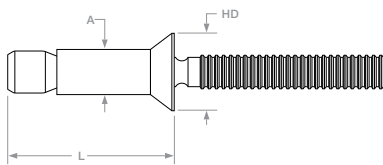

COUNTERSUNK HEAD

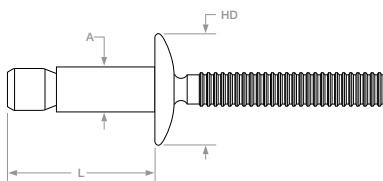

TRUSS HEAD

HUCK RIVET (all steel with zinc coating) Sleeve – Low Carbon Steel; Pin - Medium Carbon Steel: Zn – Clear Chromate

Rivet Diameter (A) (mm) and (in)	Huck Aerobolt Product Code	Grip Min-Max (mm) Material Thickness	Hole Size ±0.1 (mm)	Head Dia HD (mm)	Length L (mm)	Shear Typ. (kN)	Tensile Typ. (kN)
Dome Head							
4.8 mm (3/16")	HRDS-0604	1.6 – 6.9	5.0	9.78	18.29	5.7	4.4
	HRDS-0610E	1.6 – 11.1			25.91		
6.4 mm (1/4")	HRDS-0806	2.0 – 9.5	6.8	13.44	24.64	11.1	8.2
	HRDS-0810E	2.0 – 15.9			35.69		
	HRDS-0810E126	6.3 – 20.0			39.90		
	HRDS-0818	21.1 – 28.8			43.69		
	HRDS-0822	27.5 – 34.9			50.04		
7.9 mm (5/16")	HRDS-1016	3.5 – 16.0	8.2	15.90	32.00	15.6	9.8
9.5 mm (3/8")	HRDS-1212	3.1 – 15.9	10.0	20.14	41.91	26.6	17.7
	HRDS-1218	15.9 – 28.6			56.26		
12.7 mm (1/2")	HRDS-1612	4.0 – 19.0	14.0	27.00	57.64	44.4	31.1
Countersunk Head							
4.8 mm (3/16")	HRKS-0606	3.2 – 8.4	5.0	8.89	20.19	5.7	4.4
	HRKS-0609	7.8 – 12.7			24.43		
6.4 mm (1/4")	HRKS-0808	4.1 – 12.1	6.8	10.41	26.90	11.1	8.2
	HRKS-0812	10.5 – 18.4			33.25		
9.5 mm (3/8")	HRKS-1212	6.1 – 19.1	10.0	16.10	40.25	26.6	17.7
Truss Head							
4.8 mm (3/16")	HRTS-0604	1.6 – 6.9	5.0	13.49	18.03	5.7	4.4
	HRTS-0610E	1.6 – 11.1			25.78		
6.4 mm (1/4")	HRTS-0806	2.0 – 9.5	6.8	15.04	24.64	11.1	8.2

Huck Installation Guns



■ HUCK AIR GUN - 10244



■ HUCK CORDLESS - BV4500AUS



■ HUCK AIR GUN - 10256

HUCK RIVET FEATURES

- Extra wide grip range
- Flush break stem mandrel
- Great gap closing capacity
- Internal locking mechanism
- Vibration & weather resistant
- Fast & foolproof installation

HUCK RIVET APPLICATIONS

- Ute tray & canopy body building
- Truck & trailer body building
- Emergency & Utility Vehicles
- Sheet metal fabrication
- HVAC (Heat, Ventilation, Air Con.)
- Building construction & more

HUCK RIVET (all aluminium) Sleeve - 5056; Pin - 7075

Rivet Diameter (A) (mm) and (in)	Huck Aerobolt Product Code	Grip Min-Max (mm) Material Thickness	Hole Size ±0.1 (mm)	Head Dia HD (mm)	Length L (mm)	Shear Typ. (kN)	Tensile Typ. (kN)
Dome Head							
4.8 mm (3/16")	HRDA-0604	1.6 – 6.9	5.0	9.78	18.29	2.6	2.2
	HRDA-0610E	1.6 – 11.1			25.91		
6.4 mm (1/4")	HRDA-0806	2.0 – 9.5	6.8	13.44	24.64	5.7	3.9
	HRDA-0810E	2.0 – 15.9			35.69		
9.5 mm (3/8")	HRDA-1212	3.1 – 15.9	10.0	20.14	41.91	13.1	8.5
Countersunk Head							
4.8 mm (3/16")	HRKA-0606	3.2 – 8.4	5.0	8.89	20.19	2.6	2.2
	HRKA-0609	7.8 – 12.7			24.43		
6.4 mm (1/4")	HRKA-0808	4.1 – 12.1	6.8	10.41	26.90	5.7	3.9
	HRKA-0812	10.5 – 18.4			33.25		
Truss Head							
4.8 mm (3/16")	HRTA-0604	1.6 – 6.9	5.0	13.49	18.03	2.6	2.2

HUCK RIVET (all stainless) Sleeve – 302; Pin 305/4

Rivet Diameter (A) (mm) and (in)	Huck Aerobolt Product Code	Grip Min-Max (mm) Material Thickness	Hole Size ±0.1 (mm)	Head Dia HD (mm)	Length L (mm)	Shear Typ. (kN)	Tensile Typ. (kN)
Dome Head							
4.8 mm (3/16")	HRDSS-0604	1.6 – 6.9	5.0	9.96	10.52	5.7	4.2
	HRDSS-0607	5.4 – 11.1			14.53		
6.4 mm (1/4")	HRDSS-0806	2.0 – 9.5	6.8	13.44	24.64	10.4	8.0
	HRDSS-0810	8.9 – 15.9			30.99		
Countersunk Head							
4.8 mm (3/16")	HRKSS-0606	3.2 – 8.4	5.0	8.89	20.2	5.7	4.2
	HRKSS-0609	7.8 – 12.7			19.35		
6.4 mm (1/4")	HRKSS-0808	4.1 – 12.1	6.8	10.41	26.90	10.4	8.0
	HRKSS-0812	10.5 – 18.4			33.25		

Information provided is a guide, specific testing is recommended. *Contact us for more information. Grip range; this is the thickness of the material to be bolted or riveted, please note this is not the length of the fastener. Shear; point of failure with force applied on the vertical. Tensile; point of failure with force applied on the horizontal.

Secure, fast installation.

1. Flush pin break eliminates grinding and filling, leaving an even surface.
2. Unique solid-circle lock ensures maximum strength and resistance to vibration.
3. Excellent gap pull-out and high retained clamp.
4. The sleeve expands during installation to fill the hole and create a moisture-resistant joint.

