

PRIVACY DOOR LATCH NEW

The ZPDL privacy door latch is designed for applications with corridor to interior openings, such as hotels, student accommodation and apartment blocks. The ZPDL allows occupiers to establish safely and easily who is at the door before opening it fully and allowing access.

The easy swing motion not only makes operation quick and effective, but also means the unit will not interfere with the normal operation of the door. It also prevents damage of the door and frame caused by the door slamming against a traditional sliding chain privacy device. Furthermore, the silicone pads mounted on the device afford even further door protection, and a silent operation.

FEATURES

- Easy to operate
- Enhanced in-room privacy
- Silent operation
- Helps to prevent door kick in
- Easy to install
- For new build or retrofit applications
- Cannot be used to hold door open
- Prevents possible door & frame damage found with traditional sliding chains

APPLICATIONS

- Hotels
- Apartments
- HMO's
- Student accommodation
- Private residences

OPERATION

Once installed the ZPDL sits in the closed, flush, position meaning the door can be opened and closed as normal without any need to touch the unit. Upon the requirement to restrict access into the room, a simple push on the top of the unit is all that is required to open the arm and swing it across the door face, therefore stopping the door being fully opened from the outside. To then allow access, again the arm is simply pushed on the top to swing it back into the flushed closed position.

FINISHES

Offering much improved aesthetics for this product type, the ZPDL is manufactured from zinc die cast material and is available from stock in satin chrome finish (US26D) but is also available in satin brass (US4), oil rubbed bronze (US10B) and black powder coat to special order. Fixing screws supplied.



DOOR CLOSED



DOOR OPEN

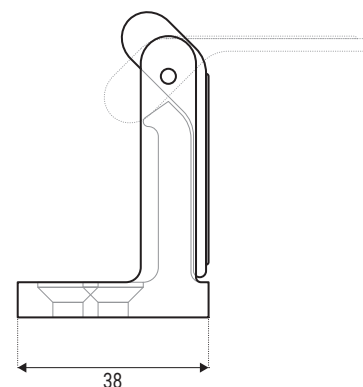
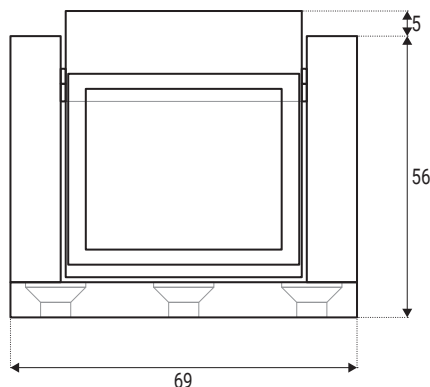
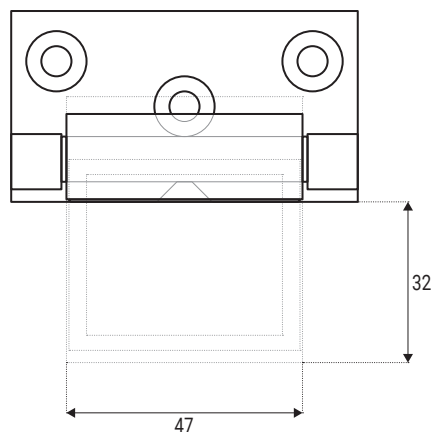

REF	DESCRIPTION
ZPDL	Privacy door latch, US26D satin chrome plated zinc die cast