

# ANEMOSTAT WOODPRO™ METAL VISION FRAMES

## LOPRO WOODPRO™ VENEER METAL VISION FRAMES - TO SUIT 44-46MM THICK DOORS & 6MM GLASS

The standard LoPro shown on pages 74-75 is galvanised mild steel, grey primed ready for powder coating. However it is also available as WoodPro™ with unfinished real wood veneers over PVC profiles which fasten to the LoPro metal vision frame with double sided adhesive tape. The veneers conceal the frame screw fixings and are available red oak, mahogany and maple.

Note: for internal use only.

- Material:** 20 GA cold rolled steel frame. PVC and wood veneer.
- Finish:** Unfinished red oak, maple or mahogany veneers over beige enamel LoPro.
- Sizes:** Minimum width of door cut-out 102mm. Maximum height of door cut-out 1829mm. Sizes available in inch increments, not available in fractional sizes.
- Installation:** WoodPro™ is easy to install and provides a low profile, flush to the door real wood finish. Uses 44mm sheet metal screws that pass through the door cut-out, and fastens to the opposite side of the vision frame. The formed wood veneers are pre-mitred with self-adhesive tape for ease of installation. Wood putty or putty stick may be required at mitres to fill any small gaps.
- Door thickness:** For 44-46mm metal or timber doors. Not available to suit other door thicknesses.
- Glass thickness:** 6mm as standard. Glass pocket of 10mm allows for glazing tape or compound to be used on one or both sides of the glass.
- Aesthetics:** No visible screws once veneers are in place. Tight mitred corners, bevelled glass stop and low profile, provide a clean tapered look.
- Fire ratings:** Tested for 30 minutes on timber door to BS EN 1634-1:2008. Actual size tested 410mm x 711mm.

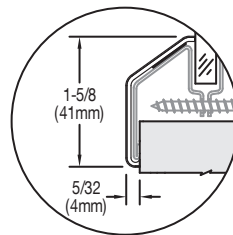
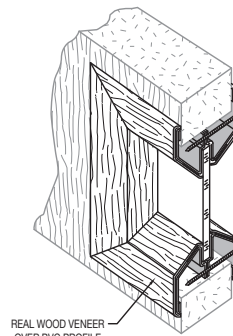

Dimensions for Wood Veneers

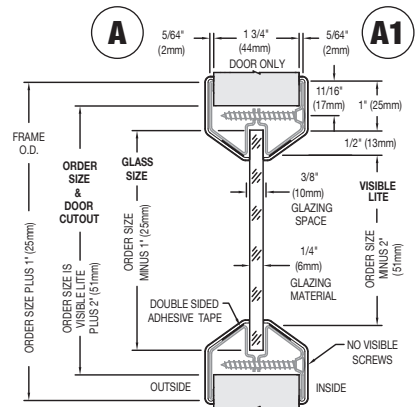

REF	SIZE IN INCHES W X H	CUT-OUT MM W X H	CLEAR VISION MM W X H	GLASS SIZE MM (NOT INCLUDED)
WOODPRO 0808*	8 x 8	203 x 203	152 x 152	176 x 176
WOODPRO 0820*	8 x 20	203 x 508	152 x 457	176 x 481
WOODPRO 0830*	8 x 30	203 x 762	152 x 711	176 x 735
WOODPRO 0848*	8 x 48	203 x 1219	152 x 1168	176 x 1192
WOODPRO 0860*	8 x 60	203 x 1524	152 x 1473	176 x 1497
WOODPRO 1010*	10 x 10	254 x 254	203 x 203	227 x 227
WOODPRO 1022*	10 x 22	254 x 559	203 x 508	227 x 532
WOODPRO 1030*	10 x 30	254 x 762	203 x 711	227 x 735
WOODPRO 1048*	10 x 48	254 x 1219	203 x 1168	227 x 1192
WOODPRO 1060*	10 x 60	254 x 1524	203 x 1473	227 x 1497
WOODPRO 1212*	12 x 12	305 x 305	254 x 254	278 x 278
WOODPRO 1616*	16 x 16	406 x 406	355 x 355	379 x 379
WOODPRO 1818*	18 x 18	457 x 457	406 x 406	430 x 430
WOODPRO 2020*	20 x 20	508 x 508	457 x 457	481 x 481
WOODPRO 2424*	24 x 24	610 x 610	559 x 559	583 x 583

Other sizes available from 102 x 102mm up to 914 x 1829mm cut-out in door.

### INSTALLATION INSTRUCTIONS

- Install LoPro vision frame and glass in door.
- If WoodPro is over 36" in height, install veneers only when door is in a horizontal (flat) position.
- If veneers are for a rectangular kit, install the two short pieces first.
- Due to manufacturing tolerances inherent in the process, there may be a slight gap in the mitred corners. If this is the case, use matching wood putty or putty stick to fill. Sand lightly to blend and stain and seal as normal.
- Wash hands prior to installing veneer strips.
- It is recommended that clean cotton gloves (not included) be used when handling and installing veneer strips.
- Avoid using oils, greases or cleaners on this product.
- Apply adhesive squares to corners of LoPro and peel protective backer.
- Pull protective strip from adhesive tape on inside of veneer.
- Place long edge of veneer against outside portion of vision frame using mitres as alignment guide.
- Rotate veneer towards glass.
- Use pressure from fingers to adhere tape to frame.
- Slide fingers with slight pressure along bevel to ensure proper contact.

