

ANEMOSTAT STAINLESS STEEL VISION FRAMES

LOPRO LOW PROFILE METAL VISION PANEL - TO SUIT 44-46MM THICK DOORS & 6MM THICK GLASS

The standard LoPro shown on pages 74-75 is galvanised mild steel, grey primed ready for powder coating. The LoPro is also available in stainless steel Grade 304 #4 satin finish in the sizes below from stock, and in Grade 316 #4 satin finish to special order.

- Material:** Grade 304 (and 316 stainless steel to special order).
- Finish:** #4 satin finish.
- Door thickness:** For 44-46mm metal or timber doors. LoPro-IS suits other door and glass thicknesses.
- Glass thickness:** 6mm as standard. Glass pocket of 10mm allows for glazing tape or compound to be used on one or both sides of the glass.
- Aesthetics:** Tight mitred corners, bevelled glass stop and low profile, provide a clean tapered look, concealed fixing one side only.
- Fire ratings:** Refer to page 74.
- Corrosion:** LoPro Grade 304 stainless steel vision frames have been successfully tested to Grade 4 (240 hours neutral salt spray exposure) in accordance with BS EN 1670:2007 Building Hardware - Corrosion Resistance. Report No WIL 392103 dated 30.01.2018 refers.

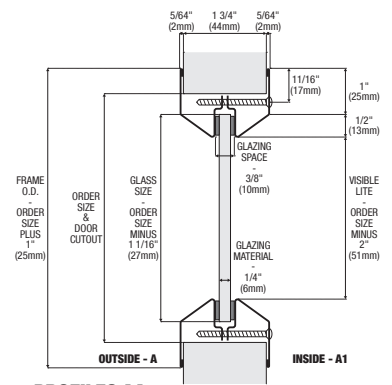
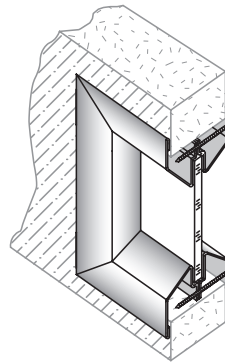

PROFILES AA1
 A = Blind side A1 = Screw hole side

Standard rectangles to suit 44-46mm doors and 6mm thick glass - satin stainless steel Grade 304, other sizes to special order.

REF	SIZE IN INCHES W X H	CUT-OUT MM W X H	CLEAR VISION MM W X H	GLASS SIZE MM (NOT INCLUDED)
LOPRO-SS 0722	7 x 22	178 x 559	127 x 508	151 x 532
LOPRO-SS 0730	7 x 30	178 x 762	127 x 711	151 x 735
LOPRO-SS 0820	8 x 20	203 x 508	152 x 457	176 x 481
LOPRO-SS 0830	8 x 30	203 x 762	152 x 711	176 x 735
LOPRO-SS 1010*	10 x 10	254 x 254	203 x 203	227 x 227
LOPRO-SS 1014	10 x 14	254 x 356	203 x 305	227 x 329
LOPRO-SS 1022*	10 x 22	254 x 559	203 x 508	227 x 532
LOPRO-SS 1030*	10 x 30	254 x 762	203 x 711	227 x 735
LOPRO-SS 1048	10 x 48	254 x 1219	203 x 1168	227 x 1192
LOPRO-SS 1060*	10 x 60	254 x 1524	203 x 1473	227 x 1497
LOPRO-SS 1212	12 x 12	305 x 305	254 x 254	278 x 278
LOPRO-SS 1818	18 x 18	457 x 457	406 x 406	430 x 430
LOPRO-SS 1822	18 x 22	457 x 559	406 x 508	430 x 532
LOPRO-IS-SS 1212 EE1*	12 x 12	305 x 305	254 x 254	278 x 278

Other sizes available from 102 x 102mm up to 813 x 1829mm cut-out in door.

ANEMOSTAT KLIP TOGETHER FRAMES

LOPRO-K KLIP TOGETHER METAL VISION PANEL - TO SUIT 44MM THICK DOORS & 6MM THICK GLASS ONLY

The LoPro-K is quicker to install than screw type kits and provides a low profile, "flush to the door look". It installs with unique spring steel clips that affix to the perimeter of the door cut-out. Each side of the vision frame is then snapped into the cut-out, fastening itself to the internal clip, thus eliminating the need for any visible fasteners or screws. This adds security and gives a cleaner, more aesthetic appearance. This kit only suits 44mm thick doors & 6mm glass. **NOT FIRE RATED.**

- Material:** 20GA cold rolled steel.
- Finish:** Galvanised grey primed as standard, other finishes available to special order.
- Door thickness:** For 44mm metal or timber doors. LoPro-K does not suit other door thicknesses.
- Glass thickness:** 6mm as standard. Glass pocket of 10mm allows for glazing tape or compound to be used on one or both sides of the glass.
- Aesthetics:** Tight mitred corners, bevelled glass stop and low profile, provide a clean tapered look with no screw holes on either side of the door.

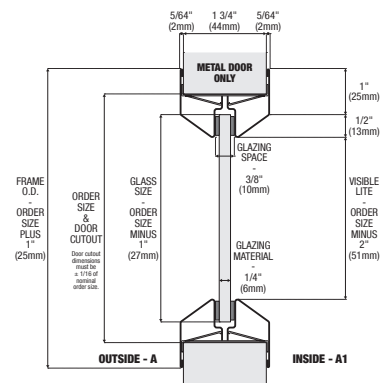
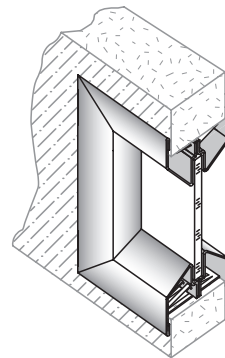

PROFILES AA
 A = Blind side

Klip together rectangles and circles to suit 44mm doors and 6mm glass - galv grey primed, other sizes to special order.

REF	SIZE IN INCHES W X H	CUT-OUT MM W X H	CLEAR VISION MM W X H	GLASS SIZE MM (NOT INCLUDED)
LOPRO-K 1022*	10 x 22	254 x 559	203 x 508	227 x 532
LOPRO-K 1030	10 x 30	254 x 762	203 x 711	227 x 735
LOPRO-K 1212*	12 x 12	305 x 305	254 x 254	278 x 278
LOPRO-K 1818*	18 x 18	457 x 457	406 x 406	430 x 430
LOPRO-K 2020*	20 x 20	508 x 508	457 x 457	481 x 481
LOPRO-K 2030	20 x 30	508 x 762	457 x 711	481 x 735
LOPRO-K 2432	24 x 32	610 x 813	559 x 762	583 x 786
LOPRO-K FP-12*	12" dia.	305	254	278
LOPRO-K FP-18*	18" dia.	457	406	430
LOPRO-K FP-24*	24" dia.	610	559	583
LOPRO-K KLIP	Spare clip	-	-	-

Other sizes available from 102 x 102mm up to 813 x 1829mm cut-out in door.

All products usually available ex-stock except those marked with *. Call for lead time. Additional manufacturers carriage charges may apply for * items. No charge for split boxes, but please try to order boxed quantity multiples where possible.